

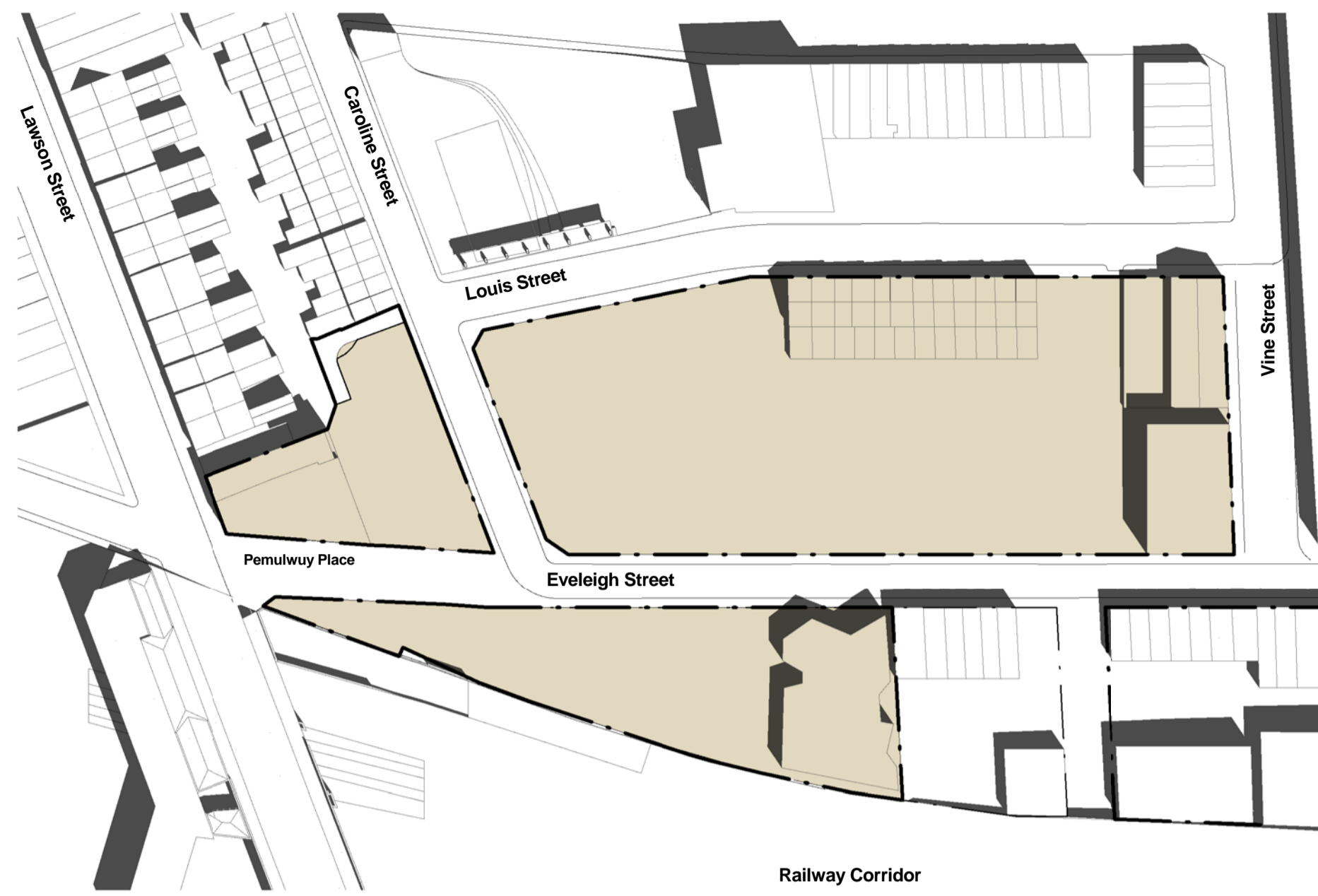

Existing - 21 December 0900

1 : 1000



Existing - 21 December 1000

1 : 1000



Existing - 21 December 1200

1 : 1000

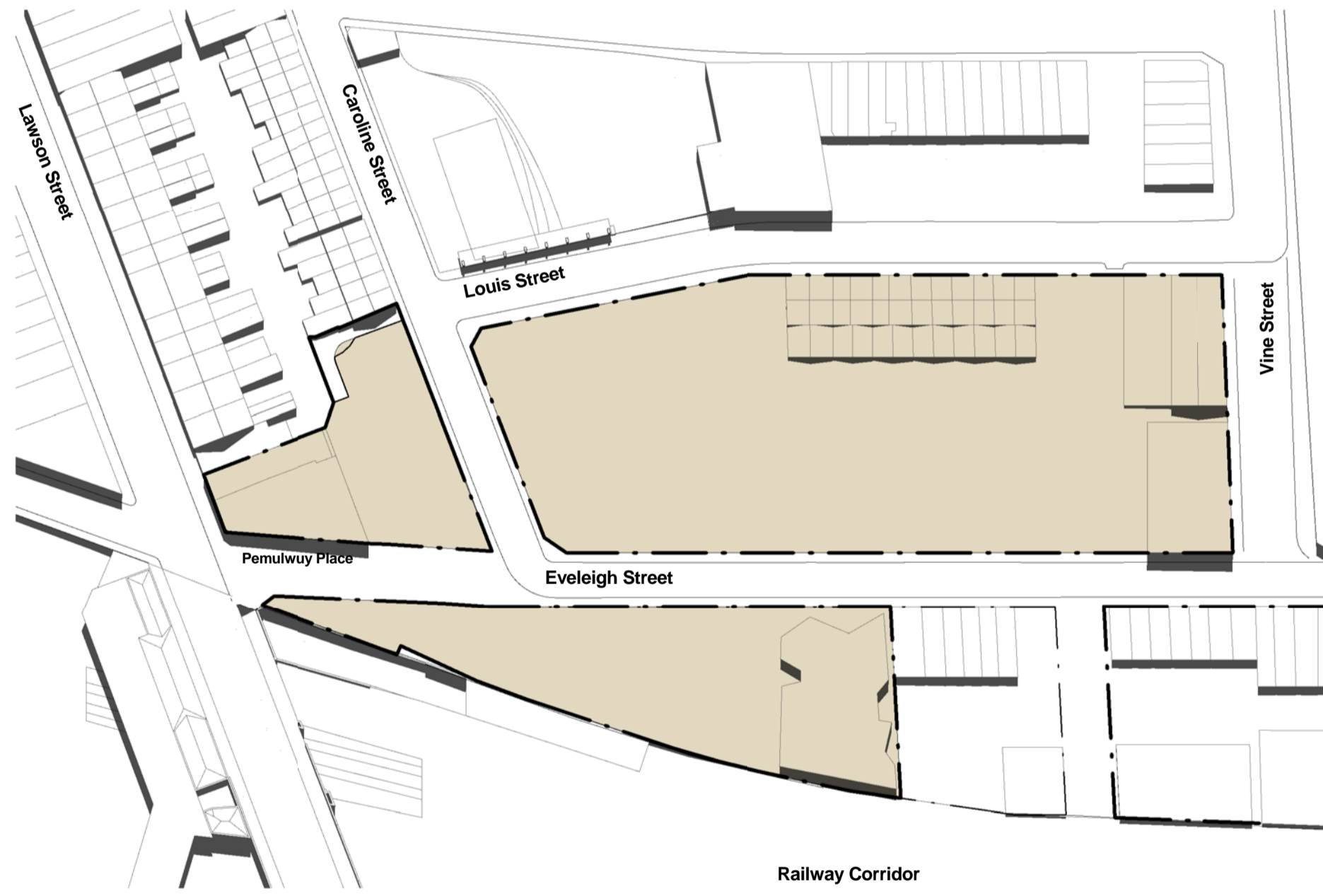

Existing - 21 December 1400

1 : 1000

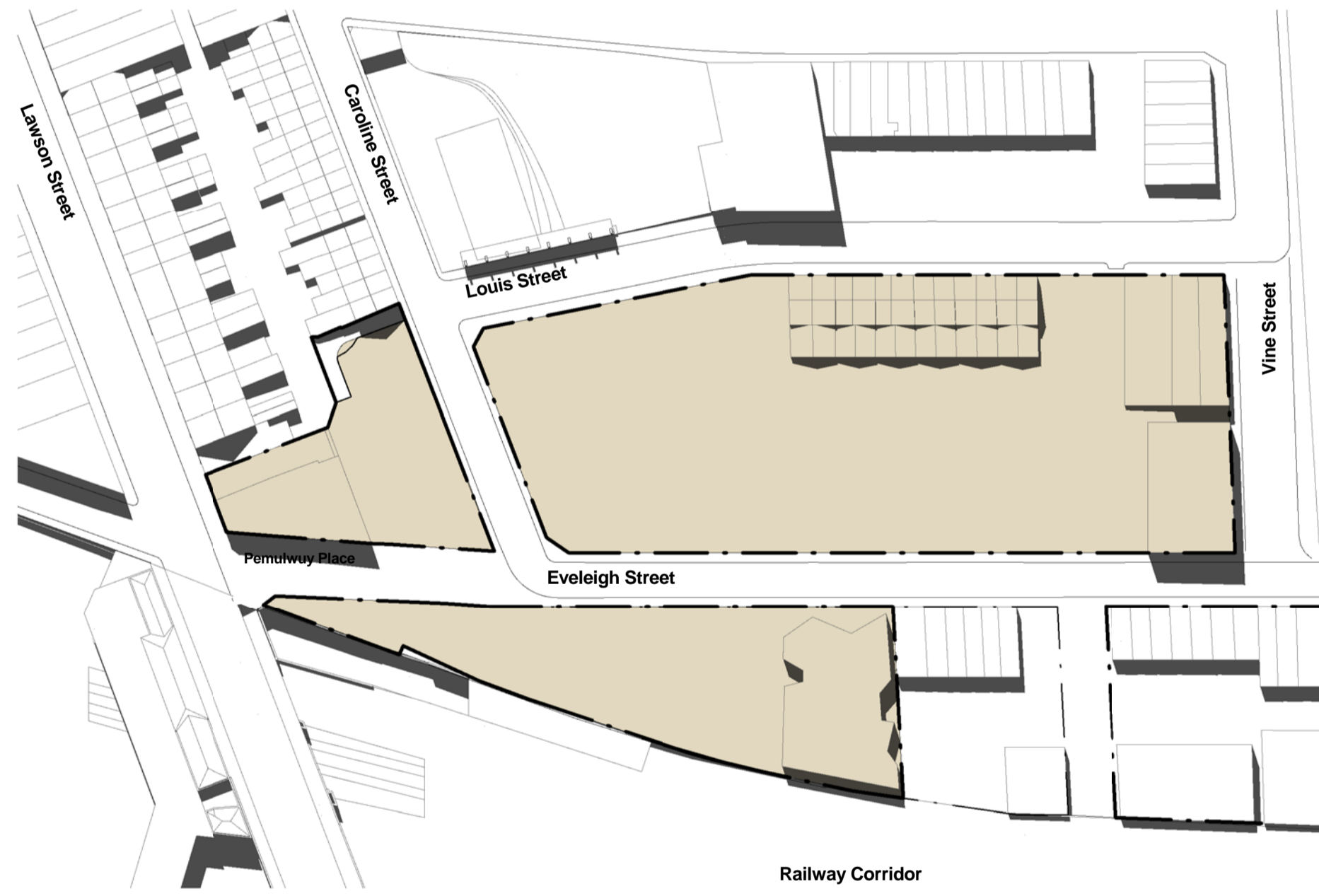

Existing - 21 December 1500

1 : 1000

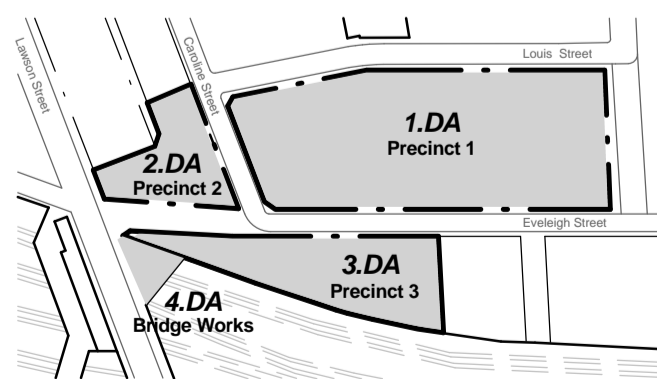

General Notes:
 Architectural Drawings To Be Read In Conjunction With All Other Consultants Detailed Drawings, Reports And Specifications.
 All Levels Indicated Taken To Australian Height Datum (AHD)
 Refer To ODA900 For Abbreviation Schedule And Proposed Outline Colour Selections And Finishes Selections.
 Site Underlay Based On Survey Carried Out By Denny Linker For Previous Application and Subsequent Survey Work Carried Out By Daw & Walton Consulting Surveyors - Refer To Drawing 302808.



CNR PARRAMATTA RD & JOHNSTON ST - PO BOX 254 - ANNANDALI - NSW 2038 - T.02 9517 2822 F.02 9517 2833
 STEPHEN J. NORDON REGISTRATION No. NSW - 4704 GRAHAM P. JAGO REGISTRATION No. NSW - 4926

Development Application		
Rev	Description	Date
A	Development Application Issue	14.12.11

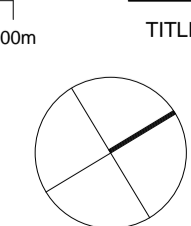
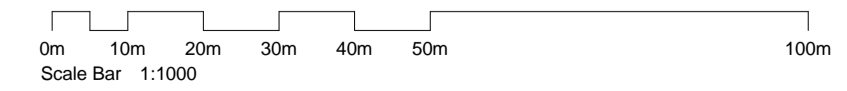

Pemulwuy Project, Mixed Use Development, REDFERN

J:\DEI0210 Pemulwuy Project\4 NIA Documentation\6 CAD\3 DA\01 Model\01 Current\DEI0210_0DA Site Master 111212.rvt

JOB No.	DEI00210
DATE	June 2010
SCALE	A1 @ As indicated
DWG No.	ODA052 A

Existing Shadow Diagrams December 21
(Summer Solstice)