

Marrickville Metro Expansion

AMP Capital Investments

| | |
|------|-----------------------------|
| 000 | Coversheet |
| 001 | Landscape Design Statement |
| 002 | Landscape Character Plan |
| 010 | Tree Removal Plan |
| 100 | Landscape Masterplan |
| C100 | Colour Landscape Masterplan |
| 101 | Landscape Plan |
| 102 | Landscape Plan |

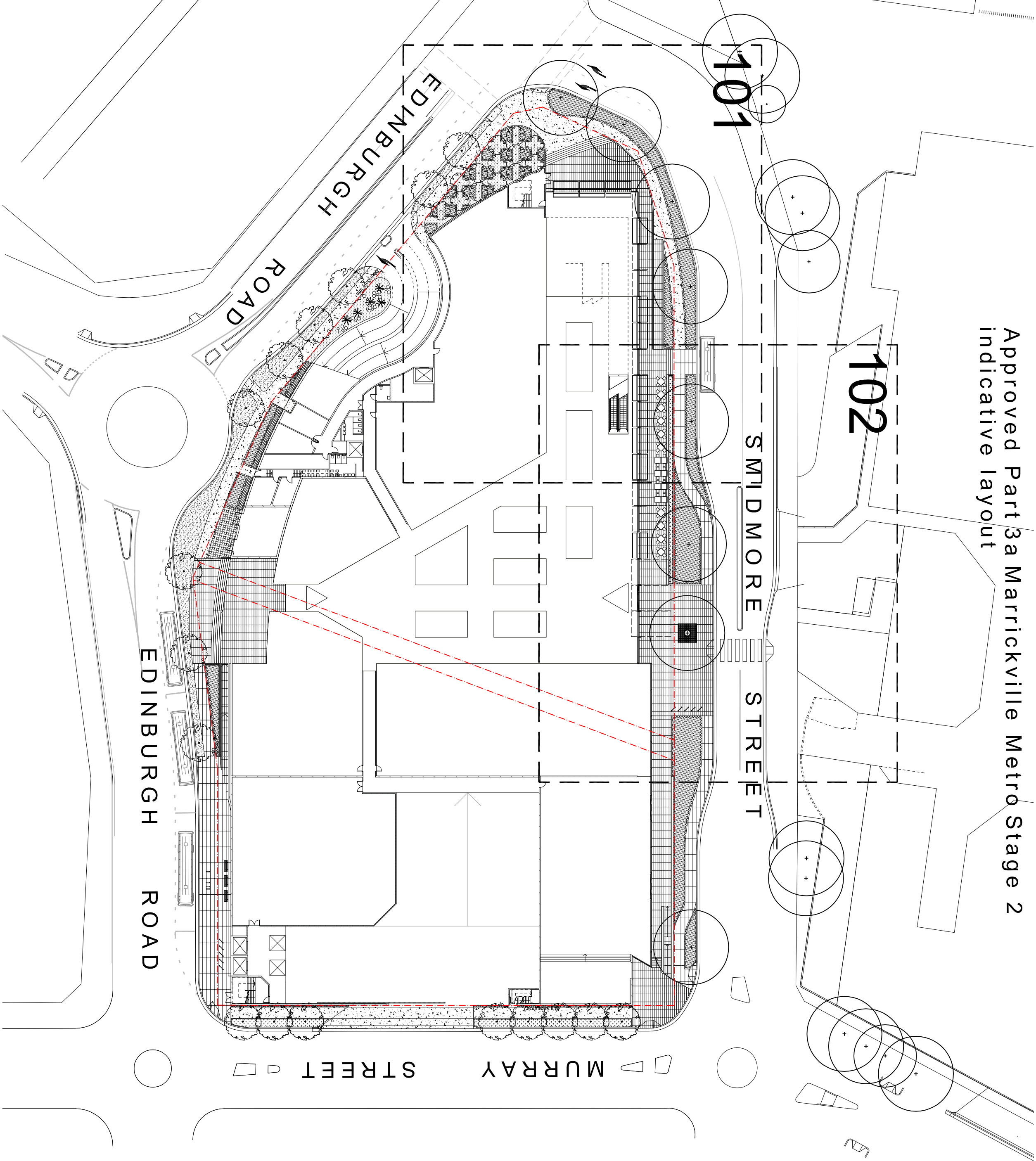

Section 75W Notes

This Section 75W Landscape Design package has been prepared on behalf of AMP Capital Investors to accompany an application to modify the existing Concept Plan Approval under Section 75W of the *Environmental Planning & Assessment Act 1979*. This application seeks to modify the existing Major Project Approval No. 09_0191, relating to the Stage 1 development of the Marrickville Metro Shopping Centre.

Indicative Plant Schedule

| Botanical Name | Common Name | Mature Height (m.) | Mature Spread (m.) | Plant Origin | Water Rating |
|--|-----------------------|--------------------|--------------------|----------------|--------------|
| Trees | | | | | |
| <i>Eucalyptus paniculata</i> | Grey Ironbark | 15-30 | 10 | Indigenous | Low |
| <i>Fraxinus griffithii</i> | Elefteen Ash | 8 | 4 | Non indigenous | Medium |
| <i>Olea europae</i> | Olive Tree | 6 | 4 | Non indigenous | Low |
| Hedge | | | | | |
| <i>Acmena smithii</i> var. <i>minor</i> | Dwarf Lillypill | 3 | 2 | Indigenous | Medium |
| <i>Acmena smithii</i> var. <i>minor</i> 'Alym Magic' | Alym Magic Lilly Pill | 0.8 | 0.8 | Indigenous | Medium |
| <i>Mulinay paniculata</i> | Orange Jasmine | 3 | 2 | Non indigenous | Medium |
| <i>Westringia Wynyabie Gem</i> | Wynyabie Rosemary | 1.5 | 1.5 | Indigenous | Low |
| Accents | | | | | |
| <i>Cycas revoluta</i> | Cycad | 3 | 2 | Non indigenous | Medium |
| <i>Dorantius excelsa</i> | Gynaea Lily | 2 | 2 | Indigenous | Low |
| Groundcovers & Grasses | | | | | |
| <i>Liriope muscari</i> 'Evergreen Giant' | Giant Liriope | 0.6 | 0.5 | Non indigenous | Medium |
| <i>Lomandra longifolia</i> 'Tanika' | Tanika Mat Rush | 0.7 | 0.6 | Indigenous | Low |
| <i>Trachelospermum jasminoides</i> | Star Jasmine | 0.3 | 1 | Indigenous | Low |
| <i>Themeda australis</i> | Kangaroo Grass | 0.8 | 0.3 | Indigenous | Low |
| <i>Philodendron 'Xenadu'</i> | Xenadu | 0.6 | 0.8 | Non indigenous | High |
| <i>Carex appressa</i> | Grass Flag | 0.8 | 0.6 | Indigenous | Medium |
| <i>Juncus usitatus</i> | Juncus | 0.8 | 0.3 | Indigenous | Medium |
| <i>Isolepis nodosa</i> | Knobby Club Grass | 1 | 0.7 | Indigenous | Low |
| <i>Lomandra longifolia</i> 'Tanika' | Tanika Mat Rush | 0.7 | 0.6 | Indigenous | Low |

© 2015 Site Image (NSW) Pty Ltd. ABN 44 601 262 280. All rights reserved. This drawing is copyright and shall not be reproduced or copied in any form or by any means (graphic, electronic or mechanical including photocopy) without the written permission of Site Image (NSW) Pty Ltd. This drawing is a preliminary design and is not to be used for any purpose what so ever is restricted to the terms of the written agreement between Site Image (NSW) Pty Ltd and the instructing party.

The contractor shall check and verify all work on site (including work by others) before commencing the landscape installation. Any discrepancies are to be reported to the Project Manager or Landscape Architect prior to commencing work. Do not scale this drawing. Any required dimensions not shown shall be referred to the Landscape Architect for confirmation.

| | | | | |
|-------|------------------------|-------|-------|------------|
| Issue | Revision Description | Drawn | Check | Date |
| A | Section 75W Submission | KA | SB | 13.12.2012 |
| B | Draw for review | KA | SB | 10.12.2012 |

LEGEND

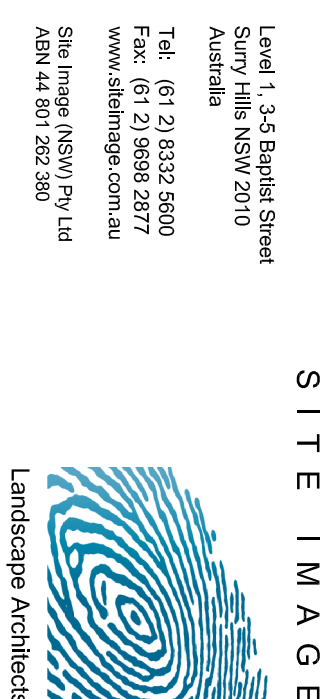

SECTION 75W

Drawing Name:
Cover Sheet