

01 21 March  
07:30 am

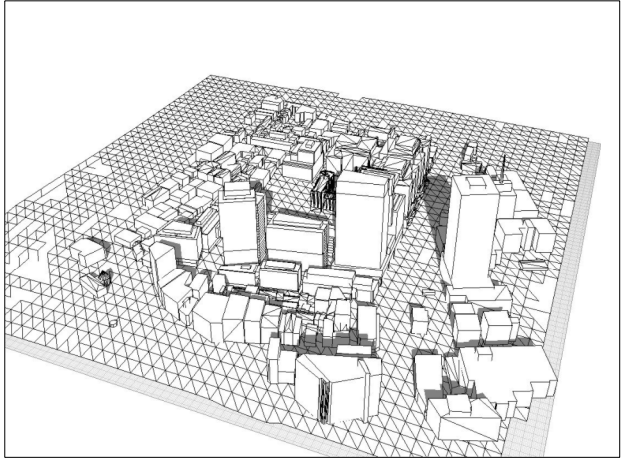

02 21 March  
8:30 am

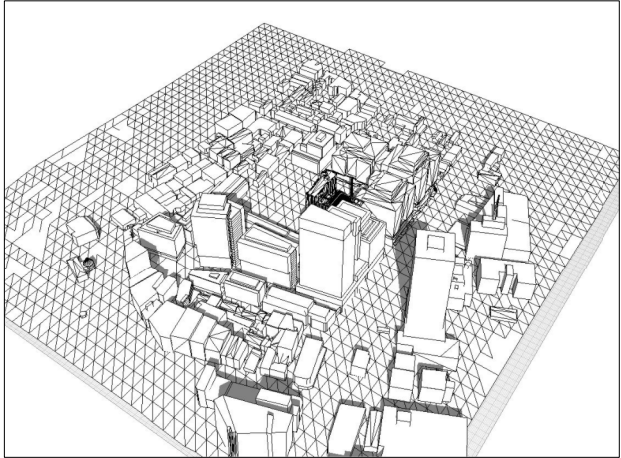

03 21 March  
9:30 am

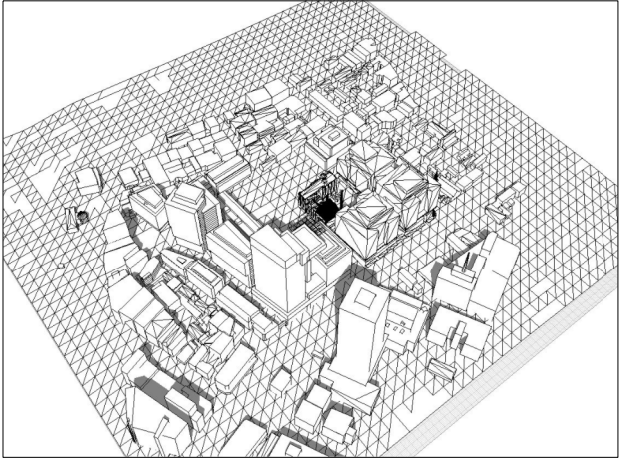

04 21 March  
10:30 am

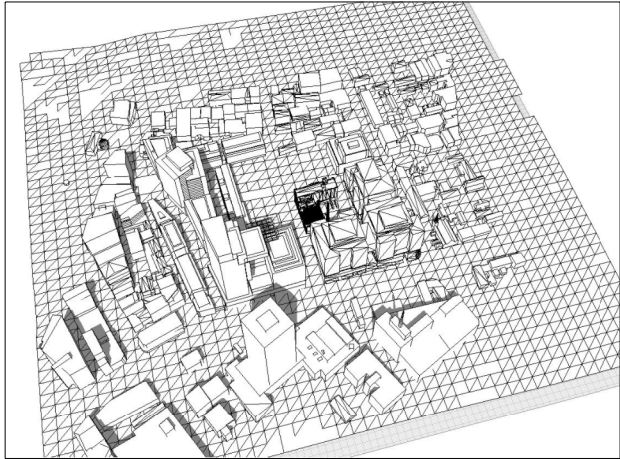

05 21 March  
11:30 am

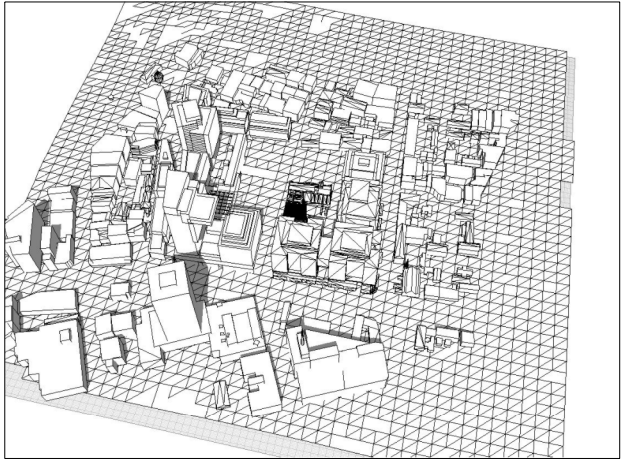

06 21 March  
12:30 pm

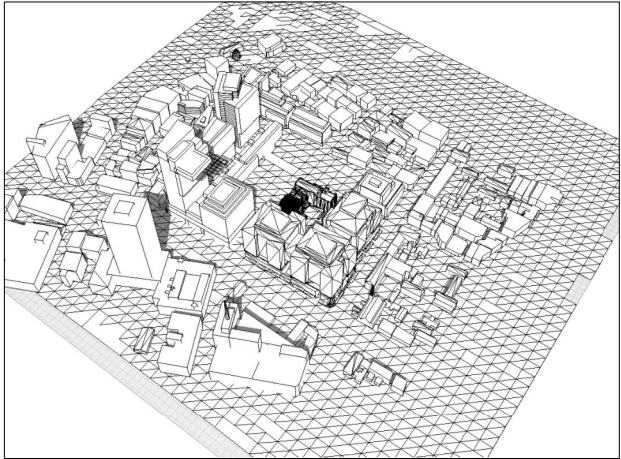

07 21 March  
01:30 pm

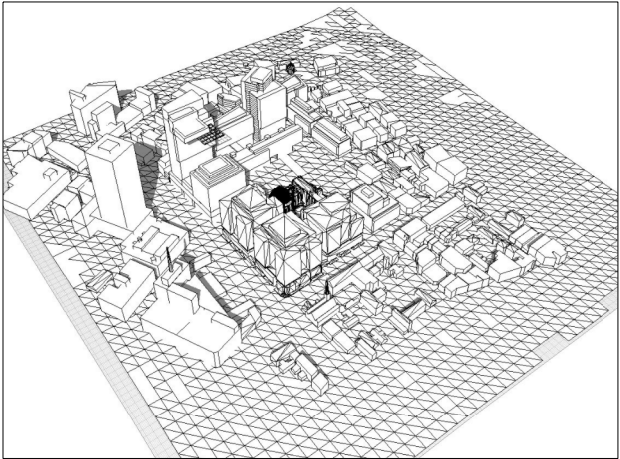

08 21 March  
02:30 pm

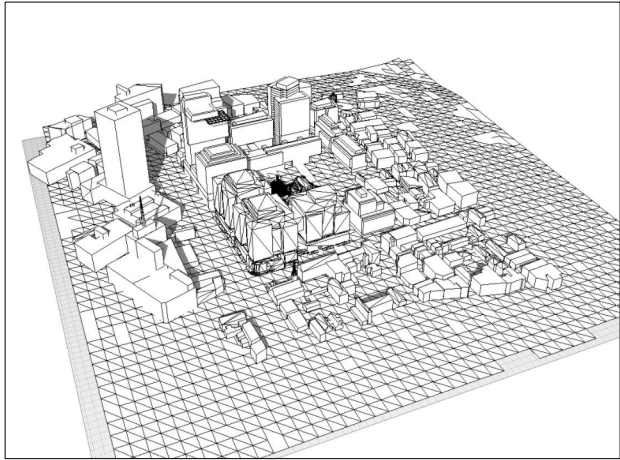

09 21 March  
03:30 pm

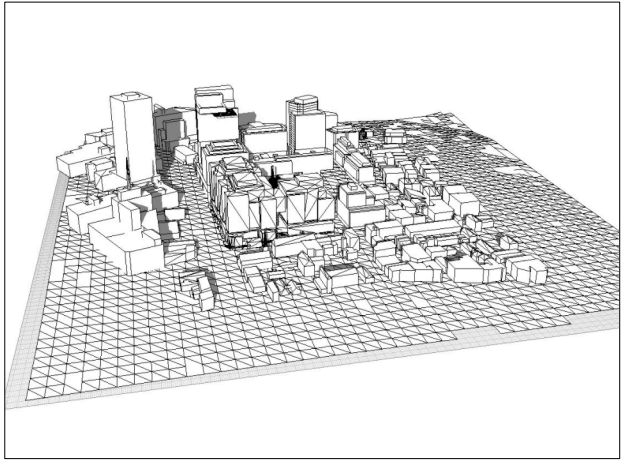

10 21 March  
04:30 pm

General Notes  
1. Do not scale drawings. Dimensions govern.  
2. All dimensions are in meters unless noted otherwise.  
3. All dimensions shall be verified on site before proceeding work.  
4. Foster + Partners shall be notified in writing of any discrepancies.

06	19/12/12	S75W Amendments (MOD 8)	RP
05	14/10/08	Submission DoP	
04	27/05/08	Submission amended DoP	
03	15/05/08	Submission DoP	
02	30/04/08	Submission amended CP	
01	21/04/08	Submission amended concept plan	
00	07/04/08	Final coordination	
-	31/03/08	For information (90% issue)	
-	19/03/08	For information (80% issue)	
-	14/03/08	For information (40% issue)	
Rev.	Date	Reason For Issue	Ck

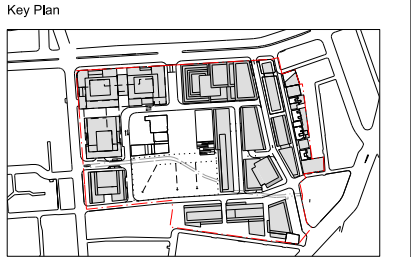

Notes

## FRASERS PROPERTY

Project Frasers Broadway  
20 - 102 Broadway Sydney NSW 2000

Client Frasers Broadway  
L11, 488 Kent Street Sydney NSW 2000  
T: 02 8823 8800 F: 02 8823 8801

## Foster + Partners

Riverside, 22 Hester Road  
London SW11 4AN  
T +44 (0)20 7738 0455  
F +44 (0)20 7738 1107

Title  
Concept Plan  
Sun Studies - Sheet 1

Project No.	Scale @ A3	Date	Drawn By
1645	NTS	14/03/08	
Number	Revision		
A-1292	06		