

PLANT IMAGES



Pyrus calleryana 'Chanticleer'



Anigozanthus 'Gold valve'



Themeda 'nirngo'



Brachycombe multifida



Carpobrotus glaucescens



Dianella 'Little Jess'



Lomandra 'Katie Belles'



Myoporum 'Yareena'



Pennisetum 'nairay'

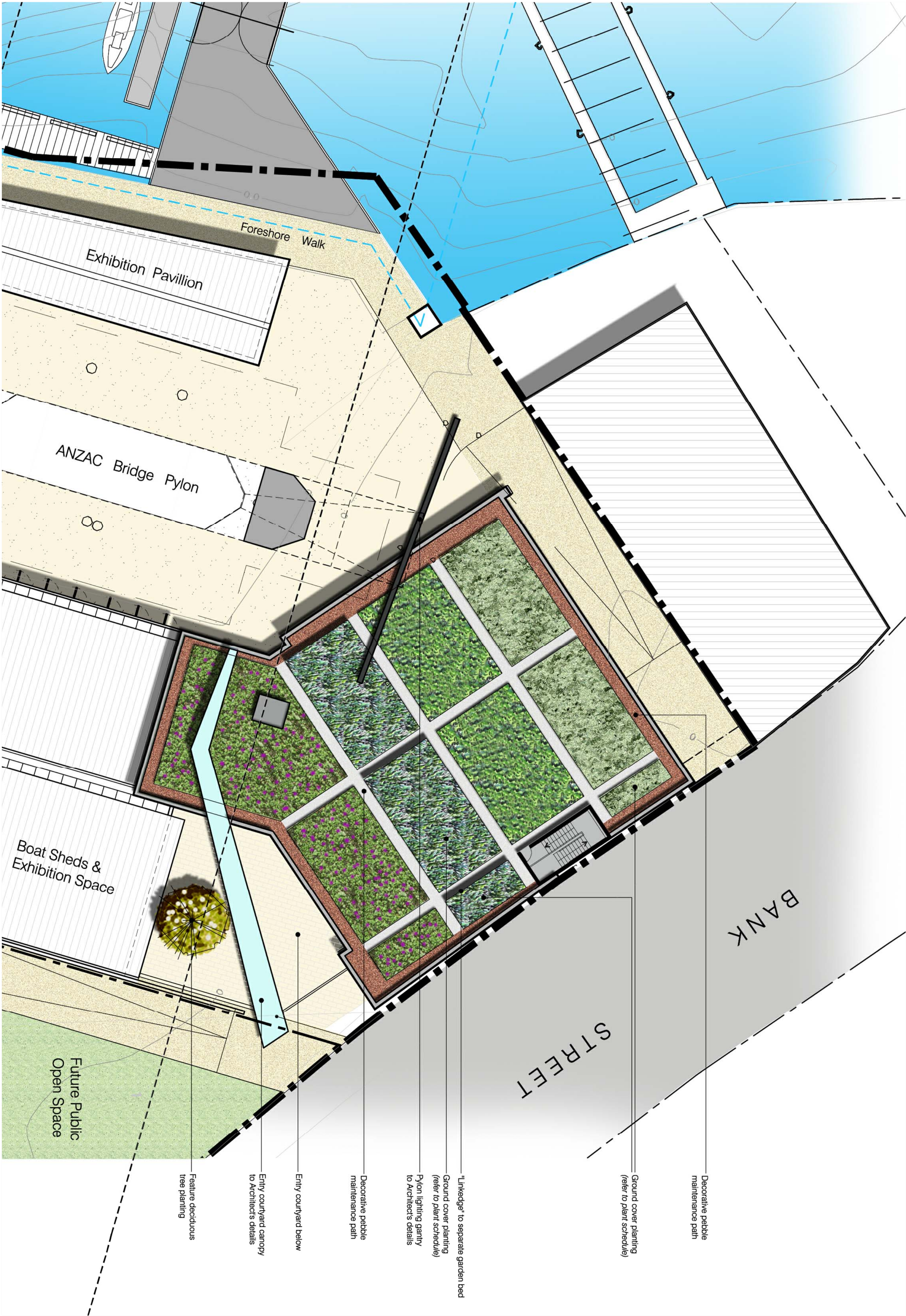

PLANTING PLAN

scale 1:200

LEGEND

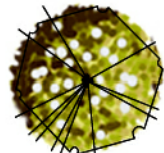

Proposed feature deciduous tree planting
(refer to plant schedule)

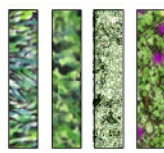

Proposed ground cover & native
grass planting (refer to plant schedule)

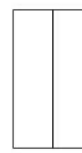

Proposed garden edge "Linkedge"



Proposed pebbles maintenance path

INDICATIVE PLANT SCHEDULE

Botanical Name	Common Name
Tree	
Pyrus calleryana 'Chanticleer'	Calleryana Pear
Native Grasses	
Dianella 'Yaranda'	
Dianella 'Little Jess'	
Dianella 'Lucia'	
Lomandra 'Katie Belles'	
Lomandra 'Kairius deluxe'	
Lomandra 'tanker'	
Lomandra 'Tropic Belle'	
Pennisetum 'nairay'	
Pennisetum 'perstipe'	
Themeda 'nirngo'	
Groundcovers	
Anigozanthus 'Gold valve'	Kangaroo Paw
Brachycombe multifida	Rock Daisy
Carpobrotus glaucescens	Pig face
Grevillea 'Gaudichaud'	Prostrate Grevillea
Helianthus actinotus	Flannel Flower
Myoporum 'Yareena'	
Scaevola 'Purple Luston'	

"Linkedge" 50mm depth
as specified
Secured to plywood
block to separate
concrete from ground
covers

RC slab to Ends Details & screed
2% fall towards drainage pits

"Tyrogreen LDPE Sheet" to
protect waterproof layer

40-60mm thk "Tyrogreen Hydrocell
Extensive Roof Garden Mk1"
20-40mm thk "Tyrogreen
Hydrocell RG30" linked foam
Blanket A14G geotextile
membrane or similar approved
20mm thk "Tyrogreen-Fyronap 20"
geotextile approved drainage filter
laid at base of planter

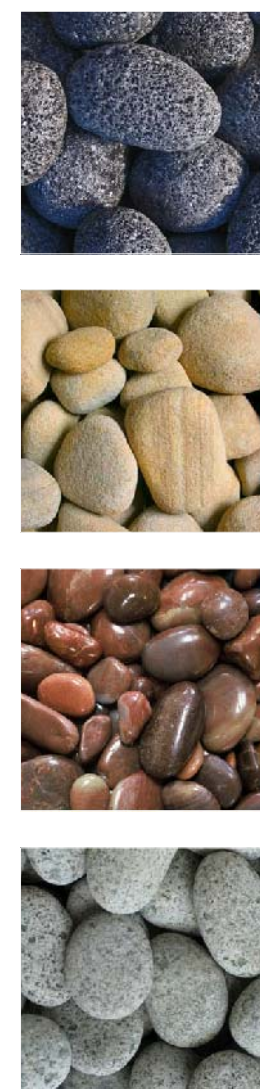

TYPICAL DETAIL : extensive roof garden

scale 1:20

SYDNEY HERITAGE FLEET BASE
Bank Street, Pyrmont - Lot 19 and Lot 20

LANDSCAPE CONCEPT PLAN

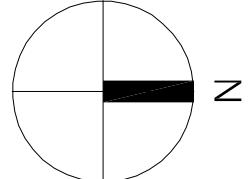

STURT ASSOCIATES
SUITE 91, 330 MARTIN STREET
ULTIMO NSW 2007
T: (02) 9271 3144 F: (02) 9271 9449
E: enquiries@sturtassociates.com.au

DATE: 08 DECEMBER 2010
DRAWING: DA-1035-01
SCALE 1:200 @ A1