



SCALE
Basin plan 1:1 250
Location plan and detail NTS

ORIENTATION
NORTH

LEGEND

Pacific Pine Estate Balance boundary

SOURCES
Contours and proposed layout supplied by
Kennedy Surveying and SMEC Urban

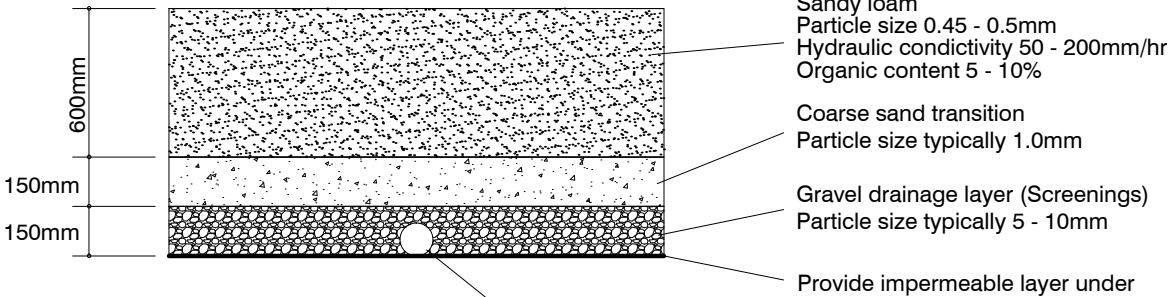

Notes
Filter conductivity to be measured in
accordance with AS4419:2003.
Filter organic content to be measured
in accordance with AS1289 4.1.1.

100mm dia perforated
PVC Pipe to be graded
to fall to a free draining
outlet.

TYPICAL BIORETENTION BASIN FILTER ZONE DETAIL

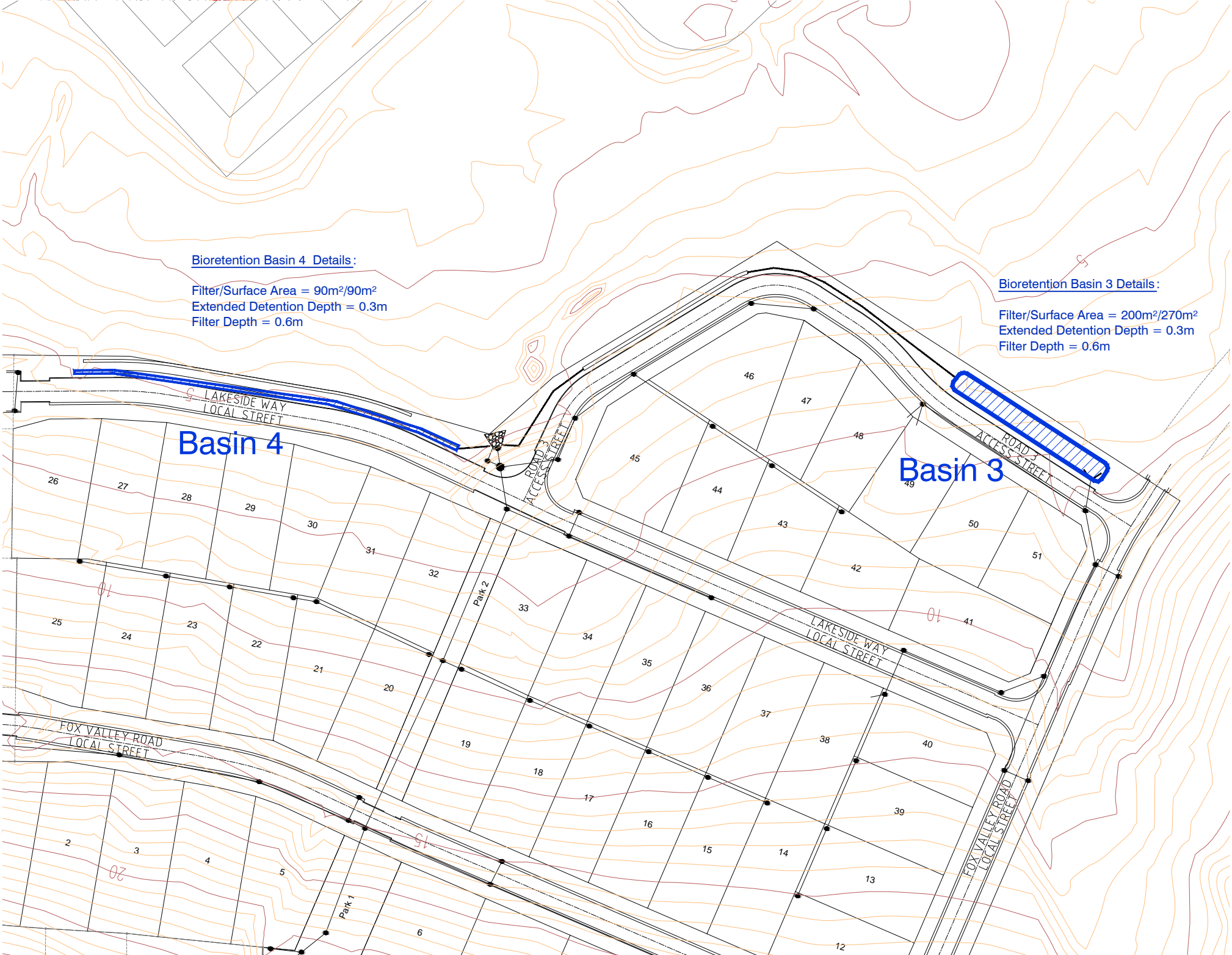

Bioretention Basin 4 Details:
Filter/Surface Area = 90m²/90m²
Extended Detention Depth = 0.3m
Filter Depth = 0.6m

Bioretention Basin 3 Details:
Filter/Surface Area = 200m²/270m²
Extended Detention Depth = 0.3m
Filter Depth = 0.6m

CAIRNS
KAWANA
BRISBANE
ROBINA
5 / 232 Robina Town Centre Dr.
PO Box 4115
Robina Q4230
Phone 07 5578 9944
Fax 07 5578 9945
robina@access.gs

MELBOURNE

Gilbert and Sutherland Pty Ltd
ABN 56 077 310 840

www.access.gs

AGRICULTURE WATER ENVIRONMENT

PROJECT
PACIFIC PINES ESTATE
LENNOX HEAD, NSW

CLIENT
LEND LEASE

DRAWING
BIORETENTION BASIN
DETAILS

DATE 24/09/2012	DRAWN BWS
SCALE 1:1 250 & NTS	CHECKED CMA
PROJECT NO 10734	REVISION B
DRAWING NO 1.6	



SCALE
1:5 000



ORIENTATION
NORTH

LEGEND

- Pacific Pines Estate
balance boundary
- WBNM base case
catchment boundary

SOURCES

Contours and proposed layout supplied by
Kennedy Surveying and SMEC Urban

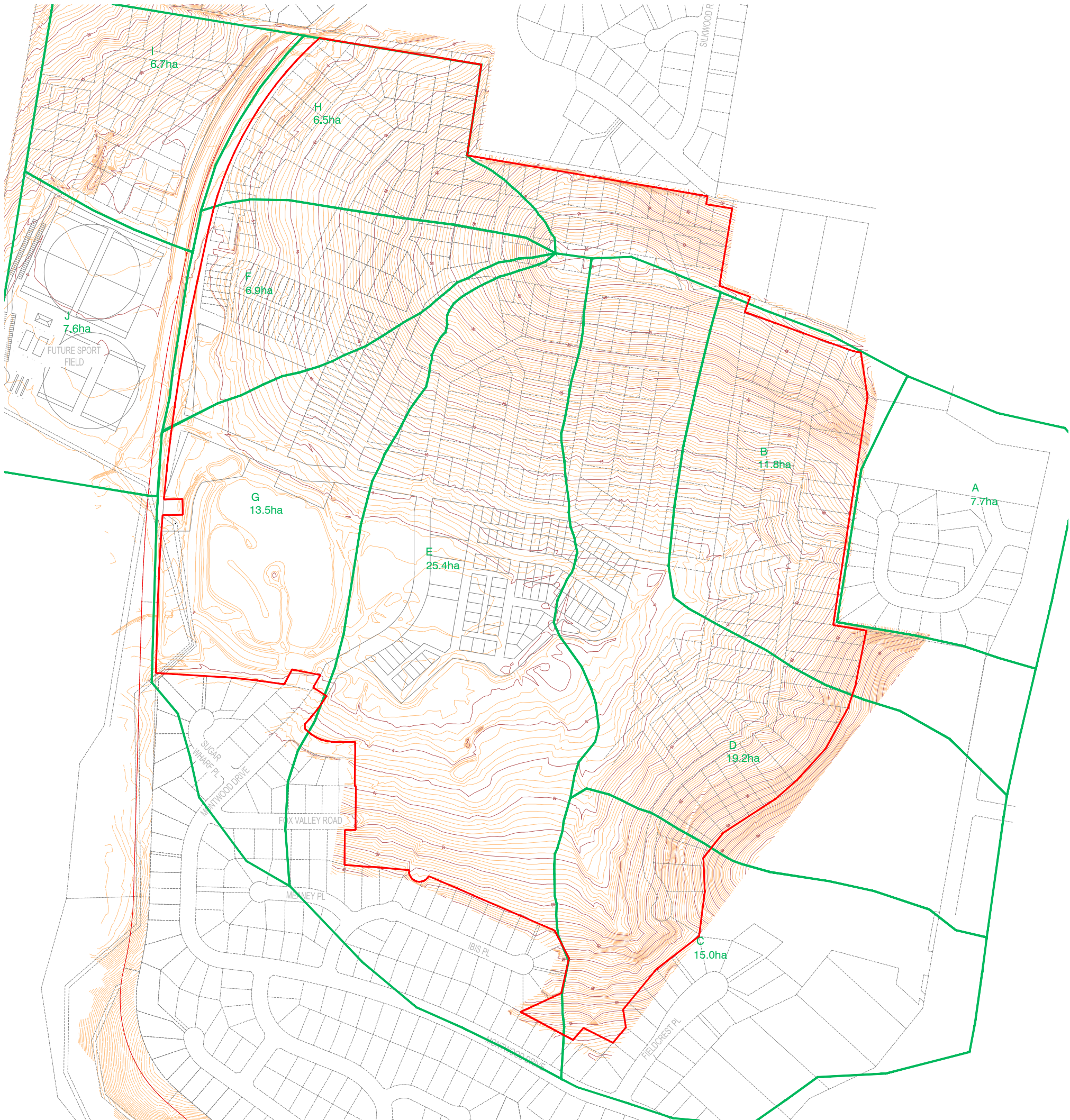

CAIRNS
KAWANA
BRISBANE
ROBINA
5 / 232 Robina Town Centre Dr.
PO Box 4115
Robina Q4230
Phone 07 5578 9944
Fax 07 5578 9945
robina@access.gs
MELBOURNE
Gilbert and Sutherland Pty Ltd
ABN 56 077 310 840
www.access.gs

AGRICULTURE WATER ENVIRONMENT

PROJECT
PACIFIC PINES ESTATE
LENNOX HEAD, NSW

CLIENT
LEND LEASE

DRAWING
WBNM BASE CASE
CATCHMENT PLAN

DATE
24/09/2012

SCALE
1:5 000

PROJECT NO
10734

DRAWN
BWS

CHECKED
CMA

REVISION
B



SCALE
1:5 000



ORIENTATION
NORTH

LEGEND

- Pacific Pines Estate balance boundary
- Stage 1A boundary
- WBNM developed case catchment boundary

SOURCES

Contours and proposed layout supplied by Kennedy Surveying and SMEC Urban

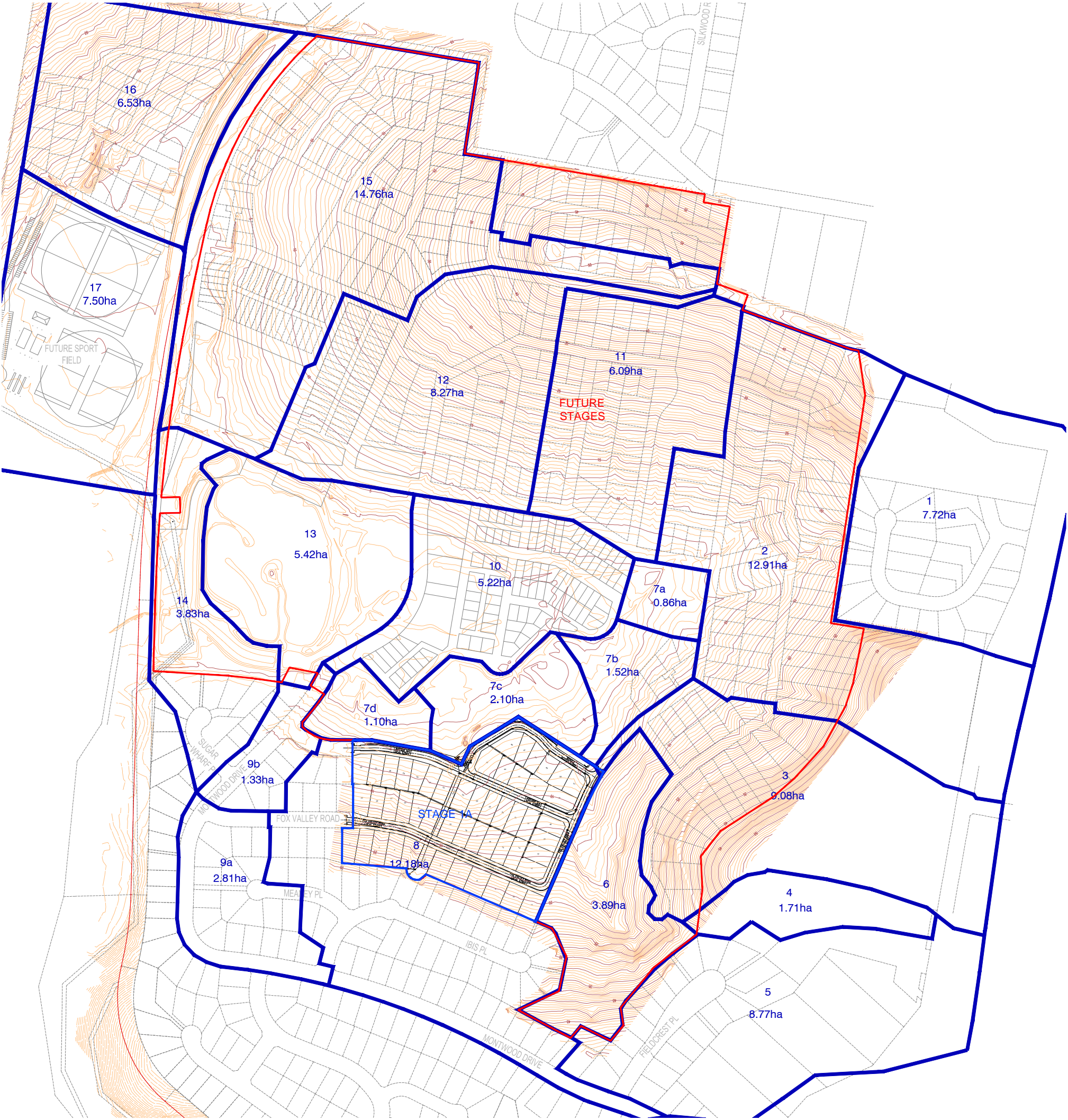

CAIRNS
KAWANA
BRISBANE
ROBINA
5 / 232 Robina Town Centre Dr.
PO Box 4115
Robina Q4230
Phone 07 5578 9944
Fax 07 5578 9945
robina@access.gs

MELBOURNE
Gilbert and Sutherland Pty Ltd
ABN 56 077 310 840

www.access.gs

AGRICULTURE WATER ENVIRONMENT

PROJECT
PACIFIC PINES ESTATE
LENNOX HEAD, NSW

CLIENT
LEND LEASE

DRAWING
WBNM DEVELOPED CASE
CATCHMENT PLAN

DATE
24/09/2012

SCALE
1:5 000

PROJECT NO
10734

DRAWN
BWS

CHECKED
CMA

REVISION
B



SCALE
1:5 000

ORIENTATION
NORTH

LEGEND

- Pacific Pines Estate Balance Boundary
- WBNM developed case catchment boundary
- Detention Basin

SOURCES

Contours and proposed layout supplied by Kennedy Surveying and SMEC Urban

CAIRNS
KAWANA
BRISBANE
ROBINA
5 / 232 Robina Town Centre Dr.
PO Box 4115
Robina Q4230
Phone 07 5578 9944
Fax 07 5578 9945
robina@access.gs
MELBOURNE
Gilbert and Sutherland Pty Ltd
ABN 56 077 310 840

www.access.gs

AGRICULTURE WATER ENVIRONMENT

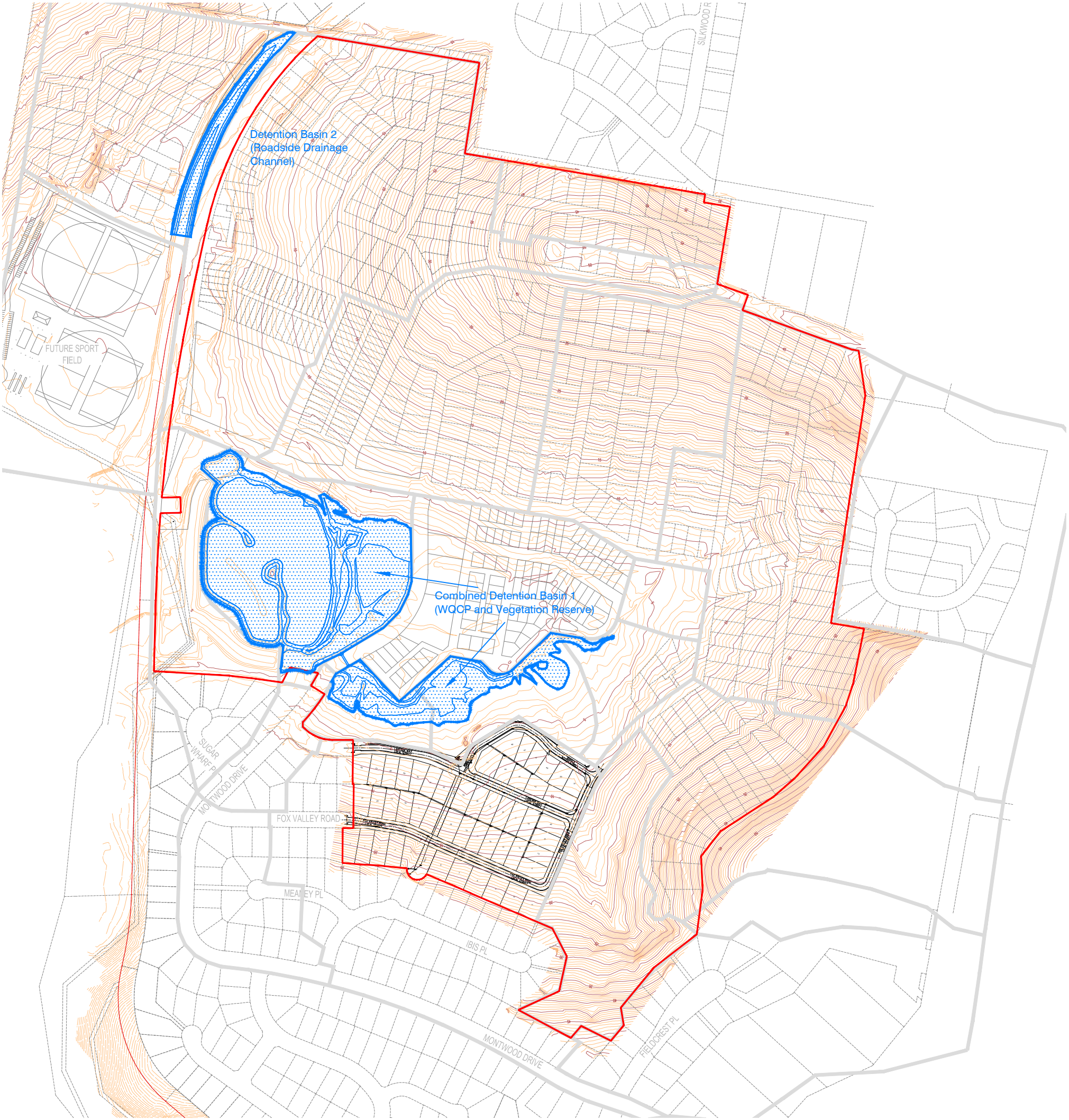

PROJECT
PACIFIC PINES ESTATE
LENNOX HEAD, NSW

CLIENT
LEND LEASE

DRAWING
DETENTION BASIN LAYOUT

DATE 24/09/2012	DRAWN BWS
SCALE 1:5 000	CHECKED CMA
PROJECT NO 10734	DRAWING NO 1.9
	REVISION B



SCALE
Basin plan 1:1 250
Location plan and detail NTS



ORIENTATION
NORTH

LEGEND

Pacific Pine Estate Balance boundary

SOURCES

Contours and proposed layout supplied by
Kennedy Surveying and SMEC Urban

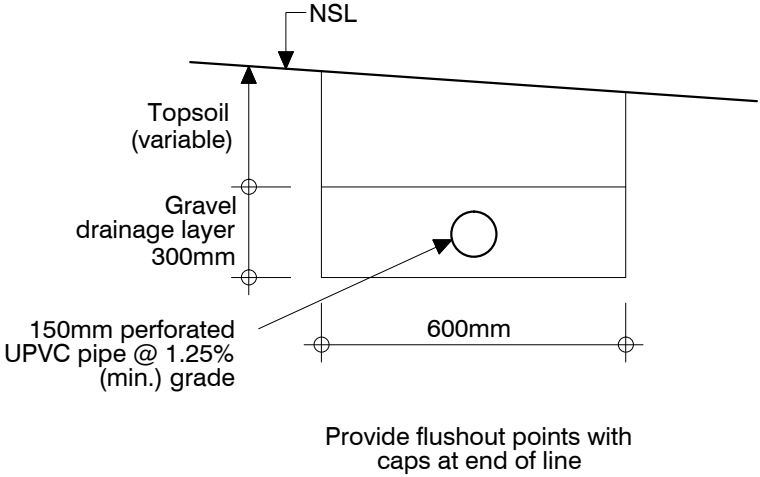

INFILTRATION TRENCH TYPICAL DETAIL

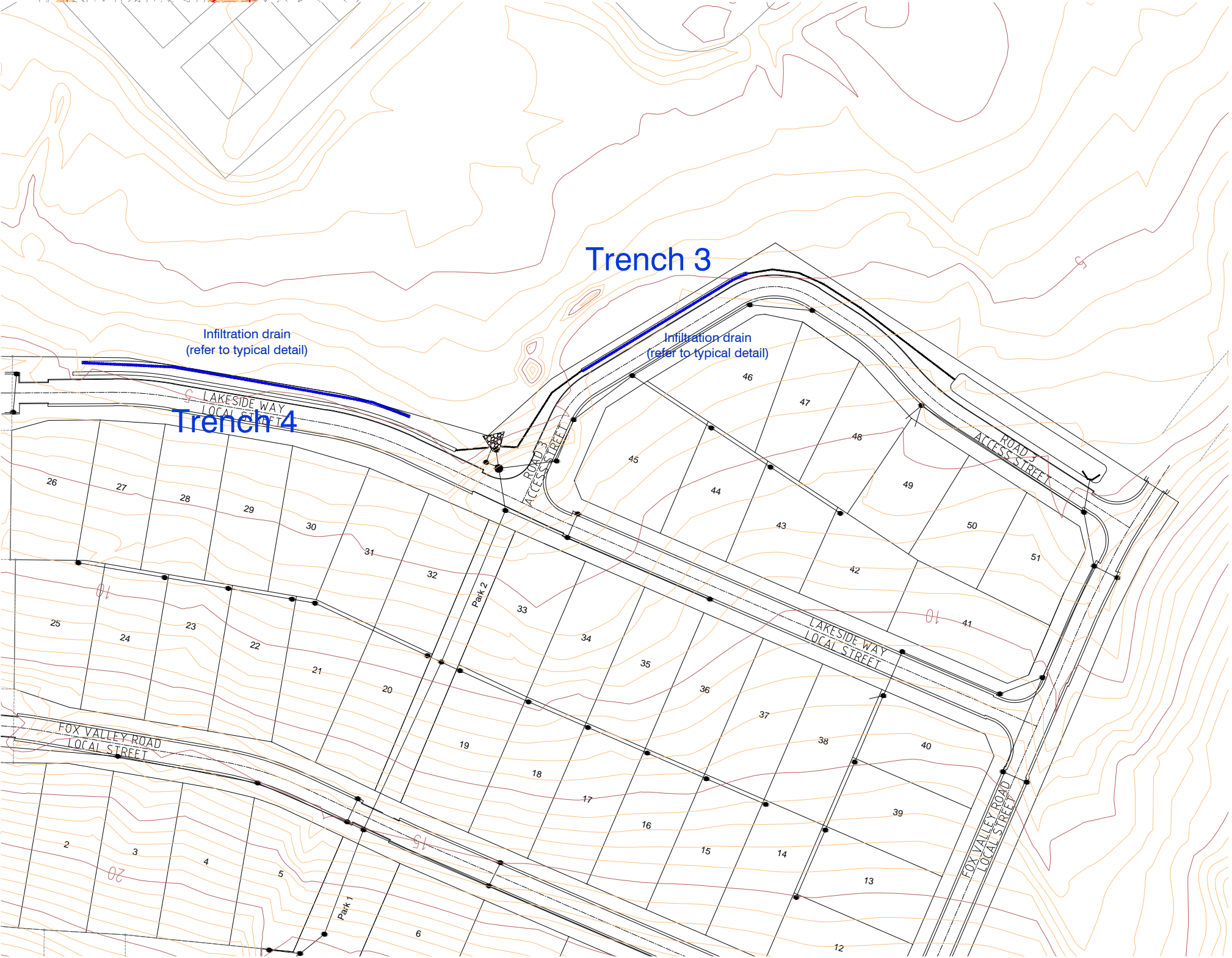

CAIRNS
KAWANA
BRISBANE
ROBINA
5 / 232 Robina Town Centre Dr.
PO Box 4115
Robina Q4230
Phone 07 5578 9944
Fax 07 5578 9945
robina@access.gs
MELBOURNE
Gilbert and Sutherland Pty Ltd
ABN 56 077 310 840
www.access.gs
AGRICULTURE WATER ENVIRONMENT

PROJECT
PACIFIC PINES ESTATE
LENNOX HEAD, NSW

CLIENT
LEND LEASE

DRAWING
INFILTRATION
TRENCH DETAILS

DATE 24/09/2012	DRAWN BWS
SCALE 1:1 250 & NTS	CHECKED CMA
PROJECT NO 10734	DRAWING NO 1.10
	REVISION B