

1 PLAN Level 9
1:100

NOTE - REFER TO INTERIOR ARCHITECTS PLANS FOR APARTMENT LAYOUTS, DETAIL PLANS & RCPs - DO NOT SET OUT INTERNAL WALLS OR FIXTURES FROM ARCHITECTURAL GA DRAWINGS
APARTMENT PLANS SHOWN ARE INDICATIVE OF INTERIOR ARCHITECTS LAYOUTS, SERVICES AND STRUCTURAL COORDINATION IS ONGOING
ADAPTABLE LAYOUTS PENDING APPROVAL BY BCA & ACCESS CONSULTANT
ALL PENTHOUSE APARTMENTS TO BE FINALISED BY INTERIOR ARCHITECTS
RISERS SHOWN IN RED REPRESENT BASEMENT SERVICES.

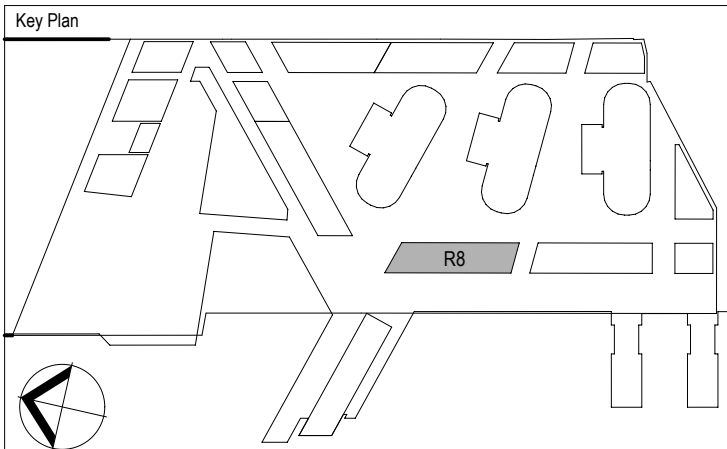

Rev.	Item	Revision Description	Date	Rev.	Item	Revision Description	Date
03		FOR INFORMATION	21-03-2013				
02		FOR COORDINATION	12-03-2013				
01		FOR COORDINATION	27-02-2013				
00		FOR COORDINATION	18-01-2013				

Architects		Principal	
fjmt francis-jones morden thorp		Lend Lease	
SYDNEY Level 5, 70 King Street Sydney NSW 2000 Australia T +61 2 9251 7077 F +61 2 9251 7072 E info@fjmt.com.au W www.fjmt.com.au		Developer Project Management & Construction Lend Lease	
NOMINATED ARCHITECT: RICHARD FRANCIS-JONES (REG NO 3581)		Design Lend Lease	
Consultant		30 The Bond 30 Hickson Road Milsons Point NSW 2000 www.lendlease.com	

Project		Title	
BARANGAROO SOUTH		GENERAL ARRANGEMENT PLAN- PPR Level 9 Floor Plan	
Drawn By JMT	Date 23/01/13	Purpose FOR INFO	Approved By JP
SCALE 1:100 @ B1		1:250 @ A3	
Site No. BR8		Drawing No. BR8AD3090000-03	

FOR PPR ISSUE	
These designs, plans and specifications and the copyright therein are the property of Lend Lease and must not be used, reproduced or copied wholly or in part without the written permission of Lend Lease.	