

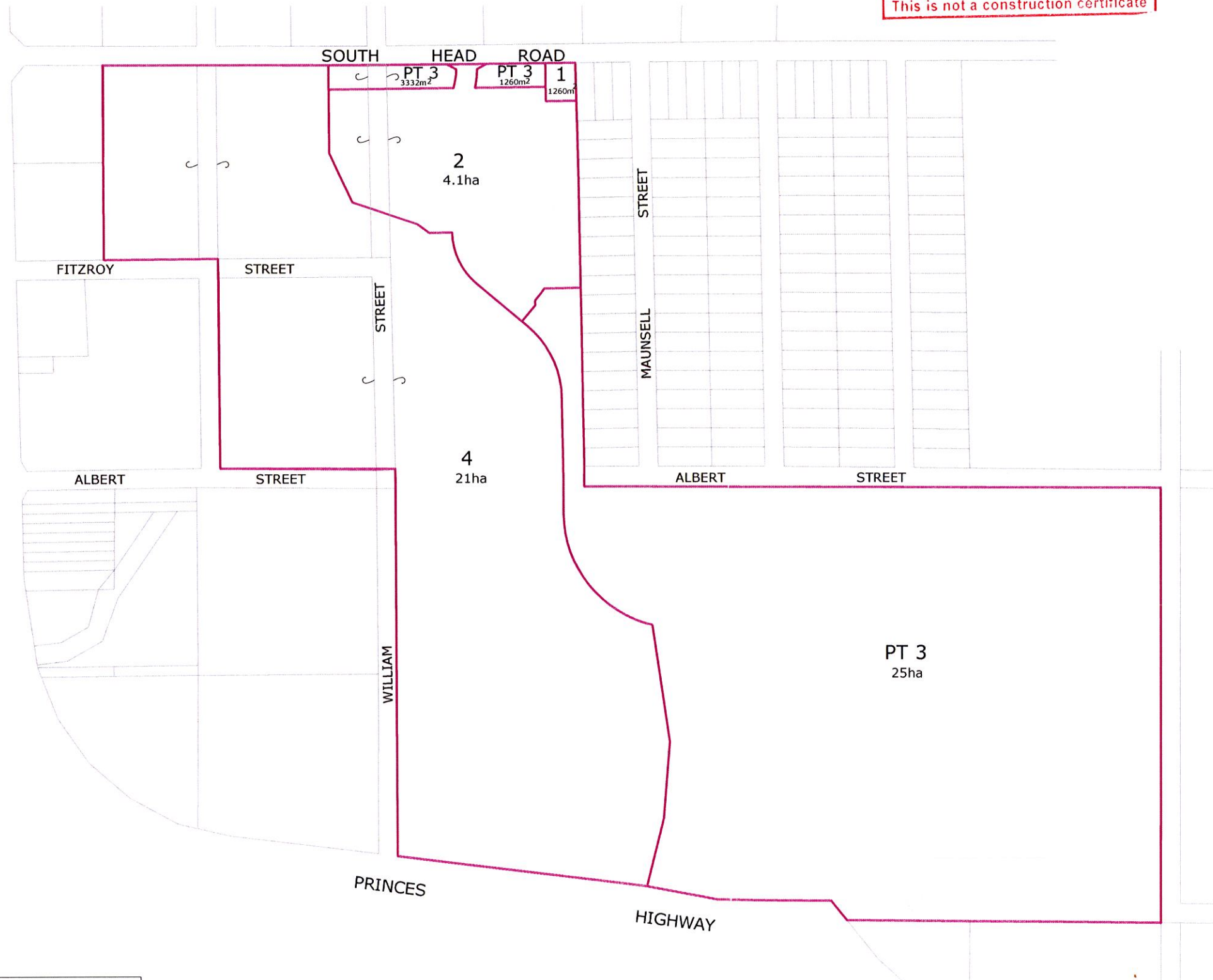

28/11

EUROBODALLA SHIRE COUNCIL
DEVELOPMENT CONSENT
This is the approved plan No. 11/218A1
referred to in consent No. 218/11
Dated: 24-2-11
Please note carefully the conditions of consent:
some conditions may affect this plan.
This is not a construction certificate



ALL DIMENSIONS AND AREAS ARE APPROXIMATE
AND SUBJECT TO SURVEY
THIS PLAN IS TO BE USED FOR DEVELOPMENT
APPLICATION PURPOSES ONLY

© CBH 2010
COPYRIGHT OF THIS PLAN BELONGS TO CONWAY BURROWS & HANCOCK
REPRODUCTION OF THE PLAN IN FULL OR PART IS NOT PERMITTED
WITHOUT WRITTEN PERMISSION

EUROBODALLA SHIRE COUNCIL
DATE RECEIVED
17 FEB 2011
PLAN No: 11/218A1

PROPOSED SUBDIVISION OF
LOTS 1 & 2 DP 553273
LOTS 65 & 68 DP 752151
LOTS 1-4 SECTION 33 DP 758710
LOTS 2 & 3 SECTION 34 DP 758710
LOTS 1-4 SECTION 42 DP 758710
LOT 50 DP 752151
LOT 51 DP 1107021
LOT 54 DP 1107020

PROPOSED SUBDIVISION
STAGING PLAN
STAGE 1A

BRAEMAR HOMESTEADS
SOUTH HEAD ROAD MORUYA

CLIENT:
PATENT DEVELOPMENT PTY LTD

**Conway Burrows
+ Hancock**
Consulting Surveyors
Civil Engineering Consultants
Land Development Consultants

126 BEACH ROAD
BATEMANS BAY NSW 2536
02 4472 5585
VULCAN STREET
MORUYA NSW 2537
02 4474 2663

| | | | |
|------------------------------|----------------|--------------------------------|----|
| DATE: 10 SEPTEMBER 2010 | | PLAN NUMBER: 13226-5 | |
| SURVEY: | PROJECT: 13226 | SHEET OF SHEETS | |
| DRAWN: ADB | DISK: Z123 | 2 | 10 |
| DATUM: AHD | | A3 | |
| REDUCTION RATIO: 1:1000 (A3) | | | |



SOUTH HEAD ROAD

INTERSECTION AS PER
COUNCIL PLAN 3964

© CBH 2010
COPYRIGHT OF THIS PLAN BELONGS TO CONWAY BURROWS & HANCOCK
REPRODUCTION OF THE PLAN IN FULL OR PART IS NOT PERMITTED
WITHOUT WRITTEN PERMISSION

100 YEAR FLOOD HEIGHT

(R) RESTRICTION ON THE USE OF LAND
(40m BUILDING SETBACK SOUTH HEAD ROAD)

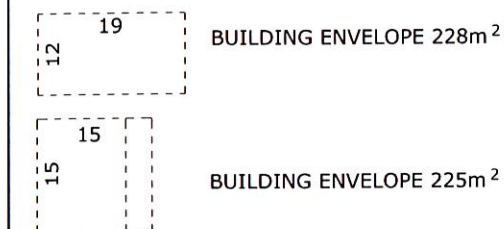

PROPOSED SUBDIVISION OF
LOTS 1 & 2 DP 553273
LOTS 65 & 68 DP 752151
LOTS 1-4 SECTION 33 DP 758710
LOTS 2 & 3 SECTION 34 DP 758710
LOTS 1-4 SECTION 42 DP 758710
LOT 50 DP 752151
LOT 51 DP 1107021
LOT 54 DP 1107020

PROPOSED LOT LAYOUT

EUROBODALLA SHIRE COUNCIL
DATE RECEIVED
17 FEB 2011
PLAN No: 11/21841

BRAEMAR HOMESTEADS
SOUTH HEAD ROAD MORUYA

CLIENT:
PATENT DEVELOPMENT PTY LTD

**Conway Burrows
+ Hancock**
Consulting Surveyors
Civil Engineering Consultants
Land Development Consultants

126 BEACH ROAD
BATEMANS BAY NSW 2536
02 4472 5585

VULCAN STREET
MORUYA NSW 2537
02 4474 2663

DATE: 10 SEPTEMBER 2010

SURVEY: PROJECT: 13226

DRAWN: ADB DISK: Z123

DATUM: AHD

REDUCTION RATIO: 1:1000 (A3)

PLAN NUMBER:

13226-5

SHEET OF SHEETS

2A

10

SHEET SIZE:

A3

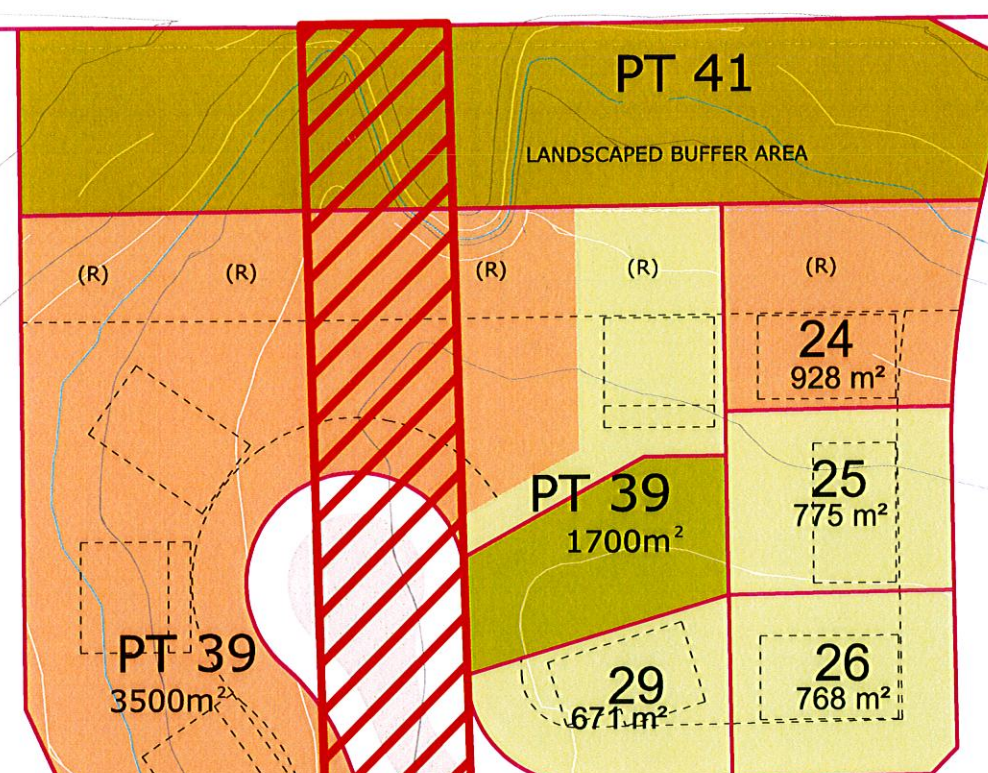

ROAD 1
(22 WIDE)

ROAD 2
(18.5 WIDE)



ROAD TO BE CLOSED

FITZROY STREET

WILLIAM STREET

ALL DIMENSIONS AND AREAS ARE APPROXIMATE
AND SUBJECT TO SURVEY
THIS PLAN IS TO BE USED FOR DEVELOPMENT
APPLICATION PURPOSES ONLY
THE CONTOURS HAVE BEEN DERIVED FROM
AERIAL PHOTOGRAPHY

EUROBODALLA SHIRE COUNCIL
DEVELOPMENT CONSENT
This is the approved plan No. 11/21841
referred to in consent No. 218/11
Dated: 24-2-11
Please note carefully the conditions of consent
some conditions may affect this plan.
This is not a construction certificate

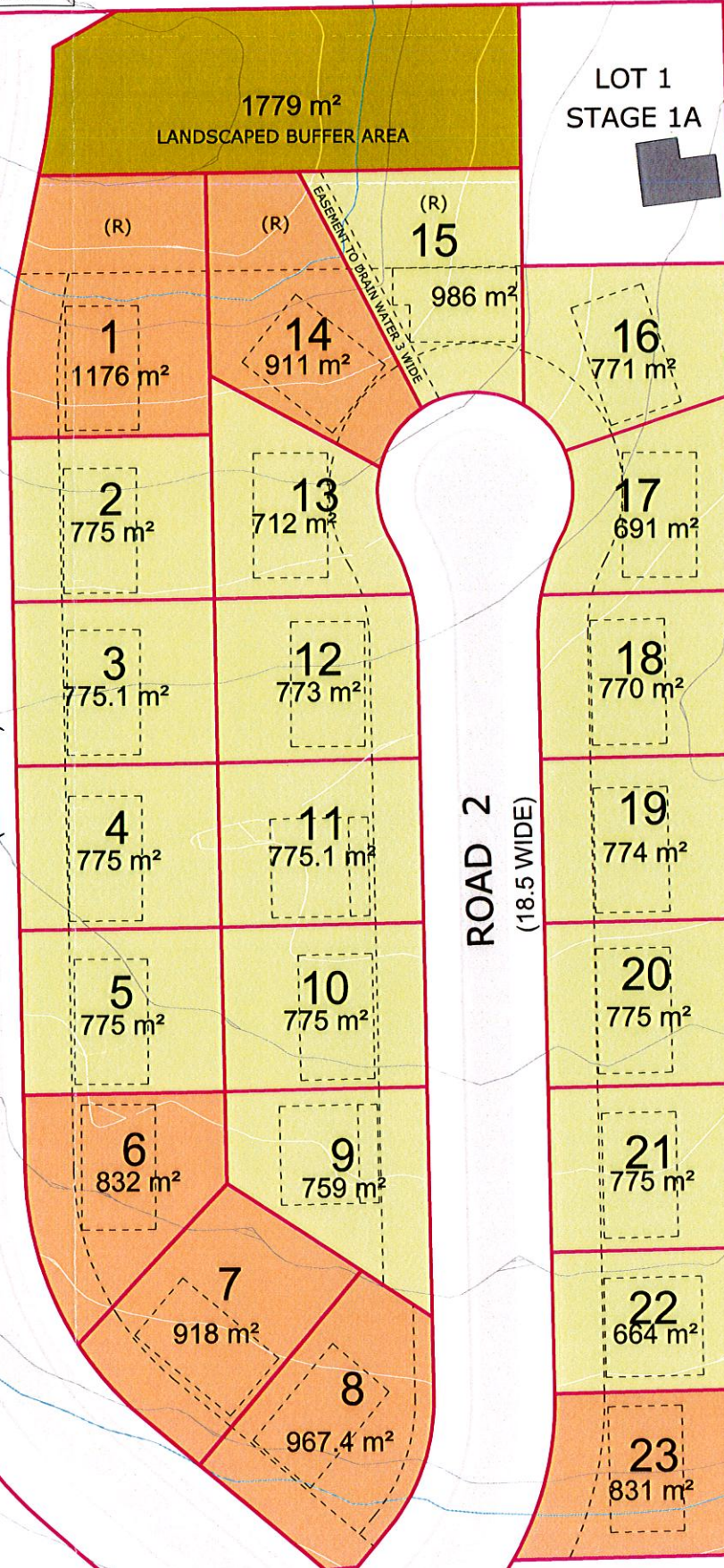

STAGE 1B

