

ARCHAEOLOGICAL & HERITAGE MANAGEMENT SOLUTIONS PTY LTD

ARCHAEOLOGISTS & HERITAGE CONSULTANTS

ACN 088 058 388

ABN 45 088 058 388

AHMS

349 Annandale Street
Annandale NSW 2038
P: (02) 9555 4000
F: (02) 9555 7005
adamp@arksolutions.com.au

25th August 2008

**Redfern-Waterloo Authority
PO Box 3332, Redfern
NSW 2016**

Attn: Joanne McGuinness

Re: Response to Submission – North Eveleigh Concept Plan, June 2008

Dear Joanne,

As requested we have prepared a response to a *Submission to the North Eveleigh Concept Plan* which has identified that the *Environmental Assessment* does not include strategies for management of archaeological remains of the “Grange villa” at the western end of the North Eveleigh Carriageway site.

As requested by the RWA our response includes the following:

1. A review of the *Submission*; and
2. Identify a strategy for managing the potential archaeological remains discussed in the *Submission*.

Review of Submission and its attachments

In regard to the *Submission* we make the following observations:

- The *North Eveleigh Archaeological Zoning Plan (AZP) 2008* prepared by AHMS for the RWA Site was based on existing historical research in the *Draft Eveleigh Carriageways Conservation Management Plan (CMP) Volume 1*¹ and the *Archaeological Assessment of the Eveleigh Carriage Workshops Site*². Historical research presented in these reports was comprehensive and AHMS did not undertake further primary research for the AZP. Despite existing comprehensive historical research presented in the *Draft CMP* and the *Archaeological Assessment* the Grange was not identified as a former building within the site.
- The historical research presented in the attachment to the *Submission* provides useful information regarding the Grange, its designer John Verge a significant 19th Century Architect and its former occupants; of whom Sir William a'Beckett was a significant historical figure. After his ownership and occupation of the Grange William a'Beckett became the Chief Justice of Victoria and was the magistrate presiding over the Eureka Stockade trials.
- This history indicates that the Grange was one of two buildings designed by Verge for David Chambers, the grantee of the land. It also includes a reference to preparation of plans for a basement storey for one of these buildings (but does not specify for which building).

¹ Otto Cserhlami & Partners: 2002

² Austral Archaeology: 2000

- The remains identified and presented in the attachment to the *Submission* may relate to the Grange, however, their fabric is not described and their location is not indicated therefore it is difficult, without further research and inspection to confirm their identity.
- Based on photographs of the remains (provided with the *Submission*) it is possible that they are remains of a vaulted cistern or other structure. Further research and inspection may confirm if this is the case.

As part of our review we have undertaken some limited analysis of the information presented in the *Submission*. This analysis is informed by an overlay of a c1900 Land Title Office plan of the Grange, over a current survey of the site (see attachment 1).

Based on this overlay we make the following points regarding the likely survival of remains of the Grange within the site:

- The difference in level between Wilson Street and the Railway Level in this part of the North Eveleigh site is approximately four metres.
- This difference in level was created by bulk excavation during the Railway occupation of the site and has probably removed most of the remains of the Grange within the area of excavation.
- The embankment adjacent to Wilson Street, where the ground level slopes steeply down to the Railway level (indicated yellow in overlay) is probably the only area with potential to contain some *in situ* remains of the Grange (indicated pink in the overlay).

In summary; while the information included in the attachment is interesting and indicates some remains at the site, further analyses of the historical and/or physical evidence would be required before conclusions regarding the identity, integrity and significance of these remains could be made.

Management Strategy

The management strategy outlined below has been prepared with consideration of the above discussion and general approaches to management and conservation of archaeological heritage.

It is recommended that:

1. An appropriately qualified archaeologist inspects the site to identify and assess the significance and research potential of the remains identified in the *Submission*; and
2. Management of the significance (as identified by inspection) of the remains should be in accordance with any applicable management strategies outlined in the AHMS report *North Eveleigh Railway Carriage Workshops NSW: Historical Archaeological Impact Assessment, Archaeological Zoning Plan and Impact Mitigation Strategy, April 2008*.

Yours Sincerely,

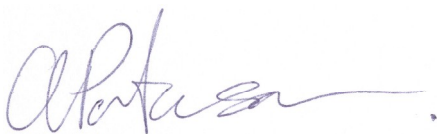

Adam Paterson
Archaeologist

Attachment I

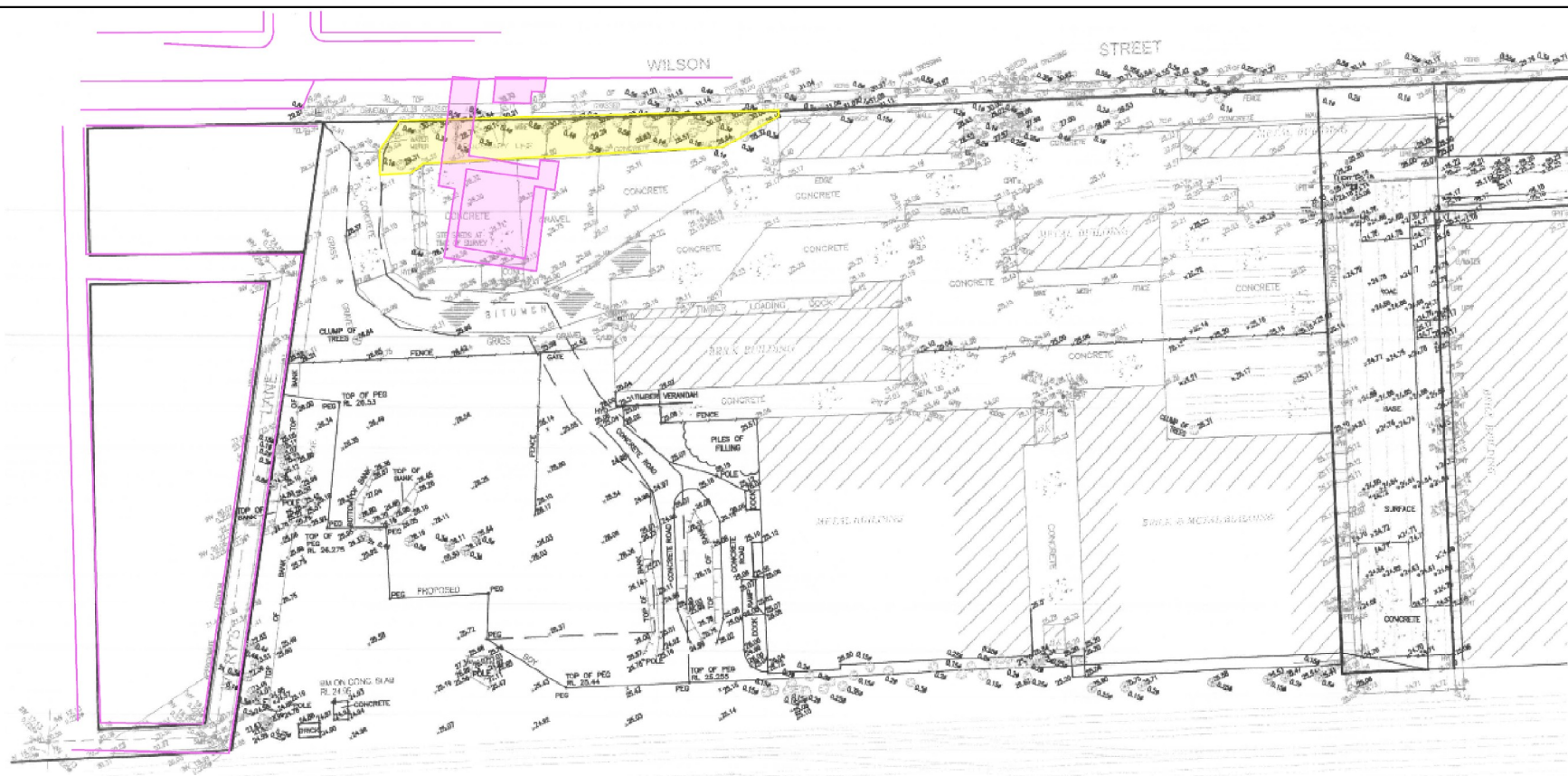

HISTORIC & ABORIGINAL HERITAGE MANAGEMENT

- SURVEY & ASSESSMENT
- CONSERVATION PLANNING
- STRUCTURAL RECORDING
- EXCAVATION & ANALYSIS