

- General Notes
1. Do not scale drawings. Dimensions govern.
  2. All dimensions are in millimetres unless noted otherwise.
  3. All dimensions shall be verified on site before proceeding with the work.
  4. Foster + Partners shall be notified in writing of any discrepancies.
  5. Any areas indicated on this sheet are approximate and indicative only.

Drawing to be read in conjunction with current site grid drawing by Degorardo, Smith & Partners DWG-Nr. 31420A013.dwg Issue E

Position of grid line in relation to existing buildings/road layouts to be checked, verified and confirmed on site prior to construction.

Rev.	Date	Reason For Issue	CHK
05	10/11/14	S7SW Amendments (MOD 10)	RP
04	11/06/14	S7SW Amendments (MOD 9)	RP
03	23/01/14	S7SW Amendments (MOD 8)	RP
02	19/12/12	S7SW Amendments (MOD 8)	RP
01	15/10/08	For Information	
00	13/10/08	For Coordination	

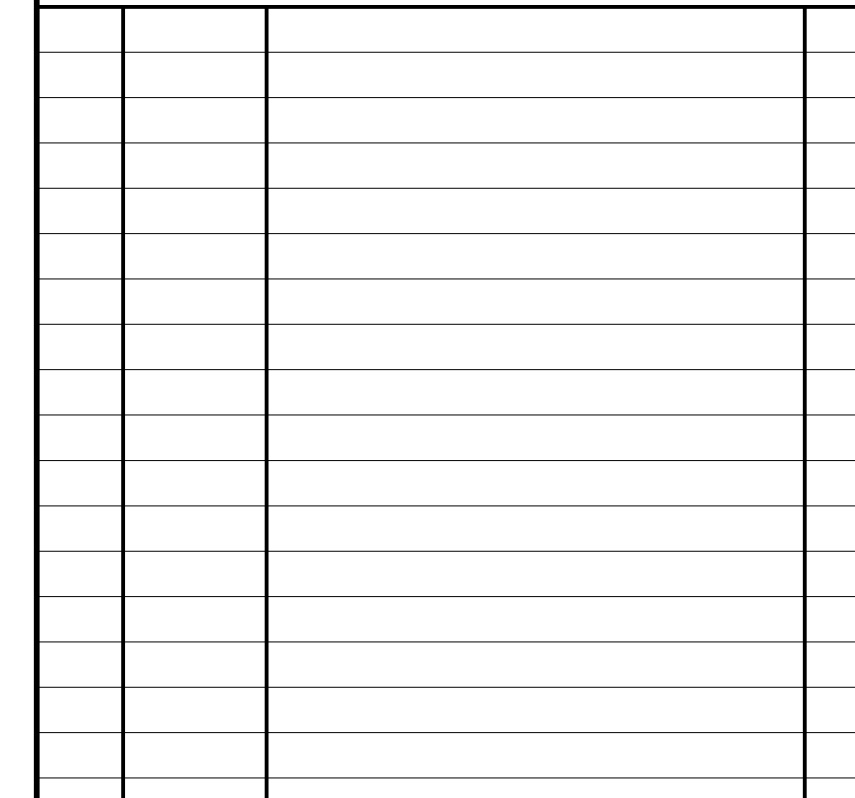

Notes

--- Development boundary

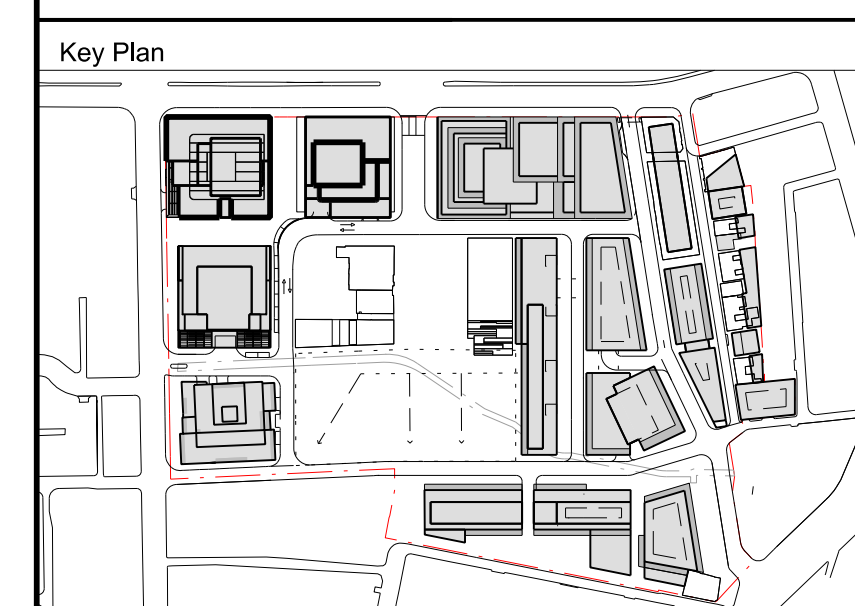

FRASERS PROPERTY

Project Frasers Broadway  
20 - 102 Broadway Sydney NSW 2000

Client Frasers Broadway  
L11, 458 Kent Street Sydney NSW 2000  
T: 02 8823 8800 F: 02 8823 8801

Architect  
**Foster + Partners**  
Riverside, 22 Hoster Road  
London SW11 6AN  
T +44 (0)20 7738 0455  
F +44 (0)20 7738 1107

Local Collaborating Architect  
**PTW Architects**  
Level 17, 9 Castlereagh St  
Sydney NSW 2000 Australia  
T +61 (0)2 92325877  
F +61 (0)2 9221 4139  
www.ptw.com.au

Title  
**Master Plan  
Site Set Out Plan**

Project No.	Scale @ A0	Date	Drawn By
1645	1:500	30/06/08	
Number	Revision		
A-1030	05		