

01 Section  
1:250

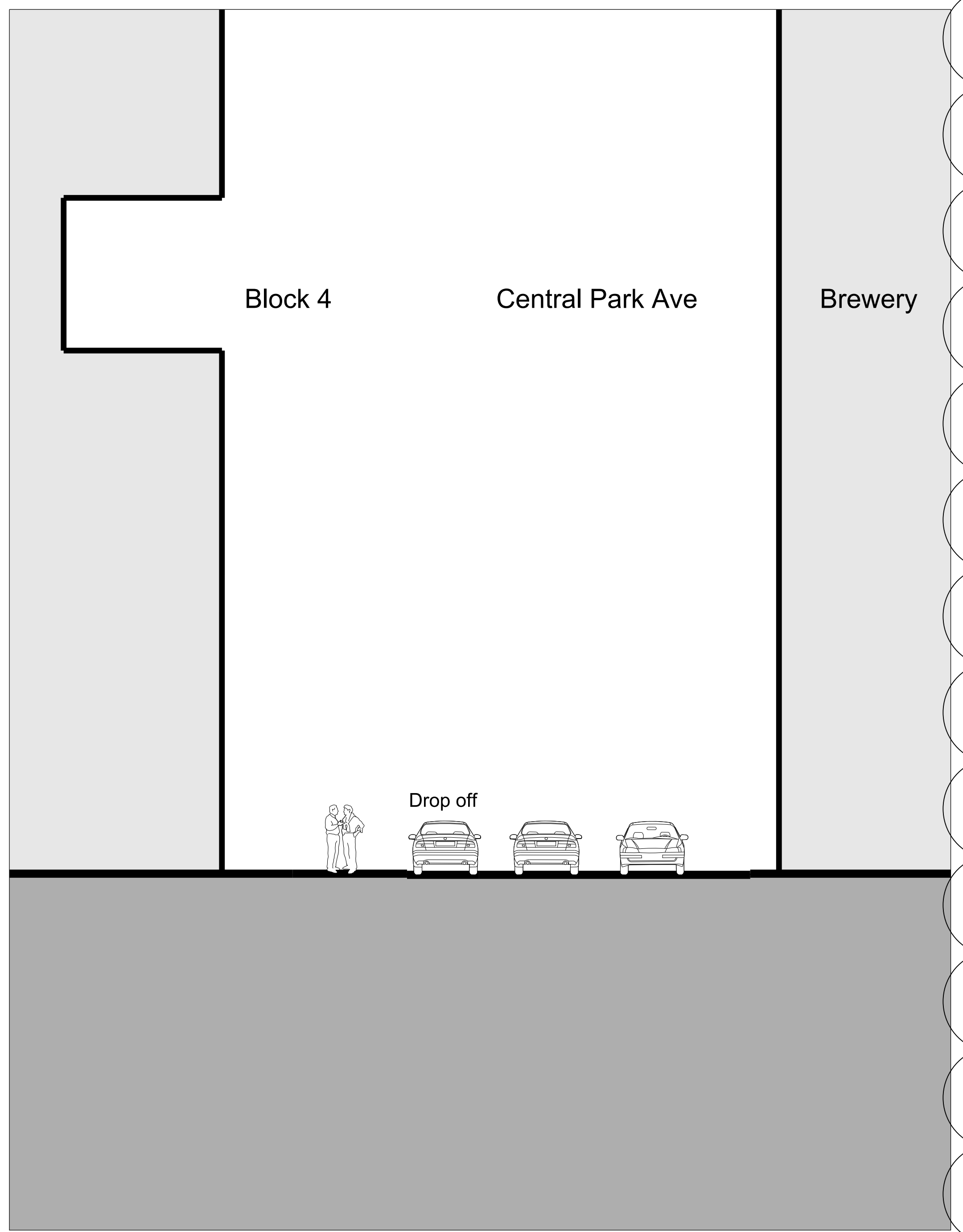

02 Section  
1:250

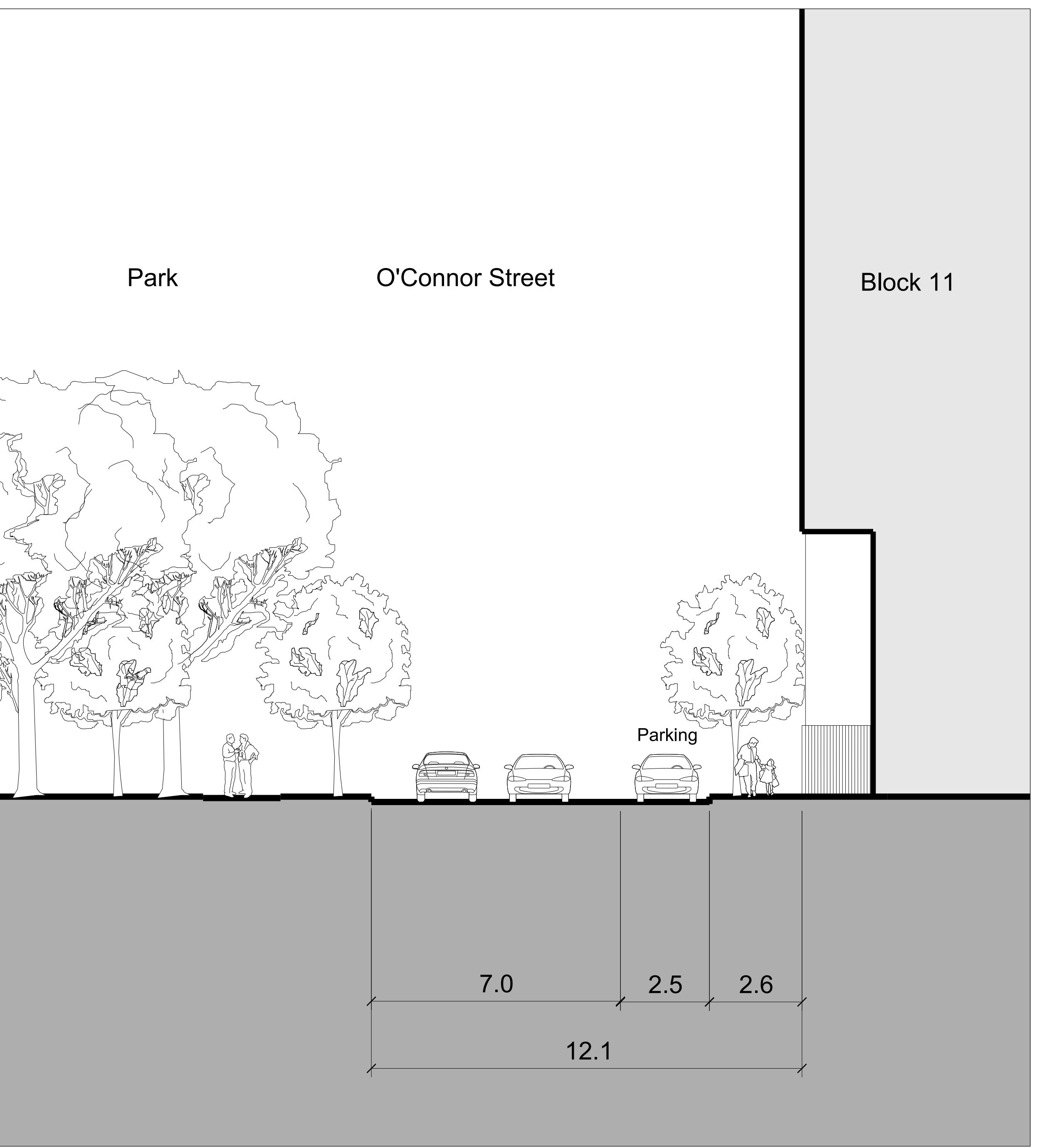

03 Section  
1:250

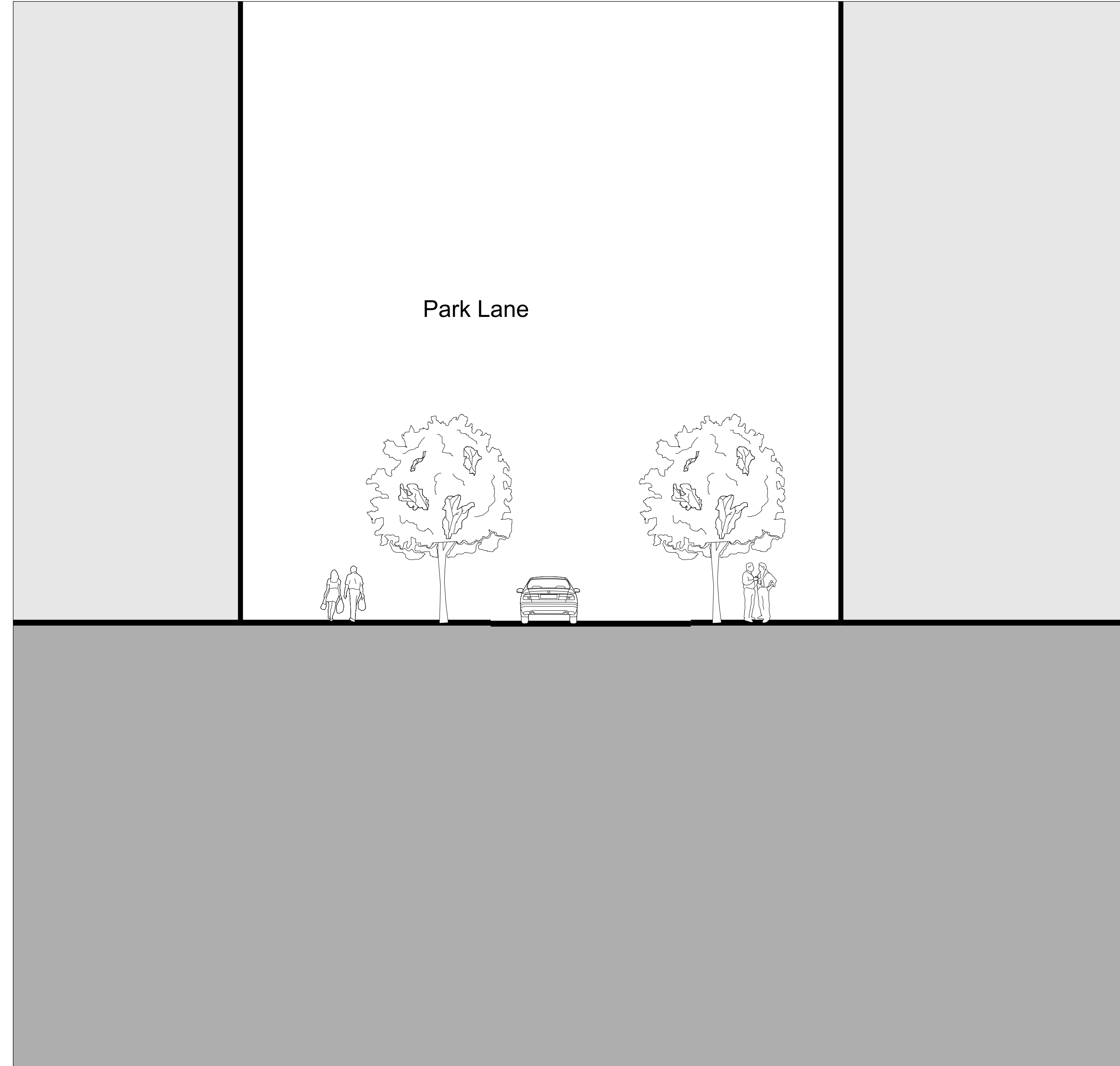

04 Section  
1:250

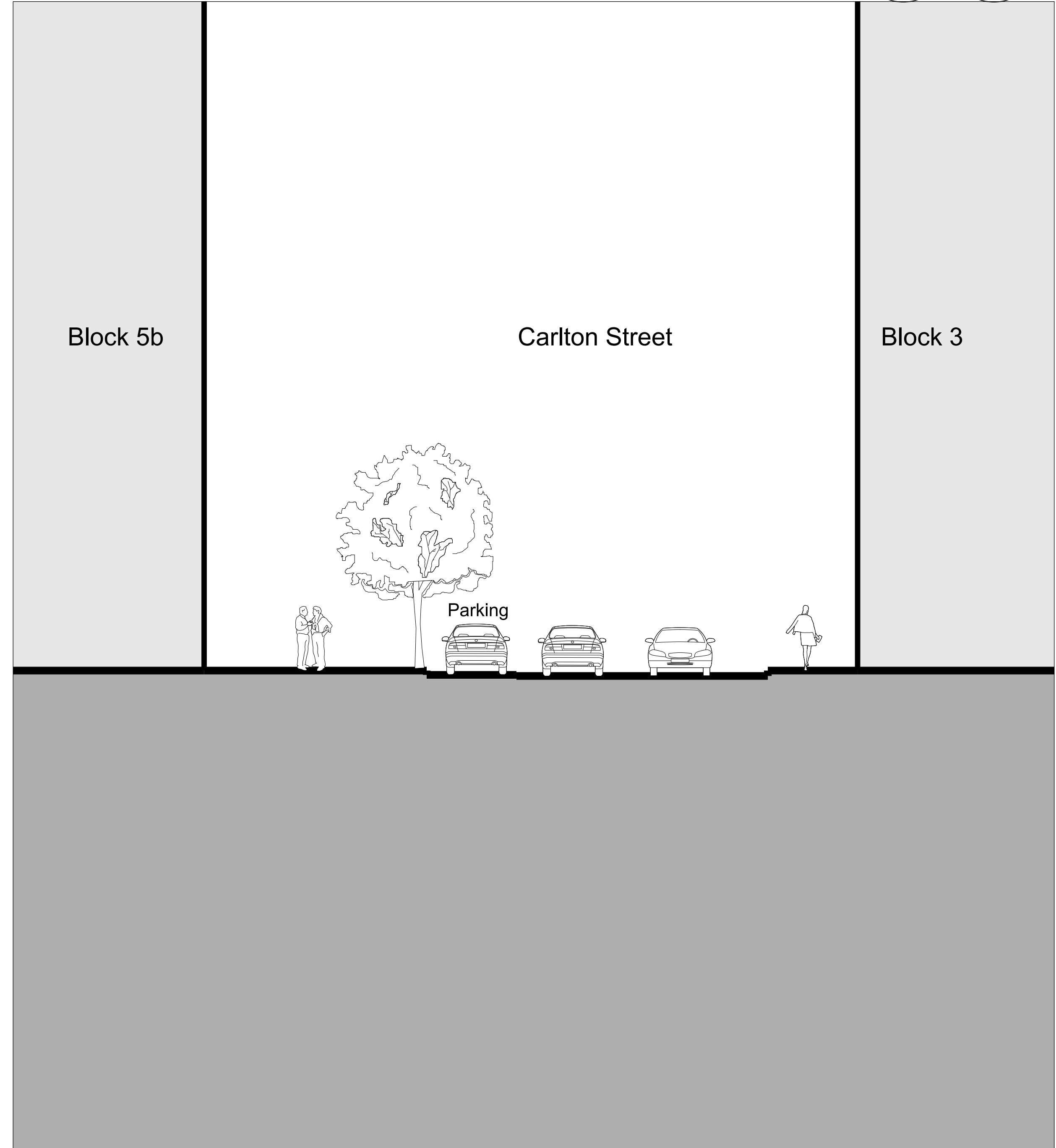

05 Section  
1:250

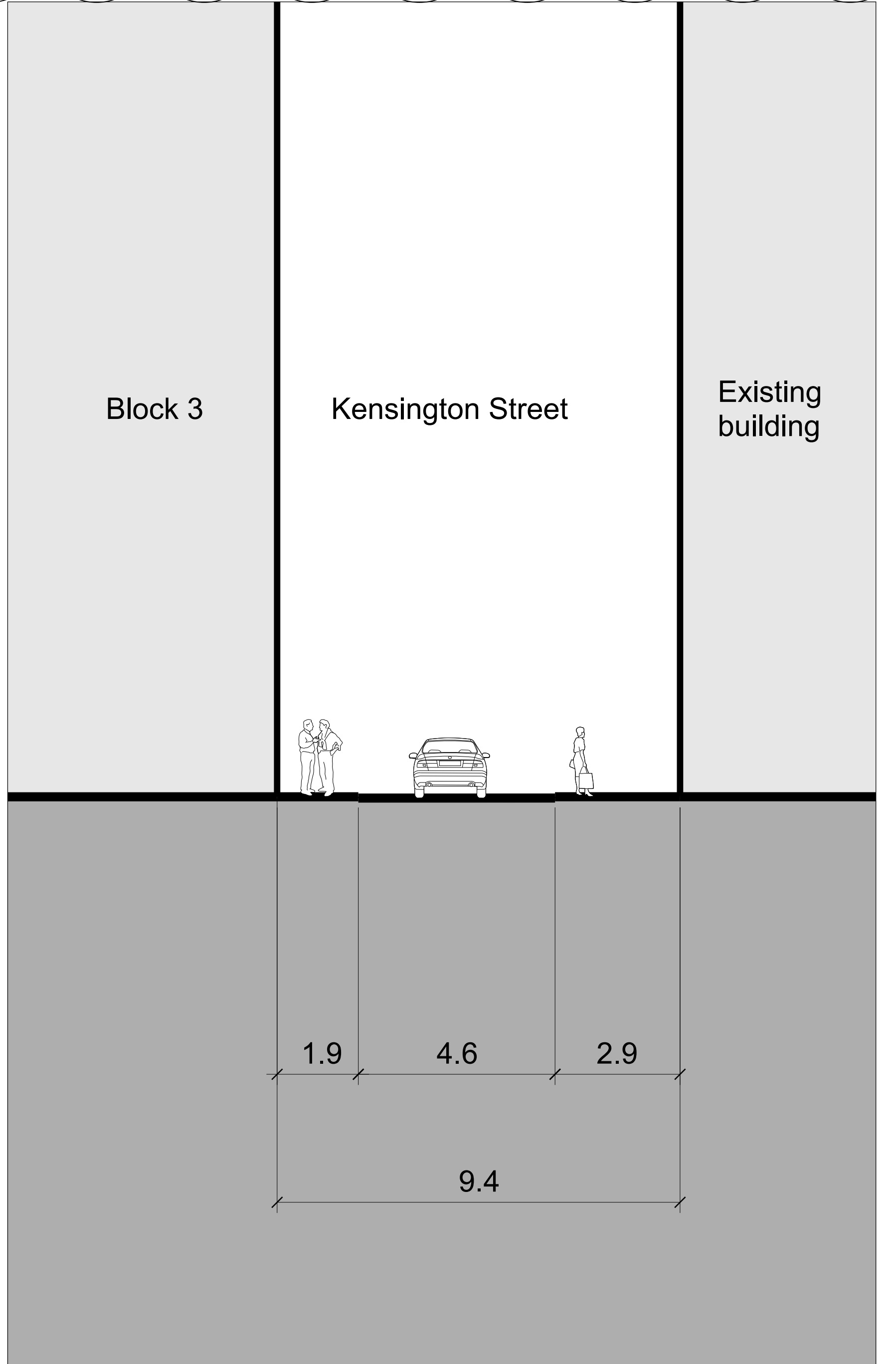

06 Section  
1:250

General Notes

- Do not scale drawings. Dimensions govern.
- All dimensions are in meters unless noted otherwise.
- All dimensions shall be verified on site before proceeding work.
- Foster + Partners shall be notified in writing of any discrepancies.

Rev.	Date	Reason For Issue	Ck
09	03/12/14	S75W Amendments (MOD 11)	RP
08	10/11/14	S75W Amendments (MOD 10)	RP
07	23/01/14	S75W Amendments (MOD 9)	RP
06	19/12/12	S75W Amendments (MOD 8)	RP
05	16/10/08	Submission DoP	
04	16/10/08	Submission DoP	
03	15/05/08	Submission DoP	
02	30/04/08	Submission amended CP	
01	21/04/08	Submission amended concept plan	
00	07/04/08	Final coordination	

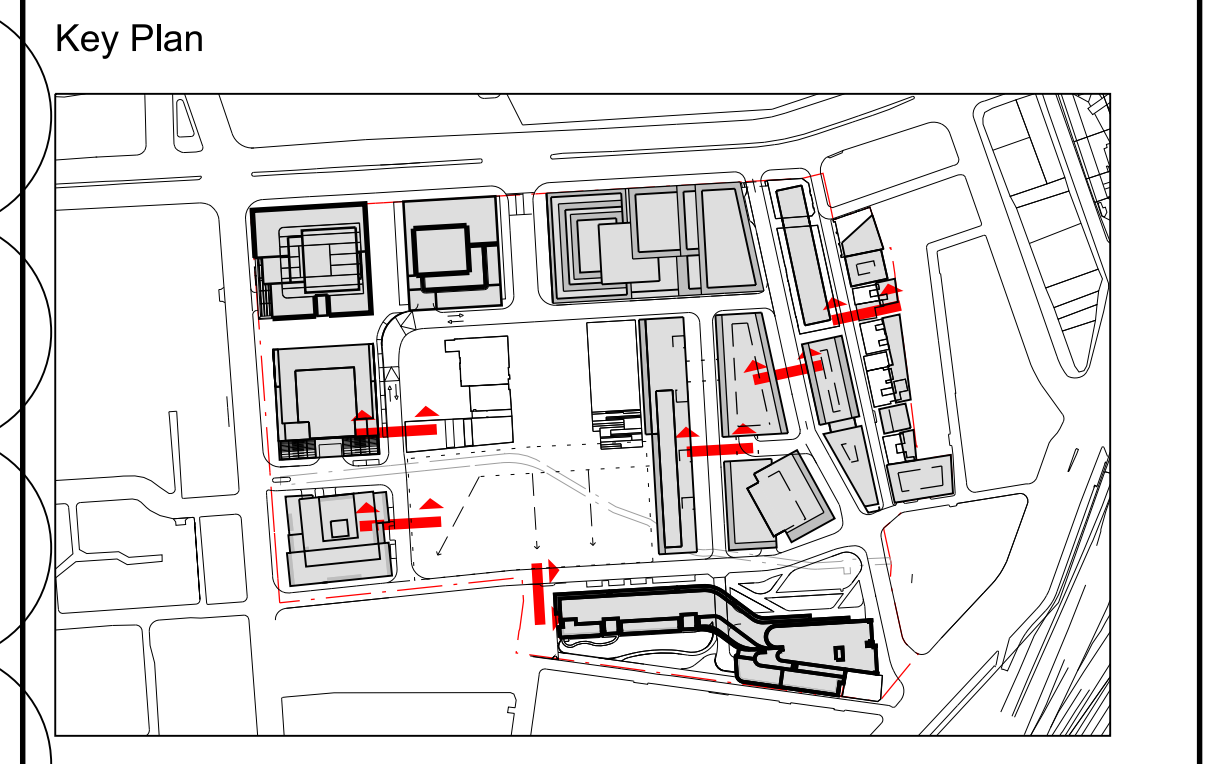

Notes

FOR SECTION LINES REFER TO A-1258

**FRASERS PROPERTY**

Project Frasers Broadway  
20 - 102 Broadway Sydney NSW 2000

Client Frasers Broadway  
L11, 488 Kent Street Sydney NSW 2000  
T: 02 8823 8800 F: 02 8823 8801

**Foster + Partners**

Riverside, 22 Hester Road  
London SW11 4AN  
T +44 (0)20 7738 0455  
F +44 (0)20 7738 1107

Title  
**Concept Plan  
Street Sections 2**

Project No.	Scale @ A3	Date	Drawn By
1645	1:250	07/04/08	
Number	Revision		
<b>A-1459</b>			<b>09</b>