

Rev.	Date	Reason For Issue	CK
12	14/05/13	SSDA Comments	
11	19/12/12	S75W Amendments (MOD 8)	RP
10	04/12/08	Submission DoP	
09	16/10/08	Submission DoP	
08	15/10/08	Submission DoP	
07	14/10/08	Submission DoP	
06	04/07/08	Submission DoP, Block 3+10 amended	
05	27/05/08	Submission amended DoP	
04	15/05/08	Submission DoP	
03	07/05/08	Submission amended CP	
17	28/11/14	S75W Amendments (MOD 11)	RP
16	10/11/14	S75W Amendments (MOD 10)	RP
15	23/01/14	S75W Amendments (MOD 9)	RP
14	23/05/13	Clouds Added	
13	20/05/13	SSDA Comments	

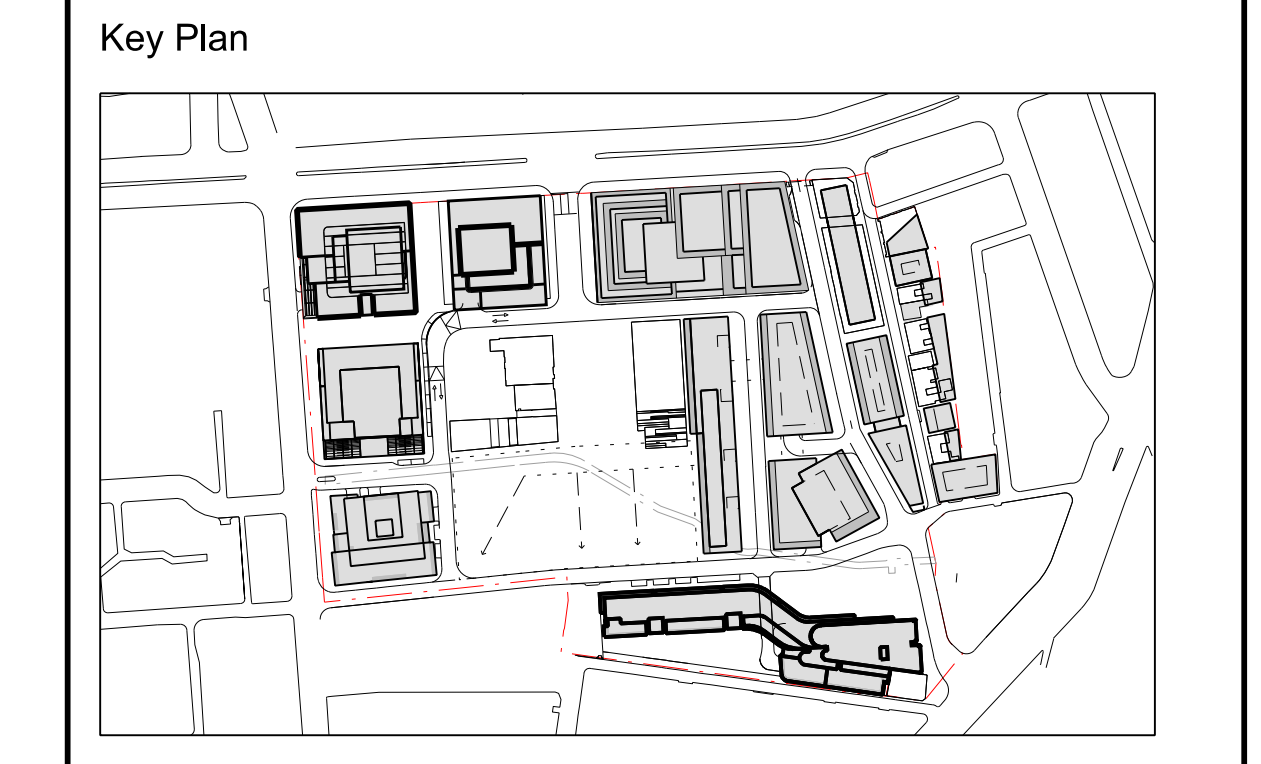

Notes

	Non Habitable Rooms
	Residential
	Non Residential
	Heritage Buildings
	Residential above 25m
	Indicative Building Development
	Possible Building Link
	Maximum building envelope
	Retail Zone

General Notes
 1. Do not scale drawings. Dimensions govern.
 2. All dimensions are in meters unless noted otherwise.
 3. All dimensions shall be verified on site before proceeding work.
 4. Foster + Partners shall be notified in writing of any discrepancies.

FRASERS PROPERTY

Project Frasers Broadway
 20 - 102 Broadway Sydney NSW 2000

Client Frasers Broadway
 L11, 488 Kent Street Sydney NSW 2000
 T: 02 8823 8800 F: 02 8823 8801

Foster + Partners

Riverside, 22 Hester Road
 London SW11 4AN
 T +44 (0)20 7738 0455
 F +44 (0)20 7738 1107

Title
**Concept Plan
 Residential Flat Design Code
 Distances between Buildings**

Project No. 1645	Scale @ A3 1:1000	Date 14/03/08	Drawn By
Number A-1290	Revision 17		