

12	29/06/12	For information	RP
11	05/05/09	Submission DoP - Condition A9	
10	04/12/08	Submission DoP	
09	17/10/08	Submission DoP	
08	15/10/08	Submission DoP	
07	14/10/08	Submission DoP	
06	04/07/08	Submission DoP, Block 3+10 amended	
05	27/05/08	Submission amended DoP	
04	15/05/08	Submission DoP	
03	07/05/08	Submission amended CP	
02	30/04/08	Submission amended CP	

16	28/11/14	S75W Amendments (MOD 11)	RP
15	10/11/14	S75W Amendments (MOD 10)	RP
14	23/01/14	S75W Amendments (MOD 9)	RP
13	19/12/12	S75W Amendments (MOD 8)	RP

Rev.	Date	Reason For Issue	Ck
------	------	------------------	----

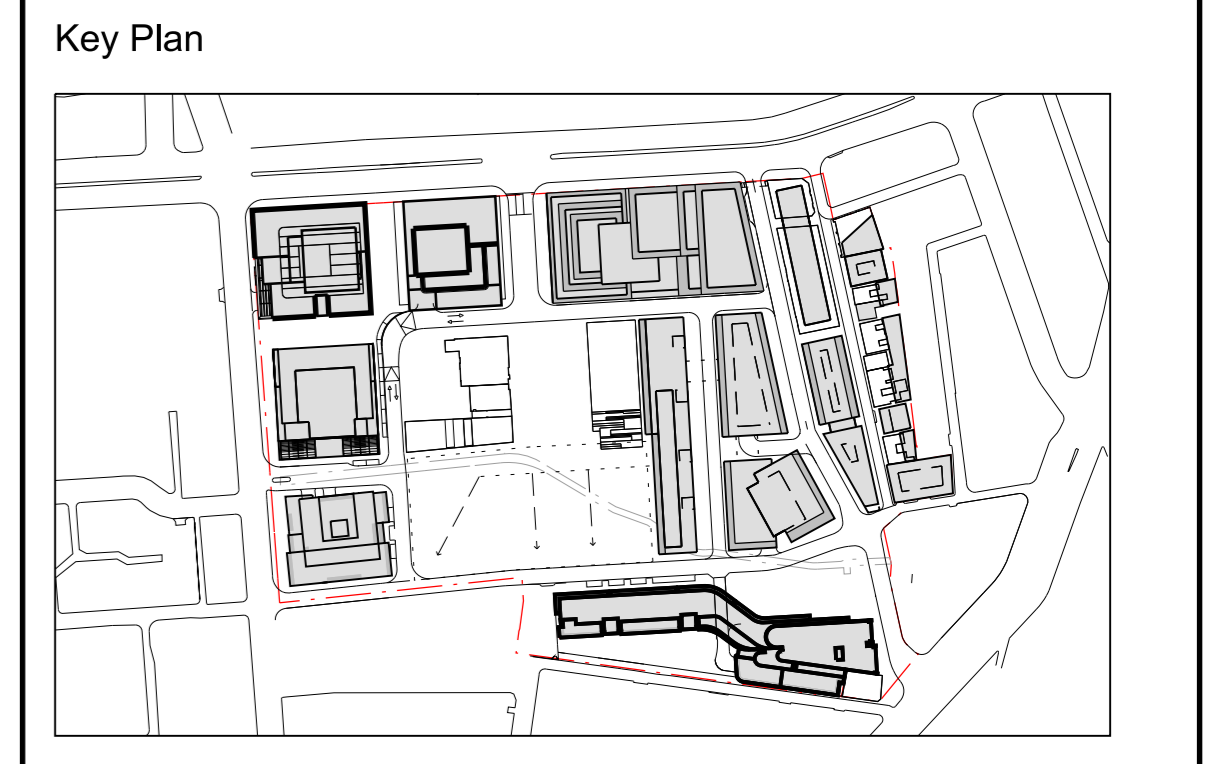

Notes

max. EH	Maximum eaves height zone
[Grey fill]	Balcony Zone/ Articulated Facade Zone
[Red dashed line]	Development boundary
[Grey fill]	Roof
[Blue dashed line]	City Datum Zone
	The Datum Line should match surrounding building heights.
	i.e. Block 2 > height existing gate - approx. 2 floors (as discussed at the workshop in London and in the following VC in March)
	Block 1-4 > height of the Australian Hotel.
	EH = External Height
	AHD = Australian Height Datum
[Dotted line]	Possible building connection
[Dashed line]	Indicative Roof Plant
[Blue dashed line]	Indicative Building Development

- General Notes
- Do not scale drawings. Dimensions govern.
  - All dimensions are in meters unless noted otherwise.
  - All dimensions shall be verified on site before proceeding work.
  - Foster + Partners shall be notified in writing of any discrepancies.

**FRASERS PROPERTY**

Project Frasers Broadway  
20 - 102 Broadway Sydney NSW 2000

Client Frasers Broadway  
L11, 488 Kent Street Sydney NSW 2000  
T: 02 8923 8800 F: 02 8923 8801

**Foster + Partners**

Riverside, 22 Hester Road  
London SW11 4AN  
T +44 (0)20 7738 0455  
F +44 (0)20 7738 1107

Title  
**Concept Plan  
Roof Plan  
Maximum Building Height (AHD)**

Project No.	Scale @ A3	Date	Drawn By
1645	1:1000	14/03/08	
Number	Revision		
A-1262	16		