

**01 View**  
South West

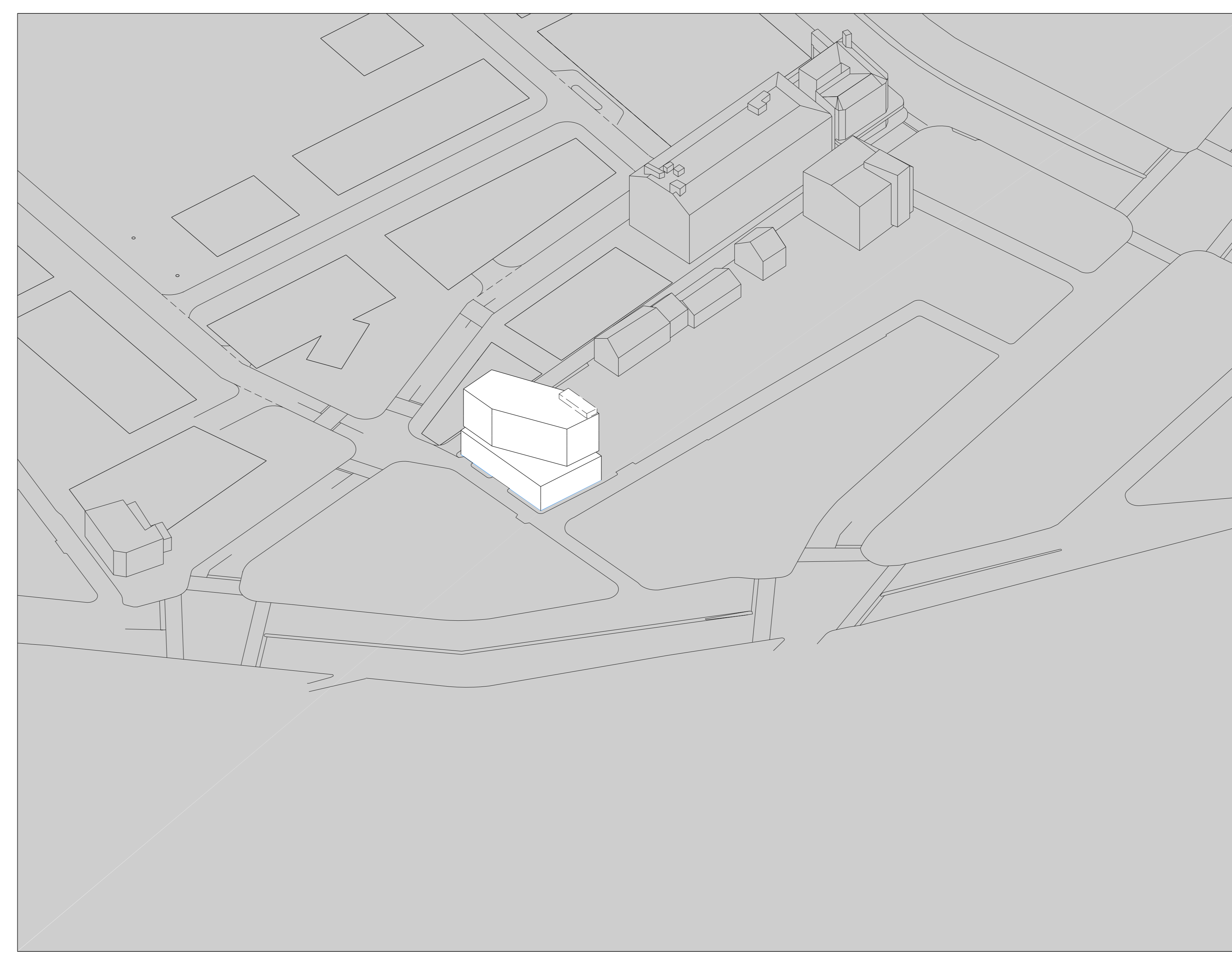

**02 View**  
South East

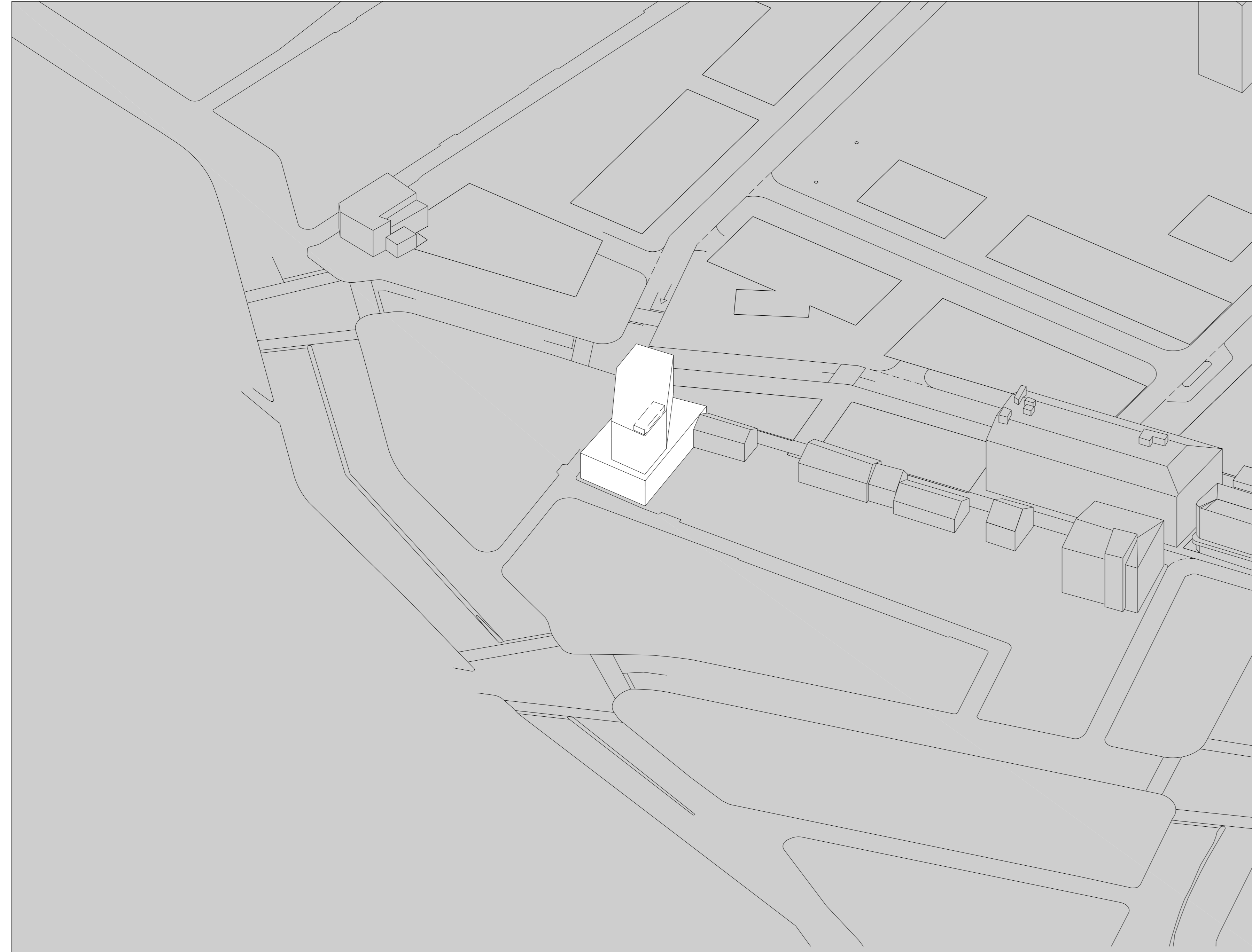

**03 View**  
North East

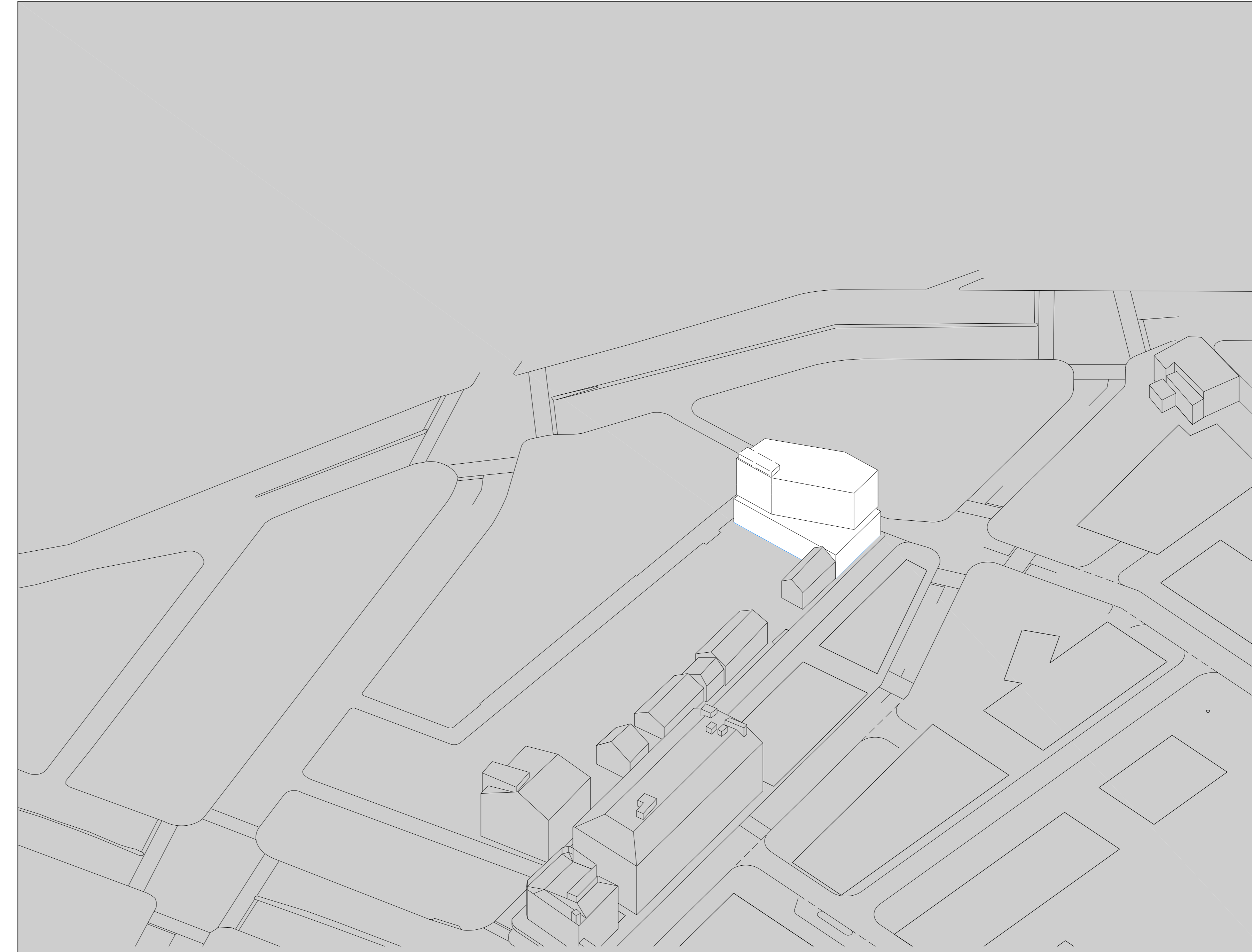

**04 View**  
North West

General Notes

1. Do not scale drawings. Dimensions govern.
2. All dimensions are in meters unless noted otherwise.
3. All dimensions shall be verified on site before proceeding work.
4. Foster + Partners shall be notified in writing of any discrepancies.

Rev.	Date	Reason For Issue	Ck
09	03/12/14	S75W Amendments (MOD 11)	RP
08	10/11/14	S75W Amendments (MOD 10)	RP
07	23/01/14	S75W Amendments (MOD 9)	RP
06	14/10/08	Submission DoP	
05	04/07/08	Submission DoP, Block 3+10 amended	
04	27/05/08	Submission amended DoP	
03	15/05/08	Submission DoP	
02	30/04/08	Submission amended CP	
01	21/04/08	Submission amended concept plan	
00	07/04/08	Final coordination	
-	31/03/08	For information (90% issue)	
-	19/03/08	For information (80% issue)	
-	14/03/08	For information (40% issue)	

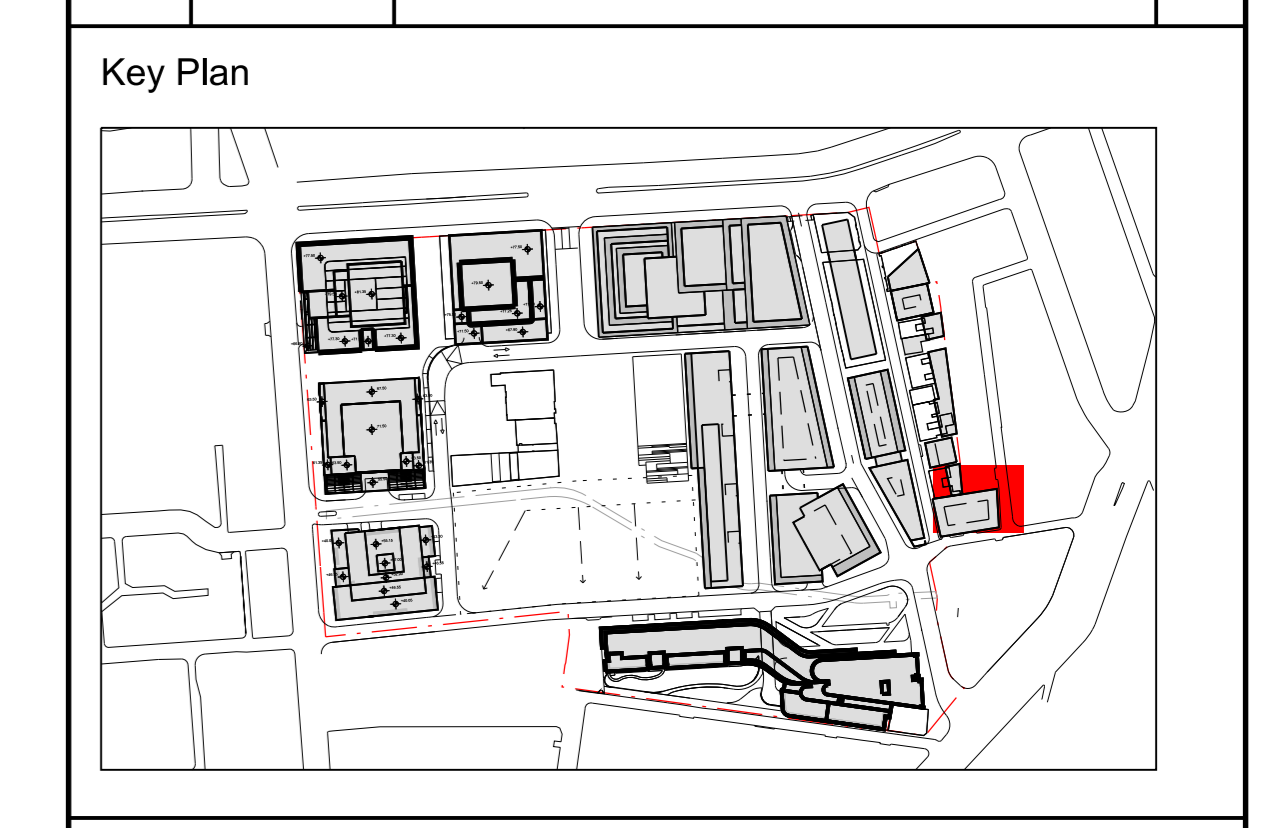

Notes

---	Possible Roof Plant
---	Balcony Zone

**FRASERS PROPERTY**

Project Frasers Broadway  
20 - 102 Broadway Sydney NSW 2000

Client Frasers Broadway  
L11, 488 Kent Street Sydney NSW 2000  
T: 02 8823 8800 F: 02 8823 8801

**Foster + Partners**

Riverside, 22 Hester Road  
London SW11 4AN  
T +44 (0)20 7738 0455  
F +44 (0)20 7738 1107

Title  
**Concept Plan  
Plot Block 10**

Project No. <b>1645</b>	Scale @ A3 <b>NTS</b>	Date <b>14/03/08</b>	Drawn By
Number <b>A-1310</b>			Revision <b>09</b>