

01 14 April
12pm



02 14 April
1pm



03 14 April
2pm

General Notes
 1. Do not scale drawings. Dimensions govern.
 2. All dimensions are in meters unless noted otherwise.
 3. All dimensions shall be verified on site before proceeding work.
 4. Foster + Partners shall be notified in writing of any discrepancies.
 5. Australian Eastern Time Zone: UTC/GMT +10 hours

Rev.	Date	Reason For Issue	Ck
09	03/12/14	S75W Amendments (MOD 11)	RP
08	10/11/14	S75W Amendments (MOD 10)	RP
07	23/01/14	S75W Amendments (MOD 9)	RP
06	19/12/12	S75W Amendments (MOD 8)	RP
05	14/10/08	Submission DoP	
04	27/05/08	Submission amended DoP	
03	15/05/08	Submission DoP	
02	30/04/08	Submission Amended CP	
01	21/04/08	Submission amended concept plan	
00	07/04/08	Final coordination	

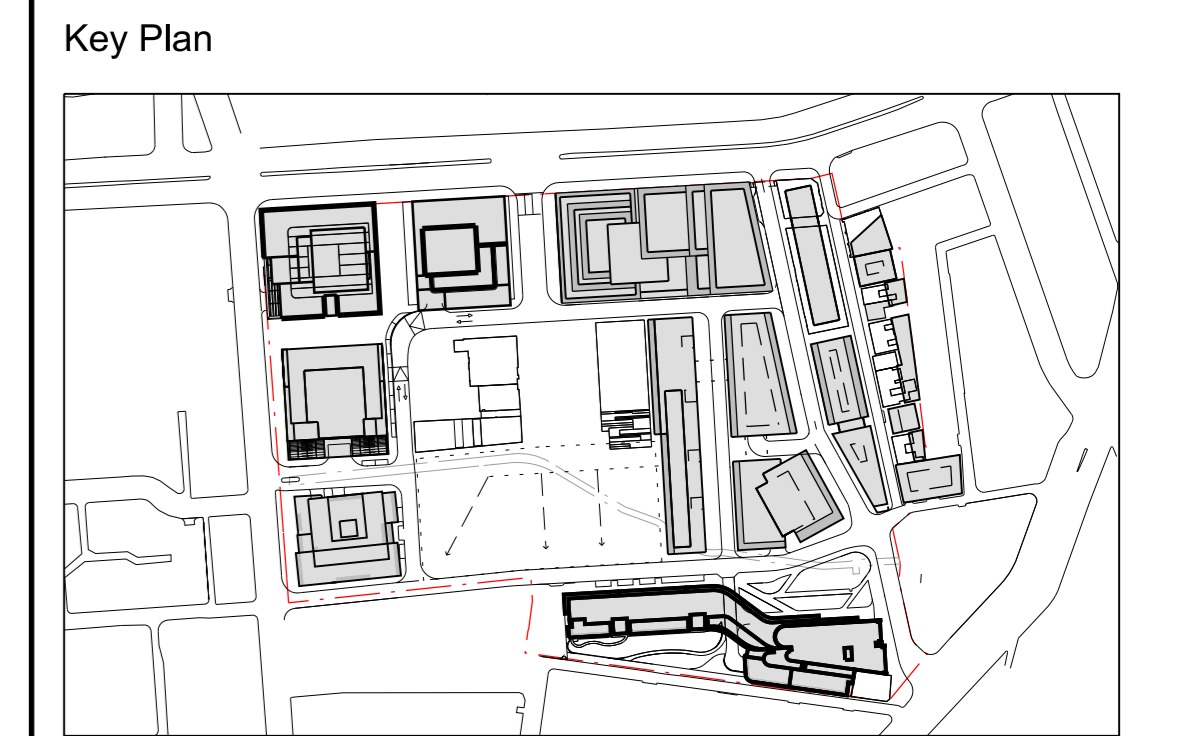

- Notes
- Shadow line of Concept Plan Envelope (MOD10)
 - Additional SUNLIGHT to masterplan in comparison to MOD10 application
 - Additional SHADOW to masterplan in comparison to MOD10 application

NOTE: shadow study and comparison indicative only. All areas are to be confirmed by a specialist consultant

FRASERS PROPERTY

Project Frasers Broadway
 20 - 102 Broadway Sydney NSW 2000
 Client Frasers Broadway
 L11, 488 Kent Street Sydney NSW 2000
 T: 02 8823 8800 F: 02 8823 8801

Foster + Partners

Riverside, 22 Hester Road
 London SW11 4AN
 T +44 (0)20 7738 0455
 F +44 (0)20 7738 1107

Title
**Concept Plan
 Shadow Studies 2**

Project No.	Scale @ A3	Date	Drawn By
1645	NTS	14/03/08	
Number	Revision		
A-1296			09