

General Notes

- Do not scale drawings. Dimensions govern.
- All dimensions are in meters unless noted otherwise.
- All dimensions shall be verified on site before proceeding work.
- Foster + Partners shall be notified in writing of any discrepancies.

Rev.	Date	Reason For Issue	Ck
09	19/12/12	S75W Amendments (MOD 8)	RP
08	16/10/08	Submission DoP	
07	15/10/08	Submission DoP	
06	14/10/08	Submission DoP	
05	27/05/08	Submission amended DoP	
04	15/05/08	Submission DoP	
03	07/05/08	Submission amended CP	
02	30/04/08	Submission amended CP	
13	28/11/14	S75W Amendments (MOD 11)	RP
12	10/11/14	S75W Amendments (MOD 10)	RP
11	23/01/14	S75W Amendments (MOD 9)	RP
10	22/05/13	SSDA Comments	

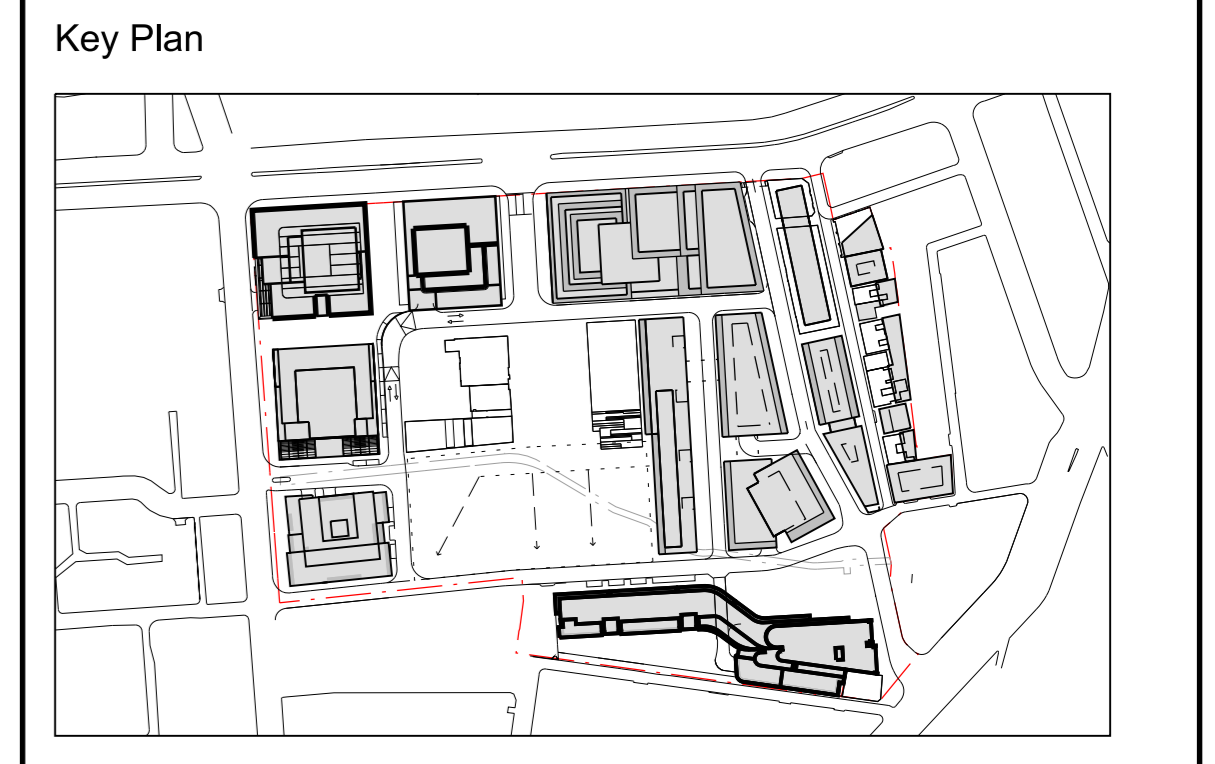

Notes

- Proposed off-road/ shared paths
- Proposed city council cycle route 20
- Proposed shared traffic lane
- Main Pedestrian Way
- Existing Controlled Pedestrian Crossing
- New Controlled Pedestrian Crossing
- Uncontrolled Pedestrian Crossing
- Raised levels for flood defence
- Possible pedestrian link

FRASERS PROPERTY

Project Frasers Broadway
20 - 102 Broadway Sydney NSW 2000

Client Frasers Broadway
L11, 488 Kent Street Sydney NSW 2000
T: 02 8823 8800 F: 02 8823 8801

Foster + Partners

Riverside, 22 Hester Road
London SW11 4AN
T +44 (0)20 7738 0455
F +44 (0)20 7738 1107

Title
**Concept Plan
Traffic
Pedestrian and Cycle Routes**

Project No.	Scale @ A3	Date	Drawn By
1645	1:1000	14/03/08	
Number	Revision		
A-1256	13		

