

- General Notes
1. Do not scale drawings. Dimensions govern.
 2. All dimensions are in millimetres unless noted otherwise.
 3. All dimensions shall be verified on site before proceeding with the work.
 4. Foster + Partners shall be notified in writing of any discrepancies.
 5. Any areas indicated on this sheet are approximate and indicative only.

Drawing to be read in conjunction with current site grid drawing by Degorardo, Smith & Partners DWG-Nr. 31420A013.dwg Issue E

Position of grid line in relation to existing buildings/road layouts to be checked, verified and confirmed on site prior to construction.

Rev.	Date	Reason For Issue	CHK
06	28/11/14	S75W Amendments (MOD 11)	RP
05	10/11/14	S75W Amendments (MOD 10)	RP
04	11/06/14	S75W Amendments (MOD 9)	RP
03	23/01/14	S75W Amendments (MOD 8)	RP
02	19/12/12	S75W Amendments (MOD 8)	RP
01	15/10/08	For Information	
00	13/10/08	For Coordination	

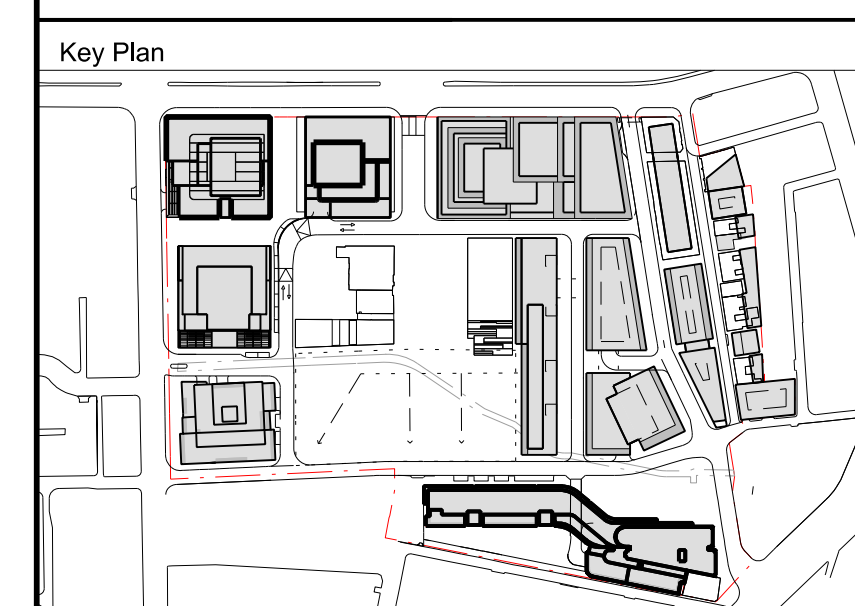

Notes

--- Development boundary

FRASERS PROPERTY

Project Frasers Broadway
20 - 102 Broadway Sydney NSW 2000

Client Frasers Broadway
L11, 488 Kent Street Sydney NSW 2000
T: 02 8823 8800 F: 02 8823 8801

Architect
Foster + Partners
Riverside, 22 Hoster Road
London SW11 4AN
T +44 (0)20 7738 0455
F +44 (0)20 7738 1107

Local Collaborating Architect
PTW Architects
Level 17, 9 Castlereagh St
Sydney NSW 2000 Australia
T +61 (0)2 92325877
F +61 (0)2 9221 4139
www.ptw.com.au

Title
**Master Plan
Site Set Out Plan**

Project No.	Scale @ A0	Date	Drawn By
1645	1:500	30/06/08	
Number	Revision		
A-1030	06		