

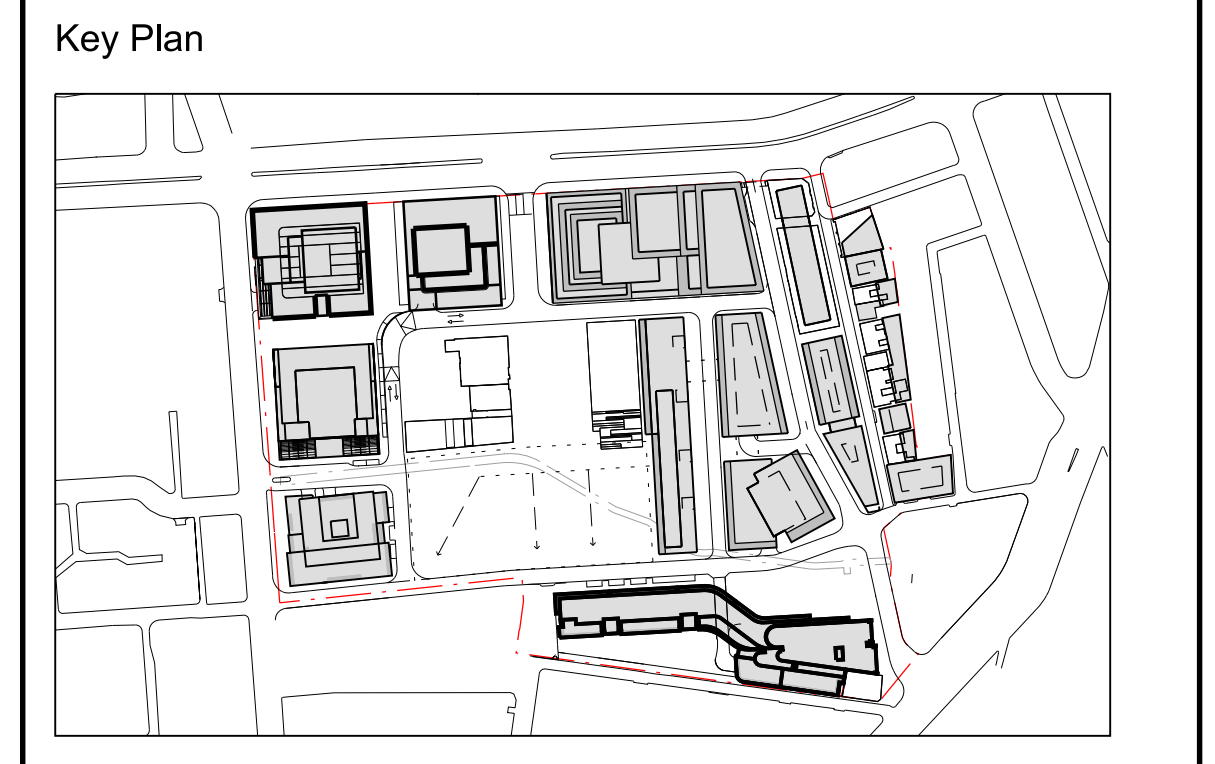

General Notes

- Do not scale drawings. Dimensions govern.
- All dimensions are in meters unless noted otherwise.
- All dimensions shall be verified on site before proceeding work.
- Foster + Partners shall be notified in writing of any discrepancies.

Rev.	Date	Reason For Issue	Ck
10	19/12/12	S75W Amendments (MOD 8)	RP
09	19/12/12	S75W Amendments (MOD 8)	RP
08	16/10/08	Submission DoP	
07	15/10/08	Submission DoP	
06	14/10/08	Submission DoP	
05	27/05/08	Submission amended DoP	
04	15/05/08	Submission DoP	
03	07/05/08	Submission amended CP	
14	28/11/14	S75W Amendments (MOD 11)	RP
13	10/11/14	S75W Amendments (MOD 10)	RP
12	23/01/14	S75W Amendments (MOD 9)	RP
11	24/01/13	MP06_0171 S75W MOD 8 Clarifications	ML



Notes

	Minor Streets, Low Traffic, 6m Wide
	Minor Streets, Low Traffic, < 6m
	Streets 7-8m Wide
	Streets 8-15m Wide
	Parking lots
	Site boundary
	Development boundary

**FRASERS PROPERTY**

Project Frasers Broadway  
20 - 102 Broadway Sydney NSW 2000

Client Frasers Broadway  
L11, 488 Kent Street Sydney NSW 2000  
T: 02 8823 8800 F: 02 8823 8801

**Foster + Partners**

Riverside, 22 Hester Road  
London SW11 4AN  
T +44 (0)20 7738 0455  
F +44 (0)20 7738 1107

Title  
**Concept Plan  
Road Width**

Project No.	Scale @ A3	Date	Drawn By
1645	1:1000	19/03/08	
Number	Revision		
A-1258	14		

