

01 Section  
1:250

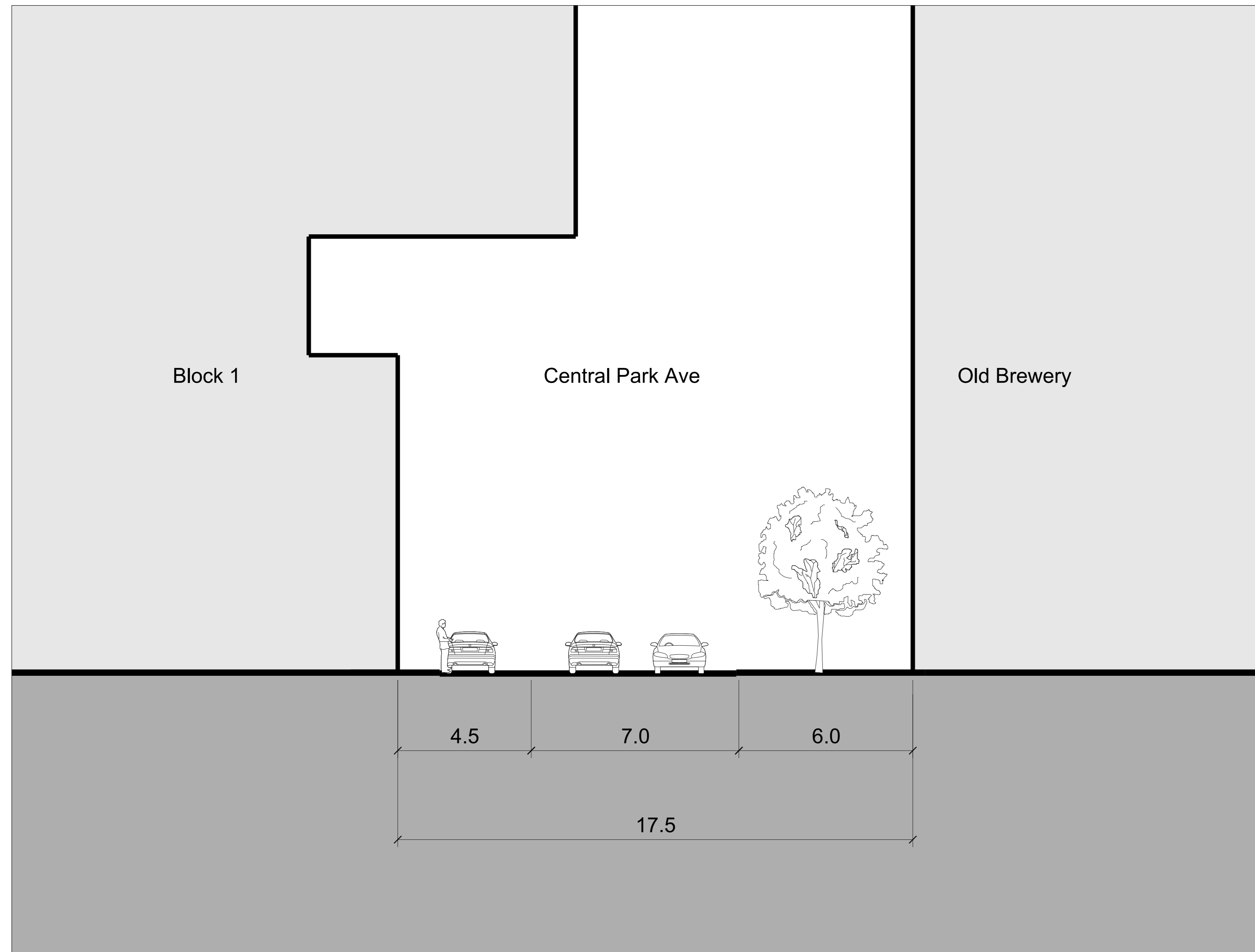

03 Section  
1:250

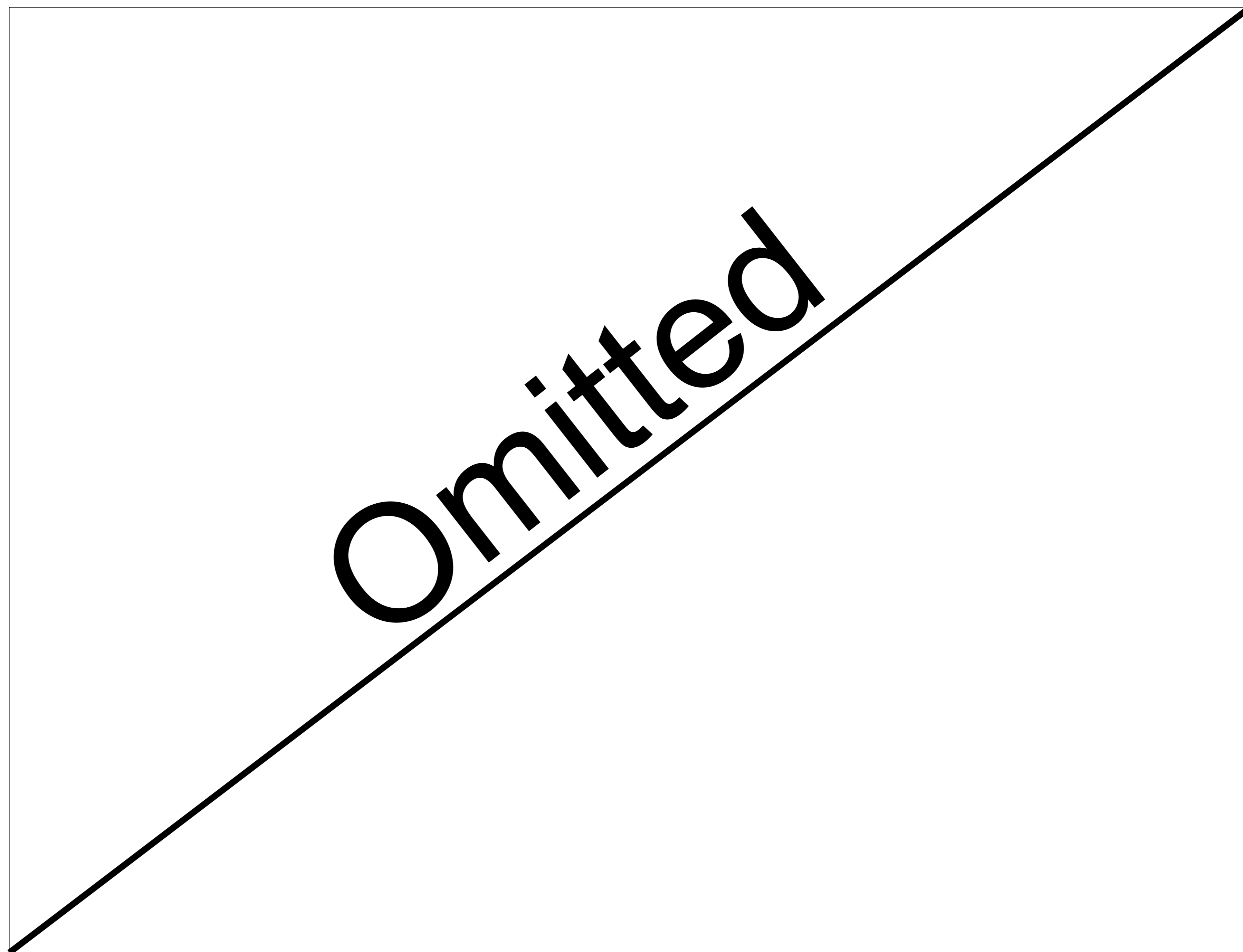

02 Section  
1:250

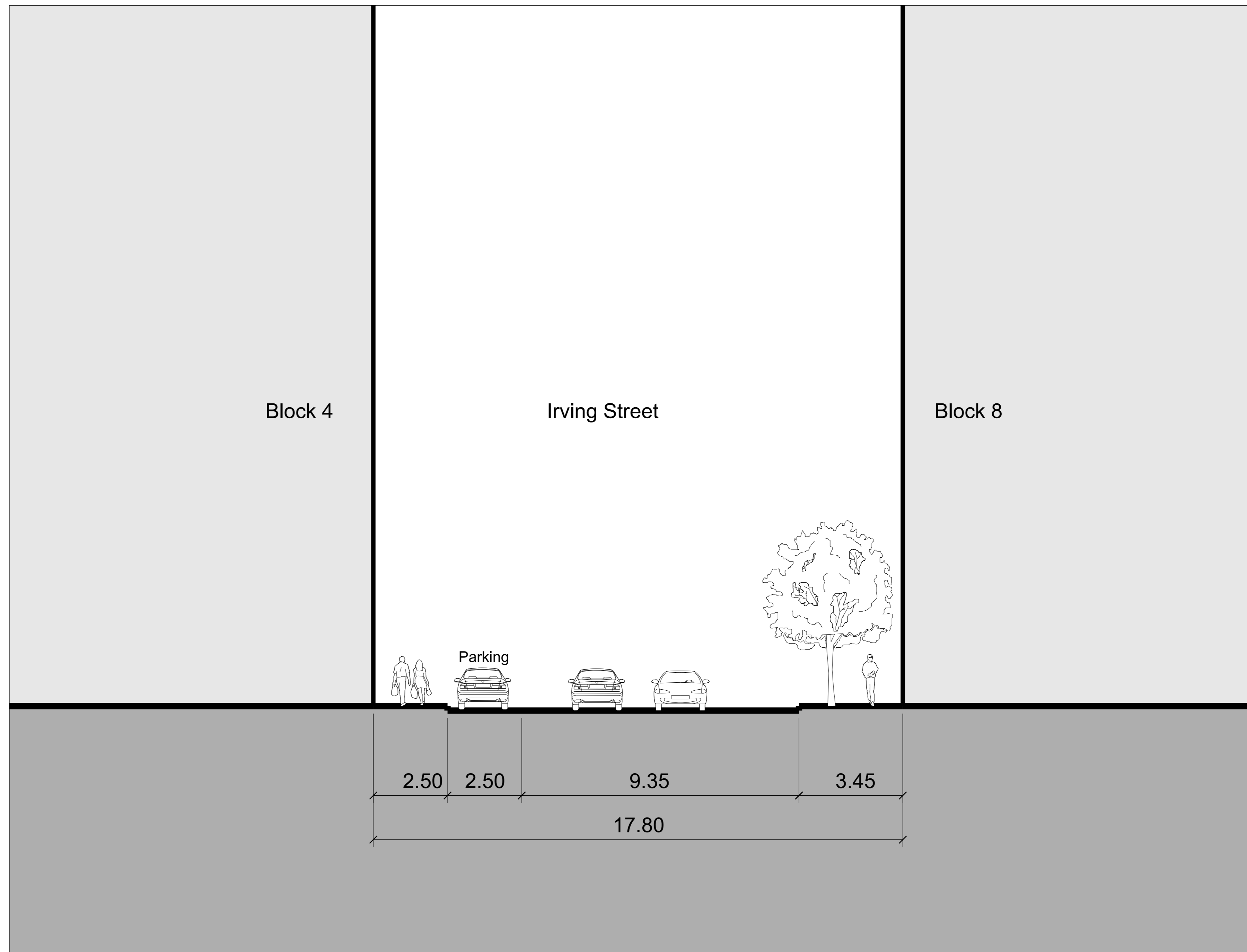

04 Section  
1:250

General Notes  
 1. Do not scale drawings. Dimensions govern.  
 2. All dimensions are in meters unless noted otherwise.  
 3. All dimensions shall be verified on site before proceeding work.  
 4. Foster + Partners shall be notified in writing of any discrepancies.

Rev.	Date	Reason For Issue	Ck
08	03/12/14	S75W Amendments (MOD 11)	RP
07	10/11/14	S75W Amendments (MOD 10)	RP
06	23/01/14	S75W Amendments (MOD 9)	RP
05	19/12/12	S75W Amendments (MOD 8)	RP
04	14/10/08	Submission DoP	
03	15/05/08	Submission DoP	
02	30/04/08	Submission amended CP	
01	21/04/08	Submission amended concept plan	
00	07/04/08	Final coordination	
-	31/03/08	For information (90% issue)	
-	19/03/08	For information (80% issue)	
-	14/03/08	For information (40% issue)	

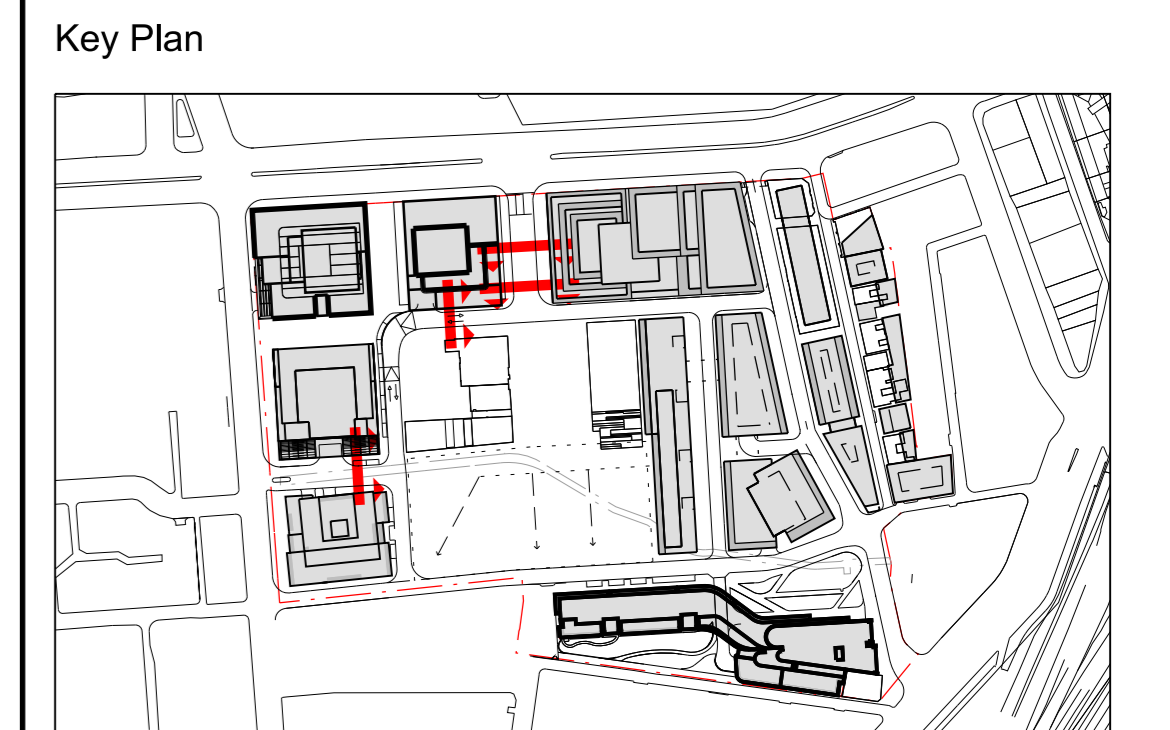

Notes

FOR SECTION LINES REFER TO A-1258

**FRASERS PROPERTY**

Project Frasers Broadway  
 20 - 102 Broadway Sydney NSW 2000  
 Client Frasers Broadway  
 L11, 488 Kent Street Sydney NSW 2000  
 T: 02 8823 8800 F: 02 8823 8801

**Foster + Partners**

Riverside, 22 Hester Road  
 London SW11 4AN  
 T +44 (0)20 7738 0455  
 F +44 (0)20 7738 1107

Title  
**Concept Plan  
 Street Sections**

Project No.	Scale @ A3	Date	Drawn By
1645	1:250	14/03/08	
Number	Revision		
A-1458			08