

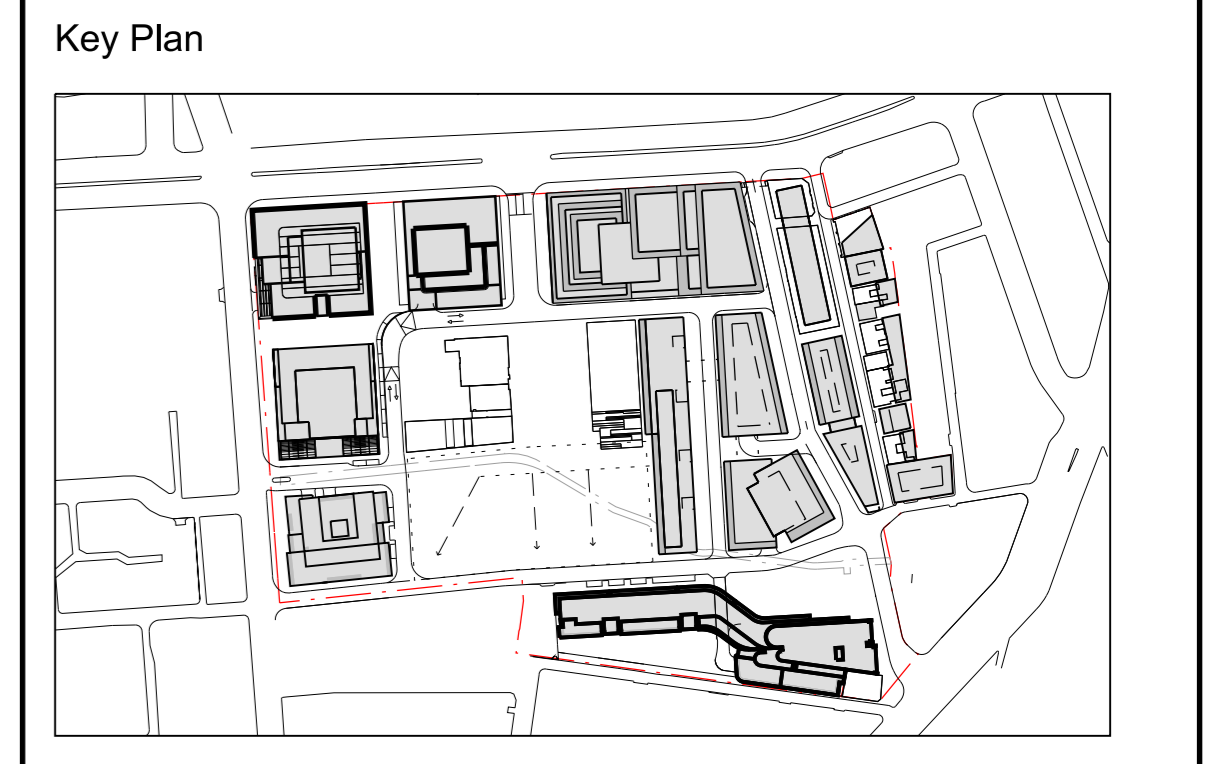

General Notes

1. Do not scale drawings. Dimensions govern.
2. All dimensions are in meters unless noted otherwise.
3. All dimensions shall be verified on site before proceeding work.
4. Foster + Partners shall be notified in writing of any discrepancies.

| Rev. | Date     | Reason For Issue         | Ck |
|------|----------|--------------------------|----|
| 11   | 14/05/13 | SSDA Comments            |    |
| 10   | 19/12/12 | S75W Amendments (MOD 8)  | RP |
| 09   | 19/12/12 | S75W Amendments (MOD 8)  | RP |
| 08   | 11/12/09 | Amended Street Names     |    |
| 07   | 15/10/08 | Submission DoP           |    |
| 06   | 14/10/08 | Submission DoP           |    |
| 05   | 27/05/08 | Submission amended DoP   |    |
| 16   | 28/11/14 | S75W Amendments (MOD 11) | RP |
| 15   | 10/11/14 | S75W Amendments (MOD 10) | RP |
| 14   | 23/01/14 | S75W Amendments (MOD 9)  | RP |
| 13   | 23/05/13 | Clouds Added             |    |
| 12   | 20/05/13 | SSDA Comments            |    |



Notes

|  |                        |
|--|------------------------|
|  | Drop Off               |
|  | General Vehicle Access |
|  | Service Vehicle Access |
|  | Drop Off and Taxi only |
|  | Traffic Direction      |
|  | Residential only       |
|  | Parking lots           |
|  | Development boundary   |

**FRASERS PROPERTY**

Project Frasers Broadway  
20 - 102 Broadway Sydney NSW 2000

Client Frasers Broadway  
L11, 488 Kent Street Sydney NSW 2000  
T: 02 8823 8800 F: 02 8823 8801

**Foster + Partners**

Riverside, 22 Hester Road  
London SW11 4AN  
T +44 (0)20 7738 0455  
F +44 (0)20 7738 1107

Title  
**Concept Plan  
Traffic  
Access, Parking**

|                            |                             |                         |          |
|----------------------------|-----------------------------|-------------------------|----------|
| Project No.<br><b>1645</b> | Scale @ A3<br><b>1:1000</b> | Date<br><b>31/03/08</b> | Drawn By |
| Number<br><b>A-1257</b>    | Revision<br><b>16</b>       |                         |          |