

A3 ISSUED FOR CERTIFIER/COUNCIL APPROVAL

NOT TO BE USED FOR CONSTRUCTION UNLESS APPROPRIATELY STAMPED BY COUNCIL OR CERTIFIER



NSW GOVERNMENT
Planning

Issued under the Environmental Planning and Assessment Act 1979

Approved Section 75W Modification Application

No. 3 granted on the 18/12/14

in respect to MP 07-0140

Signed Alwahan

Sheet No. 1 of 2

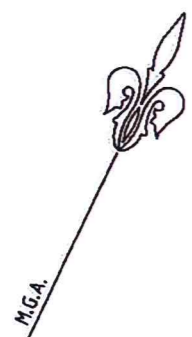

101
DP 635129

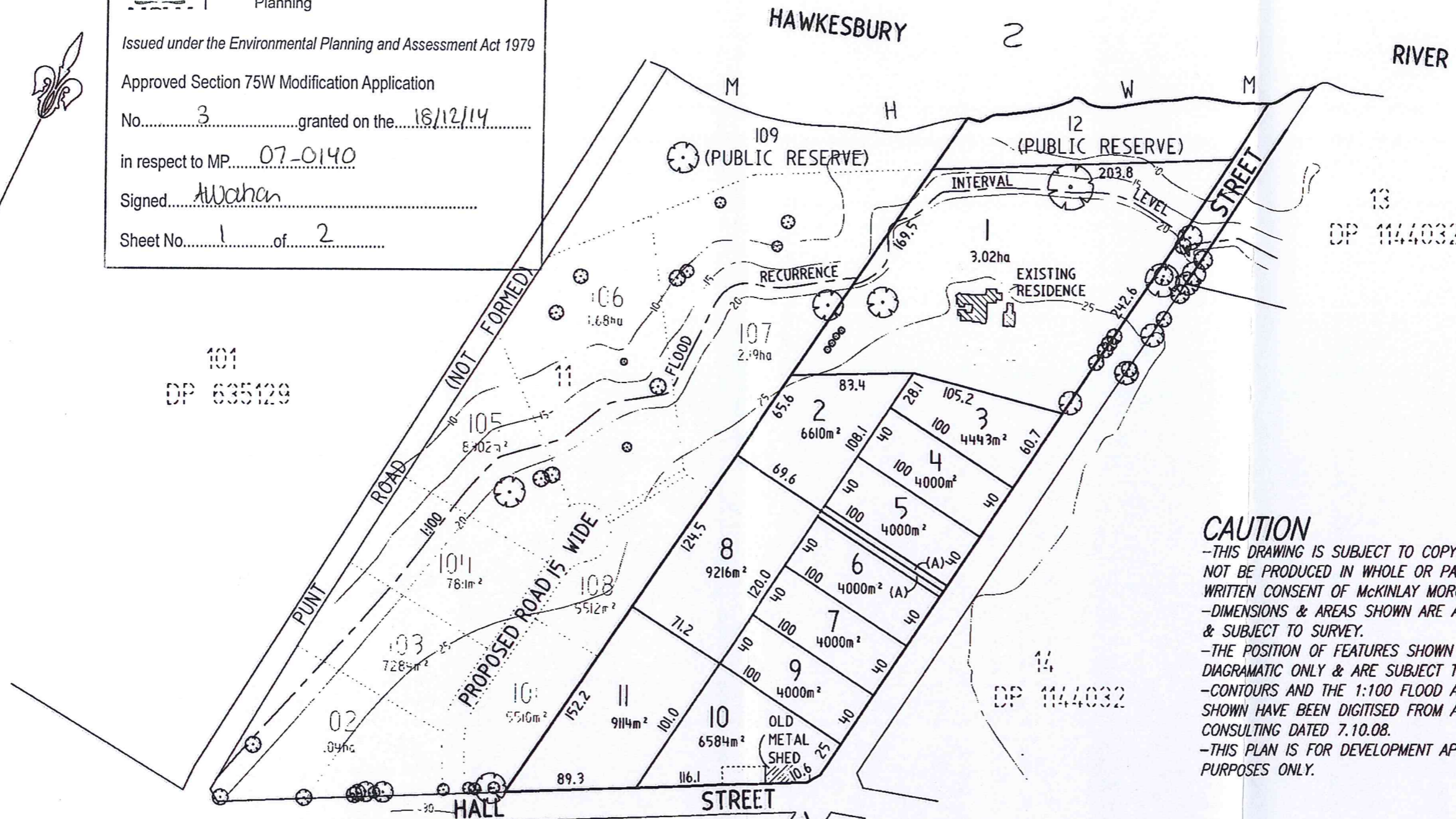

13
DP 1144032

14
DP 1144032

CAUTION
-THIS DRAWING IS SUBJECT TO COPYRIGHT. IT MUST NOT BE PRODUCED IN WHOLE OR PART WITHOUT PRIOR WRITTEN CONSENT OF MCKINLAY MORGAN & ASSOCIATES.
-DIMENSIONS & AREAS SHOWN ARE APPROXIMATE ONLY & SUBJECT TO SURVEY.
-THE POSITION OF FEATURES SHOWN MAY BE DIAGRAMATIC ONLY & ARE SUBJECT TO SURVEY.
-CONTOURS AND THE 1:100 FLOOD ARI CONTOUR SHOWN HAVE BEEN DIGITISED FROM A PLAN BY BROWN CONSULTING DATED 7.10.08.
-THIS PLAN IS FOR DEVELOPMENT APPLICATION PURPOSES ONLY.

(A) PROPOSED RECIPROCAL RIGHTS OF CARRIAGE WAY AND EASEMENTS FOR SERVICES EACH 4.5 WIDE

LOT LAYOUT OVER ADJOINING PROPERTY (LOTS 101-109) IS INDICATIVE ONLY TO SHOW POTENTIAL

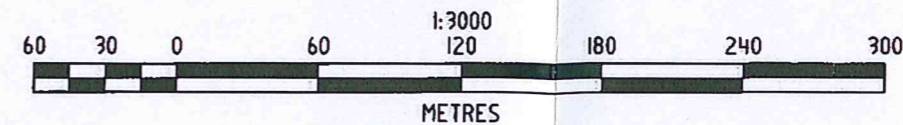

F		0	5	10	15	20	25	MILLIMETRES AT A3	30	35	40	45	50	55	60	65	70	75
E		DESIGN BY AE																
D		SURVEY BY -																
C		CALCS BY AE																
21-11-11	B	AMENDED AREA OF LOT 2																
18/11/2011	A	PROPOSED BOUNDARY ADJUSTMENT																
Date		REVISION																
		DRAWN BY SR/00																
		CHECKED BY																
		REDUCTION RATIO AT A3 1:3000																
		CONTOUR INTERVAL 5m																
		ORIGIN OF LEVELS																
		DATUM																



MCKINLAY MORGAN & ASSOCIATES Pty Ltd.
ACI 893 754 525 AIN 23 893 754 525
CONSULTING SURVEYORS - PROJECT MANAGERS
122 Macquarie Street, Windsor NSW 2756
PO Box 217 Windsor NSW 2756
Phone: 4577 6011
Fax: 4577 4910
Email: mail@mckinlaymorgan.com.au
www.mckinlaymorgan.com.au

DATE 18/11/2011	CLIENT NAME FALSON & ASSOC.	SHEET No. 1 OF 1 SHEETS
FILE No. 88248/12	LOCALITY PITT TOWN LGA HAWKESBURY	
COUNCIL REF	PLAN No. 88248-DA-2 C.FILE: 8824812DA2-8.DWG	
PLAN OF PROPOSED SUBDIVISION OF LOT 12, DP 1021340 AT PITT TOWN		

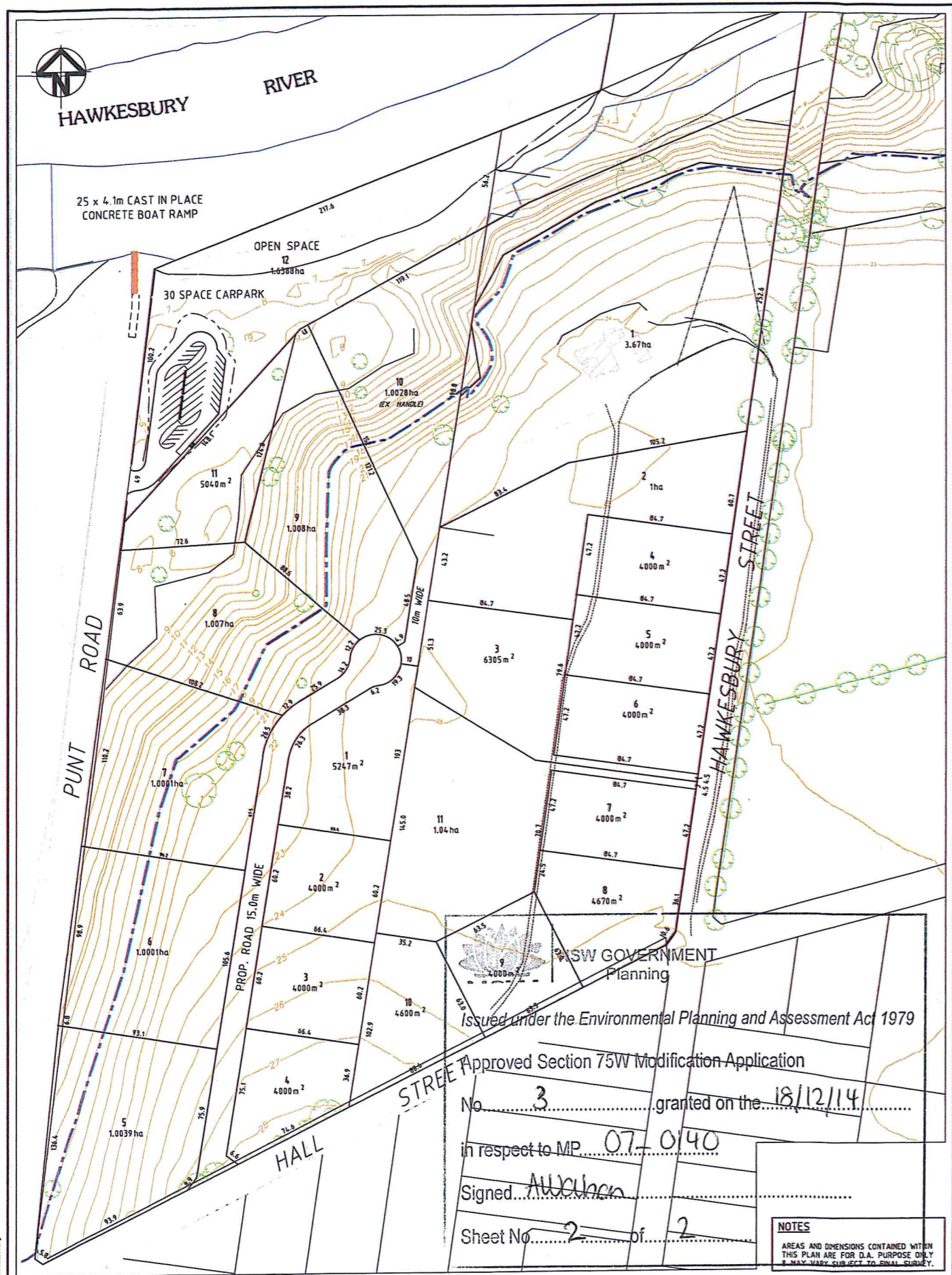

BROWN Smart Consulting ©2014 www.brownconsulting.com.au		HAWKESBURY CITY COUNCIL PITT TOWN MASTERPLAN FOR BLIGHTON OPTION 2	<table border="1"> <tr> <th>REVISION</th> <th>DATE</th> </tr> <tr> <td>2</td> <td>18/12/14</td> </tr> <tr> <td>1</td> <td>12/12/14</td> </tr> <tr> <td>0</td> <td>09/12/14</td> </tr> </table>	REVISION	DATE	2	18/12/14	1	12/12/14	0	09/12/14	<table border="1"> <tr> <th>DATE</th> <th>DESCRIPTION</th> <th>DATE</th> </tr> <tr> <td>18/12/14</td> <td>FINAL ISSUE</td> <td>18/12/14</td> </tr> </table>	DATE	DESCRIPTION	DATE	18/12/14	FINAL ISSUE	18/12/14
REVISION	DATE																	
2	18/12/14																	
1	12/12/14																	
0	09/12/14																	
DATE	DESCRIPTION	DATE																
18/12/14	FINAL ISSUE	18/12/14																
DRAWING No. L03017.500-F7 SHEET 1 OF 1 SHEETS		AMEND. 1																