

# Woollooware Bay Town Centre

## Foreshore Park

SECTION A1 | SECTION A2 | SECTION B | SECTION C

Indicative Drawings For Information Only



Key

- Site Boundary
- Staging boundary
- HV Cables
- HV Cables Easement
- MHWM

- 1 Elevated educational pontoon/decks
- 2 Protection fence to riparian and salt marsh planting
- 3 Foreshore shared pathway
- 4 Proposed upper pedestrian bridge
- 5 Open turf area
- 6 Turf terraces
- 7 Riparian/Coastal Salt Marsh planting - refer to Salt Marsh planting schedule and VMP

- 8 Riparian planting buffer - refer to Lower Riparian planting schedule and VMP
- 9 Riparian planting - refer to Upper Riparian planting schedule and VMP
- 10 Tree planting- refer to planting schedule and VMP
- 11 Planted Swale - refer to swale planting schedule and VMP
- 12 Fitness pod
- 13 Turning bay to Ausgrid power lines

- 14 Public Toilet (approved under stage 2)
- 15 Touched By Olivia playground with range of accessible play equipment
- 16 Shade structure with BBQ and seating





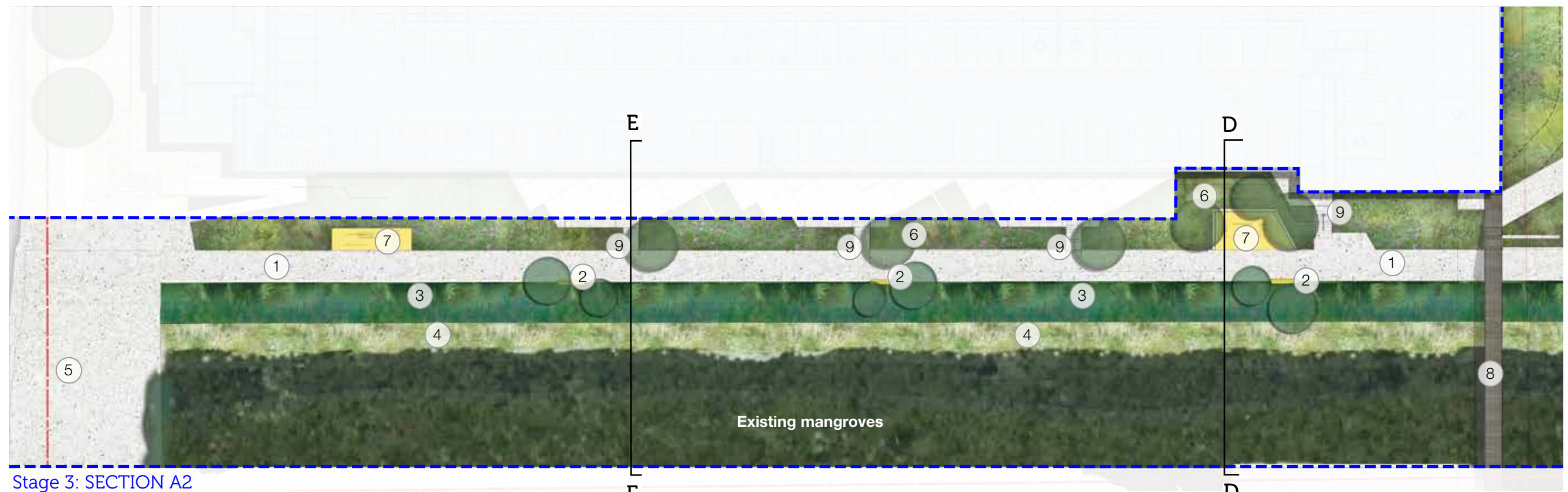

Stage 3: SECTION A2

### Key

- Site Boundary
- Staging boundary

- |  |  |                                    |
|--|--|------------------------------------|
| (1) Shared pathway                                   | (4) Planting to drainage channel - refer to planting schedule        | (7) Outdoor fitness station        |
| (2) Seating  | (5) Existing entry hard stand to stadium                             | (8) Upper pedestrian bridge        |
| (3) Planted swale - refer to swale planting schedule | (6) Trees & mass planting to embankment - refer to planting schedule | (9) Stair access to grove terraces |

Swale + Drainage Channel | Section DD



Swale + Drainage Channel | Section EE



Drainage Channel Precedents





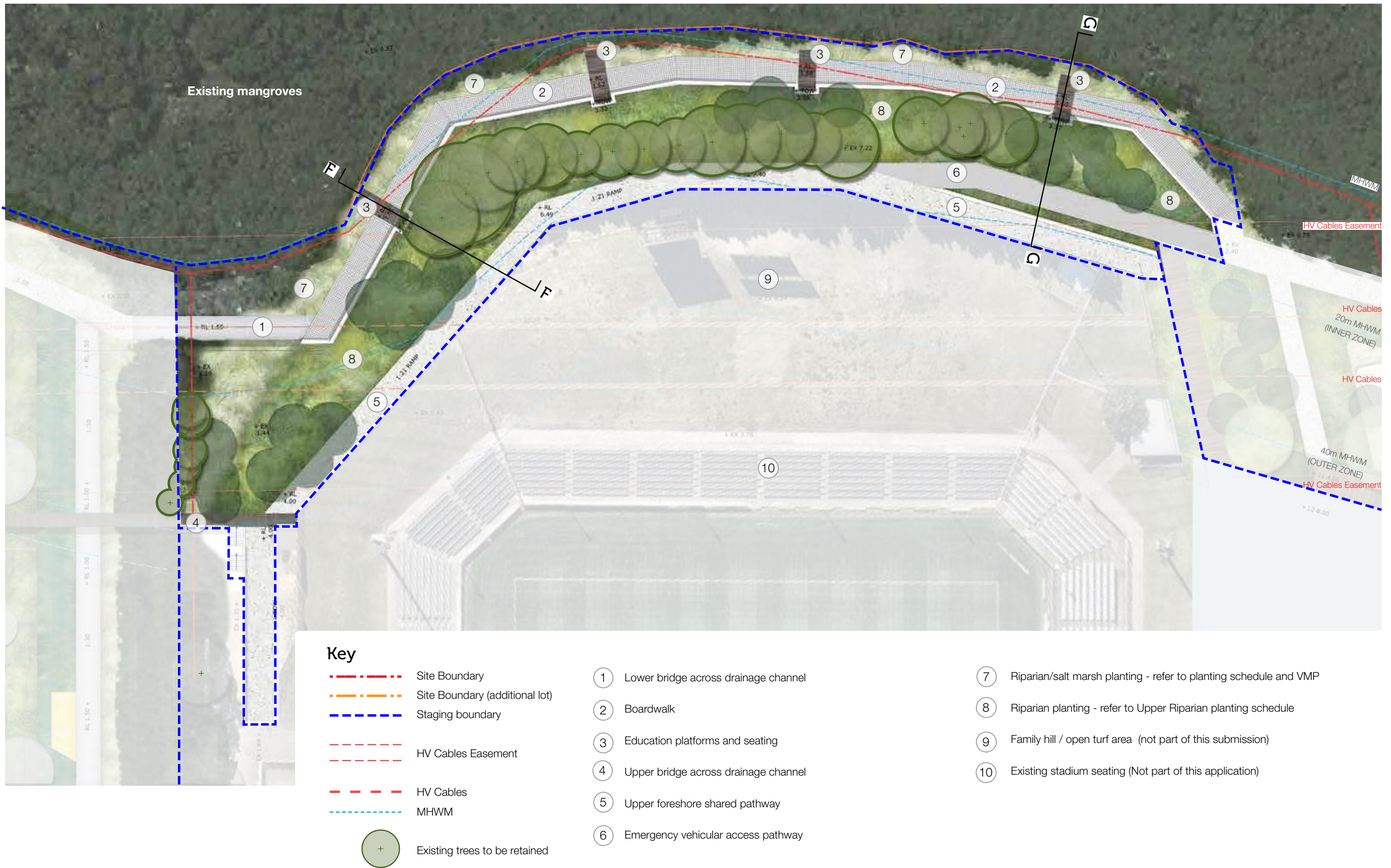





**Key**

- Site Boundary
- Staging boundary
- HV Cables
- HV Cables Easement
- MHWM

- Existing mangrove boardwalk (restored)
- Existing sea wall (restored)
- Protection fence to riparian/salt marsh planting
- Foreshore shared pathway
- Open turf area
- Stepping stones in turf
- Boardwalk/platform to building facade and through site link.
- Low seating wall
- Retail cafe spill out zone
- Stage, seating and play platform
- Water play
- Turf terraces with concrete edge/seating
- Level 2 terrace to retail
- Bridge to level 2 retail
- Riparian/Salt Marsh planting - refer to salt marsh planting schedule and VMP
- Riparian planting buffer - refer to lower riparian planting schedule and VMP
- Riparian planting - refer to upper riparian planting schedule and VMP
- Trees planting - refer to planting schedule and VMP
- Mounded dune landscape to emphasise riparian buffer





Planting Community Zones:

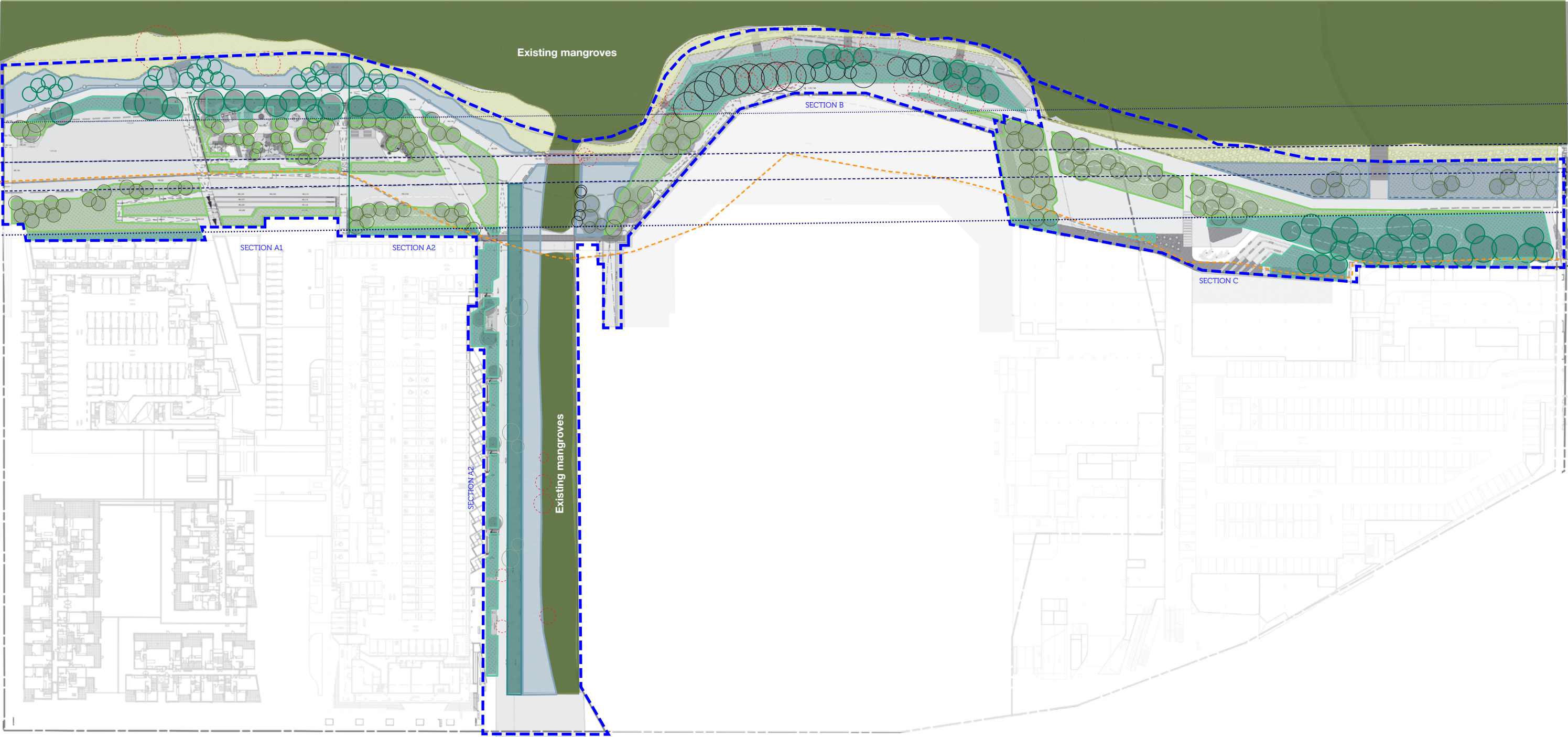

Key:

- 40m Setback from MHW
- Ausgrid HV cables
- Ausgrid HV cable easement

Note:  
All planting species selected with ecologist  
from VMP, Southernland Shire Council plant list  
and Ausgrid approved easement plant list

Existing vegetation

- Existing trees to be retained
- Existing trees to be removed
- Existing mangroves to be retained
- Existing mangroves to be removed

Planting types

- Salt marsh planting
- Lower Riparian planting
- Swale planting
- Upper Riparian planting (outside HV cables)
- Upper Riparian planting (under HV cables)

Trees

- Proposed Trees (Outside HV Cables)
- Proposed Trees (Inside HV Cables)
- Foreshore Park Trees**  
Outside HV Easement (large trees) = 44  
Inside HV Easement (small trees) = 63
- Drainage Channel Trees**  
Embankment and Swale = 12

- Mangrove Boardwalk Trees**  
Outside HV Easement (large trees) = 10  
Inside HV Easement (small trees) = 15
- Retail Foreshore Trees**  
Outside HV Easement (large trees) = 24  
Inside HV Easement (small trees) = 49

TOTAL TREES: 227



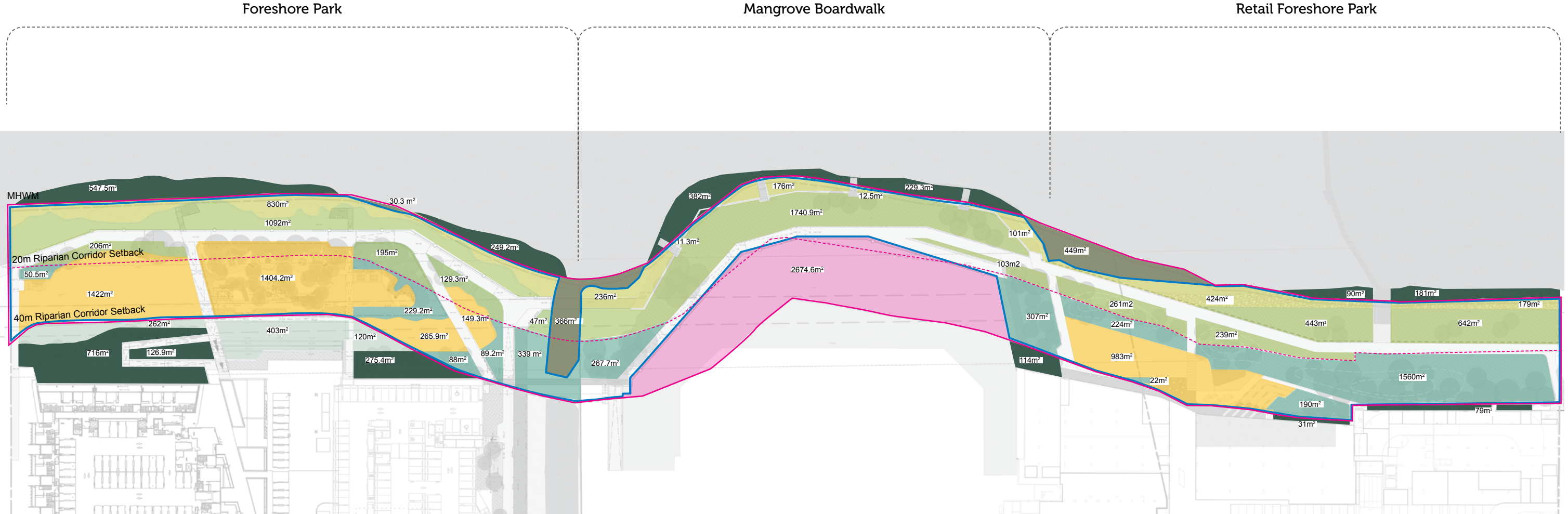

- RIPARIAN CORRIDOR
- RIPARIAN CORRIDOR AREA WITHIN SCOPE (17590m<sup>2</sup>)
- AREA OUTSIDE SCOPE
- NON RIPARIAN
- EXISTING VEGETATION AREA WITHIN RC
- INNER ZONE
- OUTER ZONE
- SURROUNDING OFFSET PLANTING

**17590m<sup>2</sup>**  
TOTAL  
RIPARIAN  
CORRIDOR AREA

**10434.6m<sup>2</sup>**  
TOTAL RIPARIAN  
PLANTING

**4224.4m<sup>2</sup>**  
TOTAL  
NON  
RIPARIAN  
(turf: 2444.68m<sup>2</sup>)

**3021.3m<sup>2</sup>**  
TOTAL RIPARIAN  
OFFSET

