

**Pacific Highway and Pelican Beach Entrance, Sapphire****Post Development PM Peak****Geometry****Demand Flows - Total**

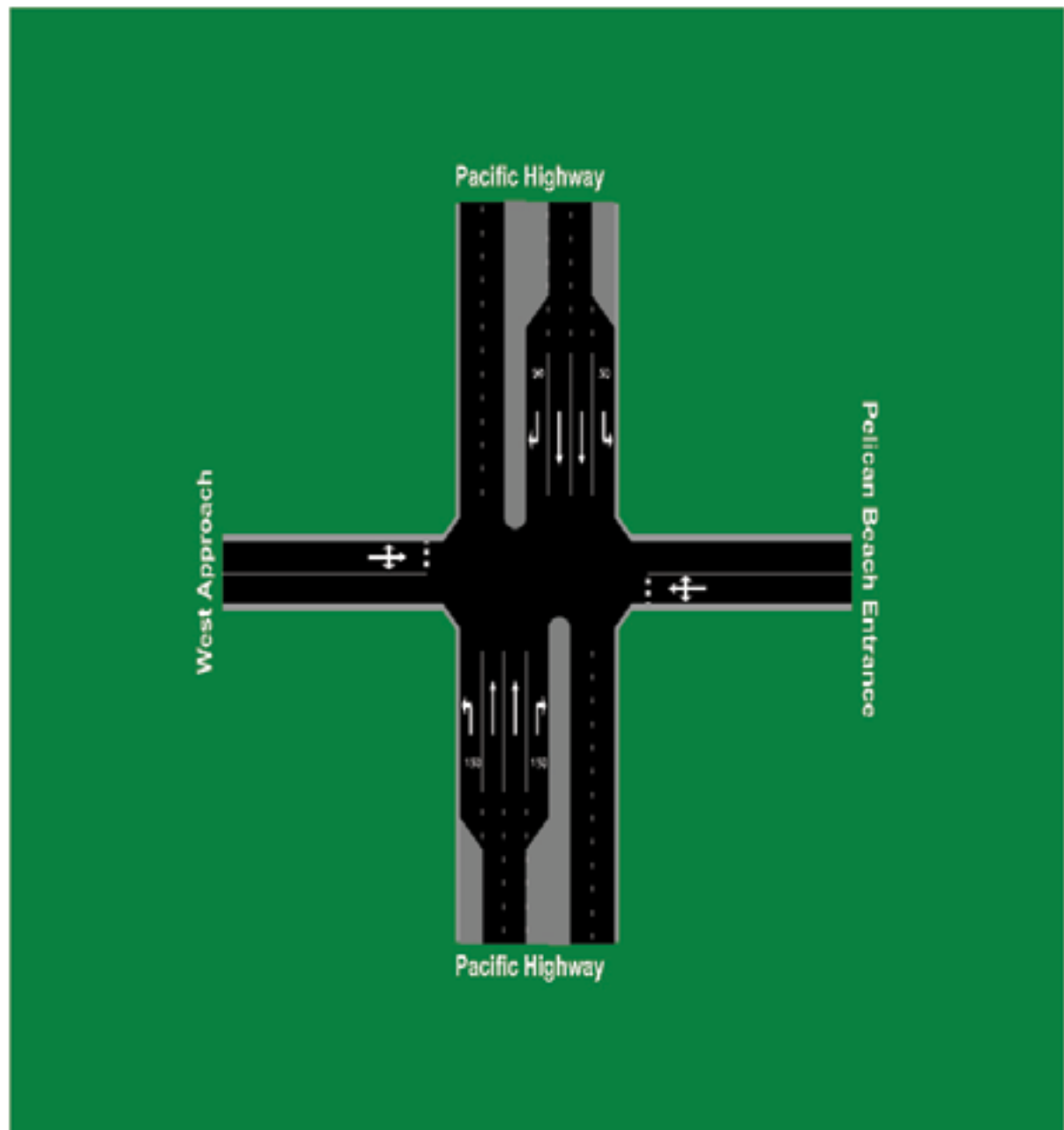

#### Demand Flows - Light Vehicles

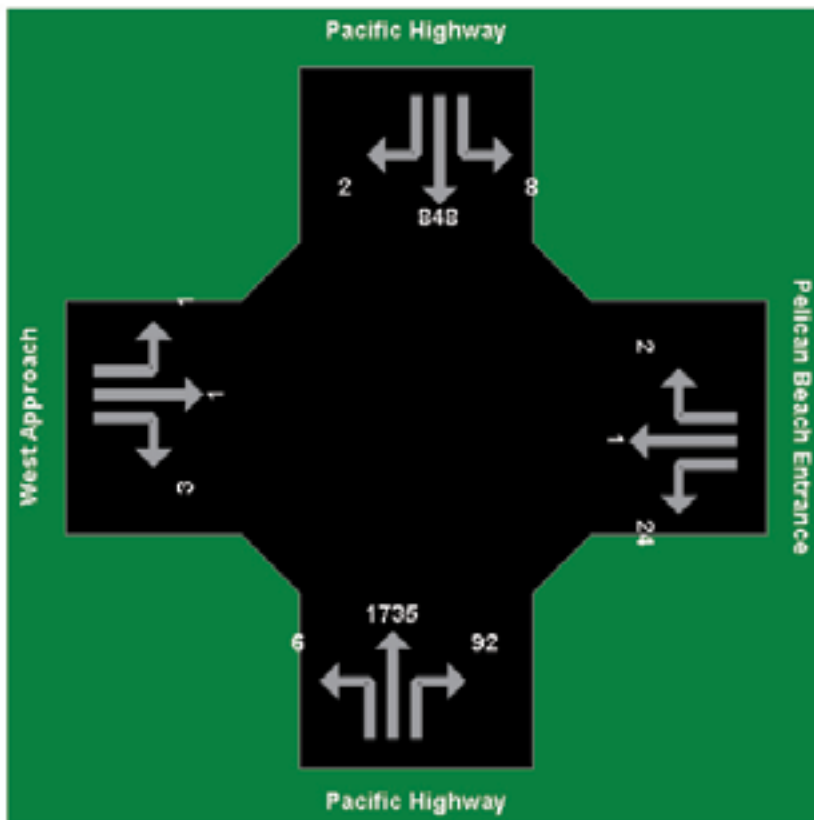
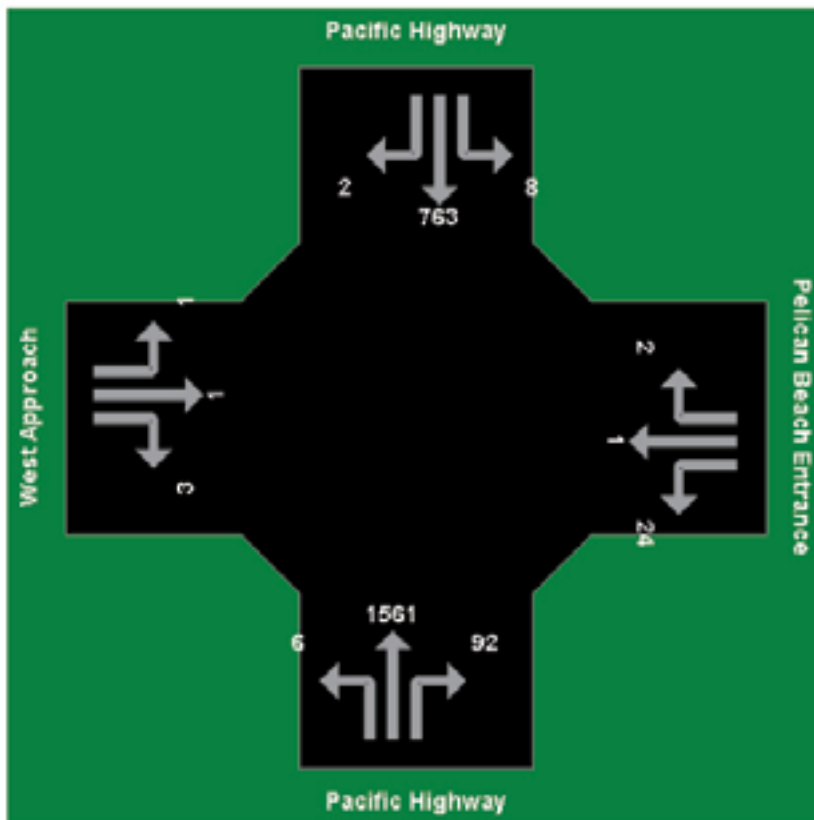

file://C:\Documents and Settings\MShrimpton\Local Settings\Temp\{4D62FF17-E883-4226-850F... 7/06/2006

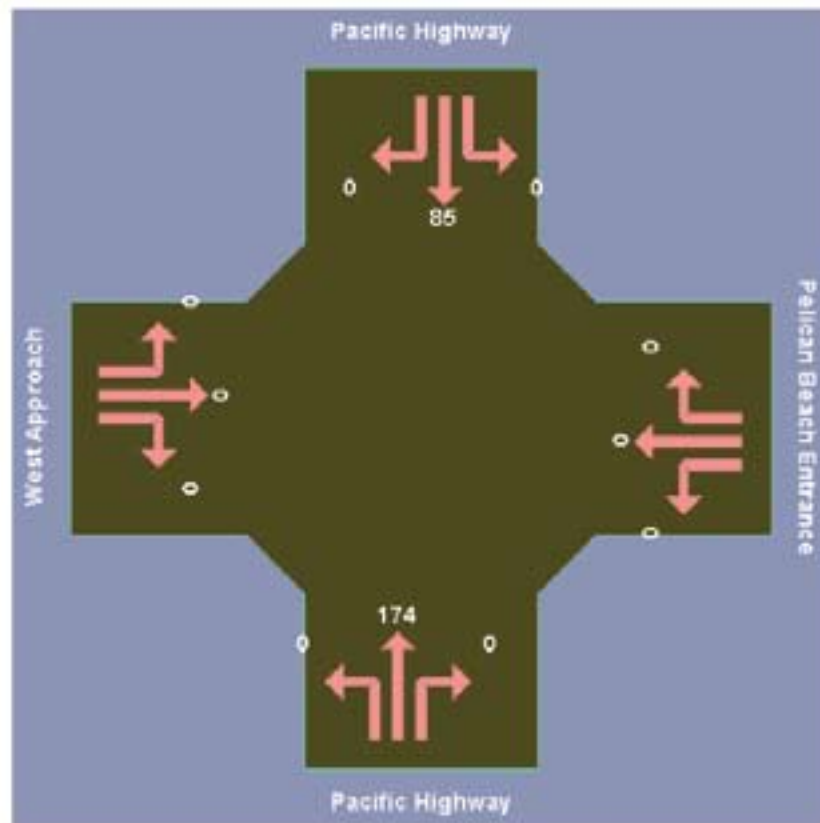
**Demand Flows - Heavy Vehicles****Percent Heavy Vehicles**

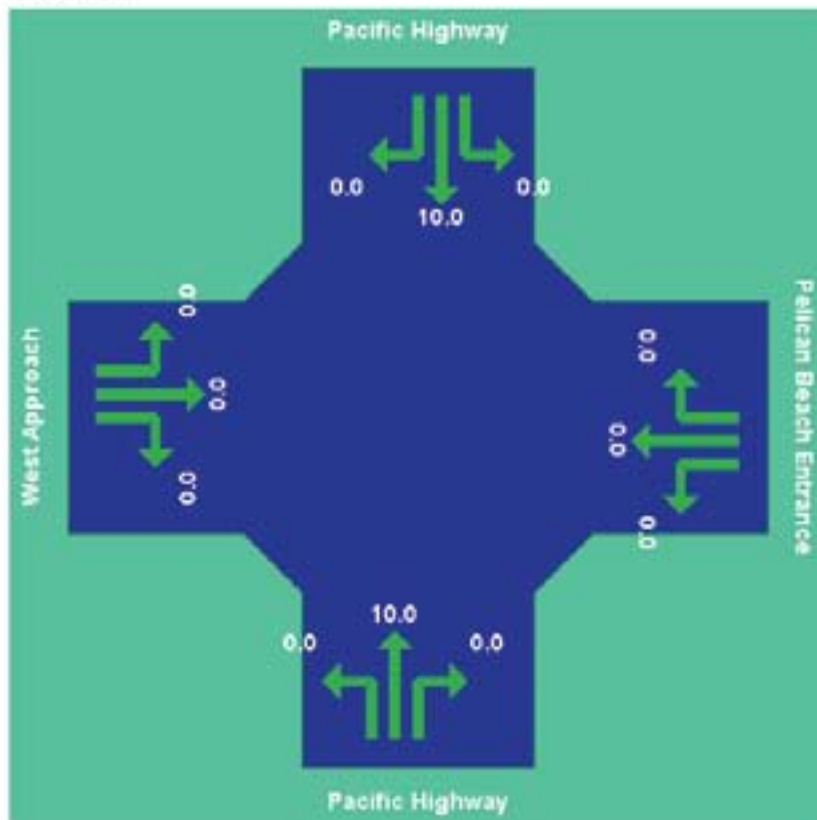

Approach, Circulating and Exiting Flows

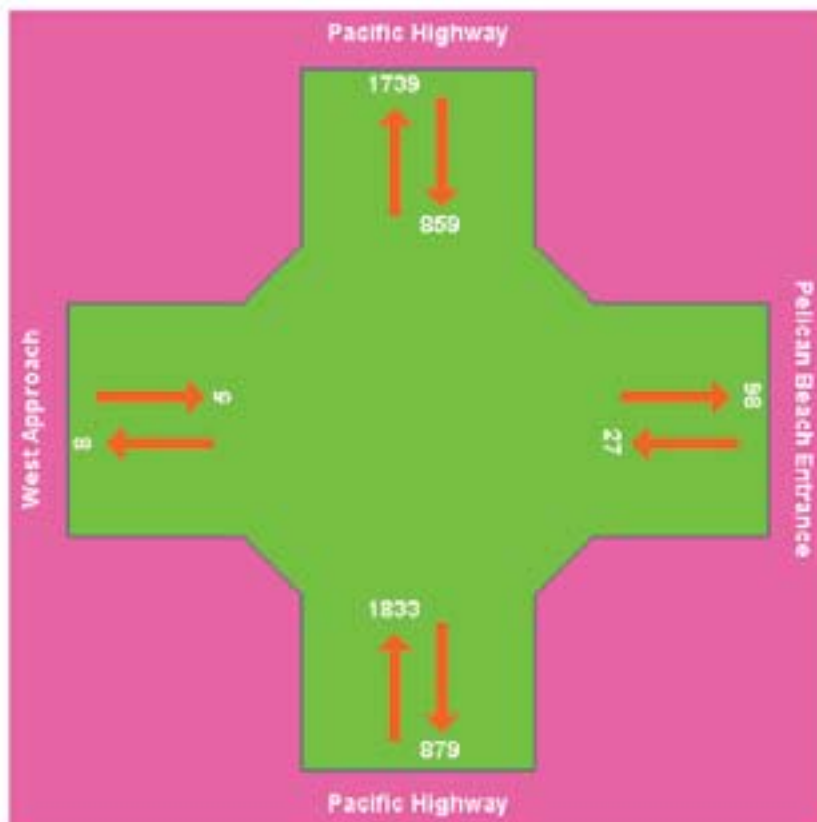

file://C:\Documents and Settings\MShrimpton\Local Settings\Temp\{4D62FF17-E883-4226-850F... 7/06/2006

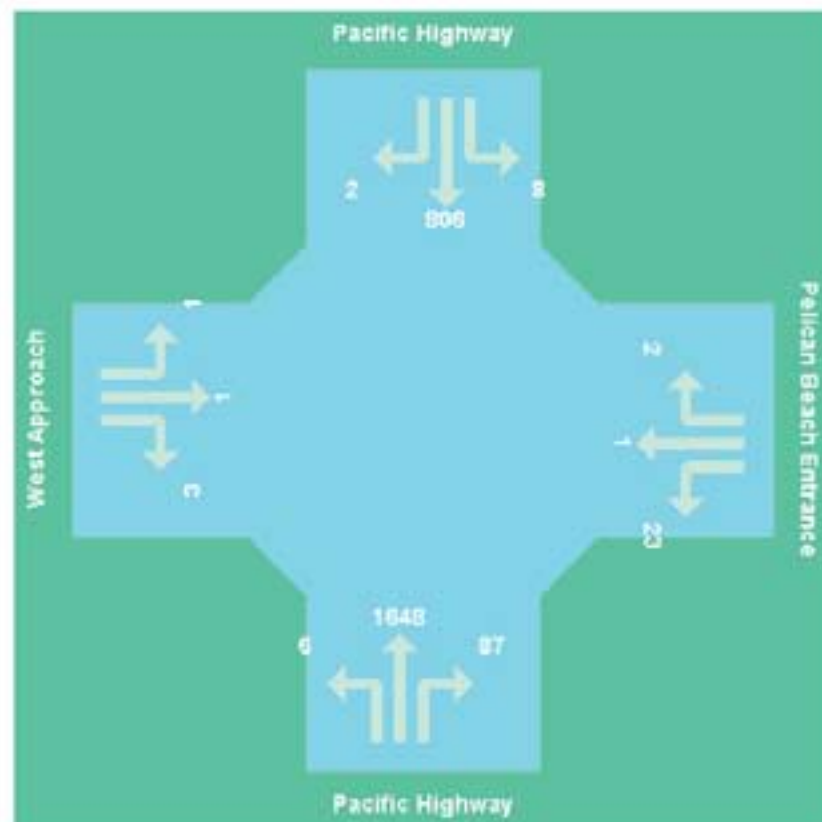
**Input Volumes****Degree of Saturation**

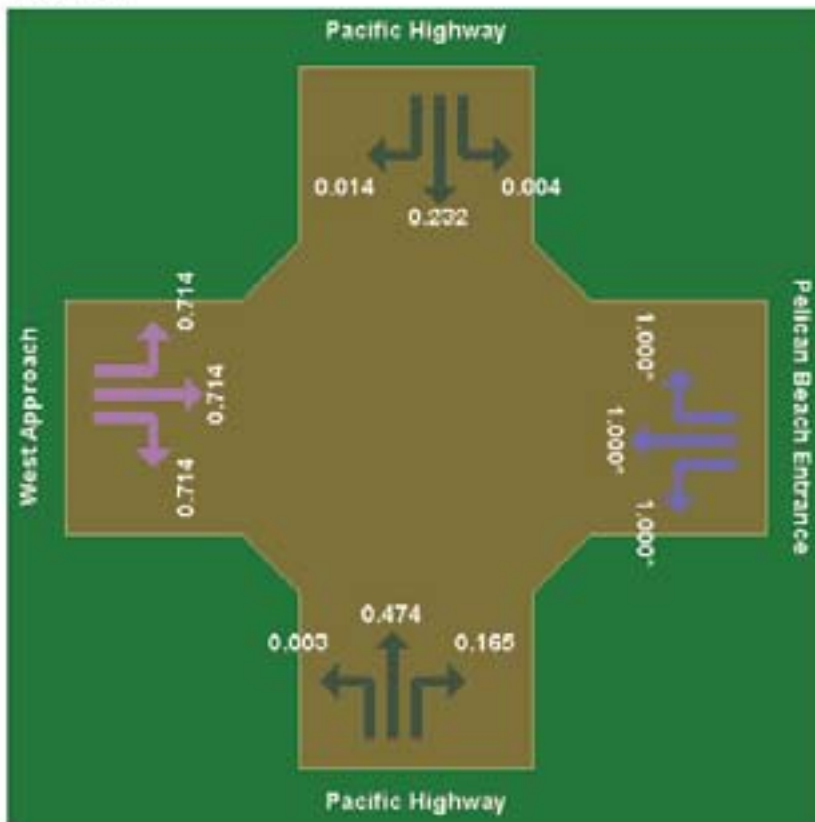

### Control Delay (Average)

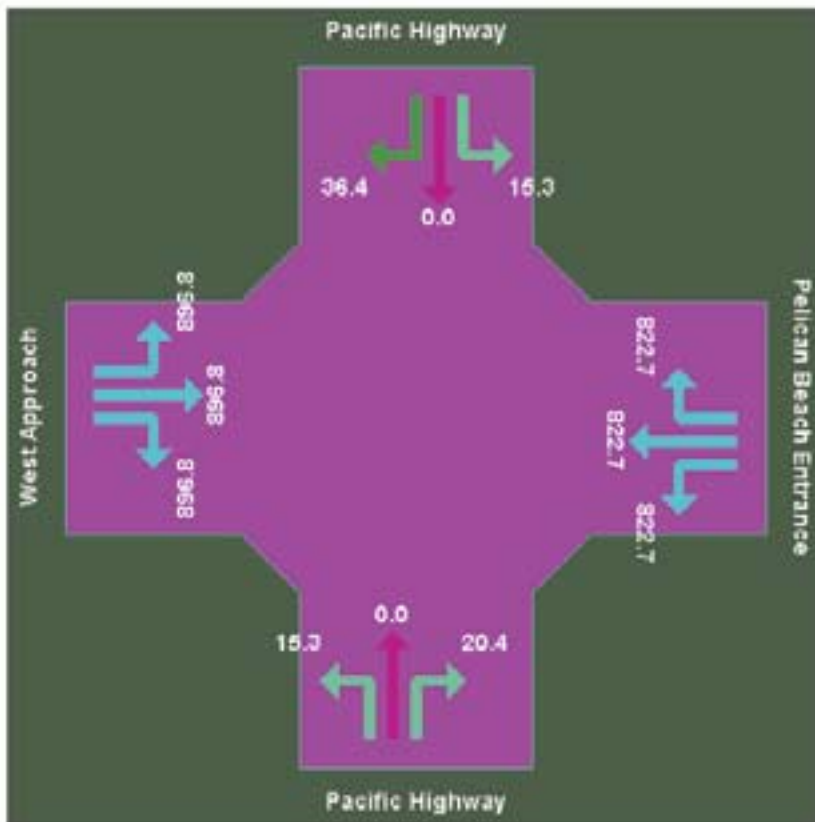

file://C:\Documents and Settings\MShrimpton\Local Settings\Temp\{4D62FF17-E883-4226-850F... 7/06/2006

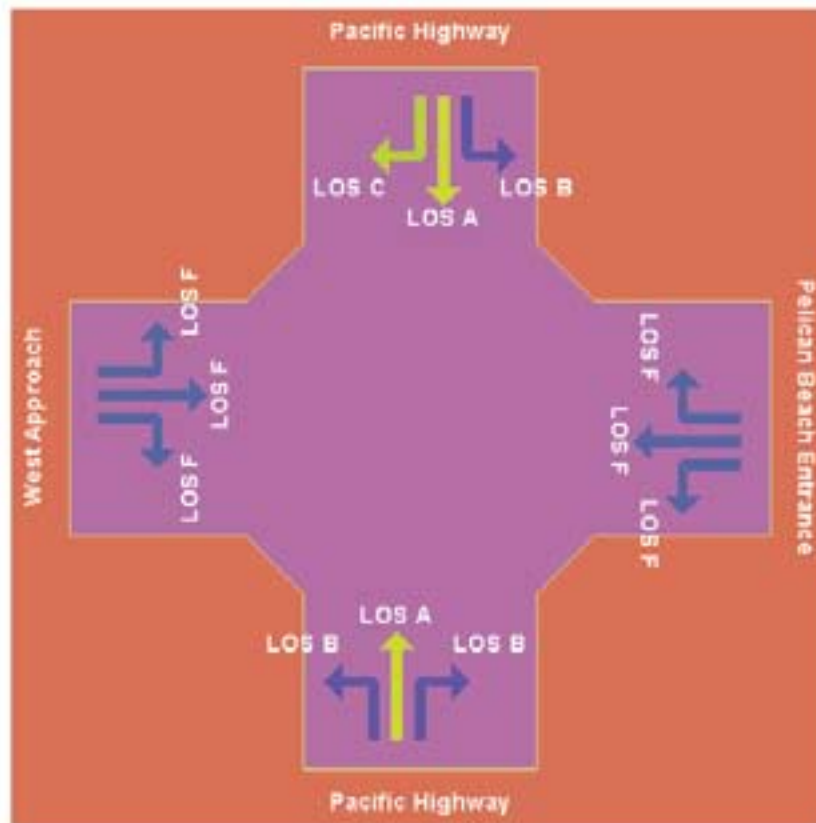

Queue Distance

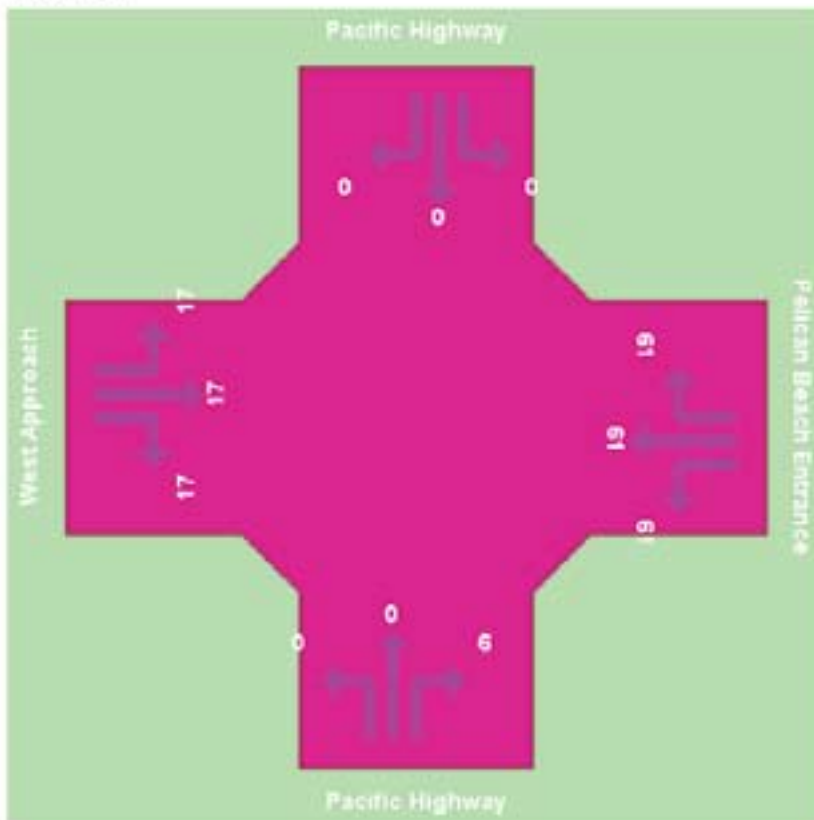

### Effective Stop Rate

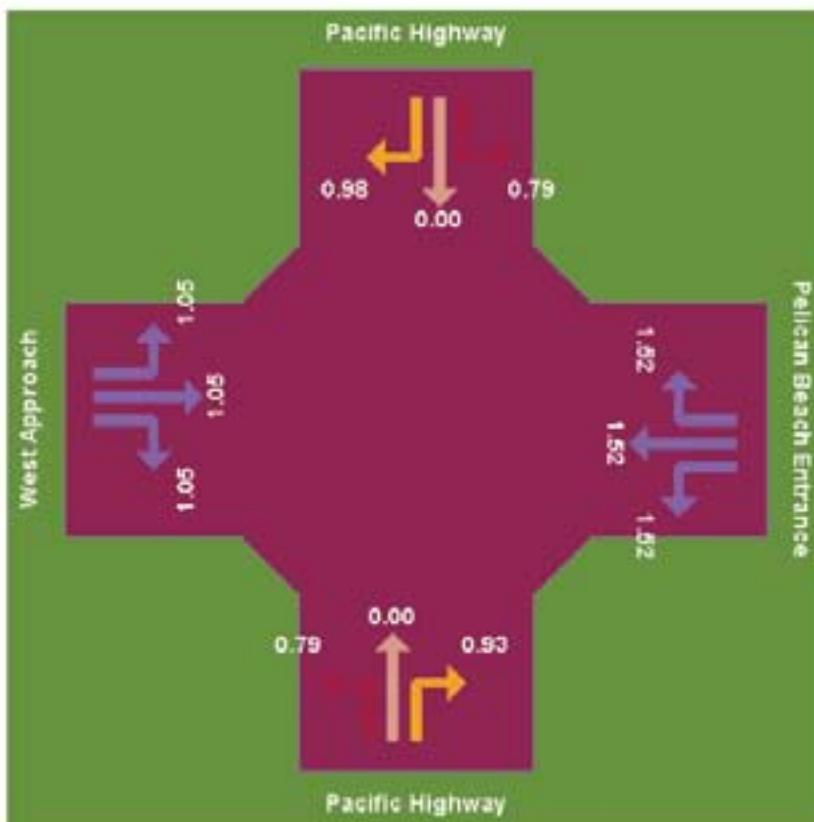

file://C:\Documents and Settings\MShrimpton\Local Settings\Temp\{4D62FF17-E883-4226-850F... 7/06/2006



**G:\22\12787\SIDRA\Pacific Highway and Pelican Beach PM Peak**

**Produced by aaSIDRA 2.1.3.356**

**Copyright© 2000-2005**

**[Akcelik & Associates Pty Ltd](#)**

Generated 7/06/2006 12:46:44 PM



## Appendix D

# RTA Crash Data

[illegible]

**H10- Pacific Highway: Shire of Coffs Harbour  
Intersection to Pelican Beach Resort (+/- 800m)  
Data Period: 1/10/2000 to 30/9/2005 (5yrs)**

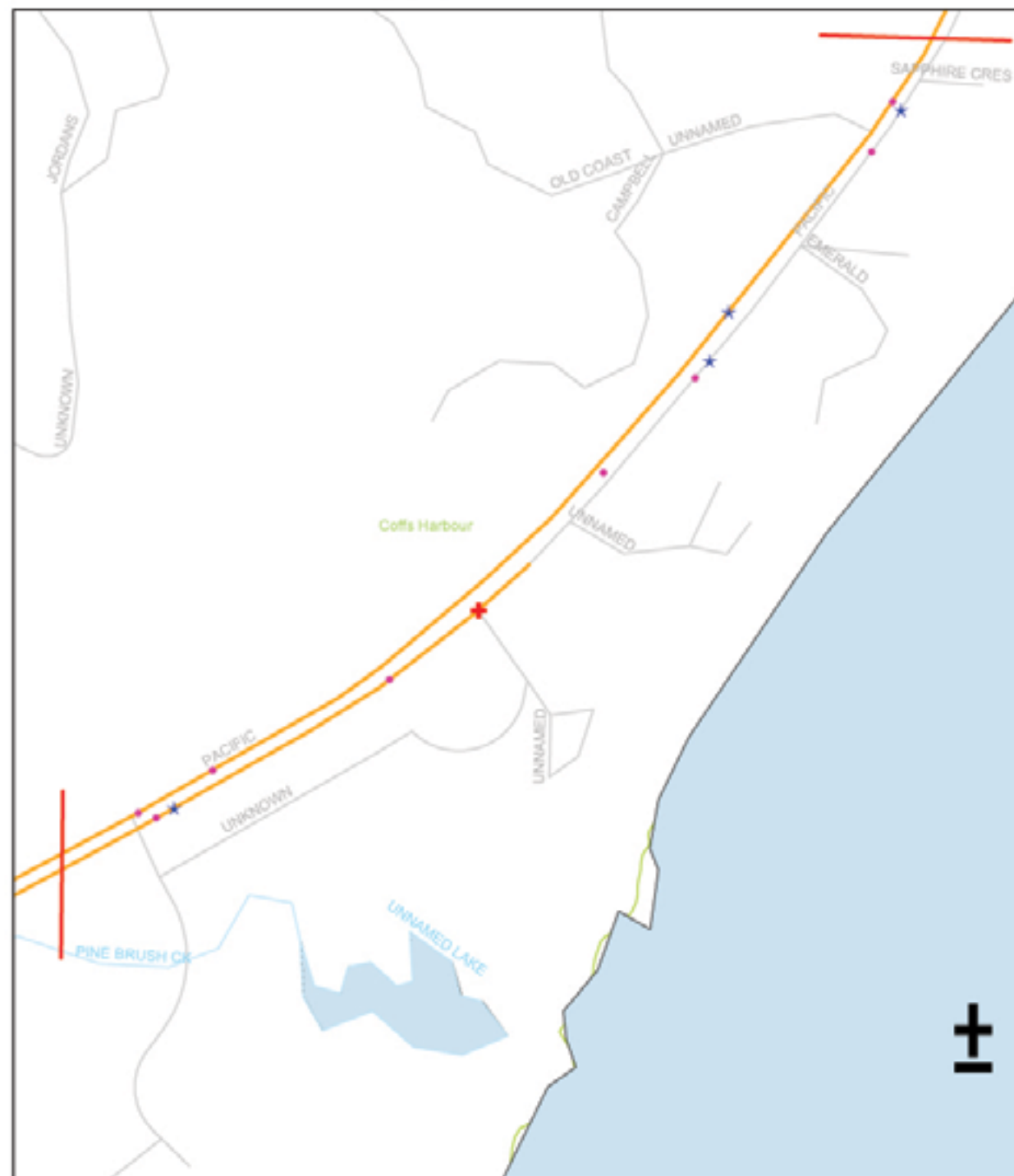

0 40 80 160 240 320  
Meters



## Accident Analysis Summary

H10 - Pacific Highway: Intersection to Pelican Beach resort (+/- 800m)

Accident Data 1/10/2000 to 30/9/2005 (5 years)

Total Number of Accidents: 13

	No. of Accidents	No. of Fatalities	No. of Injuries
<b>Fatal Accidents</b>	1	1	0
<b>Injury Accidents</b>	4		5
<b>Non Injury Accidents</b>	8		

Year *	Count	Day	Count	Direction of Travel	Surface Condition
2000	2	Monday	1	North 7	Wet 6
2001	3	Tuesday	2	South 5	Dry 7
2002	2	Wednesday	5	East 1	
2003	1	Thursday	2		<b>Natural Lighting</b>
2004	5	Friday	2		Day: 10
		Saturday	1		Night: 3

<b>Seat Belt / Helmet for Key Controller</b>	<b>Count</b>	
Adult Belt Worn	10	<b>No. Accidents speed involvement</b> 1
No restraint fitted to this position	2	(RTA Internal Use Only)
Unknown / not stated	1	<b>No. Accidents Heavy Vehicle involvement</b> 2
		<b>No. Accidents Pedestrian involvement:</b> 2

### DCA Summary

000 DCA Count	100 DCA Count	200 DCA Count	300 DCA Count	400 DCA Count	500 DCA Count	600 DCA Count	700 DCA Count	800 DCA Count	900 DCA Count
3 1		201 2	301 3				703 1	804 1	
8 1		202 1	303 1				704 1		
			305 1						

## Accident Analysis Summary

H10 - Pacific Highway: Intersection to Pelican Beach resort (+/- 800m)  
 Accident Data 1/10/2000 to 30/9/2005 (5 years)

### Object 1st Impacted

	Count
Sign post or parking meter	1
Embankment / cutting / rocky outcrop / boulders et	2
No object hit	10

### Traffic Unit Group - Key Controller

Car / Car derivatives	10
Light Trucks	2
Articulated trucks	1

### Road No Accident Count

10	12
9998	1

### Age Group Of Controller

Age Group	Count
17 - 20 yrs	2
26 - 29 yrs	1
30 - 39 yrs	3
40 - 49 yrs	3
50 - 59 yrs	2
80+ yrs	1
Unknown	1

### Age of Casualty

Age Group	Count
5 - 16 years	1
17 - 20 years	1
40 - 49 years	3
50 - 59 years	1

### Sex of Casualty

	Count
Female	1
Male	5

### Type of Day

Christmas	1
Other School Holidays	3
Other Week Ends	1
Other weekdays	8

### Time Group

Time Group	Count
0001 - 0400hrs	2
0401 - 0800hrs	3
1201 - 1600hrs	4
1601 - 2000hrs	3
2001 - 2400hrs	1



## Appendix E

# Site Layout and Long Section of Internal Roads



SEE INSERT A

INSERT A- SERVICE VEHICLE TURNING PATH  
SCALE 1:500

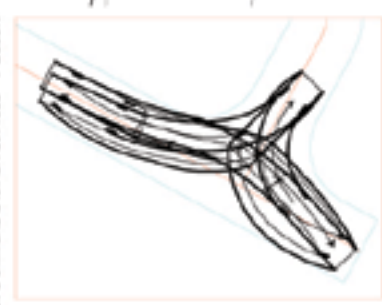

# PRELIMINARY

REV	DESCRIPTION	DATE	BY	CHK
1	DESIGN REVIEWED			

ATTENTION: PROJECTS AND PRIORITIES  
PELHAM BEACH RESORT, CORPS HARBOR  
PROPOSED CONCEPT PLAN

**GHD** CLIENTS | PEOPLE | PERFORMANCE  
GHD is a leading provider of environmental and engineering services. We are committed to providing the highest quality services to our clients.

Scale: 1:500 for A1 100 NO 22-12787  
Date: AUG 2006 Rev No: 8  
Approved: SK001

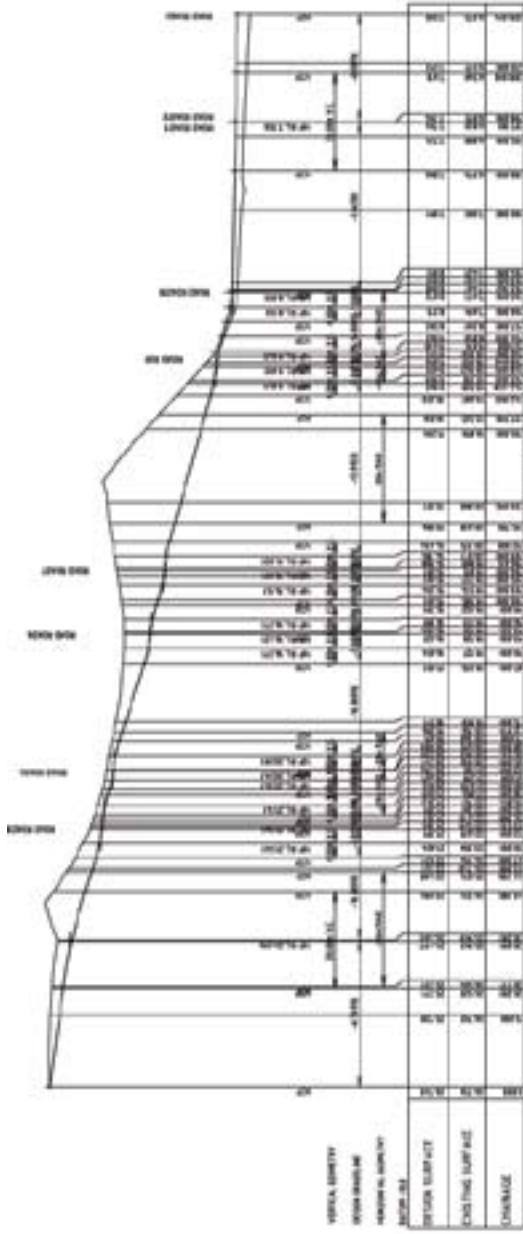





# PRELIMINARY

NO	DESCRIPTION	DATE	BY
----	-------------	------	----

ATTENTUS PROJECTS AND PROPERTIES  
PELICAN BEACH RESORT, CORPS HARBOUR  
PROPOSED CONCEPT PLAN  
DESIGN SPOT HEIGHTS



2700 Macquarie Street, Sydney NSW 2000  
Tel: +61 2 9246 4000  
Fax: +61 2 9246 4001  
Email: [info@ghd.com.au](mailto:info@ghd.com.au)  
Website: [www.ghd.com.au](http://www.ghd.com.au)

SK004  
This document is the property of GHD and is not to be distributed outside the project team without the written consent of GHD.

Scale: 1:500 for A1 job no: 22-12787  
Date: AUG 2009 Rev no: 8

Approved: SK004

GHD Pty Ltd ABN 39 008 488 373

352 King Street Newcastle NSW 2300

PO Box 5403 Hunter Region Mail Centre NSW 2310

T: (02) 4979 9999 F: (02) 4979 9988 E: ntlmail@ghd.com.au

© GHD Pty Ltd 2006

This document is and shall remain the property of GHD Pty Ltd. The document may only be used for the purposes for which it was commissioned and in accordance with the Terms of Engagement for the commission. Unauthorised use of this document in any form whatsoever is prohibited.

**Document Status**

Rev No.	Author	Reviewer		Approved for Issue		
		Name	Signature	Name	Signature	Date
0	M Shrimpton	M McKibbin	<i>pp K. McNally</i>	<i>Las Soliffe</i>	<i>Las Soliffe</i>	<i>14.8.06</i>