

This portion of Collector Rd A is on Dial A Dump Land to be constructed and dedicated with Dial A Dumps consent as agreed with DAD.

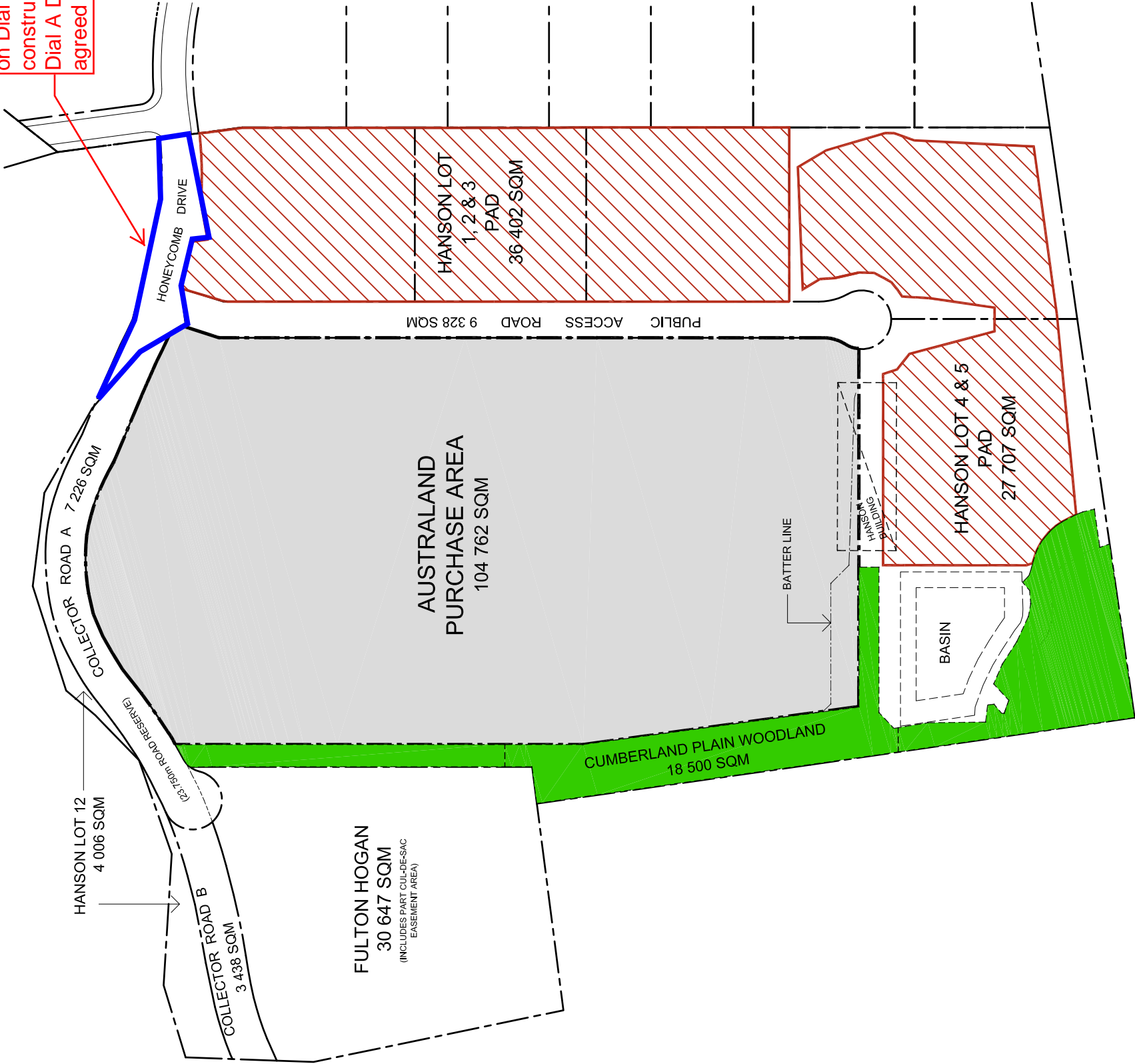

DEVELOPMENT AREAS	
TOTAL HANSON SITE AREA	100 093 SQM
INTERNAL ACCESS ROAD	9 328 SQM
PRECINCT COLLECTOR ROAD "A"	7 226 SQM
PRECINCT COLLECTOR ROAD "B"	3 438 SQM
FULTON HOGAN SITE AREA	30 647 SQM
HANSON LOT 12	4 006 SQM
AUSTRALAND PURCHASE AREA	104 762 SQM
OVERALL SITE AREA	259 500 SQM

WORKING PLATFORM	
HANSON LOTS 1, 2 & 3 PAD	36 402 SQM
HANSON LOTS 4 & 5 PAD	27 707 SQM

CUMBERLAND PLAIN WOODLAND	18 500 SQM
---------------------------	------------



SYDNEY
LEVEL3
1C Homebush Bay Drive
Rhodes
NSW 1670
TEL: 02 9767 2000 FAX: 02 9767 2933

HANSON SITE

HANSON LAND, EASTERN CREEK

PROPOSED SITE PLAN

© 2006 AUSTRALAND HOLDINGS LTD
These drawings are subject to copyright and may not be copied, used or reproduced in any way without the express permission of Australand Holdings Pty Ltd.
All Areas written on drawings are approximate only and are subject to confirmation by survey.

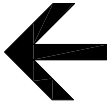

SCALE SCALE 1:1500 @ A1	
JOB MP - HN - SKN - 002	REV
DATE 29.04.15	MR C