

LAND AND PROPERTY INFORMATION NEW SOUTH WALES - TITLE SEARCH

FOLIO: 32/1117408

SEARCH DATE	TIME	EDITION NO	DATE
24/10/2016	3:53 PM	3	27/8/2015

LAND

LOT 32 IN DEPOSITED PLAN 1117408  
AT MORISSET PARK  
LOCAL GOVERNMENT AREA LAKE MACQUARIE  
PARISH OF MORISSET COUNTY OF NORTHUMBERLAND  
TITLE DIAGRAM DP1117408

FIRST SCHEDULE

COUNCIL OF THE CITY OF LAKE MACQUARIE (RA AF417909)

SECOND SCHEDULE (9 NOTIFICATIONS)

- 1 DP1119836 RIGHT TO MAINTAIN STRUCTURES AND RIGHT OF ACCESS 19 METRE(S) WIDE AND VARIABLE AFFECTING THE PART(S) SHOWN SO BURDENED IN DP1119836
- 2 DP1119836 RIGHT TO MAINTAIN STRUCTURES AND SERVICES AND RIGHT OF ACCESS 9 METRE(S) WIDE REFERRED TO AND NUMBERED (2) IN THE S.88B INSTRUMENT AFFECTING THE PART(S) SHOWN SO BURDENED IN DP1119836
- 3 DP1119836 RIGHT TO MAINTAIN STRUCTURES AND SERVICES AND RIGHT OF ACCESS 9 METRE(S) WIDE REFERRED TO AND NUMBERED (3) IN THE S.88B INSTRUMENT AFFECTING THE PART(S) SHOWN SO BURDENED IN DP1119836
- 4 DP1119836 RIGHT TO MAINTAIN STRUCTURES AND RIGHT OF ACCESS VARIABLE WIDTH AFFECTING THE PART(S) SHOWN SO BURDENED IN DP1119836
- 5 DP1119836 RIGHT OF CARRIAGEWAY VARIABLE WIDTH AFFECTING THE PART(S) SHOWN SO BURDENED IN DP1119836
- 6 AF417909 LAND EXCLUDES MINERALS (S.141 PUBLIC WORKS ACT, 1912)
- 7 AF417909 THE MINERALS ARE COMPRISED IN 32/1152568
- 8 DP1212018 EASEMENT FOR WASTE WATER PUMPING STATION 30 METRE(S) WIDE REFERRED TO AND NUMBERED (1) IN THE S.88B INSTRUMENT AFFECTING THE PART(S) SHOWN SO BURDENED IN DP1212018
- 9 DP1212018 EASEMENT FOR PIPELINE 3 AND 6 METRE(S) WIDE AFFECTING THE PART(S) SHOWN SO BURDENED IN DP1212018

NOTATIONS

UNREGISTERED DEALINGS: NIL

\*\*\* END OF SEARCH \*\*\*

37429(4)

PRINTED ON 24/10/2016

LAND AND PROPERTY INFORMATION NEW SOUTH WALES - TITLE SEARCH

FOLIO: 31/1117408

SEARCH DATE	TIME	EDITION NO	DATE
24/10/2016	3:53 PM	4	6/4/2016

LAND

LOT 31 IN DEPOSITED PLAN 1117408  
AT MORISSET PARK  
LOCAL GOVERNMENT AREA LAKE MACQUARIE  
PARISH OF MORISSET COUNTY OF NORTHUMBERLAND  
TITLE DIAGRAM DP1117408

FIRST SCHEDULE

TRINITY POINT HOLDINGS8 PTY LIMITED (T AK265840)

SECOND SCHEDULE (6 NOTIFICATIONS)

- 1 RESERVATIONS AND CONDITIONS IN THE CROWN GRANT(S)
- 2 DP1119836 RIGHT TO MAINTAIN STRUCTURES AND RIGHT OF ACCESS 19  
METRE(S) WIDE AND VARIABLE APPURTENANT TO THE LAND  
ABOVE DESCRIBED
- 3 DP1119836 RIGHT TO MAINTAIN STRUCTURES AND SERVICES AND RIGHT  
OF ACCESS 9 METRE(S) WIDE REFERRED TO AND NUMBERED (2)  
IN THE S.88B INSTRUMENT APPURTENANT TO THE LAND ABOVE  
DESCRIBED
- 4 DP1119836 RIGHT TO MAINTAIN STRUCTURES AND SERVICES AND RIGHT  
OF ACCESS 9 METRE(S) WIDE REFERRED TO AND NUMBERED (3)  
IN THE S.88B INSTRUMENT APPURTENANT TO THE LAND ABOVE  
DESCRIBED
- 5 DP1119836 RIGHT TO MAINTAIN STRUCTURES AND RIGHT OF ACCESS  
VARIABLE WIDTH APPURTENANT TO THE LAND ABOVE DESCRIBED
- 6 DP1119836 RIGHT OF CARRIAGEWAY VARIABLE WIDTH APPURTENANT TO  
THE LAND ABOVE DESCRIBED

NOTATIONS

UNREGISTERED DEALINGS: NIL

\*\*\* END OF SEARCH \*\*\*

100000

SCHEDULE OF REFERENCE MARKS			
MARK	BEARING	DISTANCE	COMMENTS
A	324°10'	3.795	RM GIP FD (DP 1101147)
B	83°14'20"	4.505	RM PM 58712 FD (DP107609)
C	181°22'	0.98	RM PM 58712 FD (DP107609)
D	181°10'	0.9	RM GIP
E	160°57"	0.99	RM GIP FD (DP 1107753)
F	256°39'	0.985	RM GIP
G	24°49'	1.0	RM GIP FD (DP1101147)

NUMBERING OF EASEMENT | SITE AMENDED & DIAG. 3 ADDED IN LPI | AT SURVEYOR'S REQUEST | VIDE 2007/2246

CERTIFICATES, SIGNATURES AND SEALS

Sheet 1 of 1 sheet(s)

PLAN OF

SUBDIVISION OF LOT 2  
DP 1107753 & RIGHT OF  
CARRIAGEWAY OVER  
LOT 1 DP 1107753.

DP1117408

Registered: 8.11.2007

Surveying Regulation, 2006

I. STEPHEN J LAWLER  
of SURDEVEL PTY. LTD. P.O.BOX 300 SWANSEA 2281  
a surveyor registered under the *Surveying Act, 2002*, certify that the  
survey represented in this plan is accurate, has been made in  
accordance with the *Surveying Regulation, 2006* and was completed  
on: 17 MAY 2007

The survey relates to LOTS 31 – 34 inclusive

(specify the land actually surveyed or specify any land shown in the  
plan that is not the subject of the survey)

Signature: *Stephen Lawler* Dated: 18.10.07  
Surveyor registered under the *Surveying Act, 2002*

Datum Line: 'X' - 'Y'  
Type: Urban/Rural

Crown Lands NSW/Western Lands Office Approval

I.....in approving this plan certify  
(Authorised Officer)  
that all necessary approvals in regard to the allocation of the land  
shown herein have been given

Signature:.....  
Date:.....  
File Number:.....  
Office:.....

Subdivision Certificate

I certify that the provisions of s.109J of the Environmental Planning and  
Assessment Act 1979 have been satisfied in relation to:

the proposed..... SUBDIVISION..... set out herein  
(insert 'subdivision' or 'new road')

*L Field*

\* Authorised Person/General Manager/Accredited Certifier

Consent Authority: Lake Macquarie City Council  
Date of Endorsement: 22 October 2007  
Accreditation no:.....  
Subdivision Certificate no: 52/2007  
File no: DA/320/2007

\* Delete whichever is inapplicable.

SIGNATURES, SEALS and STATEMENTS of intention  
to dedicate public roads or to create public reserves  
and drainage reserves.

*K. Jones*  
The Trustees of the Hospitalier Brothers  
of St John of God acting by its  
duly authorised attorney Kendal Grange  
Properties Pty Ltd Book 4480 No 607 in  
the presence of: *Bye RW*

Witness

*BRYAN GARLAND*

Name

338 KENT ST SYDNEY

Address

SIGNED FOR ON BEHALF OF

ST GEORGE BANK LIMITED A.C.N. 055 513 070  
BY ITS ATTORNEYS *CYRIL CRASTO* AND  
*Joseph E. Haddon* PURSUANT TO POWER  
OF ATTORNEY REGISTERED NO. 125 BOOK 4182

*Joseph E. Haddon*  
Executed by Cresham Property Fund Management  
Limited ACN 092 191 270 in accordance with  
its Constitution in the presence of.....

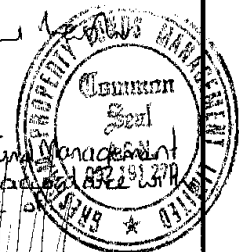

*Grams Rich*  
Director

*PHILIP MANWICK*  
Director/Secretary

Use PLAN FORM 6A for additional  
certificates, signatures and seals

SURVEYOR'S REFERENCE: 1320-1C

\* OFFICE USE ONLY



Plot Date: 04/09/14 - 16:11 Cad File: N:\37429\37429(3)\Dwg\37429(3)-DET-001-A.dwg

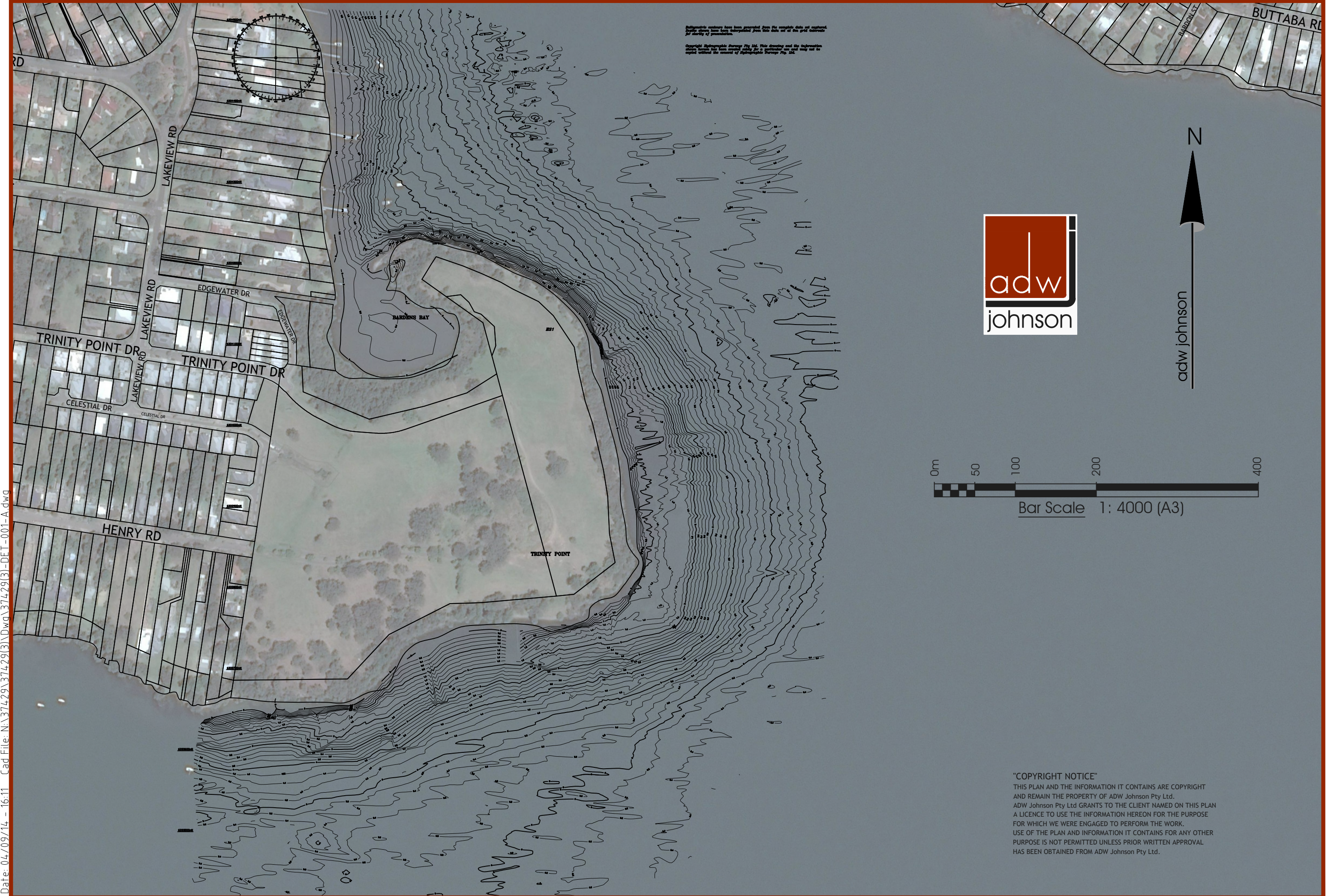

Topographic contours have been generated from the complete data set captured. Digital contours have been interpolated from 10m data set of 5m grid intervals for clarity of presentation.

Copyright Hydrographic Surveying Pty Ltd. This drawing and the information herein have been created solely for a particular use and may not be copied without the consent of Hydrographic Surveying Pty Ltd.

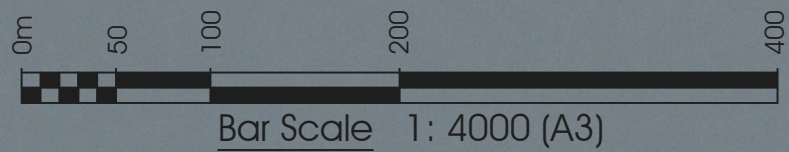

"COPYRIGHT NOTICE"

THIS PLAN AND THE INFORMATION IT CONTAINS ARE COPYRIGHT AND REMAIN THE PROPERTY OF ADW Johnson Pty Ltd. ADW Johnson Pty Ltd GRANTS TO THE CLIENT NAMED ON THIS PLAN A LICENCE TO USE THE INFORMATION HEREON FOR THE PURPOSE FOR WHICH WE WERE ENGAGED TO PERFORM THE WORK. USE OF THE PLAN AND INFORMATION IT CONTAINS FOR ANY OTHER PURPOSE IS NOT PERMITTED UNLESS PRIOR WRITTEN APPROVAL HAS BEEN OBTAINED FROM ADW Johnson Pty Ltd.