

LEGEND

SURROUNDING/EXISTING BUILD. SHADOW

APPROVED PROJECT SHADOW

PROPOSED PROJECT SHADOW

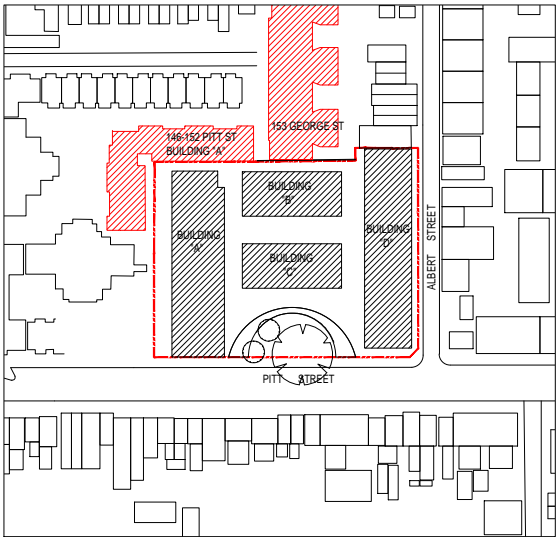

146 - 152 Pitt Street - BUILDING A, EAST FACADE 21st JUNE

The facade consist of upper level bedroom and bathroom windows and ground level services and backyard.

hour	APPROVED PROJECT (impact to bedroom windows)	PROPOSED PROJECT (impact to bedroom windows)	IMPACT
9:00 am	0%	0%	no impact
9:30 am	20%	20%	no impact
10:00 am	40%	40%	no impact
10:30 am	80%	80%	no impact
11:00 am	0%	0%	no impact

RESULT the proposed development shows no impact on this facade.

153 George Street - BUILDING A, EAST FACADE 21st JUNE

The facade consist of a blank heritage wall and above Level 3 there is further setback from the boundary with a north facing unit (unit C302). The unit present an opaque bedroom window to east, and east facing highlight living room window. Please refer to drawing A650 for further detail.

The overshadowing diagram shows no impact for this unit.

146 - 152 PITT STREET / 153 GEORGE STREET - EAST ELEVATION SHADOW (JUNE)

Rev.

Description

By

Date

DC

SEPT 2016

TL

MAY 2017

TL

JUL 2017

A

MODIFIED PROJECT SUBMISSION

B

FOR COORDINATION

C

ADDITIONAL INFORMATION

These drawings are preliminary drawings and are subject to change without notice during the course of the proposed development and in consultation with the relevant authorities. The drawings are not to be used for any other purpose without the written consent of the architect.

These drawings are preliminary drawings and are subject to change without notice during the course of the proposed development and in consultation with the relevant authorities. The drawings are not to be used for any other purpose without the written consent of the architect.

These drawings are preliminary drawings and are subject to change without notice during the course of the proposed development and in consultation with the relevant authorities. The drawings are not to be used for any other purpose without the written consent of the architect.

Notes

Drawings made to a larger scale and those showing particular detail or notes shall take precedence over drawings made to a smaller scale and for more general purposes.

Where any discrepancy exists between figures and scaled dimensions, the figured dimensions shall prevail.

Builder to check all site dimensions prior to fabrication of fixtures.

These documents and any works created as a result of these documents shall be subject to the copyright conditions set out in the conditions of engagement.

Legend

Consultants

dmpr

Client

KAYMET CORPORATION PTY LTD

Architects

tony blundell ptnrs

Project

RACHEL FORSTER

Project address

134 - 144 PITT STREET, REDFERN

Key plan

Scale 1:200

0m 1m 2m

Date JULY 2017

Drawing title

ELEVATION SHADOW DIAGRAM

Project no. 956

Drawing no. A652

Rev. C

Drawing status

ADDITIONAL INFORMATION