

LEGEND

- PROPOSED BOUNDARY
- STAGE 1D
- STAGE 1D (SWALE)

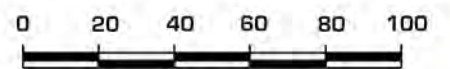

1cm = 20m
1:2000

NOTE:

This preliminary layout has been completed in accordance with the instructions provided by Clarence Property. In this respect preliminary desktop data has been used to form this layout. The final layout is subject to the completion of a detailed survey & engineering plans. Accordingly, the conclusions reached within this report may be modified by the author upon the completion of the final design plans & site inspection. Newton Denny Chapelle accepts no responsibility for any loss or damage suffered, however so arising, to any person or corporation who may use or rely on this report.

REV	DATE	AMENDMENT
B	22.07.16	BDY
C	17.08.17	BDY
D		
E		

SOURCE PLAN: N/A

k:\jobs\2013\13054 - clarence property\masterfile\planning\planning plans\ndc plans\cad files\13054 - design rev 8.dwg - p1 - stage 1d

Newton Denny Chapelle
Surveyors Planners Engineers
Email: office@newtondennychapelle.com.au
LISMORE 31 Carrington St. Lismore 2480 PH: 6622 1011
CASINO 100 Barker St. Casino 2470 PH: 6662 5000
ABN: 86 220 045 469

**P1 - SUBDIVISION LAYOUT
PLAN STAGE 1D** REV C

CLIENT: CLARENCE PROPERTY
LOCATION: CASUARINA TOWN CENTRE
CASUARINA BEACH

DATE: 17.08.17 REF: 13/054
SCALE: 1 : 2000 @ A3 DRAWN: bk

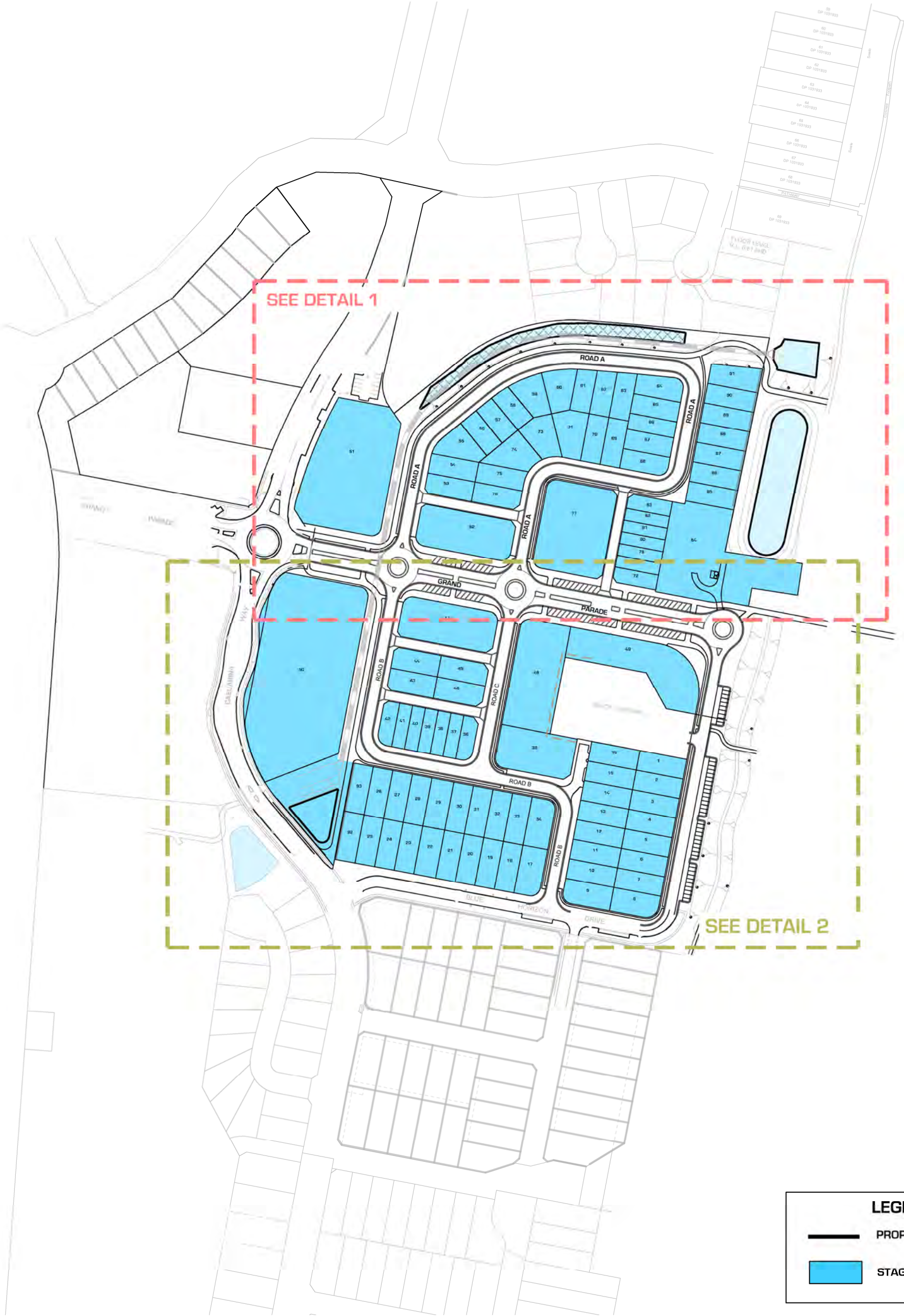
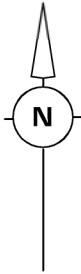

NOTE:
This preliminary layout has been completed in accordance with the instructions provided by Clarence Property.
In this respect preliminary desktop data has been used to form this layout. The final layout is subject to the completion of a detailed survey & engineering plans. Accordingly, the conclusions reached within this report may be modified by the author upon the completion of the final design plans & site inspection. Newton Denny Chapelle accepts no responsibility for any loss or damage suffered, however so arising, to any person or corporation who may use or rely on this report.

LEGEND

PROPOSED BOUNDARY

STAGE 1E

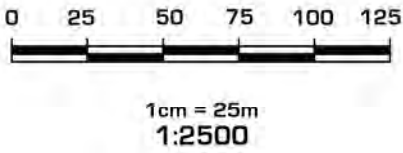

REV	DATE	AMENDMENT
B	22.07.16	BDY
C	17.08.17	BDY
D		
E		

SOURCE PLAN: N/A

k:\jobs\2013\13054 - clarence property\masterfile\planning\planning plans\ndc plans\cad files\13054 - design rev 8.dwg - p2 - stage 1e

NDC

Newton Denny Chapelle
Surveyors Planners Engineers
Email: office@newtondennychapelle.com.au
LISMORE 31 Carrington St. Lismore 2480 PH: 6622 1011
CASINO 100 Barker St. Casino 2470 PH: 6662 5000
ABN: 86 220 045 469

**P2 - SUBDIVISION LAYOUT
PLAN STAGE 1E**

CLIENT: CLARENCE PROPERTY

LOCATION: CASUARINA TOWN CENTRE
CASUARINA BEACH

DATE: 17.08.17

SCALE: 1 : 1500 @ A3

REF: 13/054

DRAWN: bk

REV C

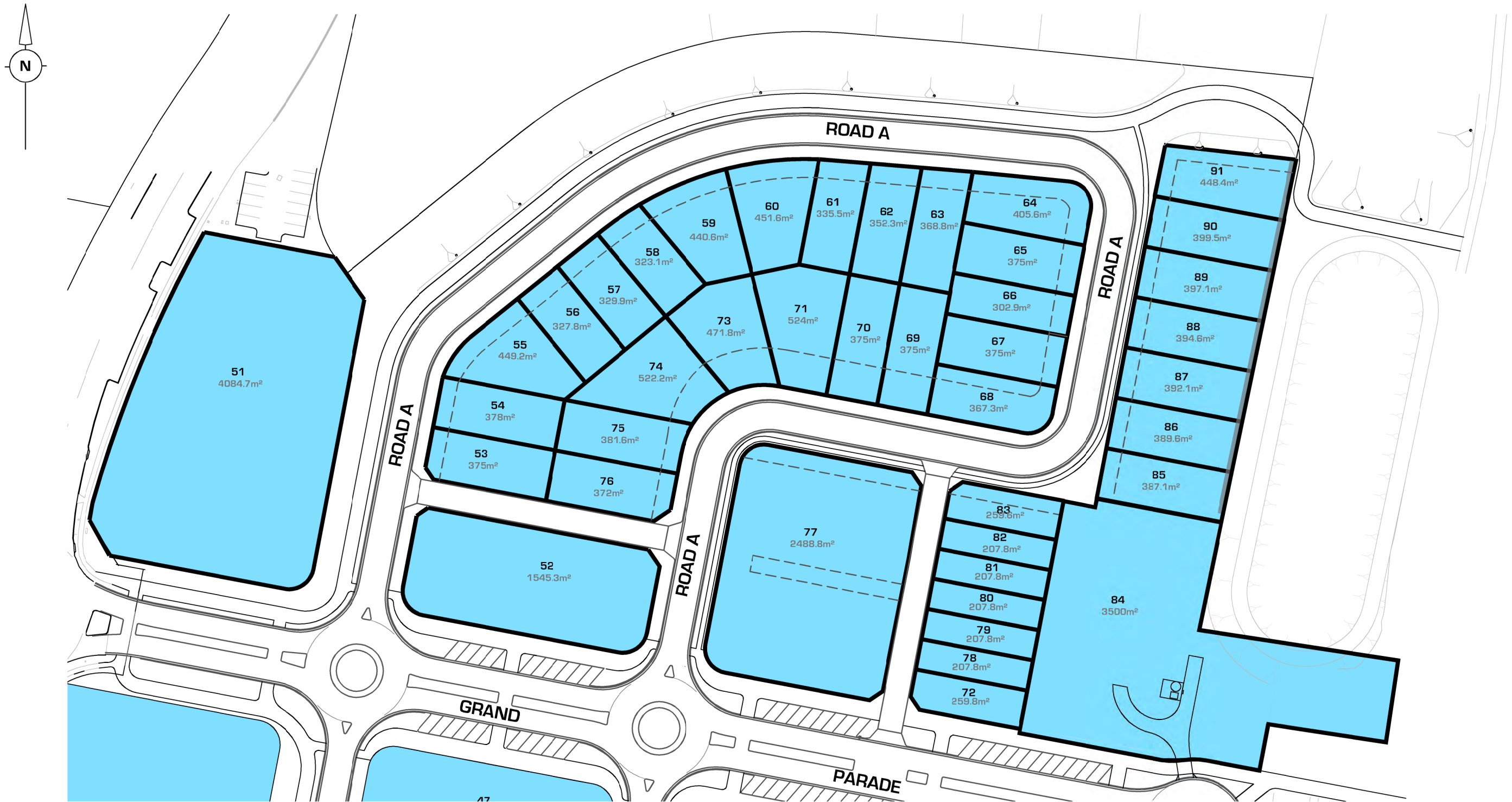

NOTE:
This preliminary layout has been completed in accordance with the instructions provided by Clarence Property. In this respect preliminary desktop data has been used to form this layout. The final layout is subject to the completion of a detailed survey & engineering plans. Accordingly, the conclusions reached within this report may be modified by the author upon the completion of the final design plans & site inspection. Newton Denny Chapelle accepts no responsibility for any loss or damage suffered, however so arising, to any person or corporation who may use or rely on this report.

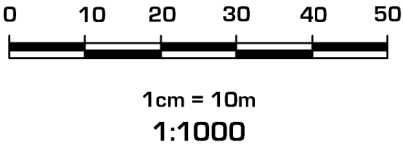

LEGEND	
	PROPOSED BOUNDARY
	EASEMENT FOR SEWER AND WATER
	STAGE 1E

REV	DATE	AMENDMENT
B	22.07.16	BDY
C	17.08.17	BDY
D		
E		

SOURCE PLAN: N/A
k:\jobs\2013\13054 - clarence property\masterfile\planning\planning plans\ndc plans\cad files\13054 - design rev 8.dwg - p3 - stage 1e detail 1

Newton Denny Chapelle
Surveyors Planners Engineers
Email: office@newtondennychapelle.com.au
LISMORE 31 Carrington St. Lismore 2480 PH: 6622 1011
CASINO 100 Barker St. Casino 2470 PH: 6662 5000
ABN: 86 220 045 469

P3 - SUBDIVISION LAYOUT PLAN STAGE 1E - DETAIL 1		
CLIENT:	CLARENCE PROPERTY	REV C
LOCATION:	CASUARINA TOWN CENTRE CASUARINA BEACH	
DATE:	17.08.17	REF: 13/054
SCALE:	1 : 1000 @ A3	DRAWN: bk

C. D. P. Y. R. I. B. H. T.
© NEWTON DENNY CHAPELLE

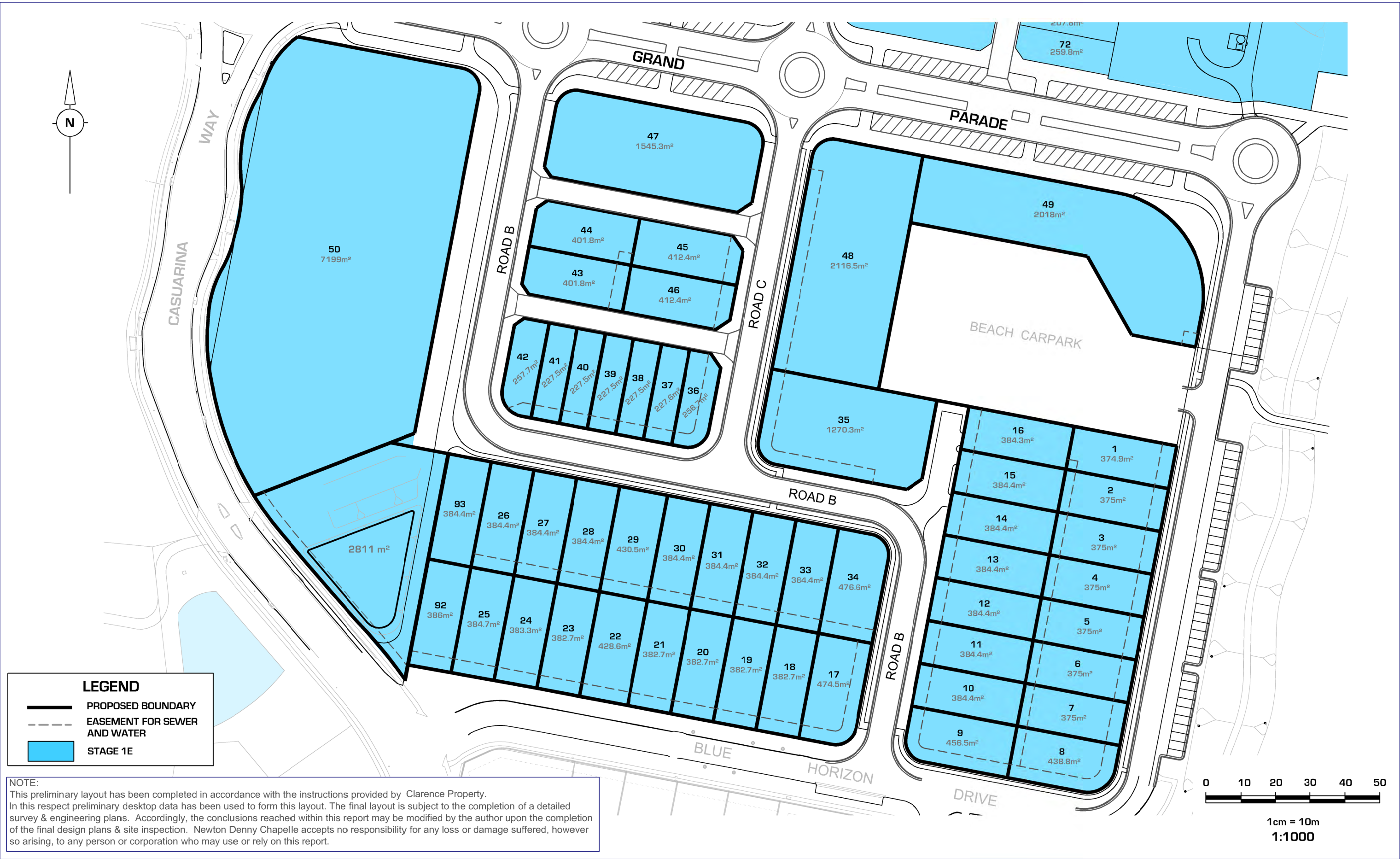

REV	DATE	AMENDMENT
B	22.07.16	BDY
C	17.08.17	BDY
D		
E		

SOURCE PLAN: N/A
k:\jobs\2013\13054 - clarence property\masterfile\planning\planning plans\ndc plans\cad files\13054 - design rev 8.dwg - p4 - stage 1e detail 2

Newton Denny Chapelle
Surveyors Planners Engineers
Email: office@newtondennychapelle.com.au
LISMORE 31 Carrington St. Lismore 2480 PH: 6622 1011
CASINO 100 Barker St. Casino 2470 PH: 6662 5000
ABN: 86 220 045 469

**P4 - SUBDIVISION LAYOUT PLAN
STAGE 1E - DETAIL 2**

CLIENT: CLARENCE PROPERTY
LOCATION: CASUARINA TOWN CENTRE
CASUARINA BEACH
DATE: 17.08.17
SCALE: 1 : 1000 @ A3
REF: 13/054
DRAWN: bk
REV C

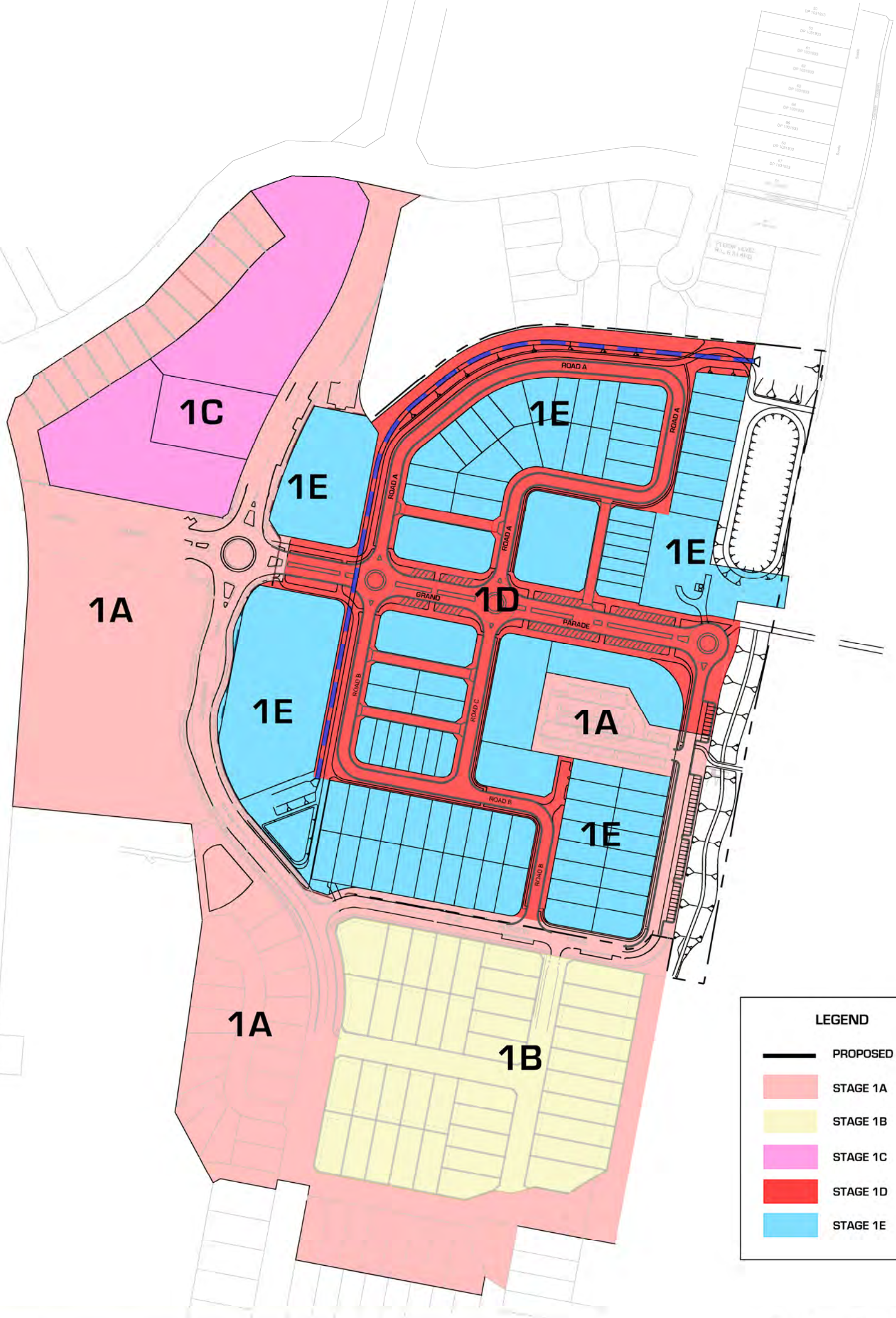
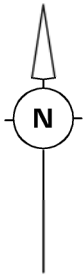

NOTE:
This preliminary layout has been completed in accordance with the instructions provided by Clarence Property.
In this respect preliminary desktop data has been used to form this layout. The final layout is subject to the completion of a detailed survey & engineering plans. Accordingly, the conclusions reached within this report may be modified by the author upon the completion of the final design plans & site inspection. Newton Denny Chapelle accepts no responsibility for any loss or damage suffered, however so arising, to any person or corporation who may use or rely on this report.

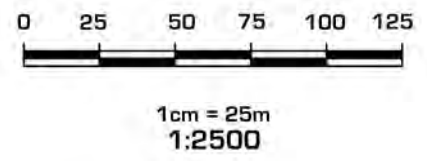

REV	DATE	AMENDMENT
B	22.07.16	BDY
C	17.08.17	BDY
D		
E		

SOURCE PLAN: N/A

k:\jobs\2013\13054 - clarence property\masterfile\planning\planning plans\ndc plans\cad files\13054 - design rev 8.dwg - p5 - sub staging plan

Newton Denny Chapelle
Surveyors Planners Engineers
Email: office@newtondennychapelle.com.au
LISMORE 31 Carrington St. Lismore 2480 PH: 6622 1011
CASINO 100 Barker St. Casino 2470 PH: 6662
5000
ABN: 86 220 045 469

P5 - SUBDIVISION STAGING PLAN
CLIENT: CLARENCE PROPERTY
LOCATION: CASUARINA TOWN CENTRE
CASUARINA BEACH
DATE: 17.08.17
SCALE: 1 : 2500 @ A3
REF: 13/054
DRAWN: bk
REV C

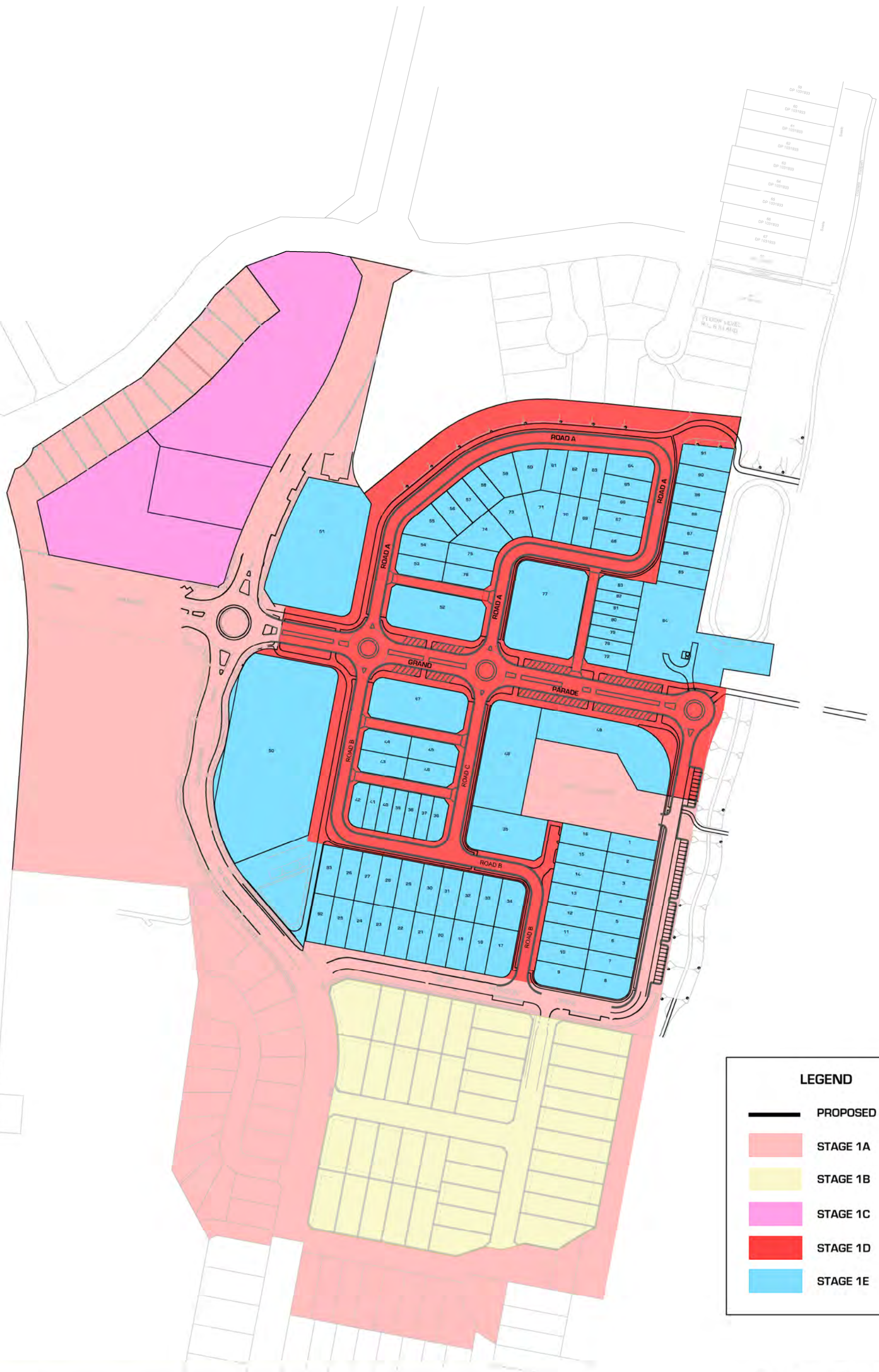
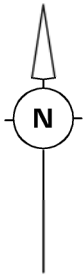

LEGEND

- PROPOSED BOUNDARY
- STAGE 1A
- STAGE 1B
- STAGE 1C
- STAGE 1D
- STAGE 1E

0 25 50 75 100 125

1cm = 25m
1:2500

NOTE:
This preliminary layout has been completed in accordance with the instructions provided by Clarence Property.
In this respect preliminary desktop data has been used to form this layout. The final layout is subject to the completion of a detailed survey & engineering plans. Accordingly, the conclusions reached within this report may be modified by the author upon the completion of the final design plans & site inspection. Newton Denny Chapelle accepts no responsibility for any loss or damage suffered, however so arising, to any person or corporation who may use or rely on this report.

REV	DATE	AMENDMENT
B	22.07.16	BDY
C	17.08.17	BDY
D		
E		

SOURCE PLAN: N/A

k:\jobs\2013\13054 - clarence property\masterfile\planning\planning plans\ndc plans\cad files\13054 - design rev 8.dwg - p6 development sequence plan

Newton Denny Chapelle
Surveyors Planners Engineers
Email: office@newtondennychapelle.com.au
LISMORE 31 Carrington St. Lismore 2480 PH: 6622 1011
CASINO 100 Barker St. Casino 2470 PH: 6662
5000
ABN: 86 220 045 469

**P6 - DEVELOPMENT
SEQUENCE PLAN**

CLIENT: CLARENCE PROPERTY
LOCATION: CASUARINA TOWN CENTRE
CASUARINA BEACH

REV C

DATE: 17.08.17
SCALE: 1 : 2500 @ A3
REF: 13/054
DRAWN: bk

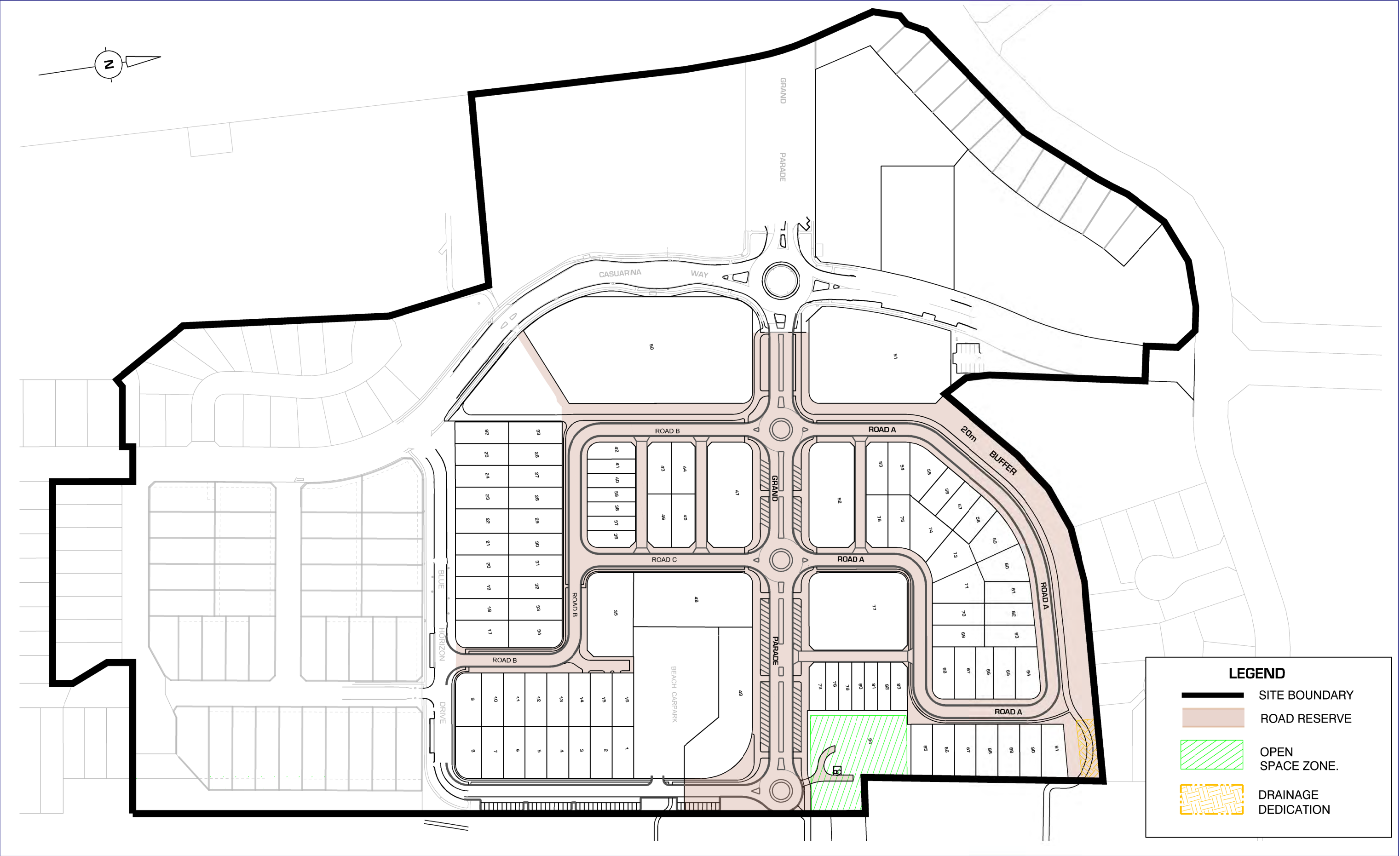

REV	DATE	AMENDMENT
B	22.07.16	BDY
C	17.08.17	BDY
D		
E		

SOURCE PLAN: N/A
k:\jobs\2013\13054 - clarence property\masterfile\planning\planning plans\ndc plans\cad files\13054 - design rev 8.dwg - p7 - stage 2 - ded & eas

Newton Denny Chapelle
Surveyors Planners Engineers
Email: office@newtondennychapelle.com.au
LISMORE 31 Carrington St. Lismore 2480 PH: 6622 1011
CASINO 100 Barker St. Casino 2470 PH: 6662 5000
ABN: 86 220 045 469

**P7 - DEDICATION & EASEMENT PLAN
STAGES 1D & 1E**

CLIENT:	CLARENCE PROPERTY	REV C
LOCATION:	CASUARINA TOWN CENTRE CASUARINA BEACH	
DATE:	17.08.17	REF: 13/054
SCALE:	1 : 1000 @ A3	DRAWN: bk

© NEWTON DENNY CHAPELLE