

8 Parsonage Street, Ryde Shepherds Bay

Views Analysis





- 1 CHURCH STREET ABOVE MORRISON
- 2 CHURCH STREET BELOW MORRISON
- 3 RYDE WHARF
- 4 RYDE BRIDGE
- 5 KING GEORGE PARK
- 6 BLAXLAND ROAD
- 7 BOWDEN STREET
- 8 BENNELONG PARK
- 9 PUBLIC WHARF KISSING POINT PARK
- 10 KOKODA MEMORIAL
- 11 WANGAL RESERVE
- 12 SETTLERS PARK - WATERVIEW STREET
- 13 MORRISON ROAD AND PRINCES STREET
- 14 HOLDMARK SITE 3
- 15 WELL STREET
- 16 MERITON BUILDING A
- 17 MERITON BUILDING D
- 18 HOLDMARK SITE 2
- 19 DAME EDITH WALKER CONVALESCENT HOSPITAL

1. Church Street above Morrison Road



MOD 1 – Approved envelope



MOD 2 - Approved envelope



S75W Envelope & DA Massing

2. Church Street below Morrison Road



MOD 1 – Approved envelope



MOD 2 - Approved envelope



S75W Envelope & DA Massing

3. Ryde Wharf



MOD 1 – Approved envelope



MOD 2 – Approved envelope



S75W Envelope & DA Massing

4. Ryde Bridge



MOD 1 – Approved envelope



MOD 2 - Approved envelope



S75W Envelope & DA Massing

5. King George Park



MOD 1 – Approved envelope



MOD 2 - Approved envelope



S75W Envelope & DA Massing

6. Blaxland Road



MOD 1 – Approved envelope



MOD 2 - Approved envelope



S75W Envelope & DA Massing

7. Bowden Street



MOD 1 – Approved envelope



MOD 2 - Approved envelope



S75W Envelope & DA Massing

8. Bennelong Park



MOD 1 – Approved envelope



MOD 2 - Approved envelope



S75W Envelope & DA Massing

9. Public Wharf Kissing Point



MOD 1 – Approved envelope



MOD 2 - Approved envelope



S75W Envelope & DA Massing

10. Kokoda Memorial



MOD 1 – Approved envelope



MOD 2 - Approved envelope



S75W Envelope & DA Massing

11. Wangal Reserve



MOD 1 – Approved envelope



MOD 2 - Approved envelope



S75W Envelope & DA Massing

12. Settlers Park - Waterview Street



MOD 1 – Approved envelope



MOD 2 - Approved envelope



S75W Envelope & DA Massing

13. Morrison Road & Princes Street *



MOD 1 – Approved envelope



MOD 2 - Approved envelope



S75W Envelope & DA Massing

* These Panoramas are indicative only

14. Holdmark Site 3 Level 2



MOD 1 – Approved envelope



MOD 2 - Approved envelope



S75W Envelope & DA Massing

14. Holdmark Site 3 Level 4



MOD 1 – Approved envelope



MOD 2 - Approved envelope



S75W Envelope & DA Massing

15. Well Street



MOD 1 – Approved envelope



MOD 2 - Approved envelope



S75W Envelope & DA Massing

16. Meriton Building D Level 5



MOD 1 – Approved envelope



MOD 2 - Approved envelope



S75W Envelope & DA Massing

17. Meriton Building A Level 3

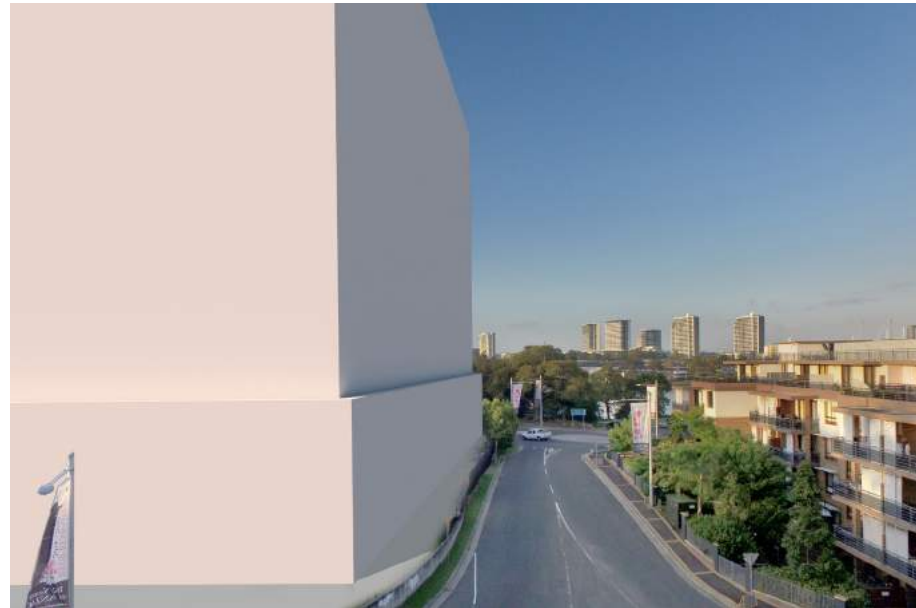

MOD 1 – Approved envelope



MOD 2 - Approved envelope



S75W Envelope & DA Massing

17. Meriton Building A Level 5

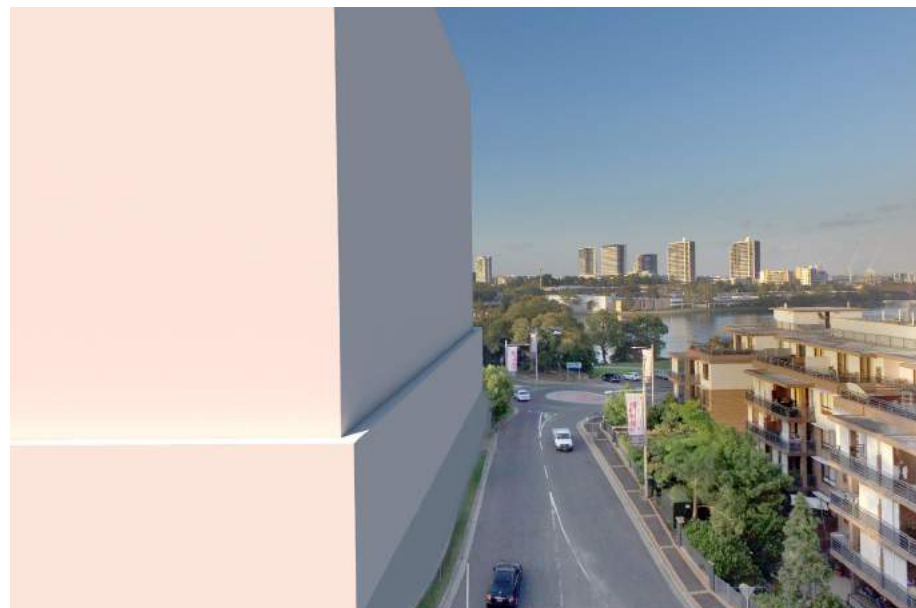

MOD 1 – Approved envelope



MOD 2 - Approved envelope



S75W Envelope & DA Massing

18. Holdmark Site 2 Level 2



MOD 1 – Approved envelope



MOD 2 - Approved envelope



S75W Envelope & DA Massing

19. Dame Eadith Walker Convalescent Hospital



MOD 1 – Approved envelope



MOD 2 - Approved envelope



S75W Envelope & DA Massing