

## 3.8 Land Previously Dedicated to Council

### Original Development Application



The land bridge [Zone C] that was part of the original Development Application has been removed in the current scheme on the basis that it will become part of the future redevelopment of Redfern Railway Station Precinct.

Legend Public / Private Open Space	
	Denotes Public Open Space Owned By AHC.
	Denotes Land Given To City Of Sydney By AHC.
	Denotes Roadways Owned By City Of Sydney.
	Denotes Public Open Space Owned By City Of Sydney.
	Denotes Private Open Space Owned By AHC.

<b>Zone A</b>	
Precinct 2 Public Domain Area	235 sqm
<b>Zone B</b>	
Precinct 3 Public Domain Area	230 sqm
<b>Zone C</b>	
Proposed New Bridge Widening	235 sqm
<b>Total</b>	700 sqm

## 3.9 Land Dedicated to Council

### Precinct 3 Development Application

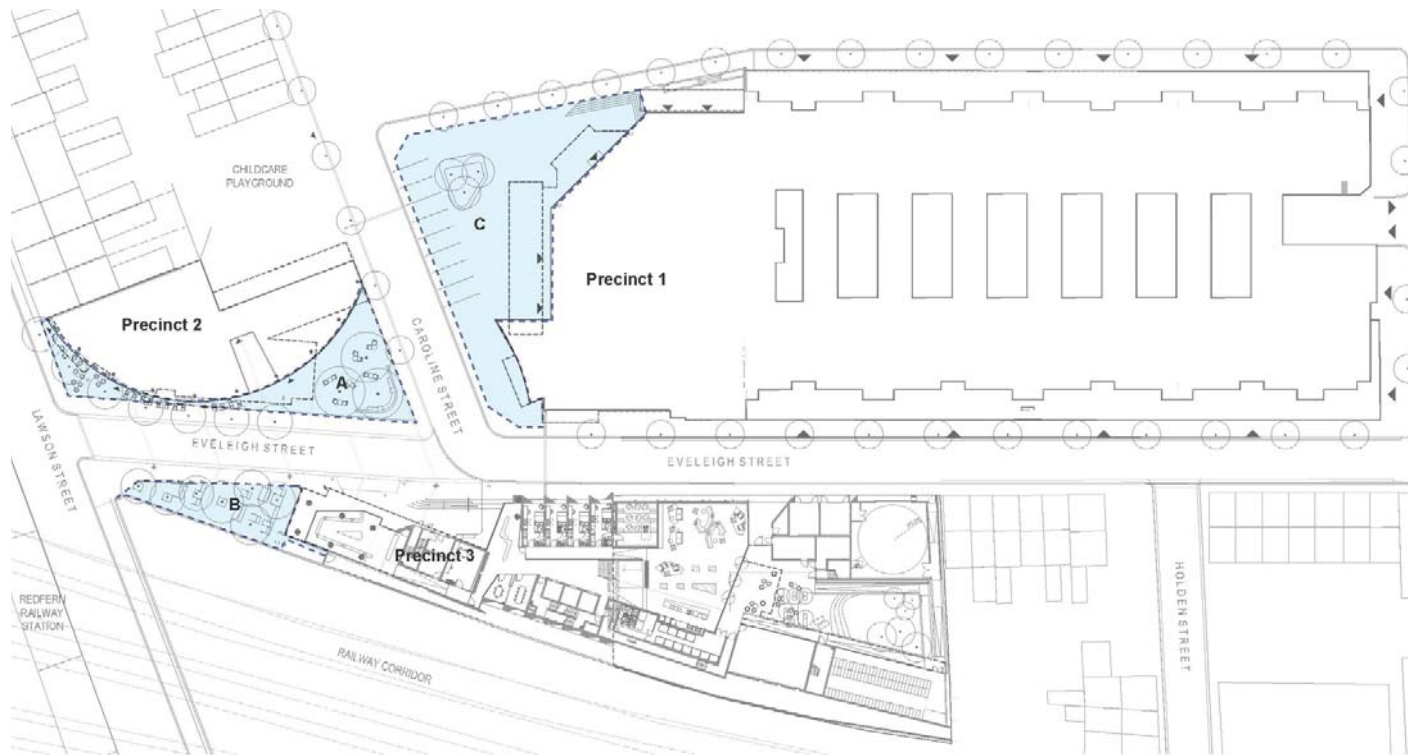

The Precinct 3 modification acknowledges an offset of Public Domain to be dedicated to City of Sydney within the Pemulwuy Precinct. This land totals 1138sqm which is an increase of 63% from the original DA.

 Denotes land given to City of Sydney by AHC

<b>Zone A</b>		
Precinct 2 Public Domain Area	235 sqm	
<b>Zone B</b>		
Precinct 3 Public Domain Area	150sqm	
<b>Zone C</b>		
Precinct 1 Public Domain Area	753 sqm	