

# SENIORS LIVING RESORT

## 9.4 Landscaping

The site will be comprehensively landscaped with the species and planting proposed complementing and improving the natural attributes of the site. The landscaping also incorporates various water sensitive urban design features including the improvement of existing detention facilities and drainage lines throughout. **Refer to Figure 27 below.**



Figure 27 - Landscape Concept



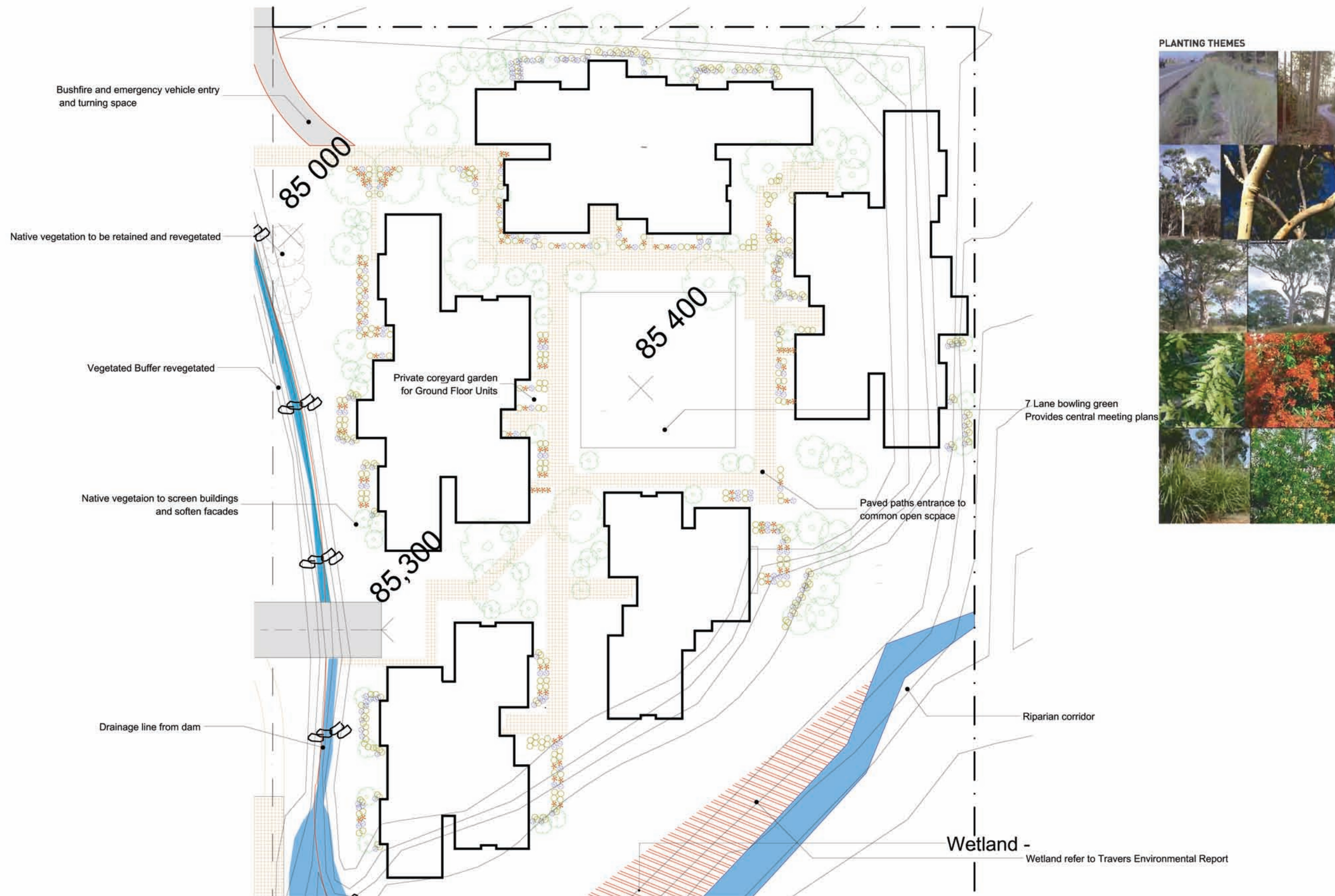
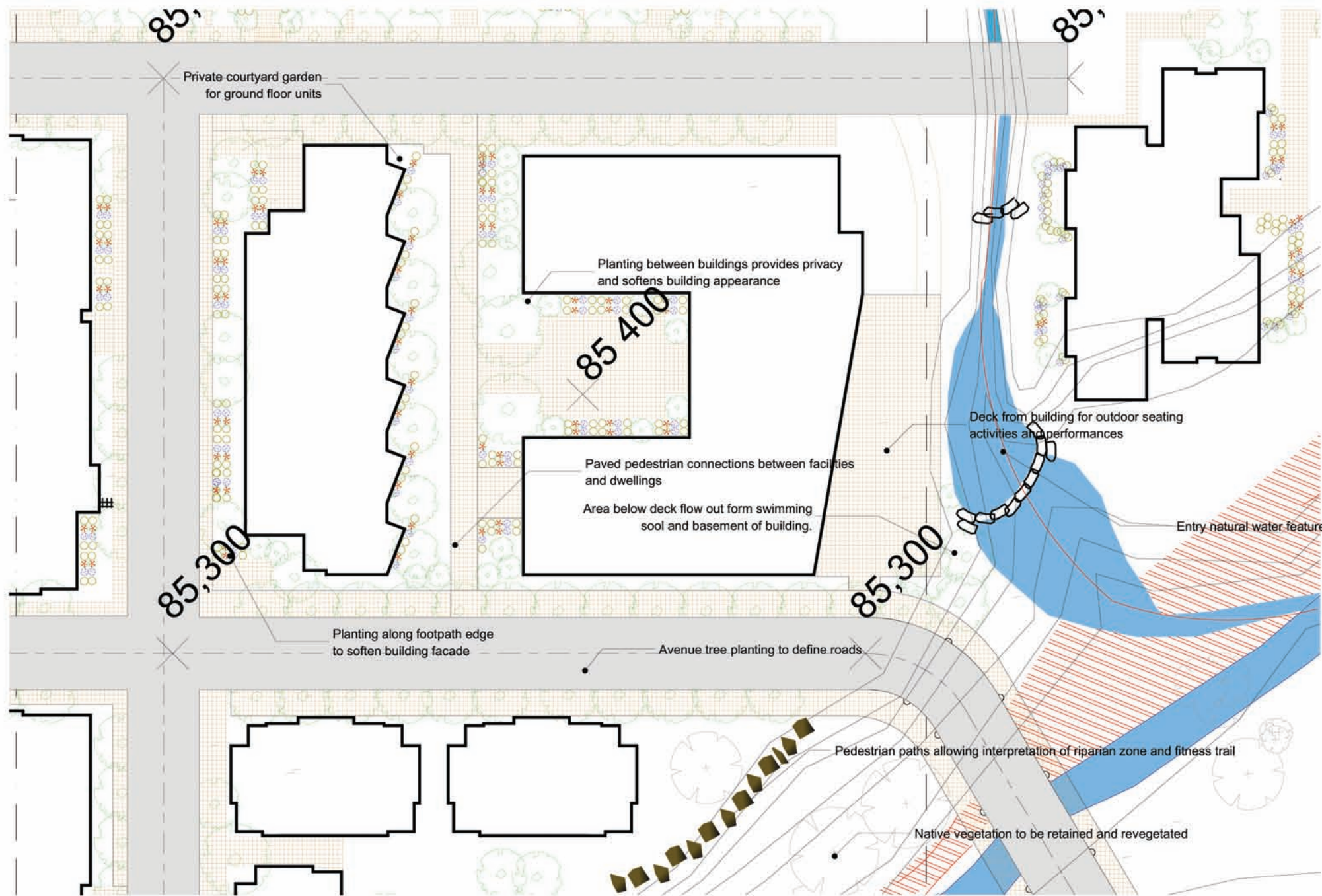

Figure 28 - Part Plan 1





PLANT SCHEDULE A

SPECIES	COMMON NAME	VEGETATION GROUP
<i>Casuarina glauca</i>	Swamp She-Oak	
<i>Allocasuarina distyla</i>	She Oak	BSGW
<i>Allocasuarina littoralis</i>	Black She-Oak	AW
<i>Melaleuca decora</i>	White Feather Honeymyrtle	
<i>Melaleuca ericifolia</i>	Swamp Paperbark	
<i>Melaleuca styphelioides</i>	Prickly-leaved Paperbark	
<i>Melaleuca nodosa</i>	Ball Honeymyrtle	
<i>Melaleuca quinquenervia</i>	Broad leaf Paperbark	
<i>Tristanopsis laurina</i>	Watergum	
<i>Syncarpia glomulifera</i>	Turpentine	
<i>Eucalyptus racemosa</i>	Narrow Leaf Scobly Gum	NSGW
<i>Eucalyptus tereticornis</i>	Forest Red Gum	
<i>Eucalyptus moluccana</i>	Grey Box	
<i>Eucalyptus longifolia</i>	Woollybutt	
<i>Eucalyptus robusta</i>	Swamp Mahogany	
<i>Eucalyptus amplifolia</i>	Cabbage Gum	
<i>Eucalyptus eugenioides</i>	Thin-leaved Stringybark	
<i>Angophora floribunda</i>	Rough Barked Apple	
<i>Angophora hispida</i>	Smooth Bark Apple	BSGW
<i>Banksia integrifolia</i>	Coastal Banksia	
<i>Banksia ericifolia</i>	Heath Leaved banksia	BSGW
<i>Banksia oblongifolia</i>	Banksia	BSGW
<i>Banksia serrata</i>	Old Man Banksia	BSGW
<i>Banksia spinulosa</i>	Hairpin Banksia	BSGW
<i>Corymbia gumulifera</i>	Red Bloodwood	BSGW
<i>Eucalyptus haemastoma</i>	Broad Leaved Scobly Gum	BSGW
<i>Eucalyptus sieben</i>	Silvertop Ash	BSGW
<i>Eucalyptus oblonga</i>	Sandstone Stringybark	NSGW
<i>Angophora costata</i>	Sydney Red Gum	AW
<i>Eucalyptus piperita</i>	Sydney Peppermint	AW
<i>Eucalyptus umbra</i>	Broad Leaf white mahogany	AW
<i>Leptospermum polygalifolium</i>	Lemon-scented Tea-tree	
<i>Acacia parramattensis</i>	Parramatta Green Wattle	
<i>Acacia ulicifolia</i>	Prickly Moses	
<i>Acacia falcata</i>	Hickory Wattle	
<i>Acacia floribunda</i>	White Sallow Wattle	
<i>Acacia intifolia</i>	Flax Leaved Wattle	AW
<i>Acacia suaveolens</i>	Wattle	BSGW
<i>Actinotus minor</i>	Lesser Flannel Flower	BSGW
<i>Acacia longifolia var longifolia</i>	Sydney Golden Wattle	
<i>Hibbertia aspera</i>	Rough Guinea Flower	
<i>Hibbertia diffusa</i>	Showy Guinea Flower	
<i>Onalanthus populifolius</i>	Bleeding Heart	
<i>Daviesia ulicifolia</i>	Bitter pea	
<i>Indigofera australis</i>	Native Indigo	
<i>Callistemon linearis</i>	Narrow-leaved Bottlebrush	
<i>Callistemon rigidus</i>	Stiff Bottlebrush	
<i>Leptospermum trinervium</i>	Paperbark Tea-tree	
<i>Hakea bakerana</i>	Hakea	
<i>Hakea sericea</i>	Bushy Needlebrush	
<i>Bursaria spinosa</i>	Blackthorn	
<i>Personia linearis</i>	Narrow-leaved Geebung	
<i>Leptospermum laevigatum</i>	Coastal Tea tree	BSGW
<i>Leptospermum squarrosum</i>	Tea Tree	
<i>Dodonaea triquetra</i>	Common Hop Bush	
<i>Lasopetalum parvifolium</i>		
<i>Boronia ledifolia</i>	Showy Boronia	BSGW
<i>Boronia pinnata</i>	Boronia	BSGW
<i>Boronia heterophylla</i>	Broom Pea	BSGW
<i>Cassipoua pubescens</i>	Downy Dodder Laurel	BSGW
<i>Dampiera stricta</i>	Blue Dampiera	BSGW
<i>Dilwynia retorta</i>	Parrot Pea	BSGW
<i>Epacris pulchella</i>	Common heath	BSGW
<i>Grevillea buxifolia</i>	Box Grevillea	BSGW
<i>Grevillea speciosa</i>	Grevillea	BSGW
<i>Hakea teretifolia</i>	Hakea	BSGW
<i>Lambertia formosa</i>	Honey Flower	BSGW
<i>Leucopogon microphyllus</i>	Heath	BSGW
<i>Persoonia levis</i>	Geebung	BSGW
<i>Pimelea linifolia</i>	Desert Rice flower	BSGW
<i>Pultenaea stipularis</i>	Bush Pea	BSGW
<i>Xanthorrhoea media</i>	Dwarf Grass Tree	BSGW
<i>Xanthorrhoea arborea</i>	Grass Tree	AW
<i>Eriostemon australis</i>	Wax Flower	NSGW
<i>Vinelandia covallifolia</i>		
<i>Pandorea pandorana</i>	Wonga Wonga Vine	
<i>Kennedia rubicunda</i>	Dusky Coral Pea	
<i>Hardenbergia violacea</i>	False Sarsaparilla	
<i>Geranium homeanum</i>	Northern Cranesbill	
<i>Geranium solanderi var solanderi</i>	Cutleaf Cranesbill	
<i>Hydrocotyle pedunculata</i>	Hydrocotyle	
<i>Clematis anisata</i>	Old Man's Beard	
<i>Clematis glycinoides</i>	Forest Clematis	
<i>Centella asiatica</i>	Pennywort	
<i>Dichondra repens</i>	Kidney Weed	
<i>Convolvulus erubescens</i>	Native Morning glory	
<i>Xanthosia tridentata</i>		BSGW
<i>Pratia purpurascens</i>	White Root	AW
<i>Smilax glyciphylla</i>	Sarsaparilla	
<i>Themeda australis</i>	Kangaroo Grass	
<i>Lomandra longifolia</i>	Mat Rush	AW
<i>Lomandra glauca</i>	Mat Rush	BSGW
<i>Anisopogon avenaceus</i>	Oat Speargrass	
<i>Danthonia tenuior</i>	Kangaroo grass	
<i>Dichelachne micrantha</i>	Shorthair Plume Grass	
<i>Entolasia stricta</i>		
<i>Microleuca stipoides</i>	Weeping Grass	NSGW
<i>Stipa pubescens</i>	Tall Speargrass	
<i>Poa affinis</i>	Poa	
<i>Petersonia glabrata</i>	Spiry Headed Rush	BSGW
<i>Schoenus imberbis</i>		BSGW
<i>Imperata cylindrica</i>	Blood Grass	AW
<i>Anisopogon avenaceus</i>	Spear Grass	BSGW
<i>Austrostipa pubescens</i>	Tuckers Spear grass	BSGW
<i>Adiantum aethiopicum</i>	Maiden hair Fern	
<i>Asplenium australasicum</i>	Birds Nest Fern	
<i>Blechnum indicum</i>	Swamp Fern	
<i>Doodia aspera</i>	Rasp Fern	
<i>Cyathea australis</i>	Tree Fern	
<i>Pteris tremula</i>	Tassel Fern	
<i>Schizaea dichotoma</i>		
<i>Macrozamia communis</i>	Barrawang	



PLANTING THEMES

Figure 29 - Part Plan 2



9.5 Associated services and facilities

A number of the existing buildings on site including the Tennis Academy building along Oxford Falls Road and the three dwellings on the western portion of the site that connect to Barnes Road will be retained to provide social services and living quarters for permanent on site staff.

All residents will have access to a range of recreational, retail, office and support facilities.

Residents in the serviced apartments and independent living apartments will have access to the following services:

- General laundry and cleaning;
- On-site staff to provide:
  - Emergency assistance;
  - Assistance with personal care, mobility and communication;
  - Meals (including special diets);
  - Social activities; and
  - Support for people with dementia.

Residents in the high care facility will have access to additional services such as mobility aids, basic medication, therapy services and registered nurses to assess, plan and manage residents’ care.

- All services and facilities identified on site will be accessible to residents with a continuous path to be provided.

Additional services and facilities that will be provided within the site are outlined in the table below.

Facility	Location
Small medical centre, with rooms for full time doctor and nursing staff, and space for visiting specialists, doctor's residence	Tennis Academy building
Serviced office facility, with administrative support e.g. desks, phone, PC, FAX, photocopying services, etc. To be available for residents' use and/or for visiting financial advisors, lawyers, accountants, and other professionals	Tennis Academy building
Overnight accommodation for up to 10 visiting relatives and friends	Tennis Academy building
Retail centre comprising mini supermarket, hair and beauty care, ATM machine, fitness/diet centre, multi-purpose store including news agency, postage, dry cleaning/laundry service, books, video hire, tours and travel agency, and theatre bookings. Services of full time entertainment and travel agent.	Basement level of serviced apartment building
One licensed restaurant, a bistro and barbecue areas, take away food shop, internet coffee shop.	Tennis Academy building
Gymnasium that can also be used for various functions e.g. dancing, entertainment, live shows, etc.	Basement level of serviced apartment building
Heated indoor swimming pool, aquarobics and other water activities	Basement level of serviced apartment building
Craft workshop that can be used for woodwork, metal, ceramics and painting	Basement level of serviced apartment building
A full time resident caretaker and a full time estate manager	Tennis Academy building
Full time on-site security, consisting of security patrols and video surveillance, and emergency call service	Tennis Academy building
Club house and lounges, library, billiards room, lecture theatre	Spali House
A full time handyman and several permanent gardeners will be located on-site, and a green and hot house will be provided for residents to participate in gardening	Basement level of serviced apartment building, Spali House
Two buses, one of which will be used permanently as a shuttle for residents to go shopping, etc., and the other to be used for tours, outings, etc. When not used for tours, the second bus would be available for shopping trips.	



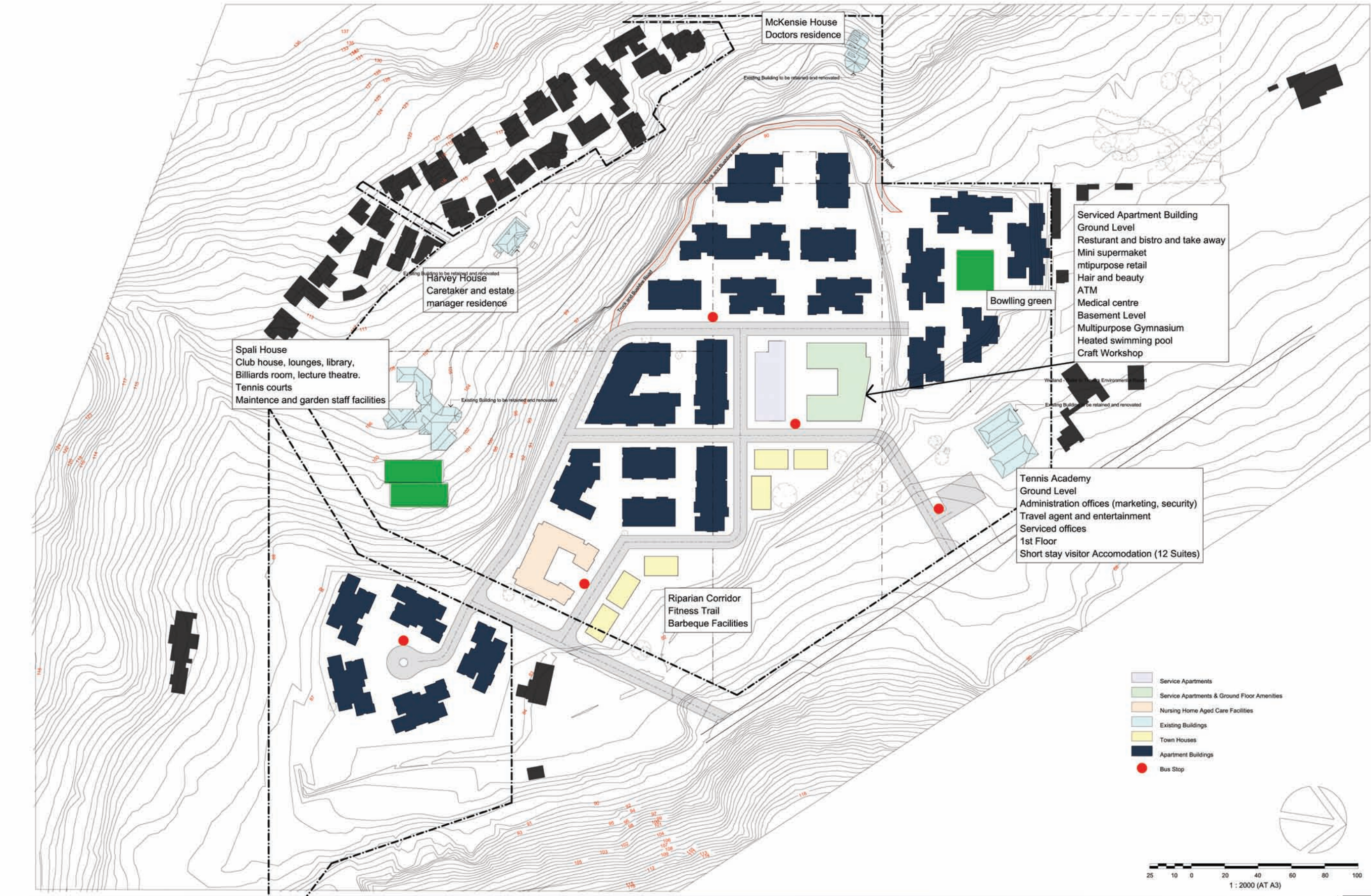

Figure 30 - Communal Facilities and Services Plan