

# Background Overview



The University of Technology Sydney (UTS) recently lodged an application to modify the current Concept Plan for the UTS City Campus Broadway Precinct.

The modification seeks to provide the University with future opportunities to deliver vibrant, new and significantly improved facilities within the UTS Bon Marche and Science precinct along Harris and Thomas streets in Ultimo.

This future-looking proposal is part of a broader masterplan vision to accommodate the University's long-term future growth and deliver an engaging, cutting-edge education precinct at the southern end of Sydney's CBD.



□ The Site

Not to scale

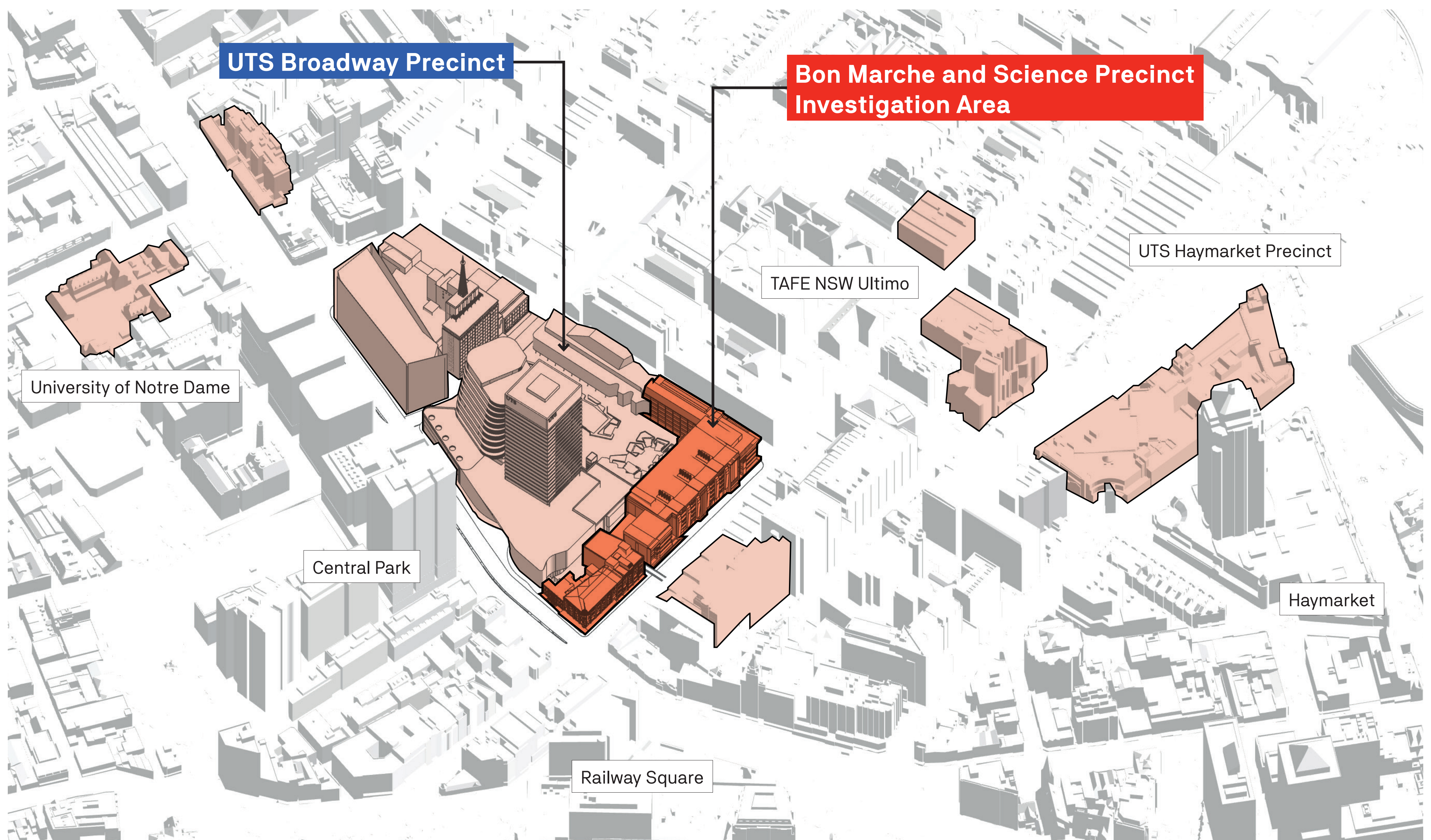



# Proposed Building Envelope



UTS are exploring opportunities for potential redevelopment of and improvements to their campus, and planning for the future to ensure that the university remains at the cutting edge of teaching, learning, research and sustainability.

Over the past decade development has been guided by the Campus Master Plan, a \$1 billion-plus investment that has transformed the UTS campus. Planning for the future is now underway, in order to deliver the infrastructure that will support and facilitate ongoing changes in teaching methodology and technology, as well as potential growth of the university community.

The proposed envelope responds to the following design analysis criteria and is based on the principles noted below:

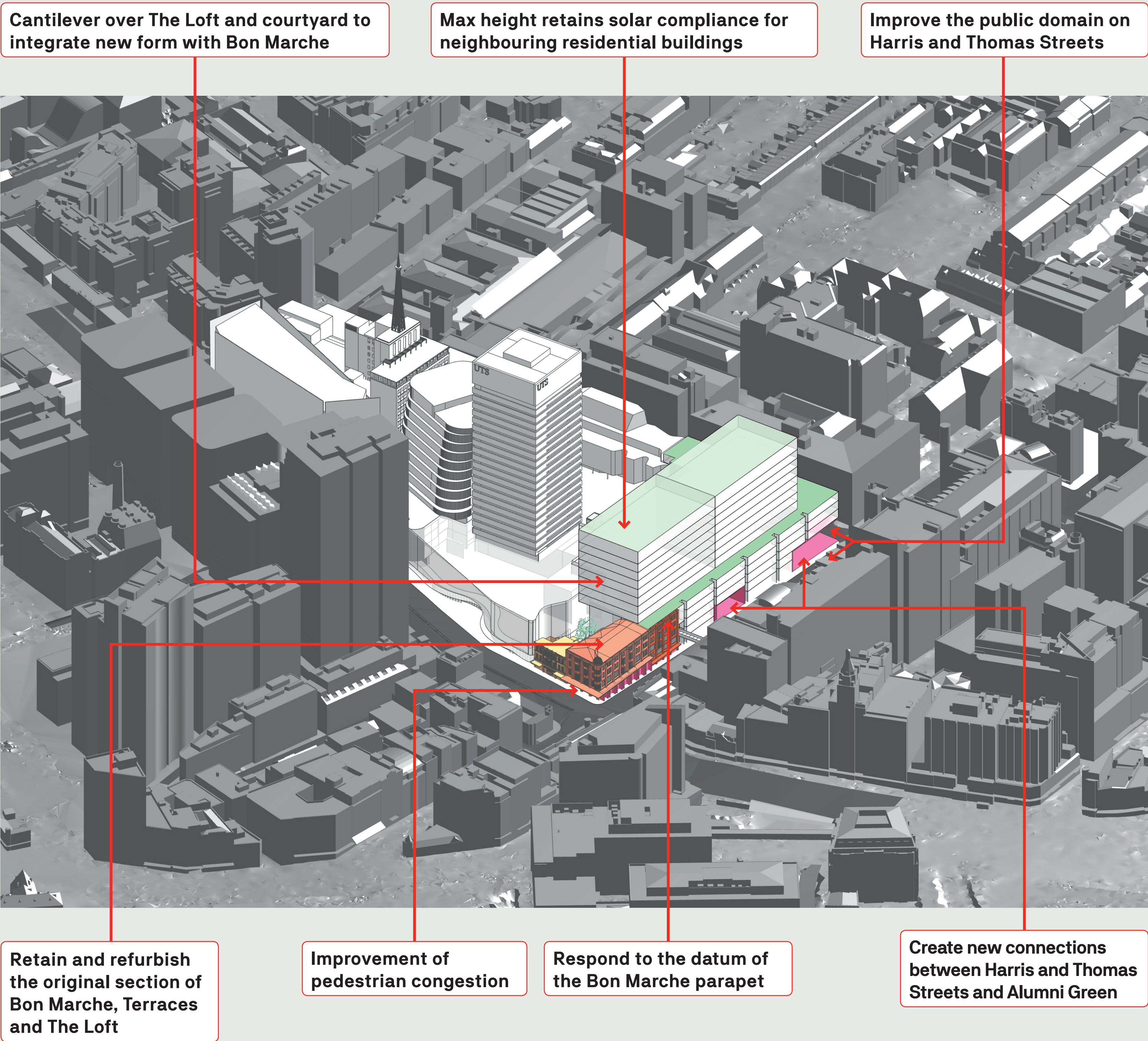
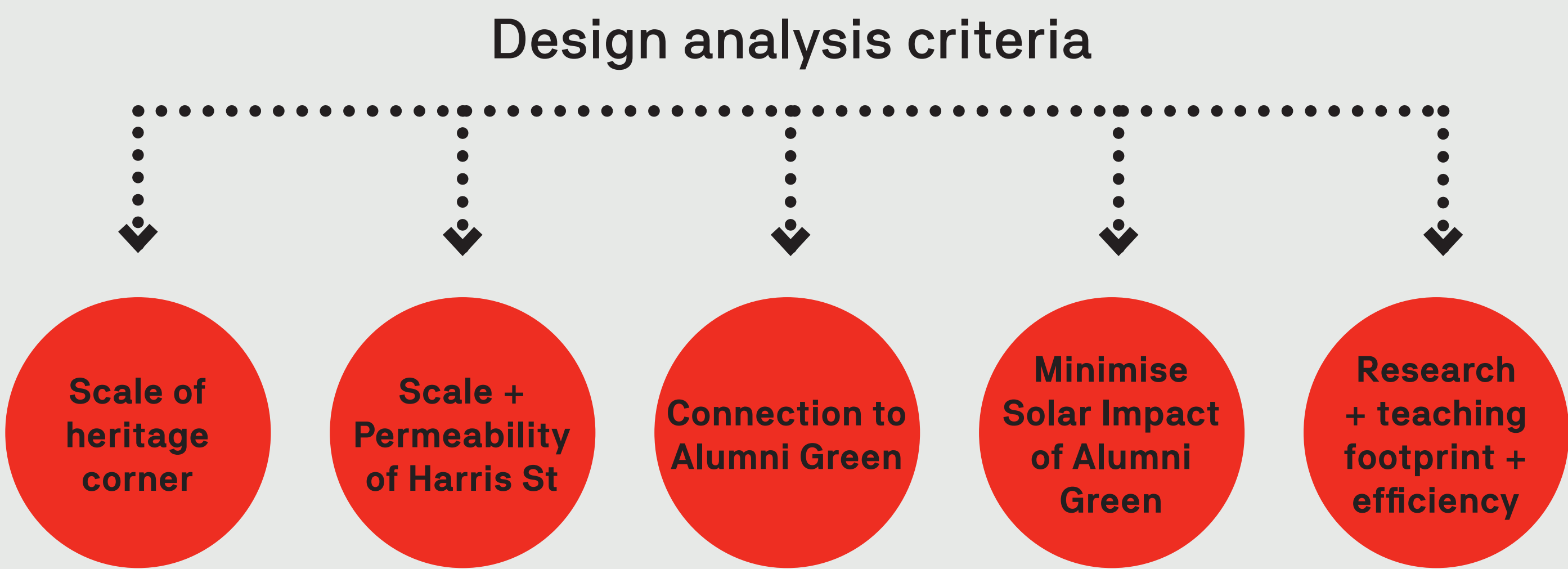



# Building Envelope Comparison



The proposed control envelope is based on demolishing Building 4 in its entirety as well as the rear wing of the Bon Marche addition behind the facade, and refurbishing the original southernmost section of Bon Marche and the Terraces to create a new entry to the development and the campus.

This major new development with its new urban edges, building façades and internal areas is an opportunity to create, and in turn identify, richness and diversity.

It will be based on design principles, including to be engaging and perorate at ground level, its façades varied and experimental, and its character representative of UTS as a home for innovative ideas, for creative thought and for cross disciplinary, discussion and research.

## Current Building Envelope

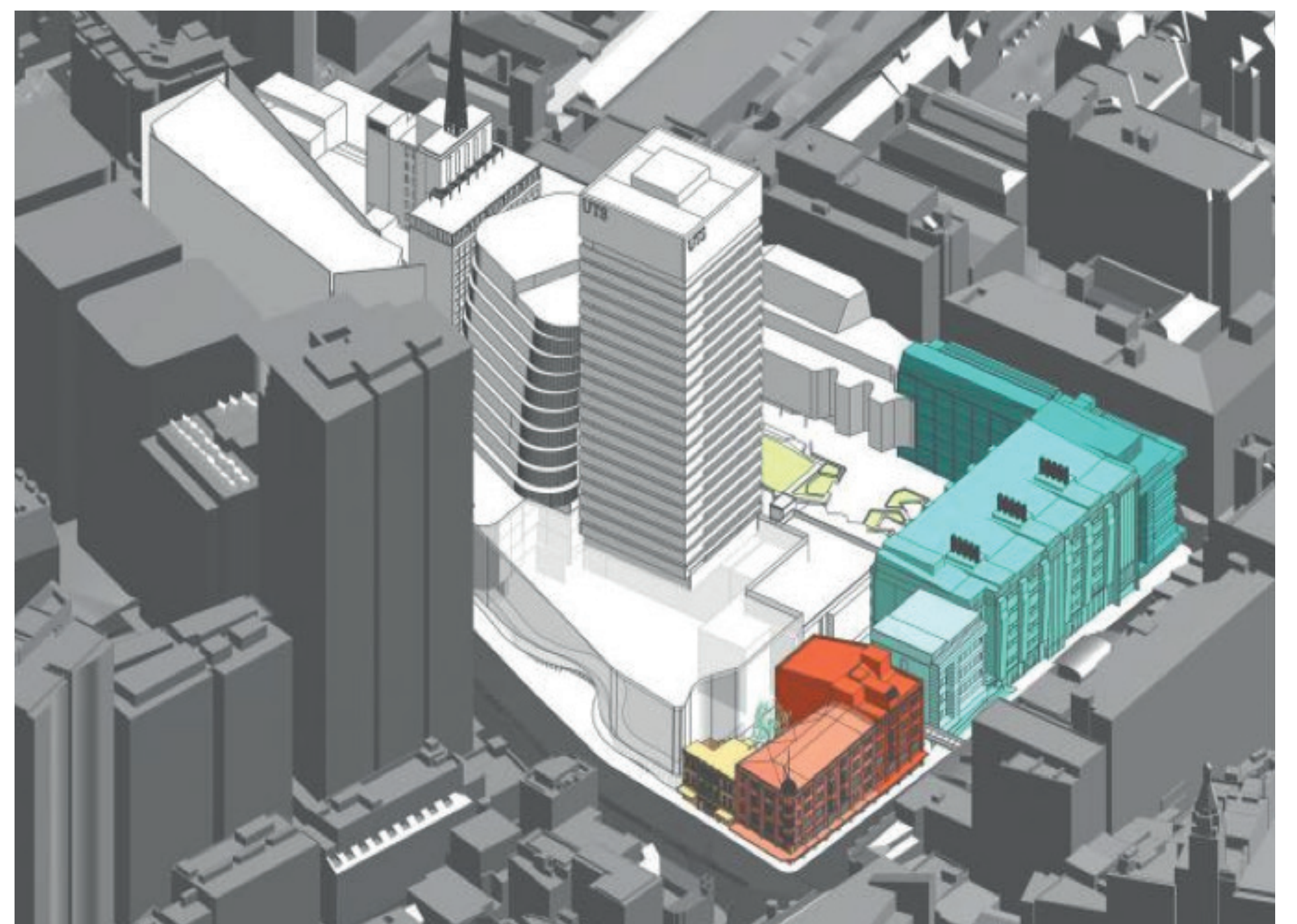

## Proposed Building Envelope

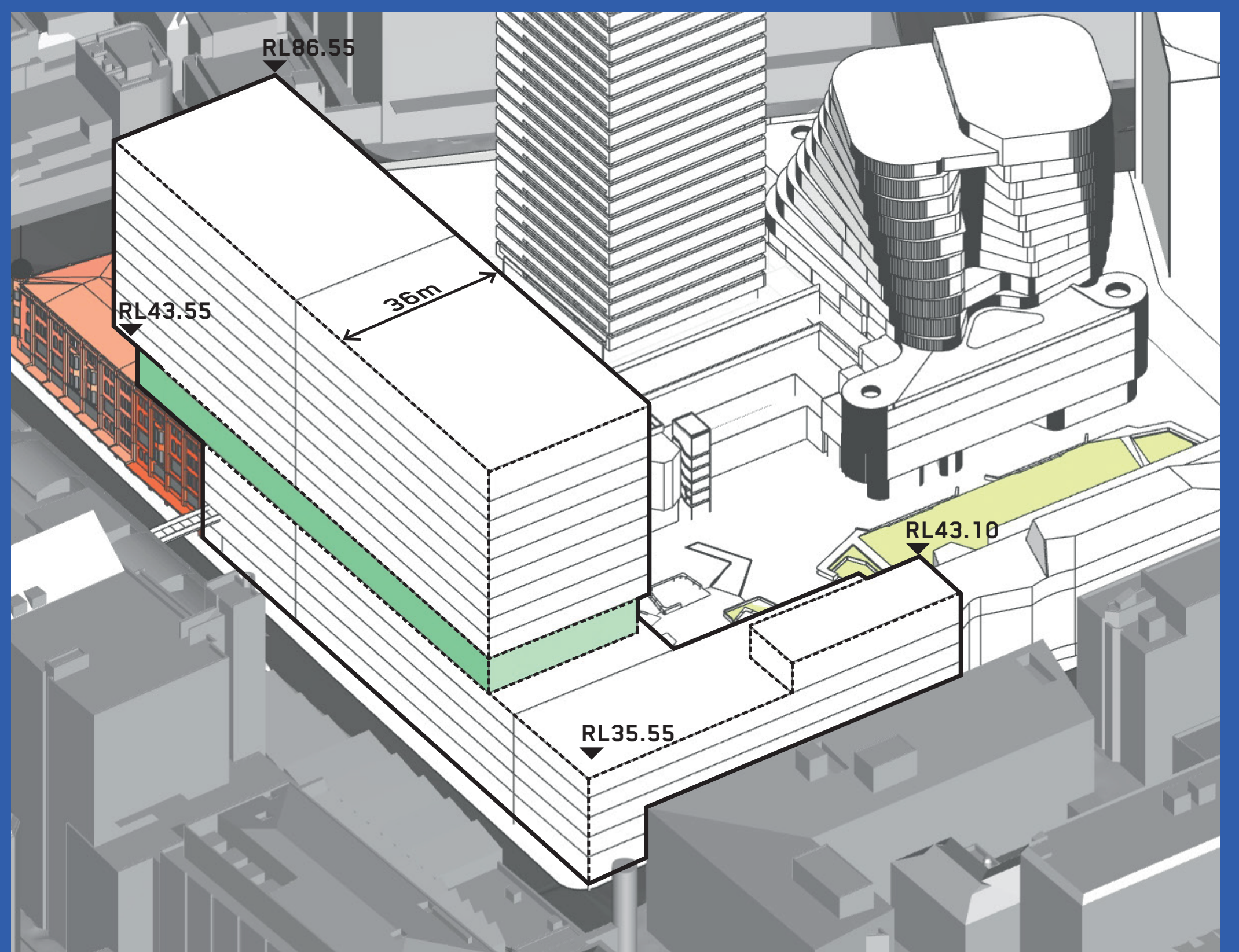
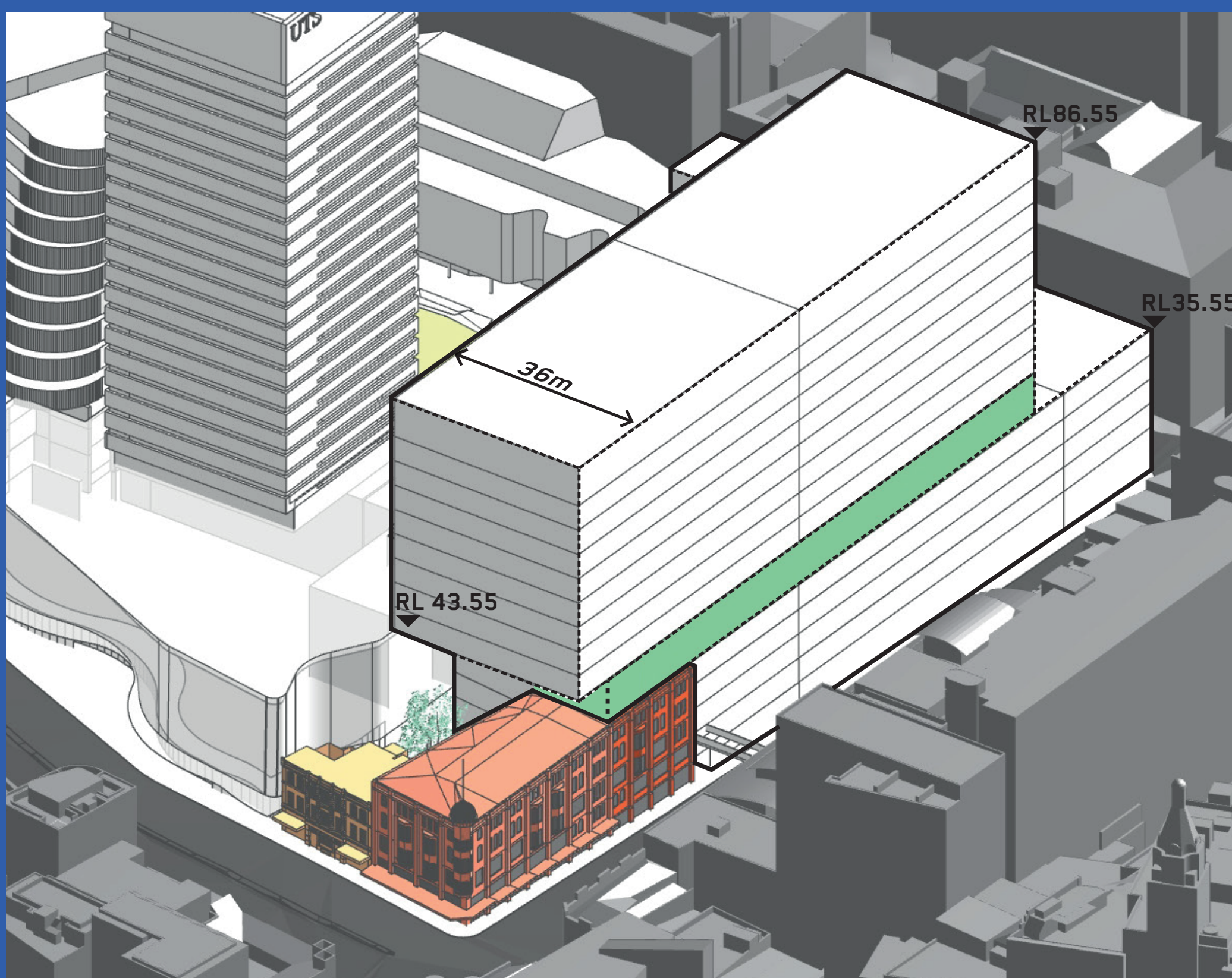



# Current Status



This is just the first step in a long planning process that will require a design competition, as well as detailed technical studies that will be subject to further assessment and consultation to progress beyond the masterplan.



WE ARE HERE

## Where to from here?

Planning for the future of this precinct is still in the early stages, and the proposal does not seek approval for any construction work or building designs at this point in time.