



Date: 12<sup>th</sup> November 2019

Our Ref: 13/054

Clarence Property  
PO Box 1478  
BALLINA NSW 2478

Attention: Mr James Webb

**Re: Casuarina Town Centre – Australian Lifeguards**

On behalf of the Australian Lifeguard Service (ALS), I Scott McCartney would like to state that we agree in principle to the proposed facility located within the Icon Building with the proposed dimensions and access to Blue Horizon Drive to be provided by Clarence Property.

By way of background the ALS currently operates out of the Casuarina Hockey fields shed. This is far from ideal as some of the main issues are:

- The lifeguards have to use their own transport to load and move lifeguard equipment from the shed to the beach location as it's too far to walk.
- Have minimum room to store required equipment due to the hockey equipment also located in the shed.
- Damages to radios and rescue equipment often occur due to the amount of people coming in and out of the shed.
- Unsecure location for vandals and theft

In supporting the proposed facility located within the Icon Building, ALS requirements for the proposed new facility to be constructed in the ICON building, as outlined in our letter dated 31 May 2019 as attached

- Minimum 3.25m x 9.25m within the ICON Building for the ALS facility
- Vehicle access to the facility off Blue Horizon Drive via a roller door or similar
- 2 x Double power points
- 1 x water point
- Shelving to store first aid and other equipment

ALS current needs for a facility to be available as soon as practical with clear benefits to ALS and the community. In this respect, the benefit to ALS if a temporary structure is provided within the Town

Centre prior to the Icon building being developed is preferred. Ideally a temporary structure like a shipping container /modular building located in the immediate vicinity of where the ALS shed/ICON building will be located would benefit the ALS in the short term as we could move away from the hockey shed and into a location more accessible. It would also benefit the community as we could establish the new patrol location with the community prior to the ALS shed being built. The location is also more central and will encourage more beachgoers to swim between the flags.

The ALS plans to operate the lifeguard service (patrol) out of the building during holiday periods. Here they will be able to keep all lifeguard equipment rescue ready as well as be able to charge radios, maintain equipment and reduce damages to equipment. With the new location we also plan to locate an ATV or RWC in the shed to increase our patrol and call out capacity for the area.

ALS support Clarence with their endeavours to approach Tweed Shire Council to secure necessary approvals to locate a temporary structure prior to the development of the Icon Building where our permanent facility will be provided. This facility and location would be beneficial from our end to perform the lifesaving duties that are expected and required from the Australian Lifeguard Service.

Regards,

Scott McCartney

Northern NSW Lifeguard Coordinator

smccartney@australianlifeguards.com.au 0405 579 342

A handwritten signature in black ink, appearing to be 'SM', with a long horizontal stroke extending to the right.

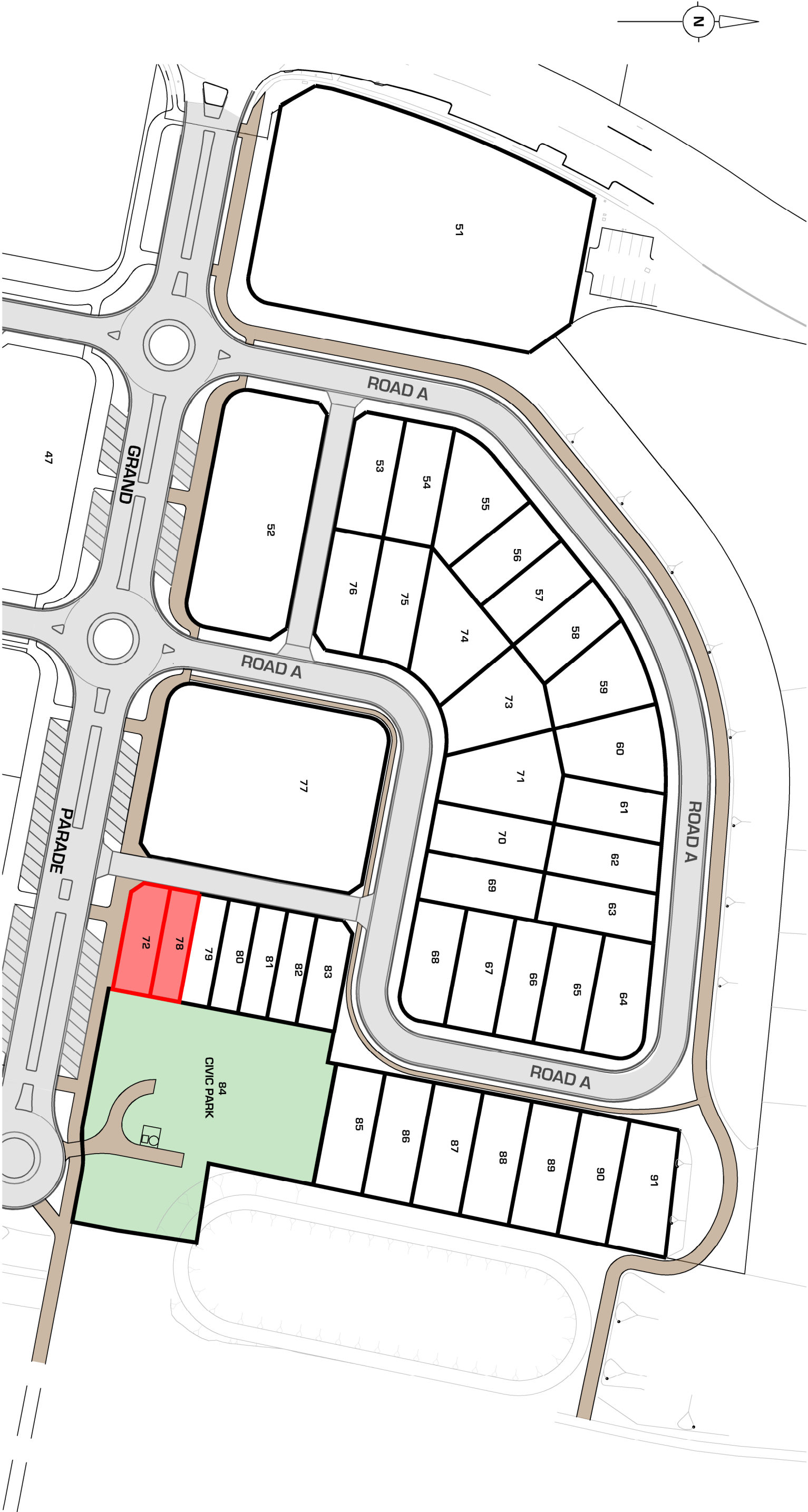

NOTE:  
This preliminary layout has been completed in accordance with the instructions provided by Clarence Property.  
In this respect preliminary desktop data has been used to form this layout. The final layout is subject to the completion of a detailed survey & engineering plans. Accordingly, the conclusions reached within this report may be modified by the author upon the completion of the final design plans & site inspection. Newton Denny Chapelle accepts no responsibility for any loss or damage suffered, however so arising, to any person or corporation who may use or rely on this report.



1cm = 10m  
1:1000

LEGEND

PROPOSED BOUNDARY

AUSTRALIAN LIFEGUARD SERVICE STORAGE FACILITY

REV DATE AMENDMENT

A  
B  
C  
D

SOURCE PLAN: Plan prepared by NDC - P3 Subdivision Layout Plan Stage 1E - Detail 1 REV C dated 17.08.17

K:\jobs\2013\13054 - clarence property\masterfile\planning\planning plans\ndc plans\cad files\13054 - p3 with lifesav'n g details.dwg - lifeguard

NDC

Newton Denny Chapelle

Surveyors Planners Engineers

Email: [office@newtondennychapelle.com.au](mailto:office@newtondennychapelle.com.au)

LISMORE 31 Carrington St. Lismore 2480 PH: 6622 1011

ABN: 88 220 045 469

AUSTRALIAN LIFEGUARD SERVICE  
STORAGE FACILITY

CLIENT: CLARENCE PROPERTY  
LOCATION: CASUARINA TOWN CENTRE  
CASUARINA BEACH  
DATE: 22.01.20 REF: 13 / 054  
SCALE: 1 : 1000 @ A3 DRAWN: bk