

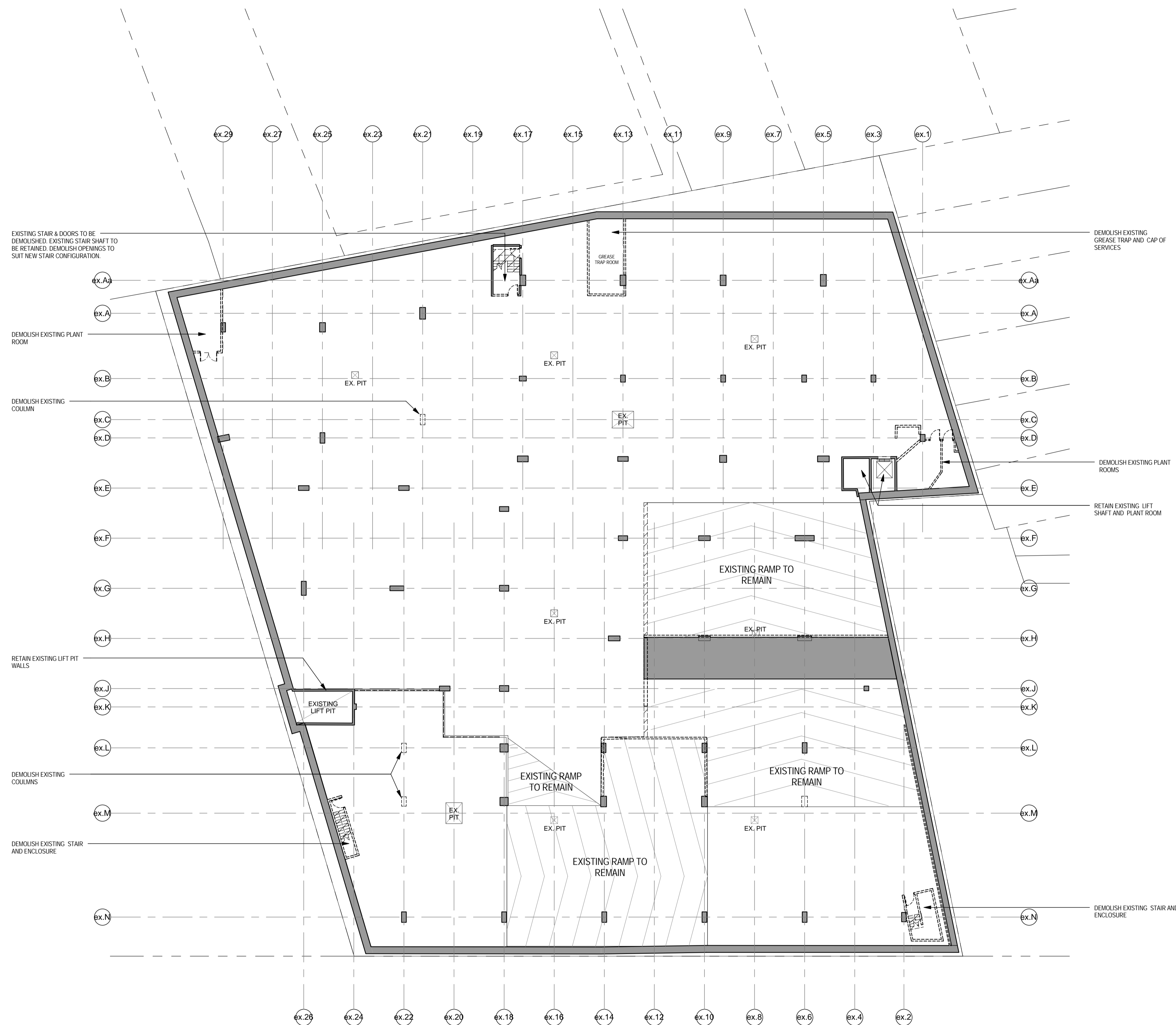

Do not scale drawings. Verify all dimensions on site

issue	amendment	date
-	ISSUE FOR QA REVIEW	02.02.09
A	ISSUE FOR ENVIRONMENTAL ASSESSMENT	20.02.09

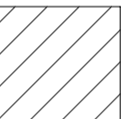

DEMOLITION PLAN LEGEND

-  EXISTING COLUMNS / WALLS TO BE DEMOLISHED
-  AREA OF EXISTING SLAB TO BE DEMOLISHED

NOTE :

- RETAIN LOWER BASEMENT SLAB AND PILE STRUCTURE AND CARRY OUT STRENGTHENING WORKS AS REQUIRED TO STRUCTURE ENGINEERS DETAIL.
- RETAIN ALL EXISTING PERIMETER CUT OFF WALLS AND BRACE AS NECESSARY TO STRUCTURAL ENGINEERS DETAIL.



Architectus Sydney
 Level 3 341 George Street
 Sydney NSW 2000
 T (61 2) 8522 8400
 F (61 2) 8522 8500
 sydney@architectus.com.au
 ABN 11 098 489 448

Sydney
 Melbourne
 Auckland
 Brisbane
 Shanghai

project
 33 CROSS STREET, DOUBLE BAY

drawing
 DEMOLITION LOWER BASEMENT PLAN

scale 1:200@A1 drawing no.
 drawn AD/TF/DR **DA00-11**
 checked CO issue
 project no 070068 **A**