

STREET

(ALIGNED 3-66 - 12-8 - 3-96)

WILLIAM

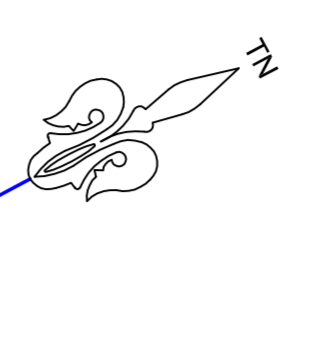

RIGHT OF WAY (N) IS UNOBSTRUCTED EXCEPT FOR
MOPS INTRUSIONS OF MESS RANGES KERBS AND
MIB WALLS TOGETHER WITH SOME STRUCTURES AND
SERVICES PROTRUDING BELOW THE UPPER LIMIT

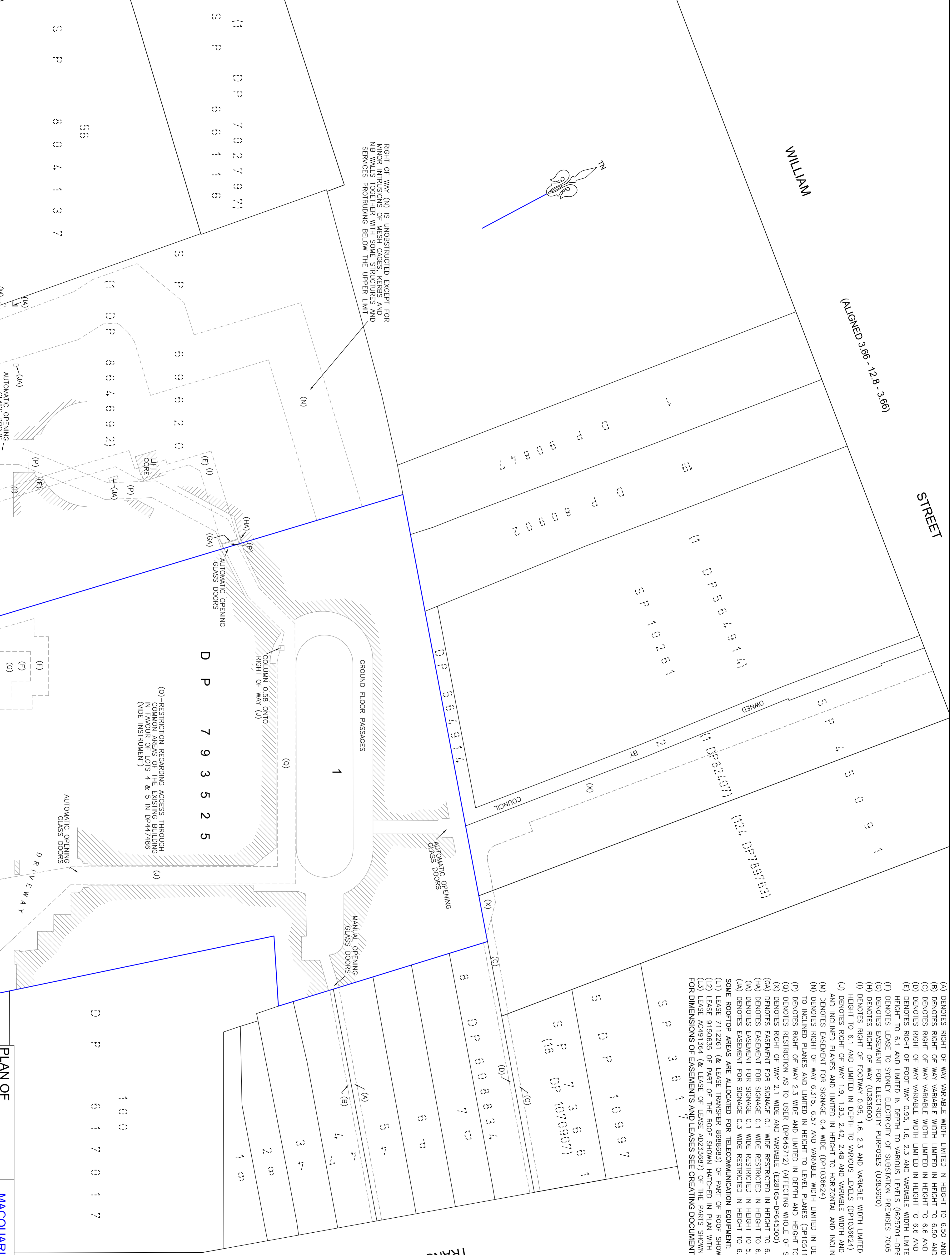

- (A) DENOTES RIGHT OF WAY VARIABLE WIDTH LIMITED IN HEIGHT TO 6.50 AND DEPTH 3.1 (DP645712)
 - (B) DENOTES RIGHT OF WAY VARIABLE WIDTH LIMITED IN HEIGHT TO 6.50 AND DEPTH 3.1 (DP645712)
 - (C) DENOTES RIGHT OF WAY VARIABLE WIDTH LIMITED IN HEIGHT TO 6.6 AND DEPTH 3.4 (DP648351)
 - (D) DENOTES RIGHT OF WAY VARIABLE WIDTH LIMITED IN HEIGHT TO 6.6 AND DEPTH 3.4 (DP648351)
 - (E) DENOTES RIGHT OF FOOT WAY 0.95, 1.6, 2.3 AND VARIABLE WIDTH LIMITED IN HEIGHT TO 6.1 AND LIMITED IN DEPTH TO VARIOUS LEVELS (623701-DP648257)
 - (F) DENOTES LEASE TO SYDNEY ELECTRICITY OF SUBSTATION PREMISES 7005 (U383600)
 - (G) DENOTES EASEMENT FOR ELECTRICITY PURPOSES (U383600)
 - (H) DENOTES RIGHT OF WAY (U383600)
 - (I) DENOTES RIGHT OF FOOTWAY 0.95, 1.6, 2.3 AND VARIABLE WIDTH LIMITED IN HEIGHT TO 6.1 AND LIMITED IN DEPTH TO VARIOUS LEVELS (DP1036824)
 - (J) DENOTES RIGHT OF WAY 1.9, 1.93, 2.42, 2.48 AND VARIABLE WIDTH AND LIMITED IN DEPTH TO HORIZONTAL PLANE AND INCLUDED PLANES AND LIMITED IN HEIGHT TO HORIZONTAL AND INCLUDED PLANES ABOVE (DP1036824)
 - (K) DENOTES EASEMENT FOR SIGNAGE 0.4 WIDE (DP1036824)
 - (L) DENOTES RIGHT OF WAY 6.315, 6.57 AND VARIABLE WIDTH LIMITED IN DEPTH TO INCLUDED PLANES AND LIMITED IN HEIGHT TO LEVEL PLANES (DP1051103)
 - (M) DENOTES RIGHT OF WAY 2.3 WIDE AND LIMITED IN DEPTH AND HEIGHT TO INCLUDED AND HORIZONTAL PLANES RESPECTIVELY (DP1051103)
 - (N) DENOTES RESTRICTION AS TO USER (DP645712) (AFFECTING WHOLE OF SITE)
 - (O) DENOTES RIGHT OF WAY 2.1 WIDE AND VARIABLE (E28165-DP64530)
 - (P) DENOTES EASEMENT FOR SIGNAGE 0.1 WIDE RESTRICTED IN HEIGHT TO 6.57 AND RESTRICTED IN DEPTH TO 5.4 (DP1051103)
 - (Q) DENOTES EASEMENT FOR SIGNAGE 0.1 WIDE RESTRICTED IN HEIGHT TO 6.5 AND RESTRICTED IN DEPTH TO 5.4 (DP1051103)
 - (R) DENOTES EASEMENT FOR SIGNAGE 0.1 WIDE RESTRICTED IN HEIGHT TO 4.95 (DP1051103)
 - (S) DENOTES EASEMENT FOR SIGNAGE 0.3 WIDE RESTRICTED IN HEIGHT TO 6.04 AND RESTRICTED IN DEPTH TO 5.0 (DP1051103)
- SOME ROOFTOP AREAS ARE ALLOCATED FOR TELECOMMUNICATION EQUIPMENT:
- (U1) LEASE 7112261 (& LEASE TRANSFER 6688683) OF PART OF ROOF SHOWN HATCHED IN PLAN WITH 7112261
 - (U2) LEASE 9150635 OF PART OF THE ROOF SHOWN HATCHED IN PLAN WITH 9150635
 - (U3) LEASE AC491364 (& LEASE OF LEASE AD233687) OF THE PARTS SHOWN HATCHED IN PLAN WITH 7112261
- FOR DIMENSIONS OF EASEMENTS AND LEASES SEE CREATING DOCUMENTS.

PLAN OF EASEMENTS AND DETAIL OF THROUGH SHEET 3 OF 4

REFER TO SHEET 1 FOR NOTES
DRAWING No. 19103-3
©PROJECT SURVEYORS-2008
REPRODUCED AND/OR PRINTED WITHOUT PERMISSION IS STRICTLY PROHIBITED

MACQUARIE PARK
PO Box 4004
MACQUARIE CENTRE NSW 2113
SUITE 404, LEVEL 4
NO13-15, YONI PARK ROAD,
MACQUARIE PARK NSW 2113
PHONE : 9888 3848
FAX : 9888 3875
email: office@projectsurveyors.com.au
ABN: 20086433374

PROJECT SURVEYORS
Professional Innovative... Results.

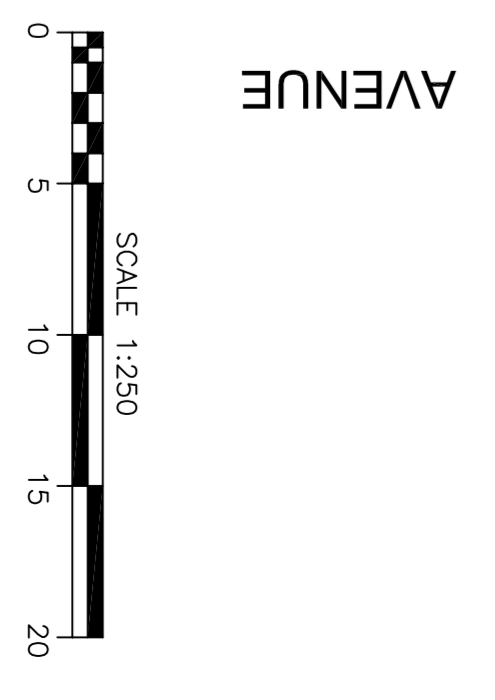

A1

CROSS

RIGHT OF WAY (P) IS UNOBSTRUCTED EXCEPT FOR FIXED GLASS PANELS TO AUTOMATIC OPENING GLASS DOORS

RIGHT OF FOOT WAY (E) & RIGHT OF WAY (I) ARE OBSTRUCTED AND GENERALLY UNTRAFFICABLE

SUBSTATION STRUCTURE IS INACCESSIBLE AND LOCATED BELOW FOOTPATH LEVEL IN UPPER BASEMENT LEVEL

DP 702797
S P 66116
S P 804137

DP 864692
S P 69620
S P 864692

DP 864692
S P 69620
S P 864692

DP 564914
S P 10261
S P 45091

DP 564914
S P 564914
S P 564914

DP 793525
S P 793525
S P 793525

DP 100
S P 617017
S P 617017

DP 100
S P 617017
S P 617017

DP 100
S P 617017
S P 617017

DP 100
S P 617017
S P 617017