

Do not scale drawings. Verify all dimensions on site

issue	amendment	date
-	ISSUE FOR QA REVIEW	02.02.09
A	ISSUE FOR ENVIRONMENTAL ASSESSMENT	20.02.09
B	ISSUE FOR PREFERRED PROJECT REPORT	21.08.09

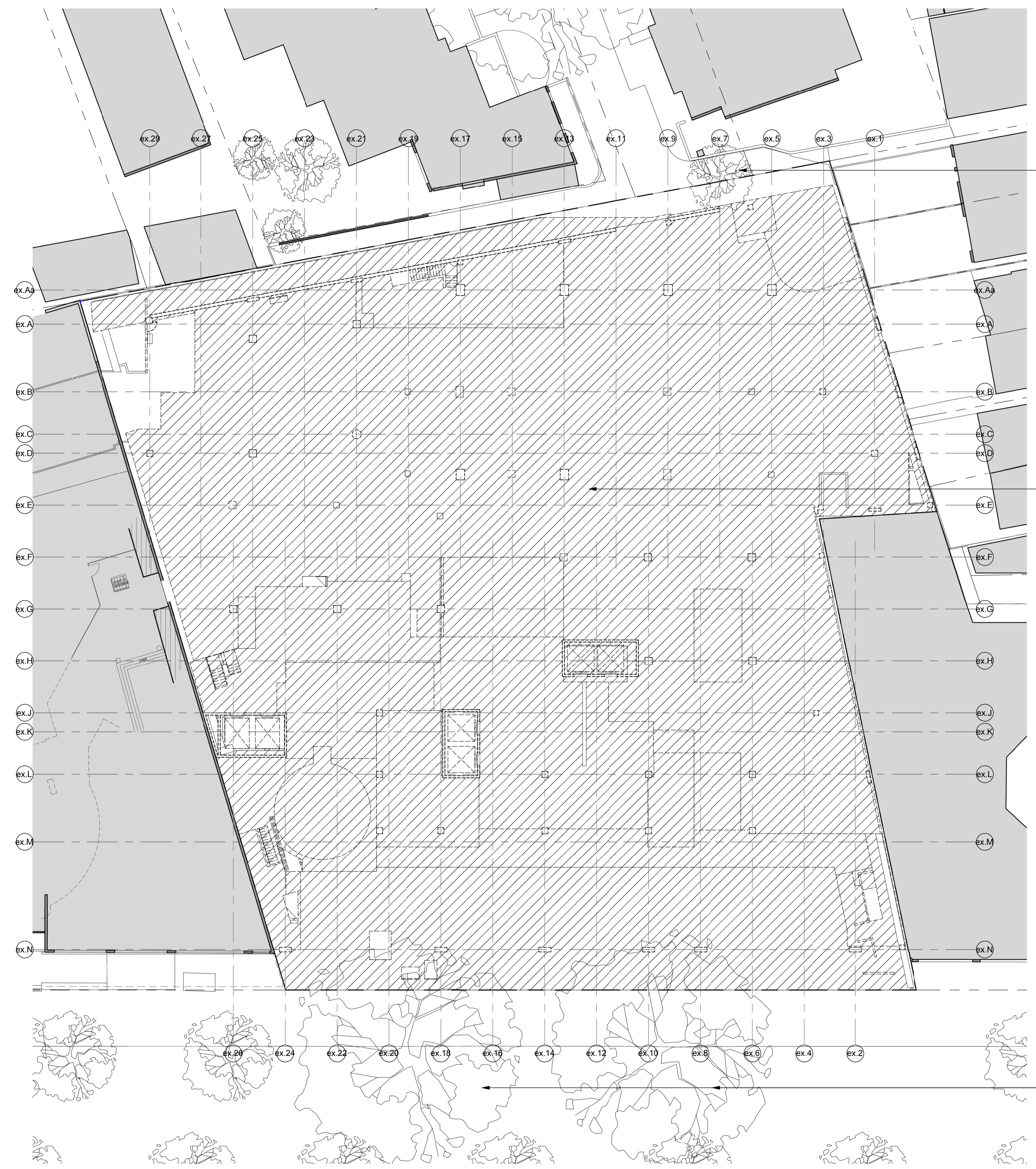

EXISTING TREE RETAINED. REFER LANDSCAPE ARCHITECT DRAWINGS

DEMOLISH AND REMOVE EXISTING BUILDING ABOVE AND INCLUDING EXISTING GROUND FLOOR SLAB. BRACE EXISTING BASEMENT CUT OFF WALLS TO STRUCTURAL ENGINEERS. CARRY OUT LOCALISED STRENGTHENING AND REINSTATEMENT OF EXISTING BASEMENT SUB-STRUCTURE AS REQUIRED.

EXISTING TREES RETAINED. REFER LANDSCAPE ARCHITECT DRAWINGS

DEMOLITION PLAN LEGEND

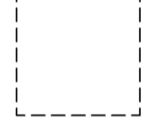
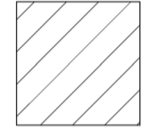
-  EXISTING COLUMNS / WALLS TO BE DEMOLISHED
-  AREA OF EXISTING SLAB TO BE DEMOLISHED

NOTE:

- RETAIN LOWER BASEMENT SLAB AND PILE STRUCTURE AND CARRY OUT STRENGTHENING WORKS AS REQUIRED TO STRUCTURE ENGINEERS DETAIL.
- RETAIN ALL EXISTING PERIMETER CUT OFF WALLS AND BRACE AS NECESSARY TO STRUCTURAL ENGINEERS DETAIL.



Architectus Sydney
 Level 3 341 George Street
 Sydney NSW 2000
 T (61 2) 8252 8400
 F (61 2) 8252 8500
 sydney@architectus.com.au
 ABN 11 098 489 448

project
33 CROSS STREET, DOUBLE BAY

drawing
DEMOLITION GROUND FLOOR PLAN

scale at A1	1:200@A1	drawing no.	
drawn	AD/TF/DR		DA00-13
checked	CO	issue	
project no	070068		B