

BUNGARRIBEE ESTATE

Precinct 1 Development Application

VOLUME 3: LANDSCAPE WORKS - HERITAGE PARK AND HERITAGE VIEW PARK

ISSUE C: DEVELOPMENT APPLICATION
October 2009



Client
LANDCOM
Level 2,330 Church Street
Parramatta NSW 2150
TELEPHONE: (02) 9841 8600
FACSIMILE: (02) 9841 8688

NSI061

**BUNGARRIBEE ESTATE
PRECINCT I DEVELOPMENT APPLICATION**

**DA ISSUE - OCTOBER 2009
ISSUE C**

Project Manager

APP
PROJECT MANAGEMENT
LEVEL 6,53 BERRY STREET PO Box 1573
NORTH SYDNEY NSW 2059
EMAIL carlos.lopez@app.com.au
FACSIMILE (02) 9954 1951
TELEPHONE (02) 9956 1216

Prepared by

CLOUSTON associates
LANDSCAPE ARCHITECTS URBAN DESIGNERS LANDSCAPE PLANNERS
6A WETHERILL STREET PO BOX 44
LEICHHARDT NSW 2040
EMAIL sydney@clouston.com.au
FACSIMILE (02) 3569 3523
TELEPHONE (02) 9569 3388

JWP
CIVIL ENGINEERS
77 UNION ROAD
PENRITH NSW 2750
EMAIL jwp@jwprince.com.au
FACSIMILE (02) 4721 7638
TELEPHONE (02) 4732 3366

HYDROPLAN
IRRIGATION CONSULTANTS
SUITE 5/7-11 RAILWAY STREET PO BOX 209
BAULKHAM HILLS NSW 2153
EMAIL syd@hydroplan.com.au
FACSIMILE (02) 9686 6231
TELEPHONE (02) 9686 6911

TABLE OF CONTENTS

COVER SHEET

TABLE OF CONTENTS

LA 3.01	LANDSCAPE DESIGN INTENT
LA 3.02	TREES FOR RETENTION & REMOVAL
LA 3.03	PARK SCHEMATIC CONCEPTS
LA 3.04	HERITAGE & HERITAGEVIEW PARK MASTERPLAN
LA 3.05	HERITAGE PARK DETAIL
LA 3.06	HERITAGEVIEW PARK DETAIL
LA 3.07	HERITAGE & HERITAGEVIEW PARK PLANTING PLAN
LA 3.08	PLANT SCHEDULES 1 of 2
LA 3.09	PLANT SCHEDULES 2 of 2
LA 3.10	HERITAGE & VIEW PARK SECTIONS SHEET 1
LA 3.11	HERITAGE & VIEW PARK SECTIONS SHEET 2
LA 3.12	HERITAGE & VIEW PARK SECTIONS SHEET 3
LA 3.13	WALL ELEMENTS
LA 3.14	POST, FENCE & BOLLARD ELEMENTS
LA 3.15	HOMESTEAD ENCLOSURE VIEWS
LA 3.16	ENTRY COURT A VIEWS
LA 3.17	HERITAGEVIEW PARK PERSPECTIVE
LA 3.18	ENTRY PARK- PERSPECTIVES
LA 3.19	ENTRY PARK- ELEMENTS
LA 3.20	ENTRY PARK PRECEDENT IMAGES
LA 3.21	PLAY EQUIPMENT PALETTE
LA 3.22	IRRIGATION PLAN



DESIGN INTENT

The following design intent underpins the design and layout of the Bungarribee Estate Precinct 1. The design intent has been developed with reference to the regional and local context, and is based upon the 4 design principles in the Bungarribee Estate Public Domain Strategy Volume 1: Strategic Overview. The 4 design principles are:

CONNECTING COMMUNITIES: *forging links between existing and proposed communities.*

- Provide pedestrian and cycle connections through the residential precinct and parks and along Doonside Road.
- Provide connection points for development of future precincts and future connections to the WSP over Bungarribee Creek.
- Provide a local park for the area which responds to the contextual setting of the existing Doonside community and the neighbouring Western Sydney Parklands.
- Create a public open space framework which responds to existing, proposed and future development, in particular a potential Community Resource Hub.

EXPERIENCE & MEMORY: *interpreting significant heritage values and utilising the elevated location of the site to create a unique sense of place.*

- Develop interpretive stories which communicate the cultural heritage value of the historic homestead and cultural plantings.
- Integrate the heritage interpretation as an integral part of the landscape design.
- Ensure interpretive themes are accessible and relevant to the diverse community demographic.
- Create a unique and identifiable image for the precinct streetscape which responds to the cultural heritage of the site.

INSPIRED BY THE PARKLANDS: *creating a development which capitalises upon its unique location adjacent to a regional parkland.*

- Provide a range of informal passive recreation areas within the Heritage and View parks.
- Provide a range of play experiences, including sculptural play elements, accessible play and group play features.
- Promote connections to the Western Sydney Parklands with Themeda grasslands in the View Park.

AN ENVIRONMENT FOR ALL: *protecting, enhancing and promoting the diverse natural habitat within and surrounding the site.*

- Promote interaction with nature by providing areas for accessibility through the View Park and at the crossing point for Bungarribee Creek.
- Maintain child safety and visibility of the playground by locating the play elements in a visually prominent area.
- Optimise the layout for casual surveillance and adult supervision.
- Re-establish Themeda australis habitats in line with the ecological strategy.
- Strategically limit the use of irrigation to high intensity usage lawn areas.



STATUS		DATE
DEVELOPMENT APPLICATION		07/10/09
ISSUE	NOTES / STATUS	INITIAL
C	DA: MINOR AMENDMENTS	TDC 07/10/09
B	DA	TDC 01/10/09
A	DRAFT	TDC 28/09/09



NSW GOVERNMENT
Department of Planning



PROJECT BUNGARRIBEE ESTATE PROJECT STAGE 1A & 1B DEVELOPMENT APPLICATION			
CLIENT LANDCOM	PROJECT NUMBER NS1061	DRAWN TDC	DATE OCTOBER 09
DRAWING TITLE DESIGN INTENT	DRAWING NUMBER LA3.01	SCALE NTS	ISSUE C

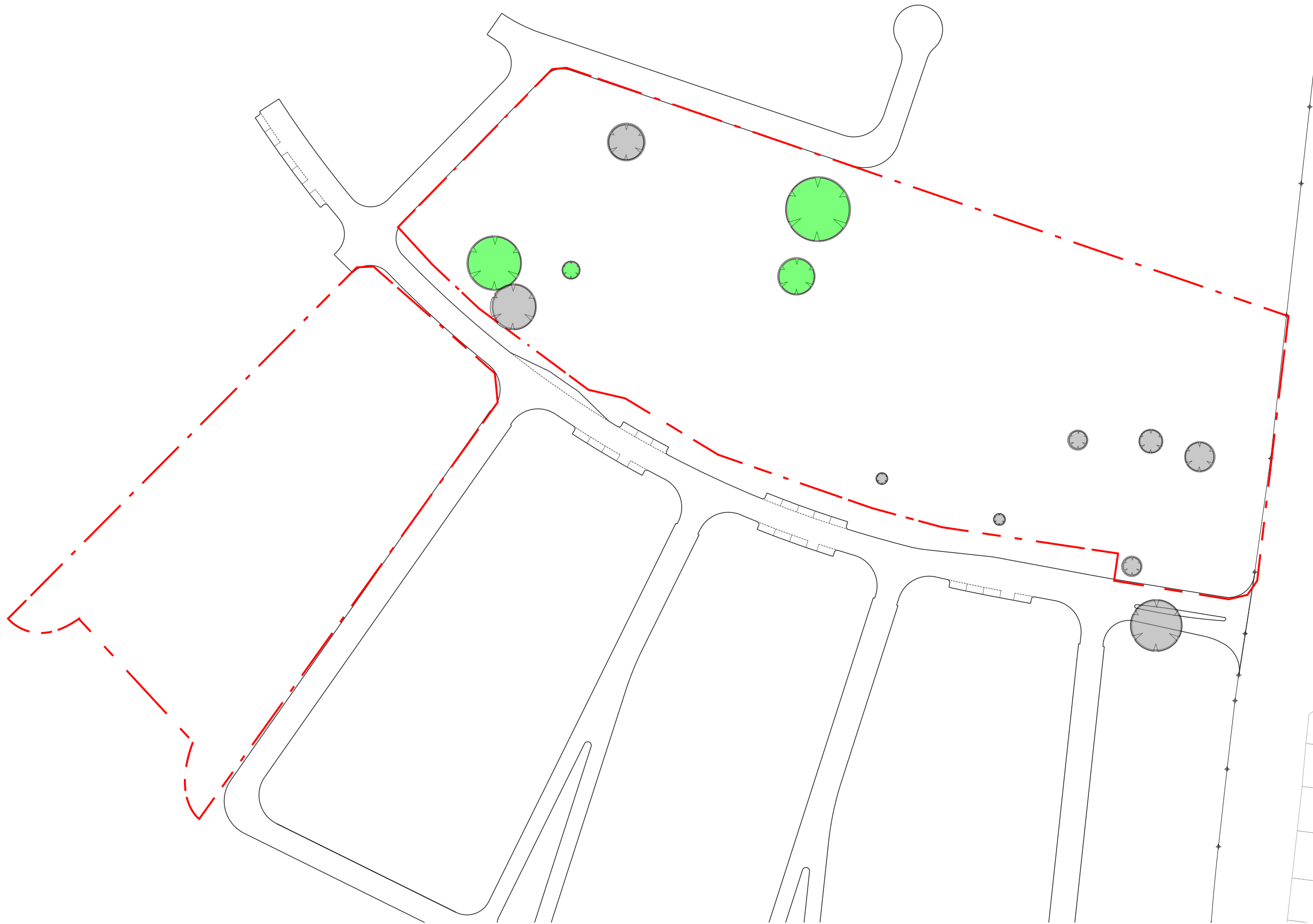

Legend

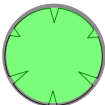
 Existing tree to be retained

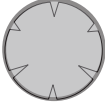
 Existing tree to be removed

NOTE:
Refer to ATC Arboricultural
assessment

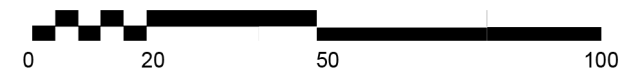

STATUS		DATE
DEVELOPMENT APPLICATION		07/10/09
ISSUE	NOTES / STATUS	INITIAL
C	DA: MINOR AMENDMENTS	TDC 07/10/09
B	DA	TDC 01/10/09
A	DRAFT	TDC 28/09/09



NSW GOVERNMENT
Department of Planning



PROJECT BUNGARRIBEE ESTATE PROJECT STAGE 1A & 1B DEVELOPMENT APPLICATION			
CLIENT LANDCOM		PROJECT NUMBER NS1061	DRAWN TDC
DRAWING TITLE TREES FOR RETENTION & REMOVAL		DRAWING NUMBER LA3.02	DATE OCTOBER 09
		SCALE 1:1500@A3	ISSUE C

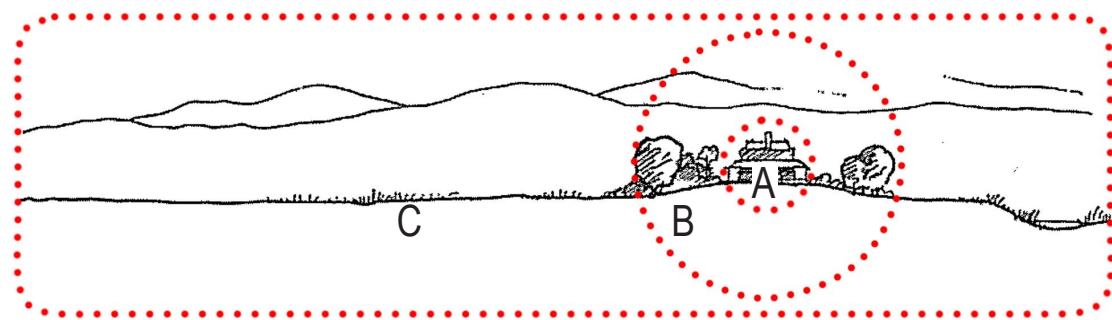

Britton & Morris Colonial Landscapes: Lowland/Flatland model

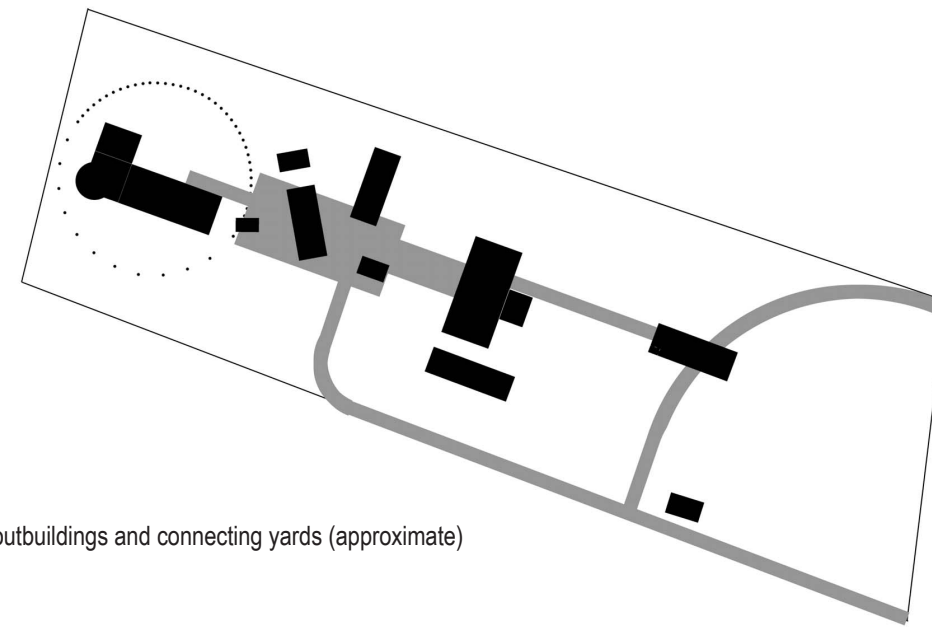

3. Homestead, outbuildings and connecting yards (approximate)

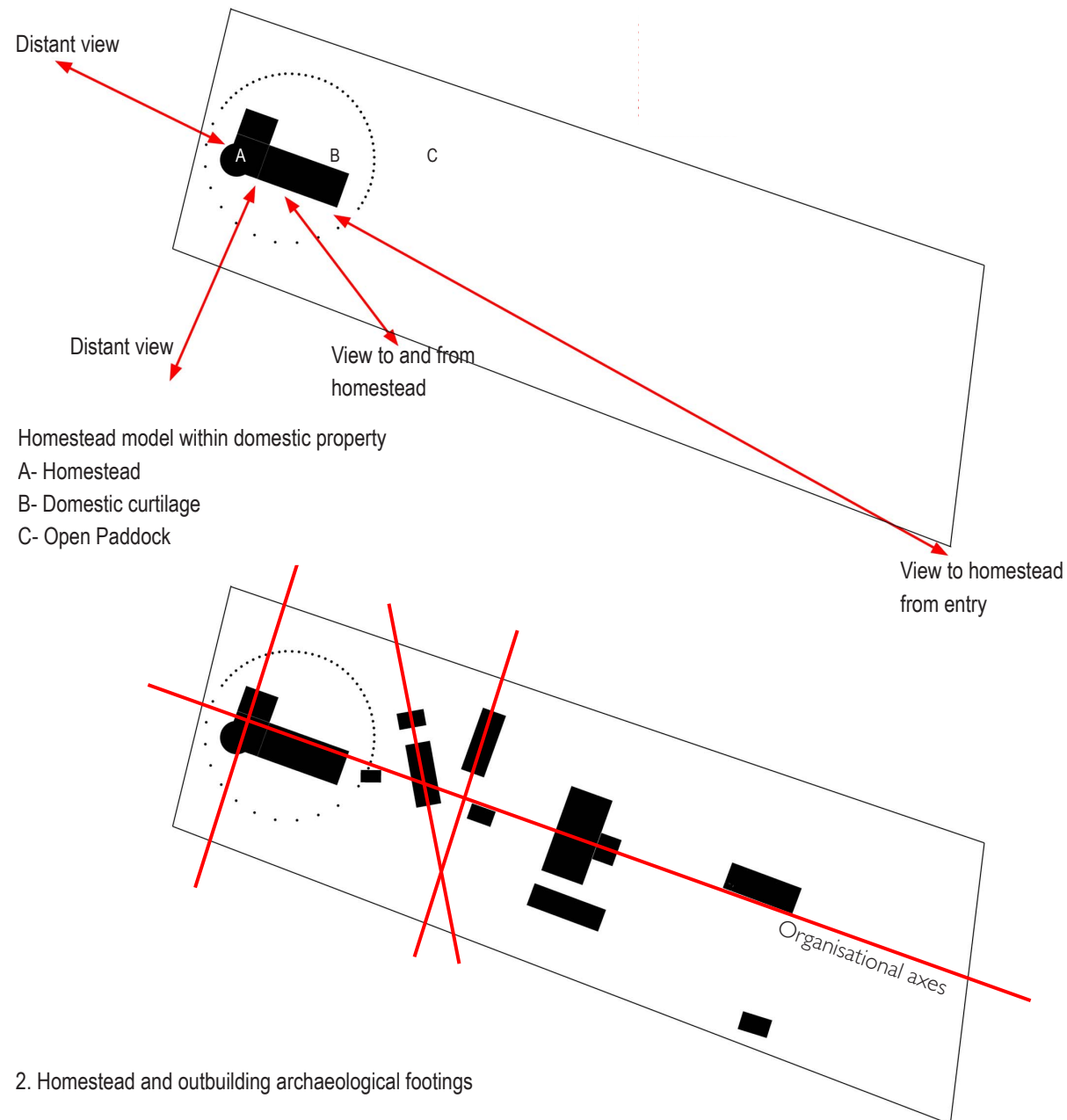

2. Homestead and outbuilding archaeological footings

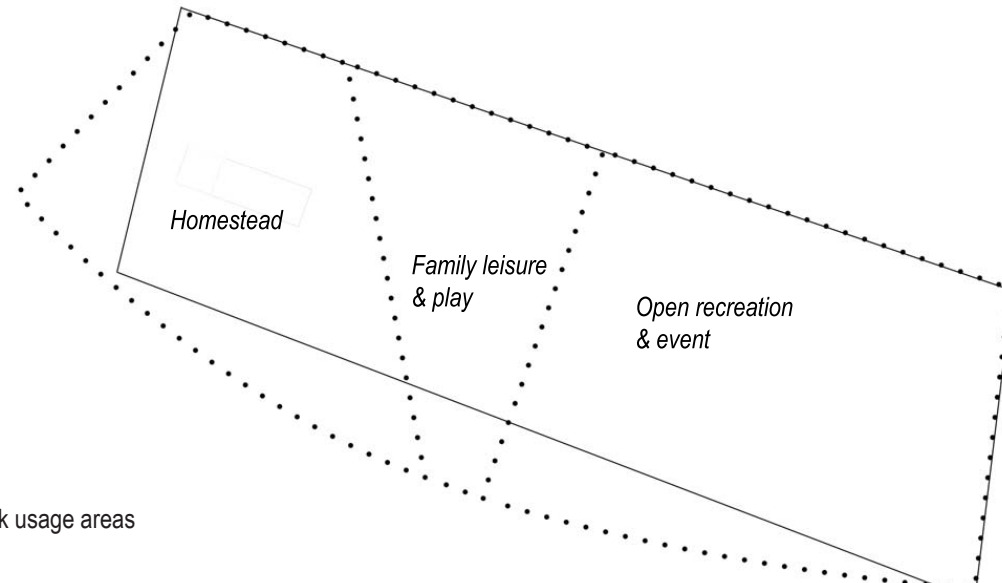

4. Park usage areas

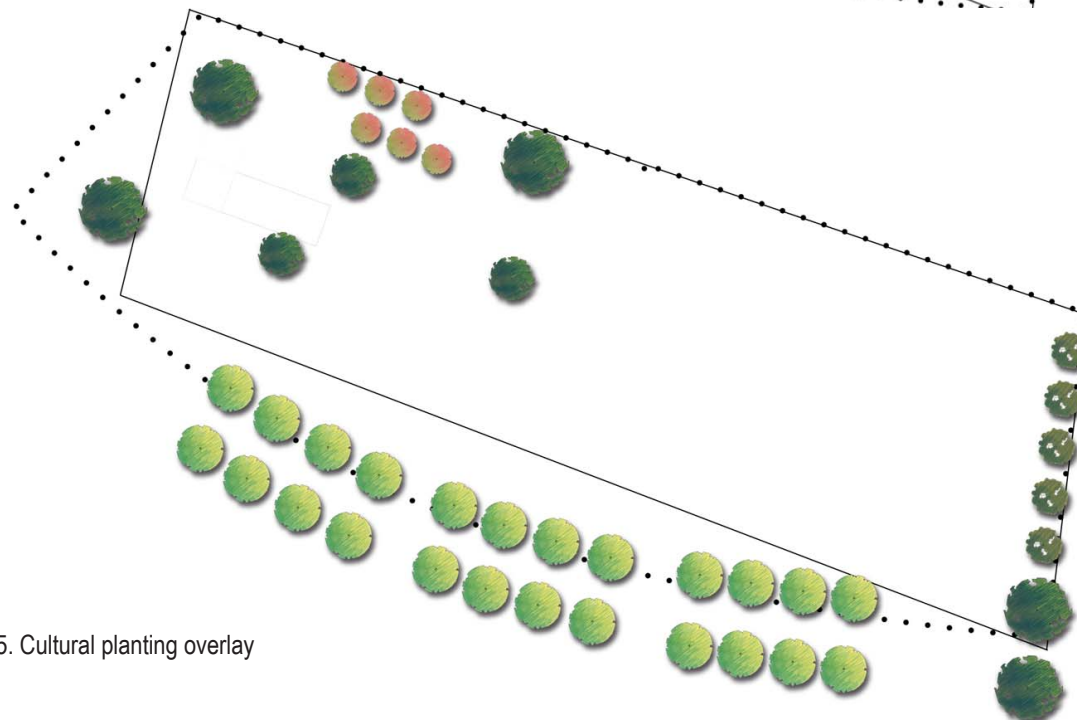

5. Cultural planting overlay

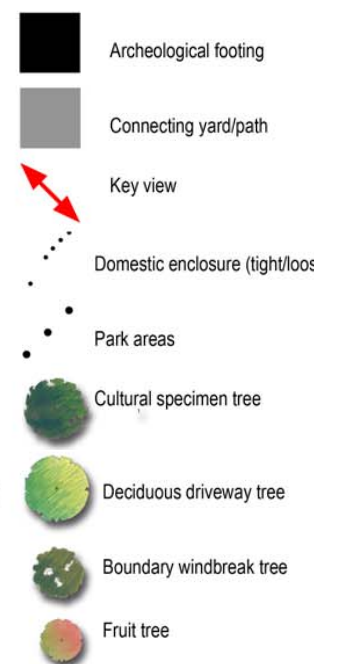

STATUS		DATE
DEVELOPMENT APPLICATION		07/10/09
ISSUE	NOTES / STATUS	INITIAL
C	DA: MINOR AMENDMENTS	TDC
B	DA	TDC
A	DRAFT	TDC



NSW GOVERNMENT
Department of Planning



BUNGARRIBEE ESTATE PROJECT
STAGE 1A & 1B DEVELOPMENT APPLICATION

CLIENT	LANDCOM	PROJECT NUMBER	NS1061	DRAWN	TDC	DATE	OCTOBER 09
DRAWING TITLE	HERITAGE ANALYSIS & CONCEPT RATIONALE	DRAWING NUMBER	LA3.03	SCALE	NTS	ISSUE	C



- Materials Legend**
- Lawn
 - Crushed sandstone paving
 - Concrete paving- rock salt finish or similar
 - Concrete paving- broom finish
 - Soft-fall safety surfacing- blue grey
 - Soft-fall safety surfacing- buff
 - Sandstone unit paving
 - Planting- Refer to LA3.06 for planting plan

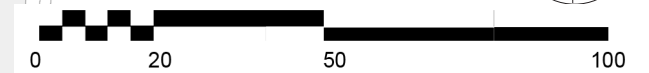

STATUS		DATE
DEVELOPMENT APPLICATION		07/10/09
ISSUE	NOTES / STATUS	INITIAL
C	DA: MINOR AMENDMENTS	TDC
B	DA	TDC
A	DRAFT	TDC



NSW GOVERNMENT
Department of Planning



PROJECT
BUNGARRIBEE ESTATE PROJECT
STAGE 1A & 1B DEVELOPMENT APPLICATION

CLIENT
LANDCOM

DRAWING TITLE
HERITAGE PARK & HERITAGE VIEW PARK MASTERPLAN

PROJECT NUMBER
NS1061

DRAWING NUMBER
LA3.04

DRAWN
TDC

SCALE
1:1500@A3

DATE
OCTOBER 09

ISSUE
C

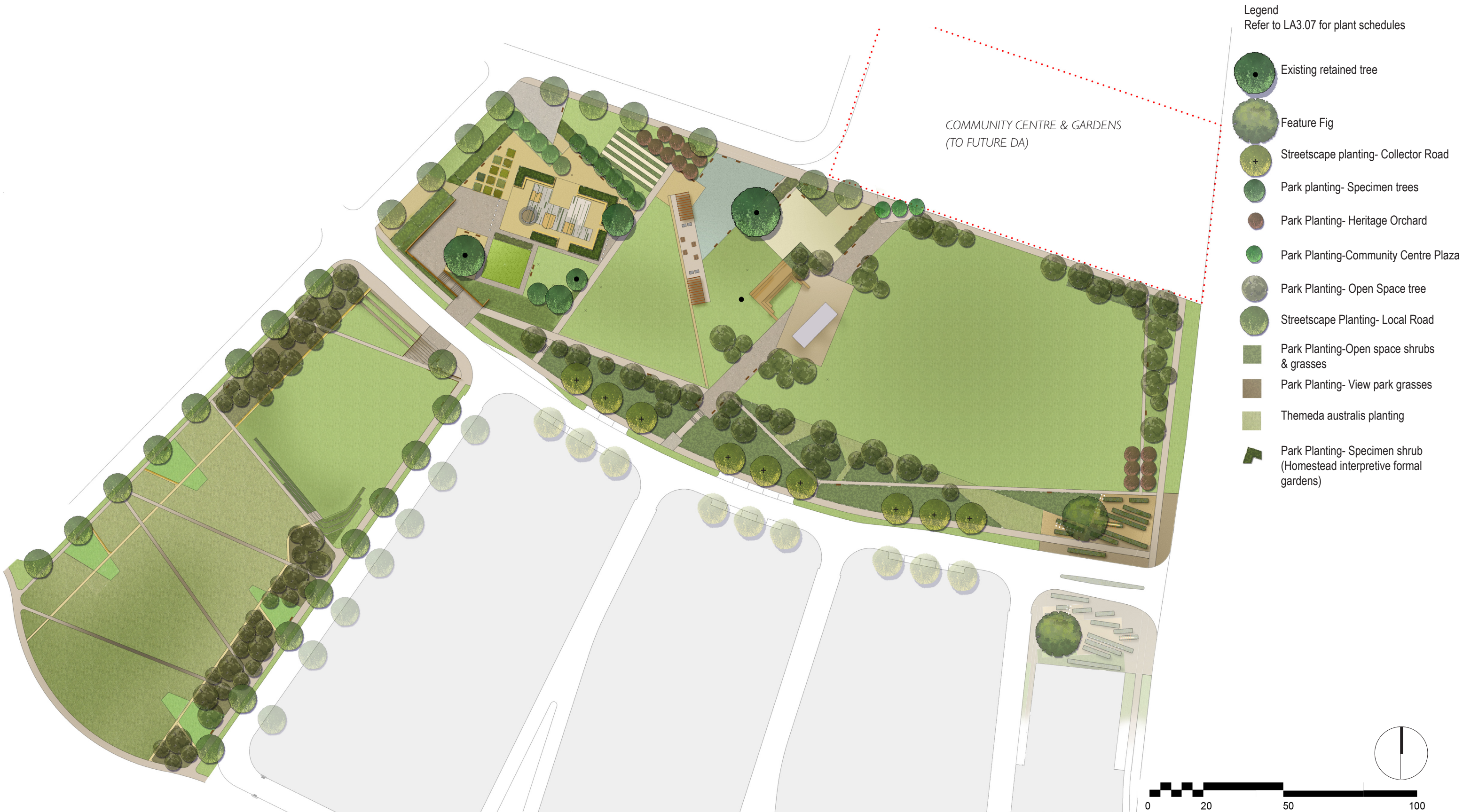

STATUS		DATE
DEVELOPMENT APPLICATION		07/10/09
ISSUE	NOTES / STATUS	INITIAL
C	DA: MINOR AMENDMENTS	TDC
B	DA	TDC
A	DRAFT	TDC



NSW GOVERNMENT
Department of Planning



PROJECT
BUNGARRIBEE ESTATE PROJECT
STAGE 1A & 1B DEVELOPMENT APPLICATION

CLIENT
LANDCOM

DRAWING TITLE
HERITAGE & HERITAGE VIEW PARK PLANTING PLAN

PROJECT NUMBER
NS1061

DRAWING NUMBER
LA3.07

DRAWN
TDC

SCALE
1:1500@A3

DATE
OCTOBER 09

ISSUE
C

BOTANICAL NAME	COMMON NAME	MATURE HEIGHT	MATURE SPREAD	DENSITY (No./m2)
Park Planting - Heritage/ Orchard				
TREES				
<i>Malus ioensis</i> 'Plena'	White Crab Apple	6m	4.5m	As Shown
<i>Prunus betulaefolia</i> 'Southworth Dancer'	Ornamental Pear	8m	5m	As Shown
<i>Prunus x blireana</i>	Pink Flowering Plum	4m	4m	As Shown
<i>Prunus mumé</i> 'Rosebud'	Pink Flowering Apricot	4m	4m	As Shown
<i>Prunus persica</i> 'Alboplana'	White Flowering Peach	4m	4m	As Shown

Park Planting - Community Centre Plaza				
TREES				
<i>Melaleuca quinquenervia</i>	Broad Leaved Paperbark	15m	10m	As Shown
<i>Tristaniopsis laurina</i> 'Luscious'	Water Gum	8m	4m	As Shown

Park Planting - Open Space				
TREES				
<i>Angophora floribunda</i>	Rough-barked Apple	15m	7m	As Shown
<i>Angophora subvelutina</i>	Broad-leaved Apple	20m	10m	As Shown
<i>Brachychiton populneum</i>	Kurrajong	10m	5m	As Shown
<i>Corymbia maculata</i>	Spotted Gum	18m	6m	As Shown
<i>Eucalyptus crebra</i>	Narrow-leaved Ironbark	20m	6m	As Shown
<i>Eucalyptus eugeuinoides</i>	Thin- leaved Stringbark	25m	10m	As Shown
<i>Eucalyptus tereticornis</i>	Forest Red Gum	40m	20m	As Shown
<i>Melia azedarach</i> 'Caroline'	White Cedar	10m	8m	As Shown
<i>Parrotia persica</i>	Persian Witch Hazel	10m	7m	As Shown

SHRUBS				
<i>Banksia</i> 'Giant Candles'	Banksia	5m	2.5m	
<i>Callistemon citrinus</i> 'Western Glory'	Bottlebrush	4m	3m	
<i>Grevillea</i> 'Fireworks'	Grevillea	1m	1m	
GRASSES				
<i>Dianella caerulea</i>	Flax Lily	0.7m	0.3m	6
<i>Lomandra longifolia</i>	Mat Rush	1.2m	1.0m	6
<i>Lomandra longifolia</i> 'Tanika'	Mat Rush	0.6m	0.6m	6
<i>Themeda australis</i>	Kangaroo Grass	1m	0.3m	6
<i>Poa labillardieri</i>	Tussock Grass	0.8m	0.5m	6
<i>Dianella</i> 'Little Jess'	Flax Lily	0.4m	0.2m	8

Park Planting - Specimens				
TREES				
<i>Araucaria cunninghamii</i>	Hoop Pine	40m	10m	As Shown
<i>Arbutus unedo</i>	Irish Strawberry Tree	6m	4m	As Shown
<i>Ficus macrophylla</i>	Moreton Bay Fig	40m	40m	As Shown
<i>Pinus pinea</i>	Stone Pine	10m	15m	As Shown

SHRUBS/HEDGES				
<i>Buxus sempervirens</i>	English Box			2
<i>Choisya ternata</i>	Mexican Orange Blossom			2
<i>Raphiolepis indica</i> 'Apple Blossom'	Indian Hawthorn			4
<i>Acmena smithii</i> (dwarf varieties)	Acmena			6
<i>Xylosma senticosa</i>	Shiny Xylosma			2
<i>Phormium</i>	Phormium			2
<i>Ceanothus</i> 'Gloire de Versaille'	Ceanothus			2
<i>Magnolia stellata</i>	Magnolia			1
<i>Buddleia davidii</i>	Buddleia			1
<i>Plumbago auriculata</i> 'Royal Cape'	Plumbago			1
<i>Rosa banksia</i> (alba)	Rose			1
<i>Rosa rugosa</i> (purple and white)	Rose			1
<i>Spiraea x arguta</i>	Spiraea			1
<i>Clivea miniata</i>	Clivea			4
<i>Tibouchina</i> 'Jules'	Tibouchina			2
<i>Drejerella guttata</i>	Shrimp plant			2

PERENNIALS, CLIMBER & BULBS				
<i>Hemerocallis</i> vars	Day lily			4
<i>Argyranthemum frutescens</i>	Marguerite Daisy			6
<i>Kniphofia uvaria</i>	Red hot poker			2
<i>Lavendula dentata</i>	Lavender			2
<i>Trachelospermum jasminoides</i>	Star jasmine			4
<i>Wisteria sinensis</i>	Wisteria			1
<i>Narcissus tazetta</i>	Daffodil			12
<i>Felicia amelloides</i>	Blue Marguerite			6
<i>Acanthus mollis</i>	Oyster plant			2
<i>Nerine bowdenii</i>	Nerine			12
<i>Erigeron karvanskiamis</i>	Seaside Daisy			4
<i>Cerastium tomentosum</i>	Snow in Summer			6
<i>Convolvulus mauretanicus</i>	Ground Morning Glory			6
<i>Dietes iridioides</i>	Dietes			4

KITCHEN GARDEN SPECIES				
<i>Festuca glauca</i>	Festuca			6
<i>Phormium</i> (dwarf varieties)	Phormium			6
<i>Dianella</i>	Dianella			6
<i>Stachys byzantina</i>	Lambs ears			6

BOTANICAL NAME	COMMON NAME	MATURE HEIGHT	MATURE SPREAD	POT SIZE	DENSITY (No./m2)
Park Planting - View Park					
TREES					
<i>Allocasuarina littoralis</i>	Black She-Oak	9m	5m		As Shown
<i>Angophora floribunda</i>	Rough-barked Apple	15m	7m		As Shown
<i>Eucalyptus tereticornis</i>	Forest Red Gum	40m	20m		As Shown
<i>Ginkgo biloba</i>	Maidenhair Tree	9m	7m		As Shown

GRASSES					
<i>Lomandra longifolia</i>	Mat Rush	1.2m	0.5m	HIKO	6
<i>Lomandra</i> 'Katrinus'	Mat Rush	0.6m	0.6m	HIKO	6
<i>Poa labillardieri</i>	Tussock Grass	0.4m	0.25m	HIKO	6
<i>Themeda australis</i>	Kangaroo Grass	1m	0.3m		(relocated)

STATUS		DATE
DEVELOPMENT APPLICATION		07/10/09
ISSUE	NOTES / STATUS	INITIAL
		DATE
C	DA: MINOR AMENDMENTS	TDC 07/10/09
B	DA	TDC 01/10/09
A	DRAFT	TDC 28/09/09



NSW GOVERNMENT
Department of Planning



PROJECT BUNGARRIBEE ESTATE PROJECT STAGE 1A & 1B DEVELOPMENT APPLICATION			
CLIENT LANDCOM	PROJECT NUMBER NS1061	DRAWN TDC	DATE OCTOBER 09
DRAWING TITLE PLANT SCHEDULES 1 OF 2	DRAWING NUMBER LA3.08	SCALE NTS	ISSUE C

BOTANICAL NAME	COMMON NAME	MATURE HEIGHT	MATURE SPREAD	DENSITY (No./m2)
Streetscape Planting - Doonside Road				

TREES

<i>Alphitonia excelsa</i>	Red Ash	20m	10m	As Shown
<i>Grevillea robusta</i>	Silky Oak	25m	9m	As Shown
<i>Leptospermum petersonii</i>	Lemon-Scented Tea-Tree	7.5m	3m	As Shown

SHRUBS

<i>Callistemon citrinus</i> 'Western Glory'	Bottlebrush	4m	3m	1
<i>Grevillea</i> 'Fireworks'	Grevillea	1m	1m	2
<i>Philotheca myoporoides</i>	Long Leaf Wax Flower	1.8m	2m	2
<i>Westringia fruticosa</i> 'Zena'	Coastal Rosemary	0.9m	1.0m	4
<i>Xylosma senticosa</i>	Shiny Xylosma	5m	3m	2

GROUNDCOVER

<i>Grevillea</i> 'New Blood'	Grevillea Hybrid	-	1.5m spread	4
<i>Hardenbergia violacea</i> 'Flat White'	Prostrate White Hardenbergia	-	1.5m spread	4
<i>Lomandra longifolia</i> 'Tanika'	Mat Rush	0.6m	0.6m	6
<i>Trachelospermum asiaticum</i>	Prostrate Star Jasmine	-	1.5m spread	4

Streetscape Planting - Collector Road

TREES

<i>Brachychiton populneum</i>	Kurrajong	10m	5m	As Shown
<i>Ginkgo biloba</i> 'Princeton Sentry'	Maidenhair Tree	11m	4m	As Shown
<i>Platanus orientalis</i>	London Plane	13m	10m	As Shown

Streetscape Planting - Local Roads

TREES

<i>Elaeocarpus eumundii</i>	Eumundi Quondong	10m	6m	As Shown
<i>Melaleuca linarifolia</i>	Snow-in-Summer	9m	3m	As Shown
<i>Pyrus calleryana</i> 'Capital'	Ornamental Pear	11m	3.5m	As Shown
<i>Tristaniopsis laurina</i> 'Luscious'	Water Gum	8m	4m	As Shown
<i>Waterhousia floribunda</i>	Weeping Lilly Pilly	10m	5m	As Shown

Streetscape Planting - Gateway Entry Park

TREES

<i>Ficus macrophylla</i>	Moreton Bay Fig	40m	40m	As Shown
--------------------------	-----------------	-----	-----	----------

SHRUBS

<i>Banksia spinulosa</i> 'Birthday Candles'	Banksia hybrid 'Birthday Candles'	0.45m	0.6m	4
<i>Ceanothus</i> 'Blue Sapphire'	Blue Cushion	0.4m	0.6m	6
<i>Clivea miniata</i> 'Belgian Hybrid'	Clivea 'Belgian Hybrid'	0.75m	0.75m	4
<i>Chrysocephalum apiculatum</i>	Billy Buttons	0.6m	1m spread	4
<i>Dampiera stricta</i>	Blue Dampiera	0.25	-	6
<i>Gazania</i> Hybrids	Silver Leafed Gazania	0.15m	0.5m	6
<i>Grevillea</i> 'Bronze Rambler'	Prostrate Grevillea	-	2m spread	4
<i>Grevillea juniperina</i> 'Prostrate Gold'	Yellow Prostrate Grevillea	-	1.5m spread	4

STATUS		DATE
DEVELOPMENT APPLICATION		07/10/09
ISSUE	NOTES / STATUS	INITIAL
C	DA: MINOR AMENDMENTS	TDC 07/10/09
B	DA	TDC 01/10/09
A	DRAFT	TDC 28/09/09



NSW GOVERNMENT
Department of Planning



PROJECT BUNGARRIBEE ESTATE PROJECT STAGE 1A & 1B DEVELOPMENT APPLICATION			
CLIENT LANDCOM	PROJECT NUMBER NS1061	DRAWN TDC	DATE OCTOBER 09
DRAWING TITLE PLANT SCHEDULES 2 OF 2	DRAWING NUMBER LA3.09	SCALE NTS	ISSUE C

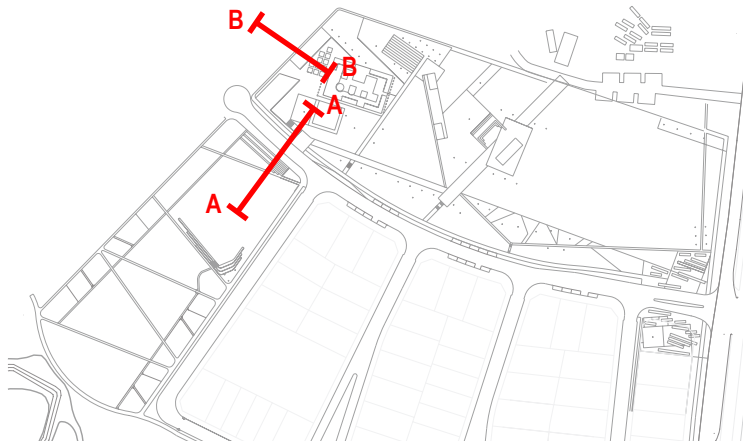

SECTION A-A

View Park | Landscape terraces | Pavement | Collector Road | Entry plaza A | Steps | Gravel court

Dry packed
sandstone
retaining wall



SECTION B-B

Lot | Local Street | Low shrub planting | Interpretive formal garden | Interpretive homestead area



STATUS		DATE
DEVELOPMENT APPLICATION		07/10/09
ISSUE	NOTES / STATUS	INITIAL
C	DA: MINOR AMENDMENTS	TDC
B	DA	TDC
A	DRAFT	TDC



NSW GOVERNMENT
Department of Planning



PROJECT
BUNGARRIBEE ESTATE PROJECT
STAGE 1A & 1B DEVELOPMENT APPLICATION

CLIENT
LANDCOM

DRAWING TITLE
HERITAGE & VIEW PARK SECTIONS SHEET 1

PROJECT NUMBER
NS1061

DRAWING NUMBER
LA3.10

DRAWN
TDC

SCALE
1:200@A3

DATE
OCTOBER 09

ISSUE
C

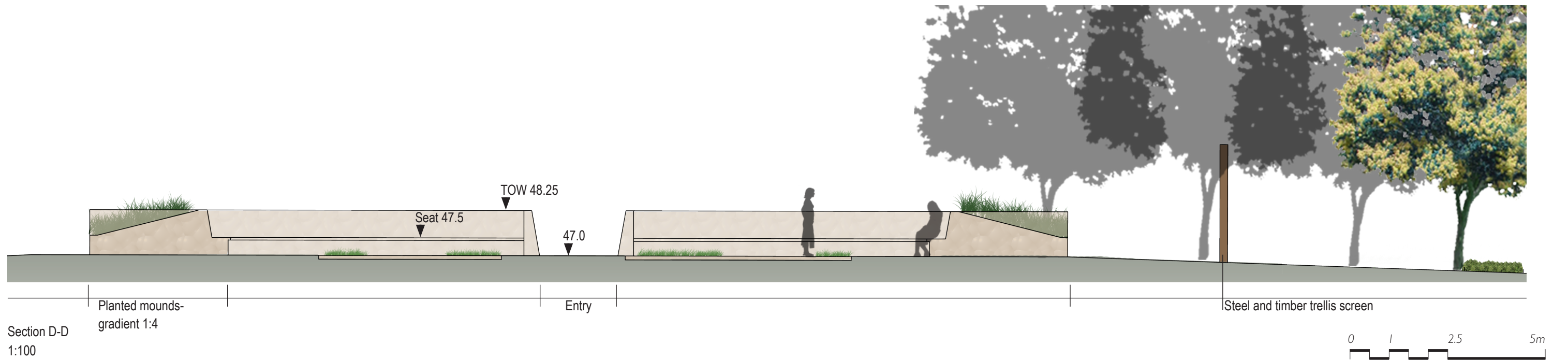
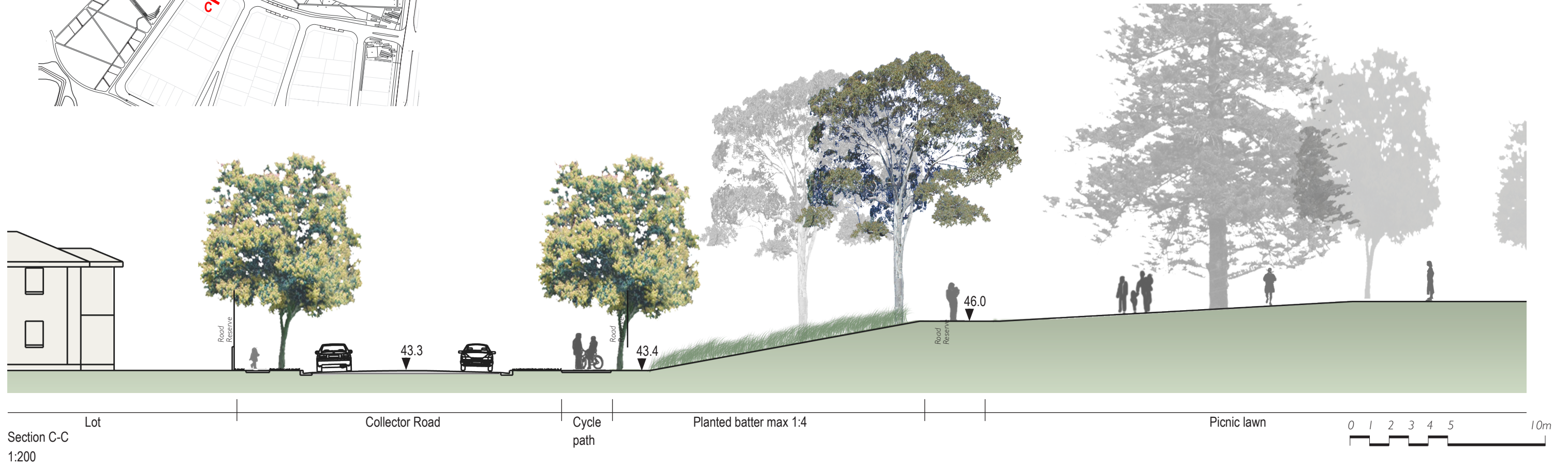
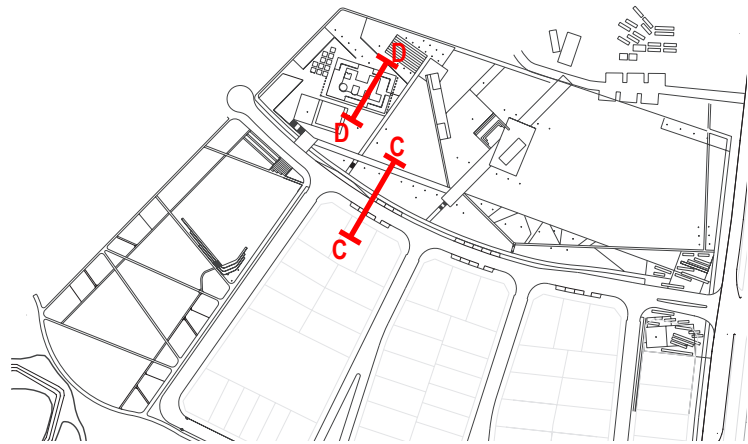

STATUS		DATE
DEVELOPMENT APPLICATION		07/10/09
ISSUE	NOTES / STATUS	INITIAL
C	DA: MINOR AMENDMENTS	TDC
B	DA	TDC
A	DRAFT	TDC



NSW GOVERNMENT
Department of Planning



PROJECT BUNGARRIBEE ESTATE PROJECT STAGE 1A & 1B DEVELOPMENT APPLICATION			
CLIENT LANDCOM	PROJECT NUMBER NS1061	DRAWN TDC	DATE OCTOBER 09
DRAWING TITLE HERITAGE & VIEW PARK SECTIONS SHEET 2	DRAWING NUMBER LA3.11	SCALE VARIES@A3	ISSUE C

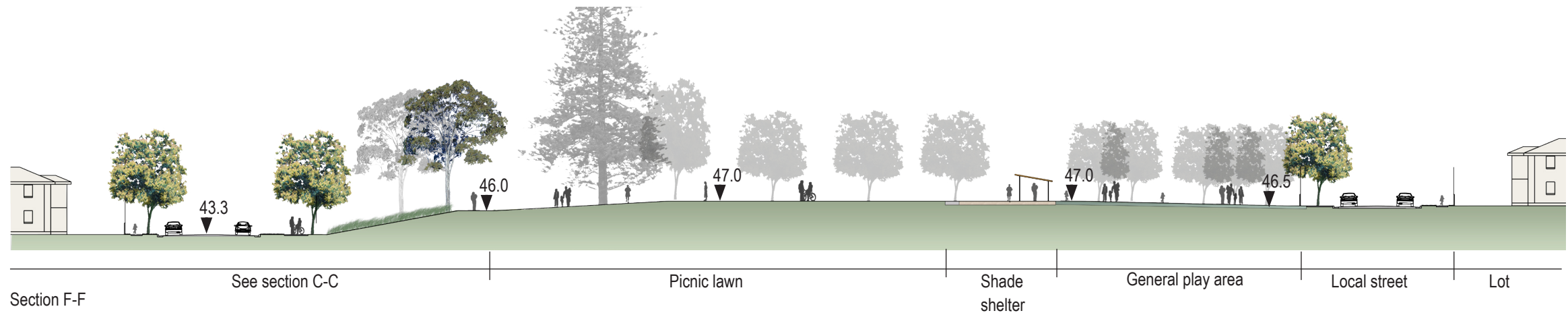
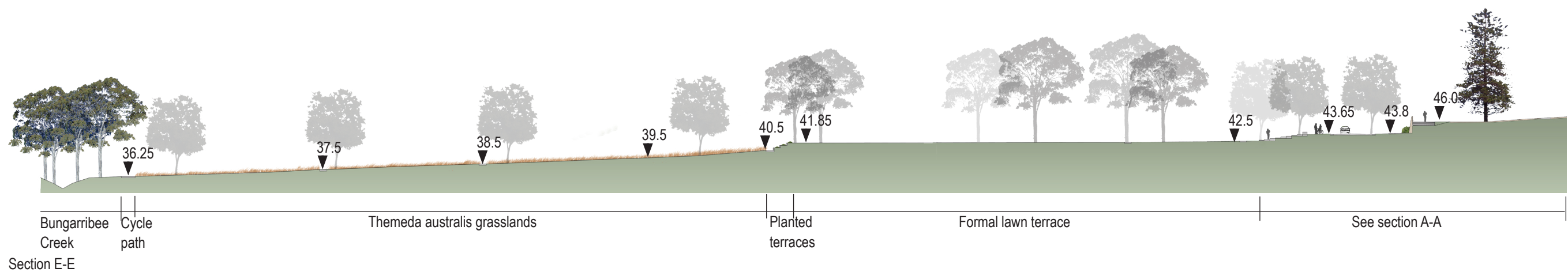
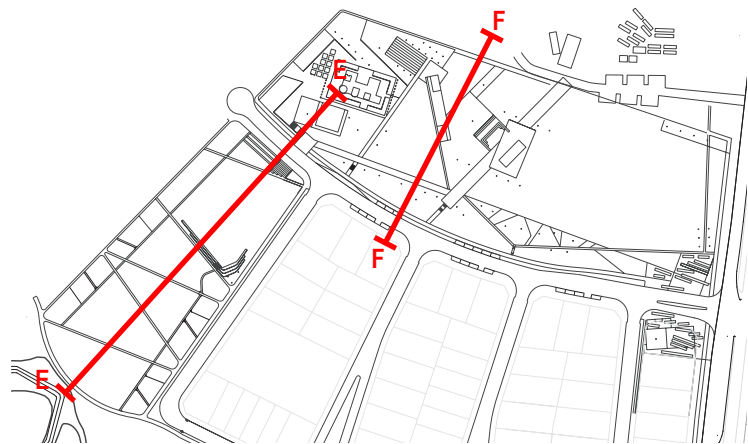

STATUS		DATE
DEVELOPMENT APPLICATION		07/10/09
ISSUE	NOTES / STATUS	INITIAL
C	DA: MINOR AMENDMENTS	TDC
B	DA	TDC
A	DRAFT	TDC



NSW GOVERNMENT
Department of Planning



PROJECT BUNGARRIBEE ESTATE PROJECT STAGE 1A & 1B DEVELOPMENT APPLICATION			
CLIENT LANDCOM	PROJECT NUMBER NS1061	DRAWN TDC	DATE OCTOBER 09
DRAWING TITLE HERITAGE & VIEW PARK SECTIONS SHEET 3	DRAWING NUMBER LA3.12	SCALE 1:750@A3	ISSUE C

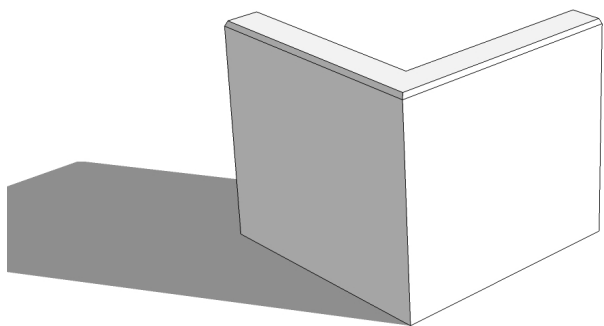

Off form finish Grade 2 concrete

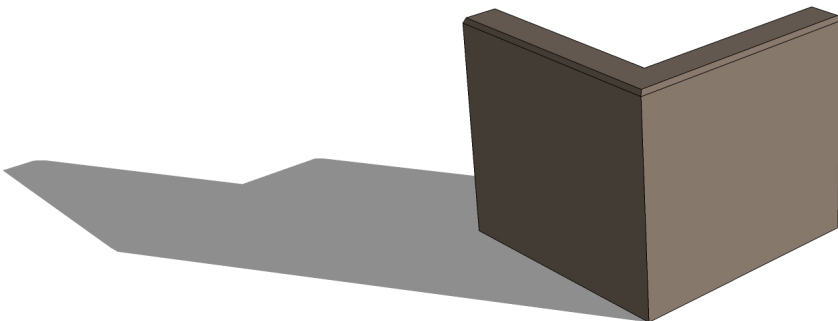

Off form finish Grade 2 coloured concrete

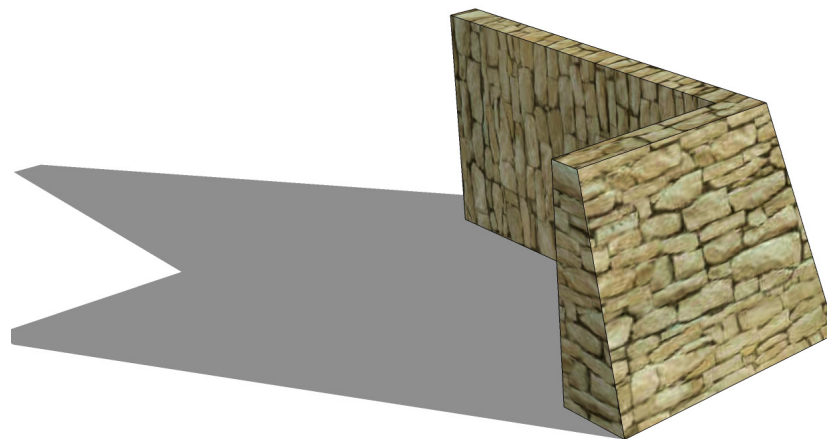

Dry packed sandstone with 10° batter on face (cladding face on concrete core for larger walls)

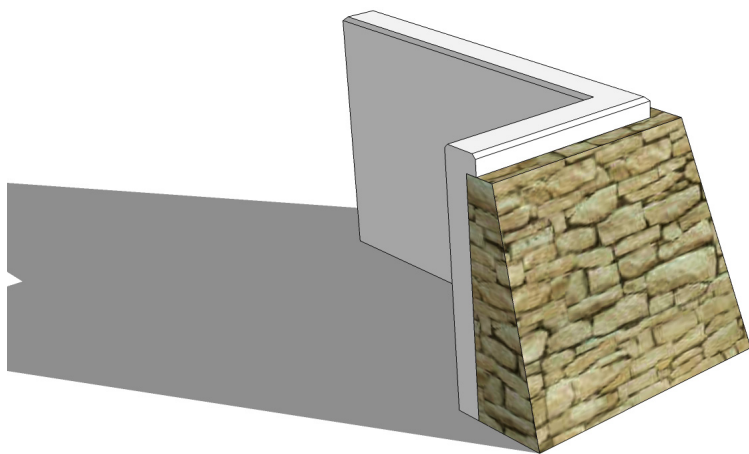

Concrete and sandstone combination

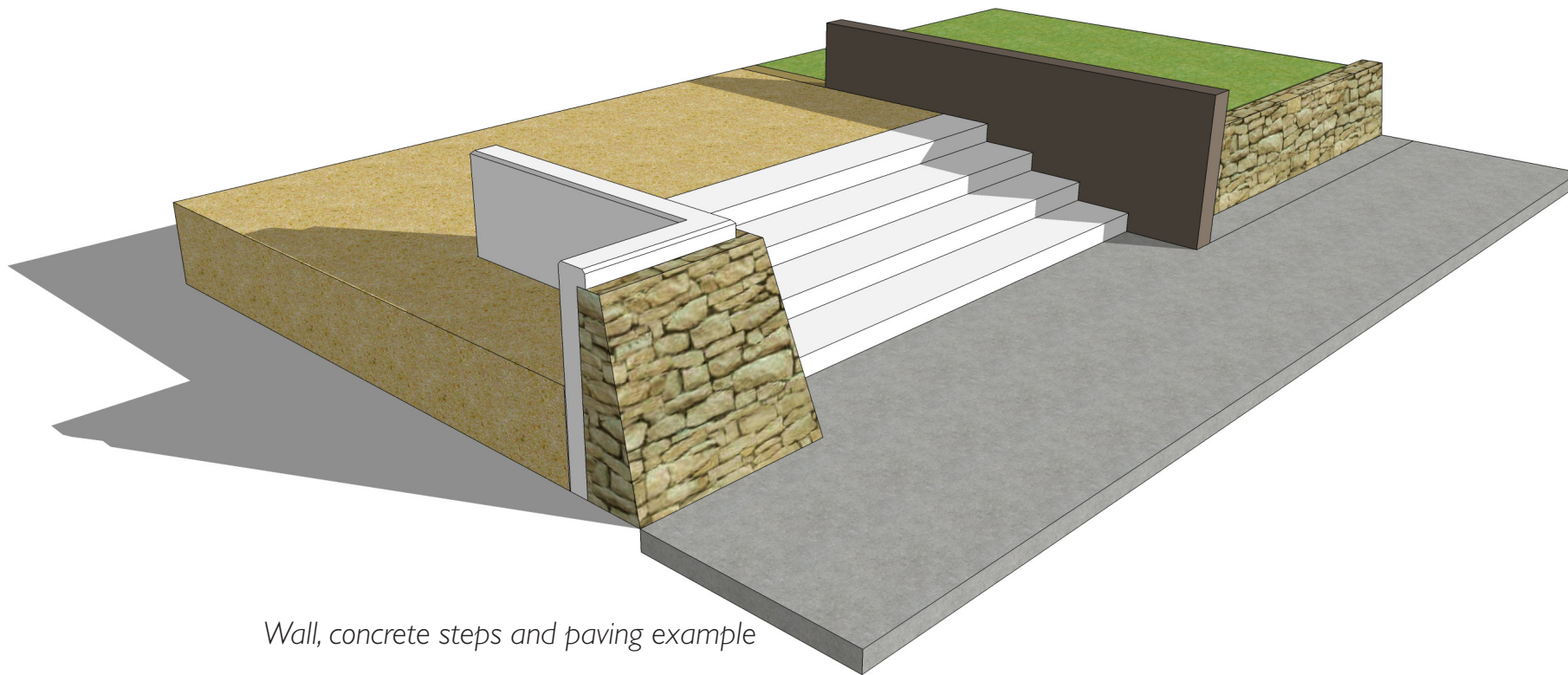

Wall, concrete steps and paving example

STATUS		DATE
DEVELOPMENT APPLICATION		07/10/09
ISSUE	NOTES / STATUS	INITIAL
C	DA: MINOR AMENDMENTS	TDC 07/10/09
B	DA	TDC 01/10/09
A	DRAFT	TDC 28/09/09



NSW GOVERNMENT
Department of Planning



PROJECT BUNGARRIBEE ESTATE PROJECT STAGE 1A & 1B DEVELOPMENT APPLICATION			
CLIENT LANDCOM	PROJECT NUMBER NS1061	DRAWN TDC	DATE OCTOBER 09
DRAWING TITLE WALL ELEMENTS	DRAWING NUMBER LA3.13	SCALE NTS	ISSUE C

FENCE POST/BOLLARD
ELEMENTS

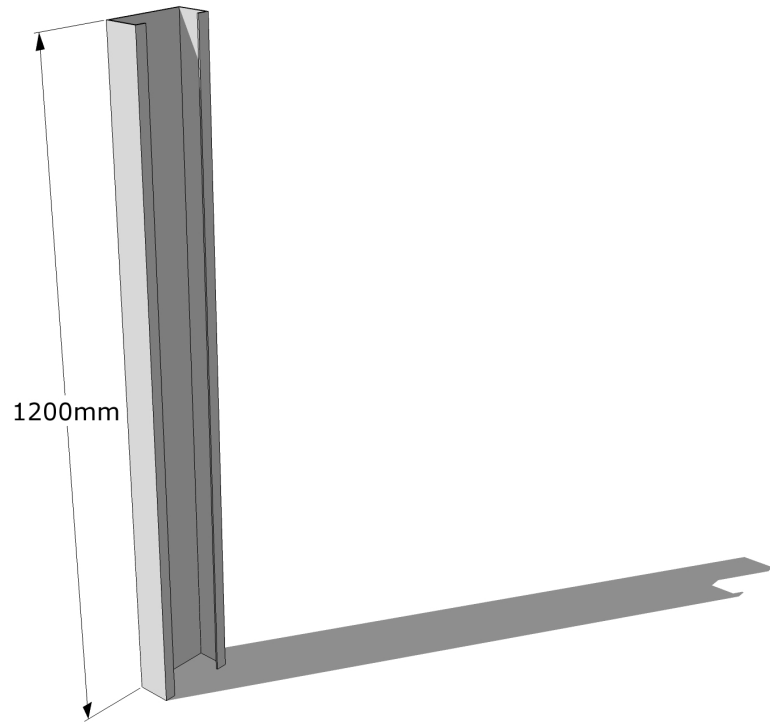

Powder coated steel lipped
channel section

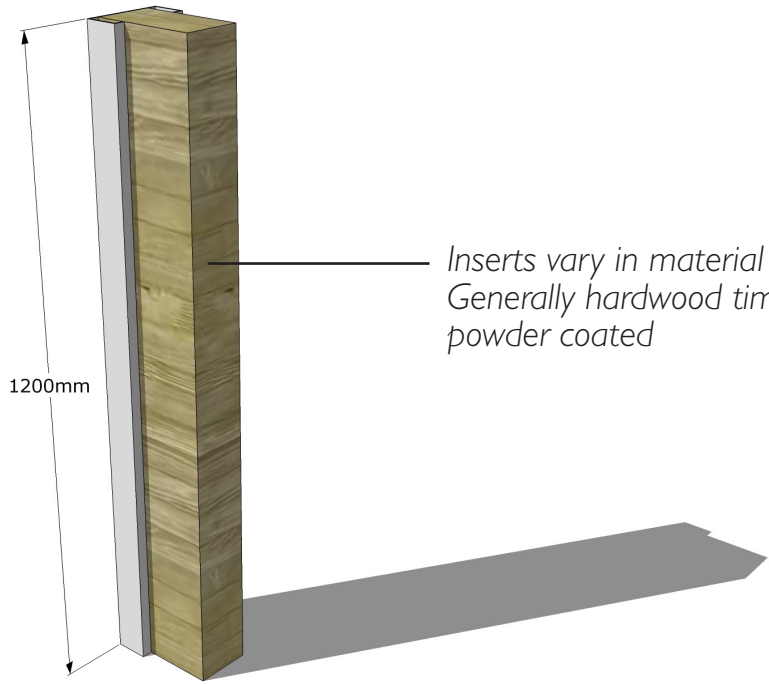

Lipped section with timber/
steel insert

Inserts vary in material and colour based on context.
Generally hardwood timber or mild steel hollow section,
powder coated

POST ELEMENTS

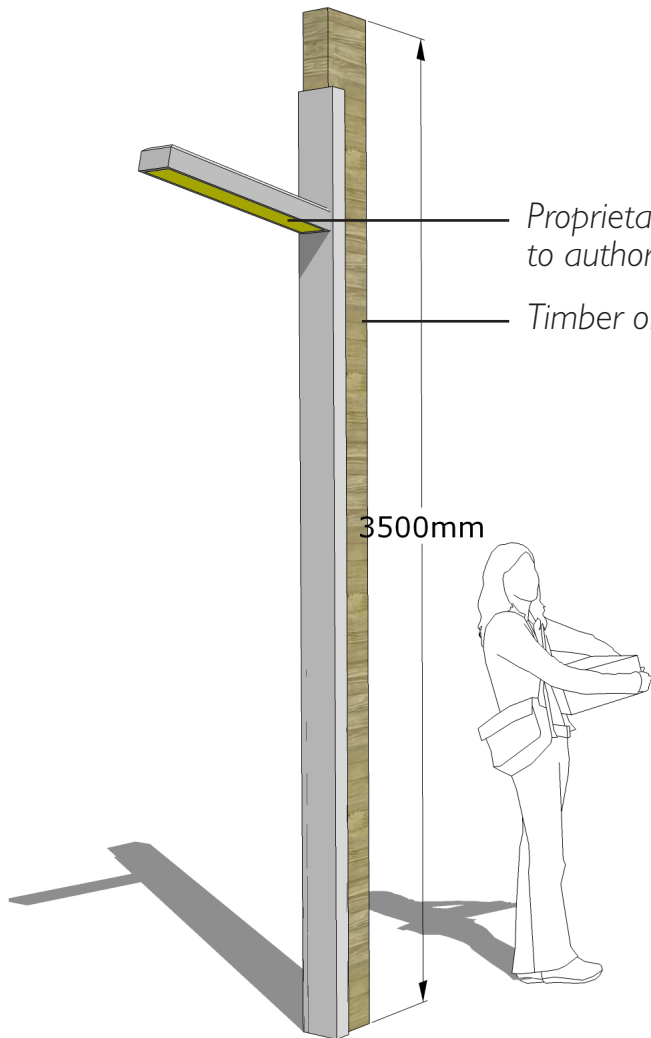

Custom post and lighting example

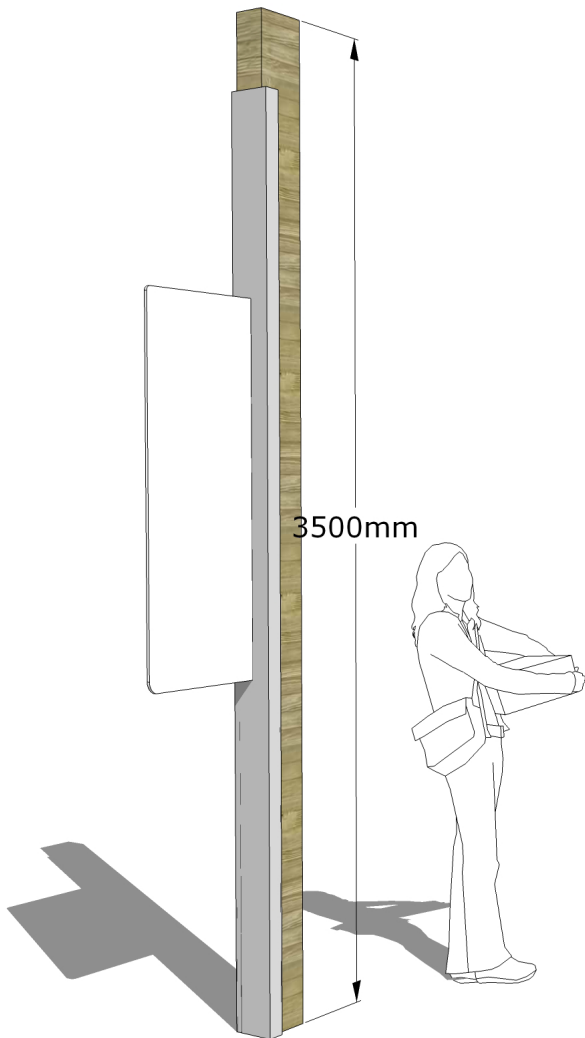

Custom post and signage example

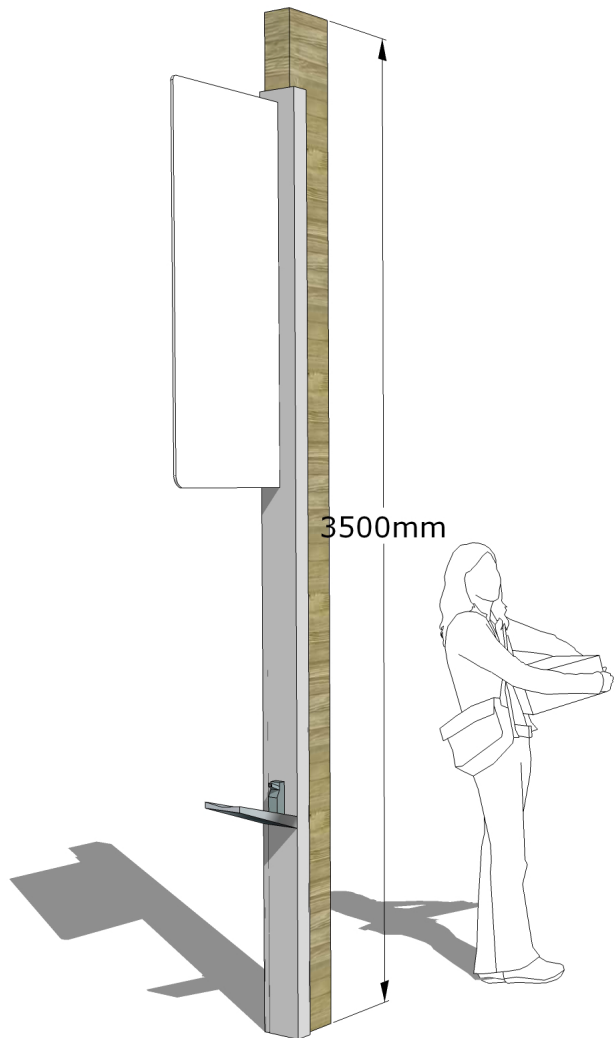

Custom post and bubbler/banner example

STATUS		DATE
DEVELOPMENT APPLICATION		07/10/09
ISSUE	NOTES / STATUS	INITIAL
C	DA: MINOR AMENDMENTS	TDC
B	DA	TDC
A	DRAFT	TDC



NSW GOVERNMENT
Department of Planning



PROJECT BUNGARRIBEE ESTATE PROJECT STAGE 1A & 1B DEVELOPMENT APPLICATION			
CLIENT LANDCOM	PROJECT NUMBER NS1061	DRAWN TDC	DATE OCTOBER 09
DRAWING TITLE POST, FENCE & BOLLARD ELEMENTS	DRAWING NUMBER LA3.14	SCALE NTS	ISSUE C

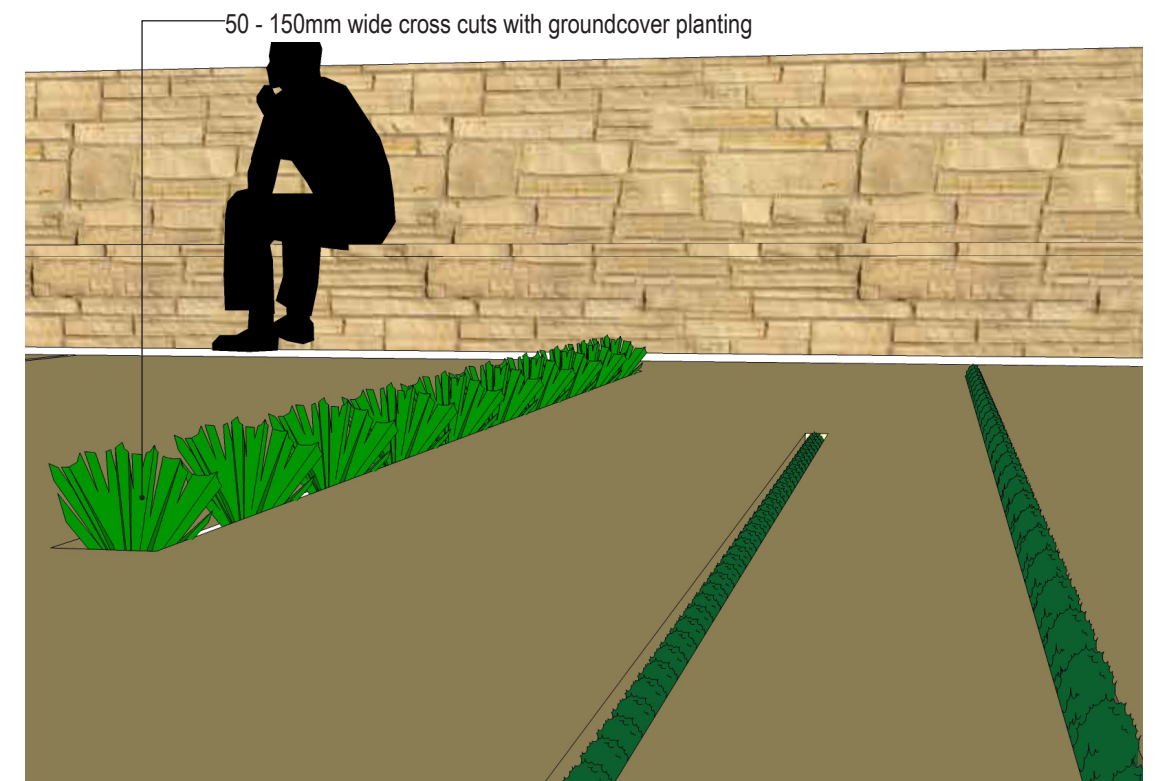
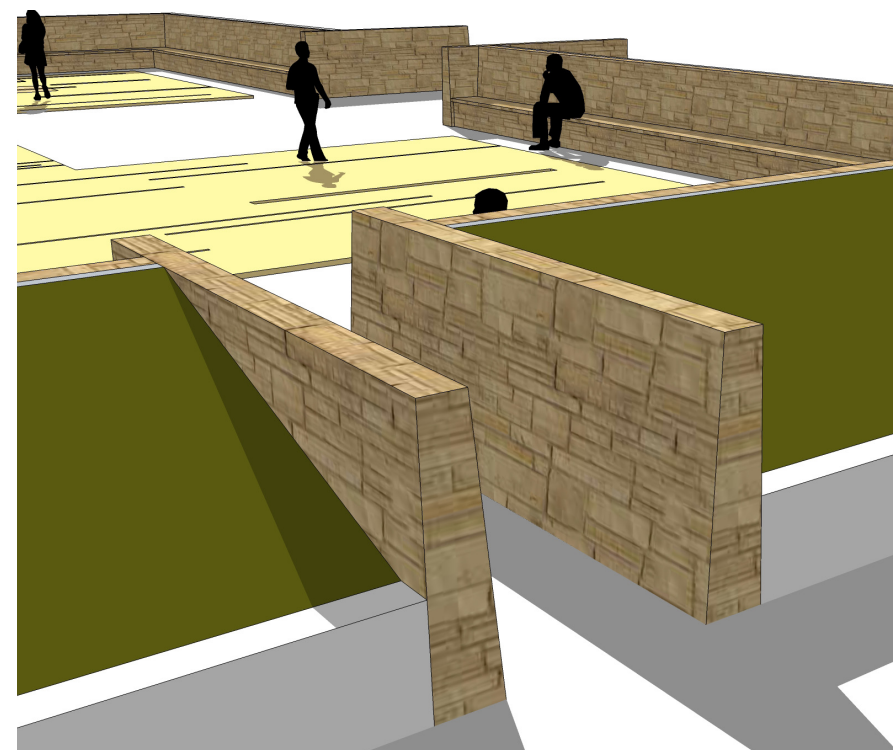
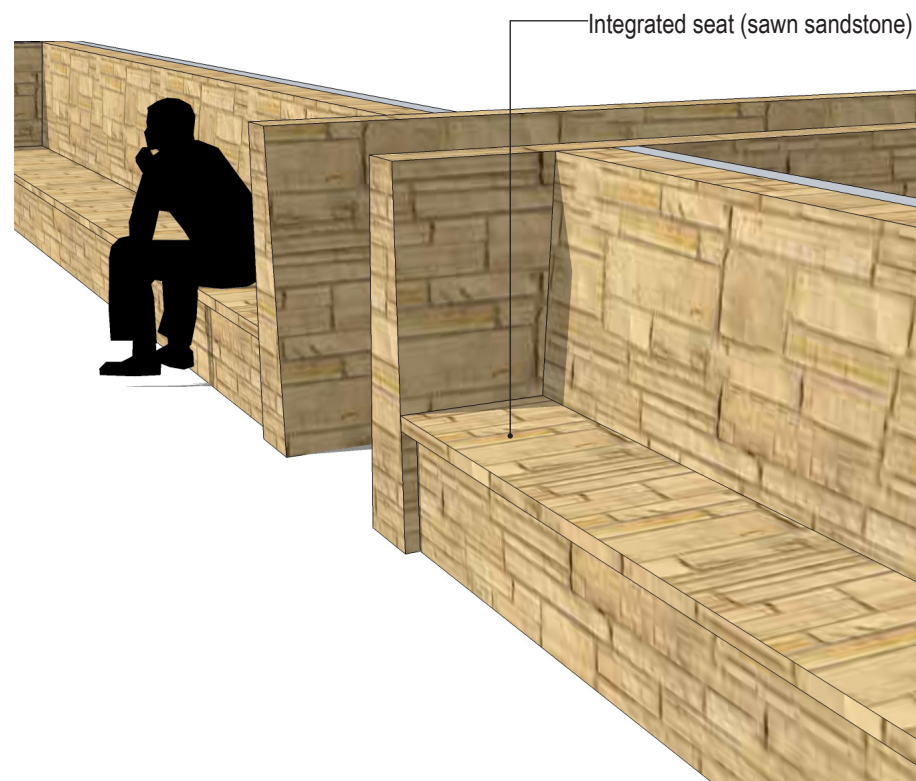
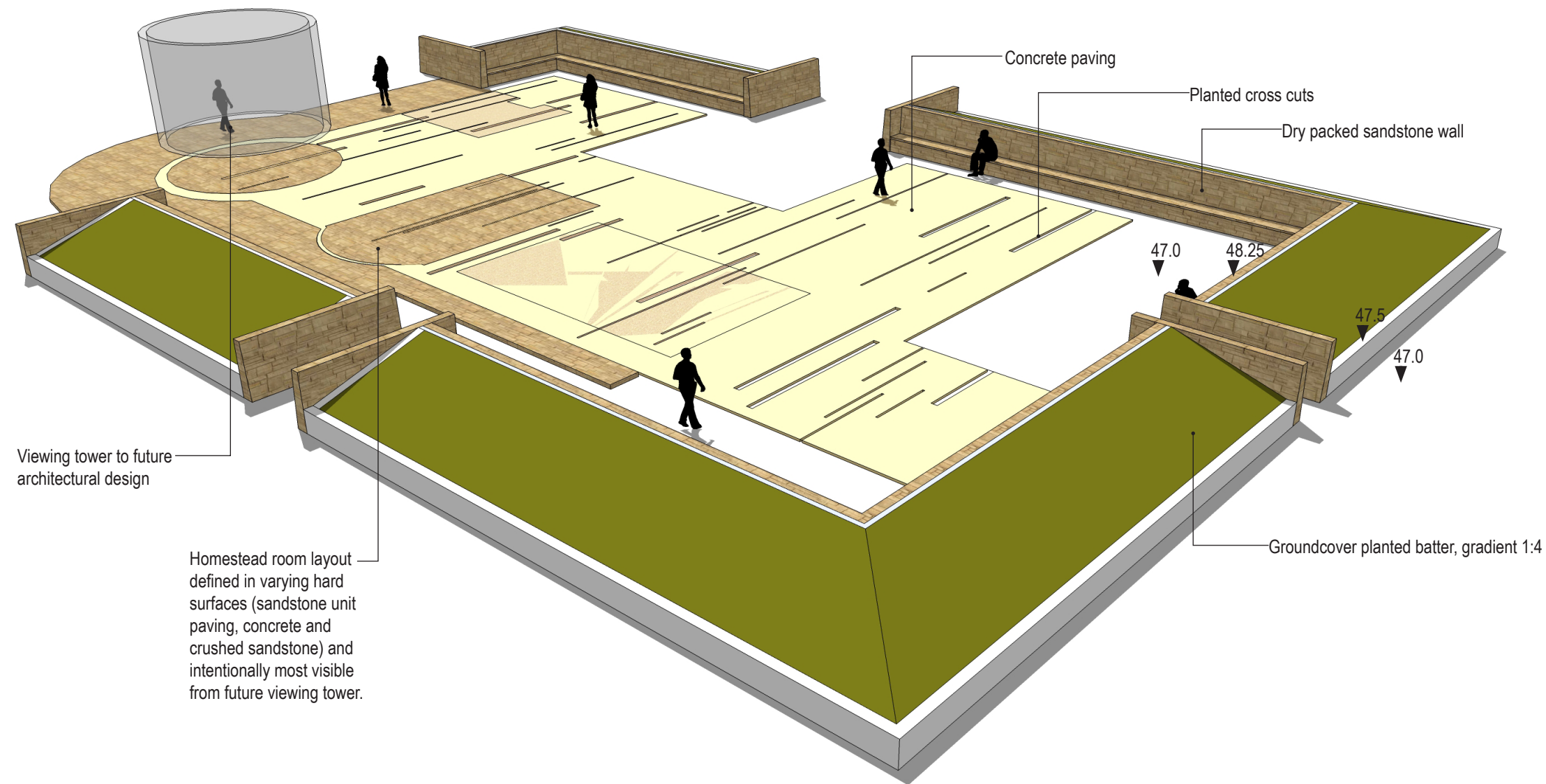

STATUS		DATE
DEVELOPMENT APPLICATION		07/10/09
ISSUE	NOTES / STATUS	INITIAL
C	DA: MINOR AMENDMENTS	TDC
B	DA	TDC
A	DRAFT	TDC



NSW GOVERNMENT
Department of Planning



PROJECT		BUNGARRIBEE ESTATE PROJECT STAGE 1A & 1B DEVELOPMENT APPLICATION	
CLIENT	LANDCOM	PROJECT NUMBER	NS1061
DRAWING TITLE	HOMESTEAD ENCLOSURE CONCEPT	DRAWING NUMBER	LA3.15
		SCALE	NTS
		DRAWN	TDC
		DATE	OCTOBER 09
		ISSUE	C

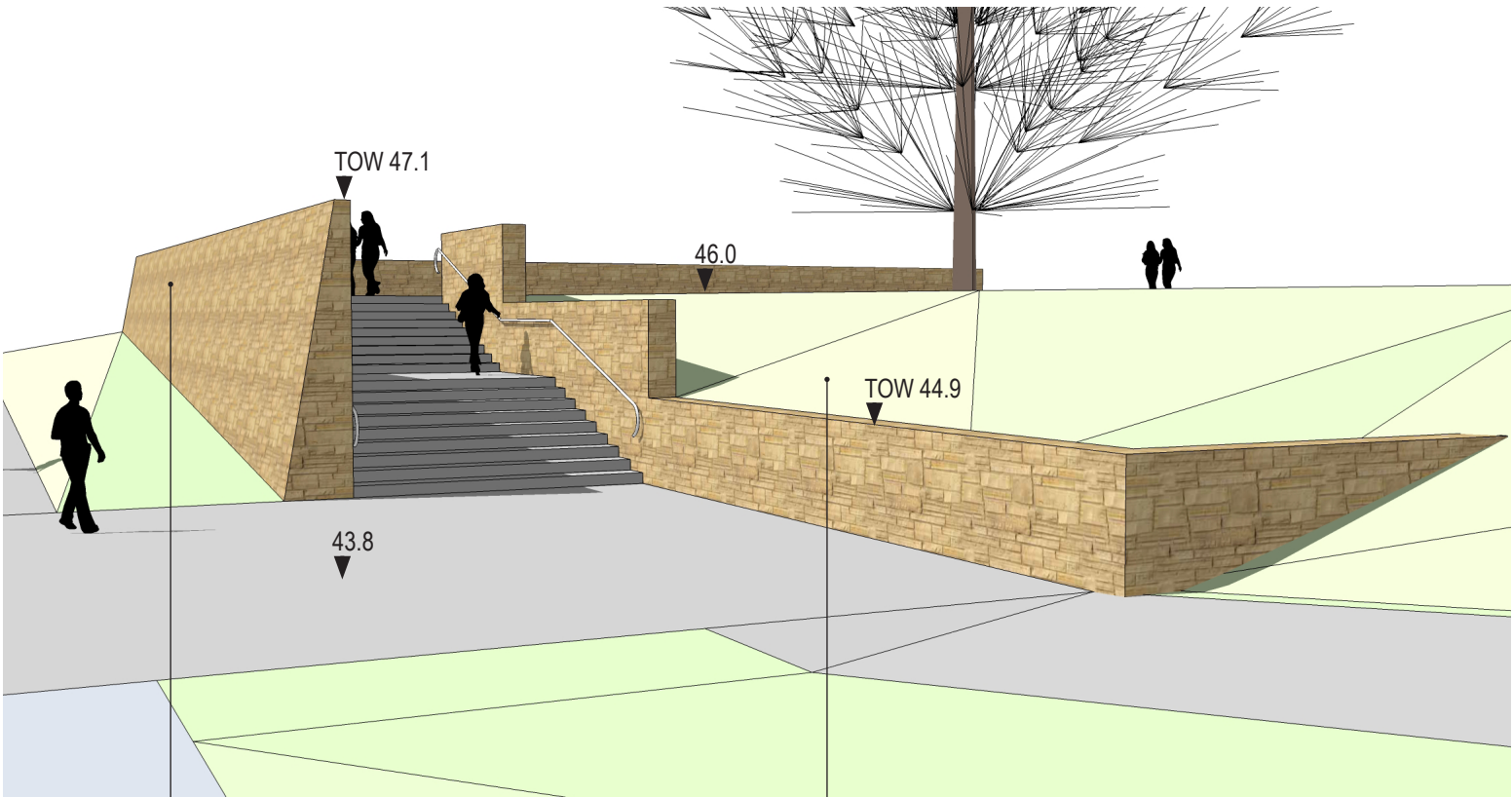

Retaining wall with dry packed sandstone cladding

Planted batters, max. gradient 1:4

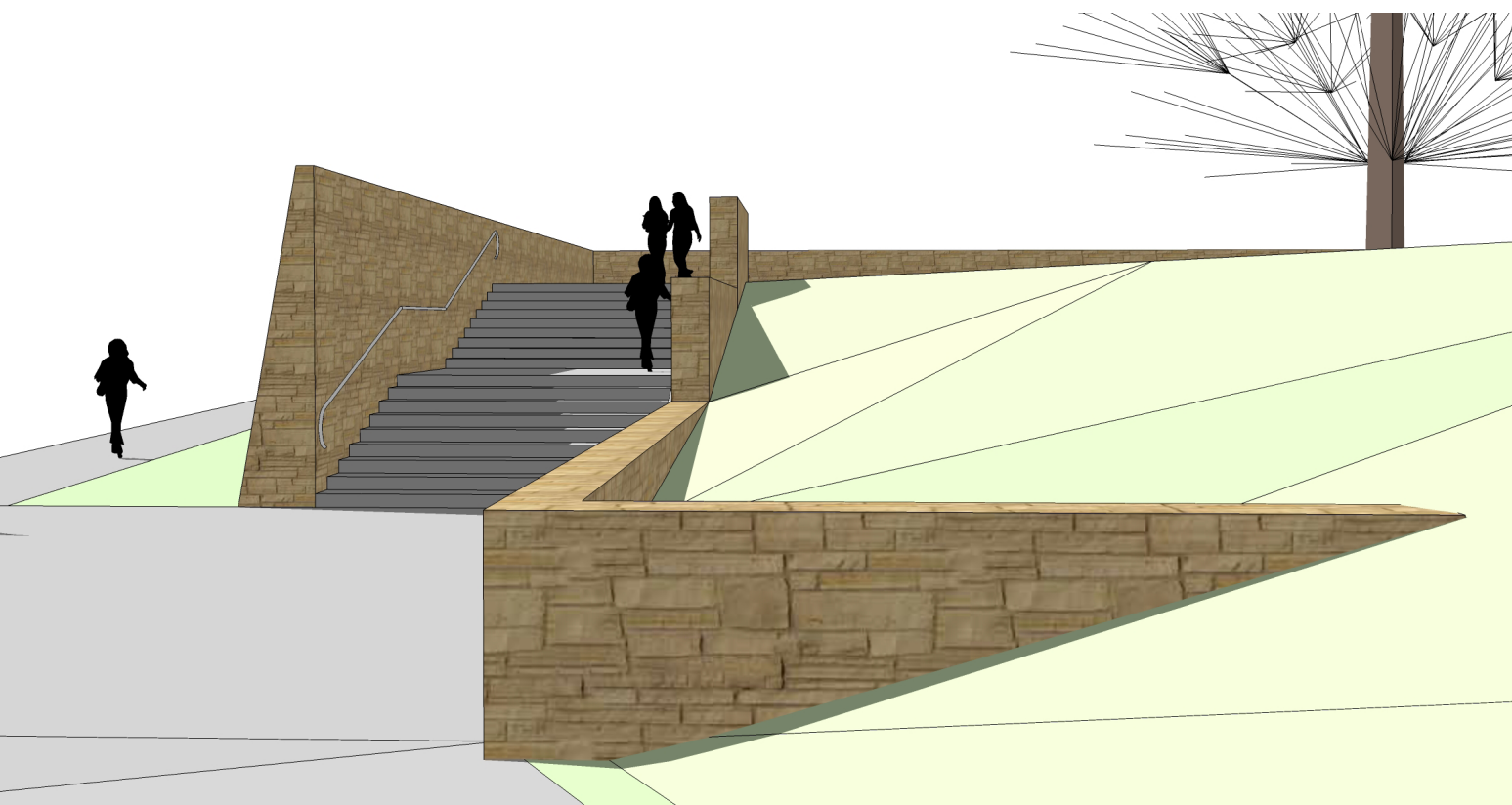
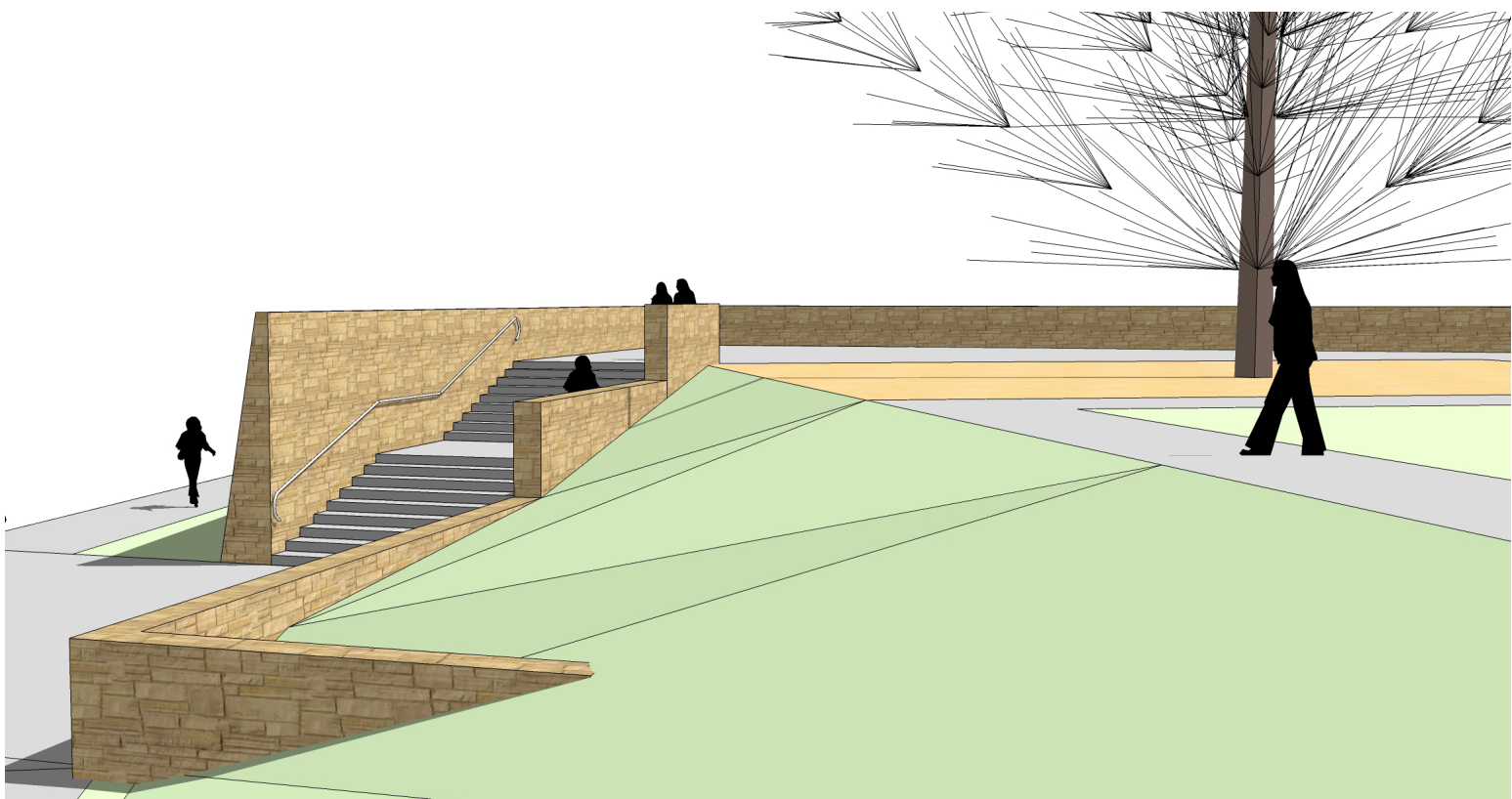

STATUS		DATE
DEVELOPMENT APPLICATION		07/10/09
ISSUE	NOTES / STATUS	INITIAL
C	DA: MINOR AMENDMENTS	TDC 07/10/09
B	DA	TDC 01/10/09
A	DRAFT	TDC 28/09/09



NSW GOVERNMENT
Department of Planning



PROJECT			
BUNGARRIBEE ESTATE PROJECT STAGE 1A & 1B DEVELOPMENT APPLICATION			
CLIENT	PROJECT NUMBER	DRAWN	DATE
LANDCOM	NS1061	TDC	OCTOBER 09
DRAWING TITLE	DRAWING NUMBER	SCALE	ISSUE
ENTRY COURT A VIEWS	LA3.16	NTS	C



STATUS		DATE
DEVELOPMENT APPLICATION		07/10/09
ISSUE	NOTES / STATUS	INITIAL
C	DA: MINOR AMENDMENTS	TDC 07/10/09
B	DA	TDC 01/10/09
A	DRAFT	TDC 28/09/09



NSW GOVERNMENT
Department of Planning



PROJECT
BUNGARRIBEE ESTATE PROJECT
STAGE 1A & 1B DEVELOPMENT APPLICATION

CLIENT
LANDCOM

DRAWING TITLE
HERITAGE VIEW PARK PERSPECTIVE

PROJECT NUMBER
NS1061

DRAWING NUMBER
LA3.17

DRAWN
TDC

DATE
OCTOBER 09

SCALE
NTS

ISSUE
C

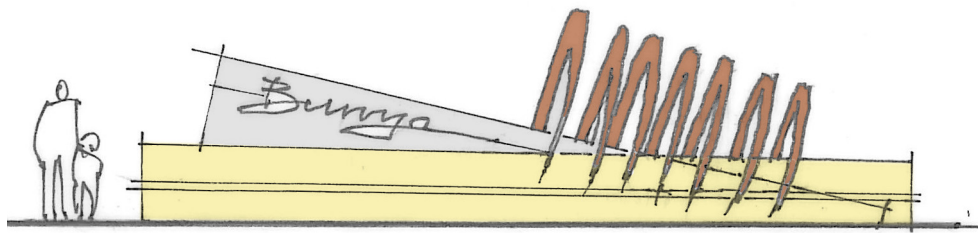

Feature entry signage "Tines": Sandstone wall, steel and Cor-ten steel sculpture

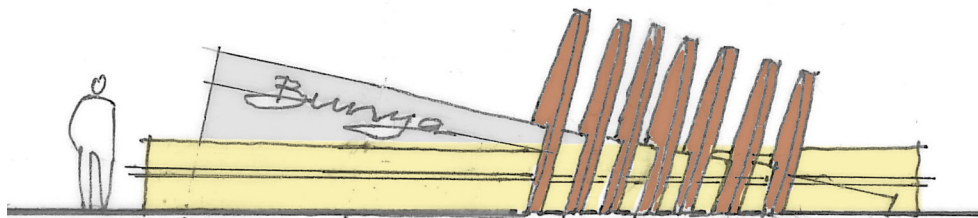

Feature entry signage "Harrows": Sandstone wall, steel and Cor-ten steel sculpture

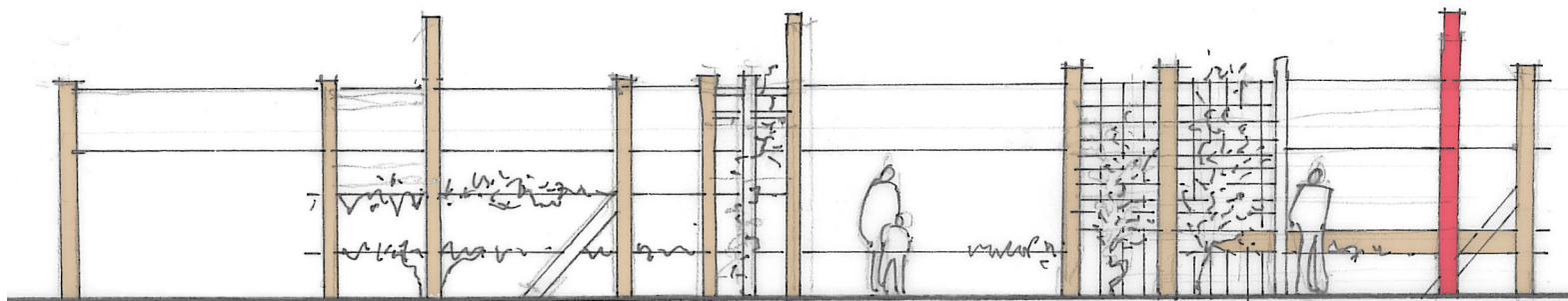

Feature entry walk 'Farm Fence' elevation: I beam or lipped channel sections and recycled timber posts with lattice framework for climbers. The design complements the noise wall design.

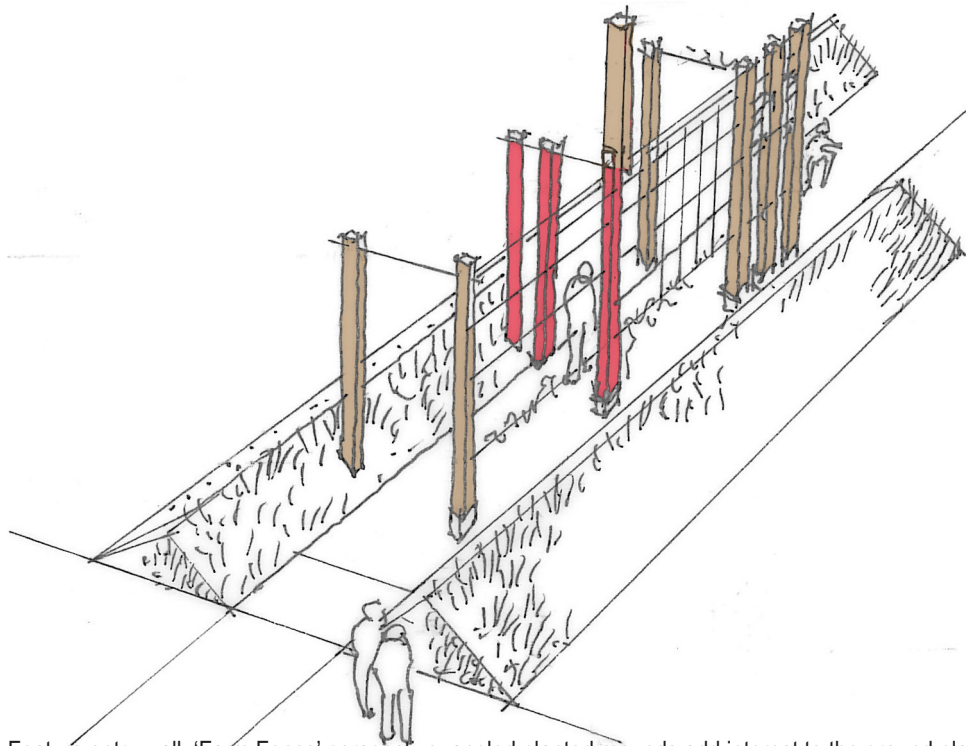

Feature entry walk 'Farm Fence' perspective: angled planted mounds add interest to the ground plane providing a sculptural landscape quality

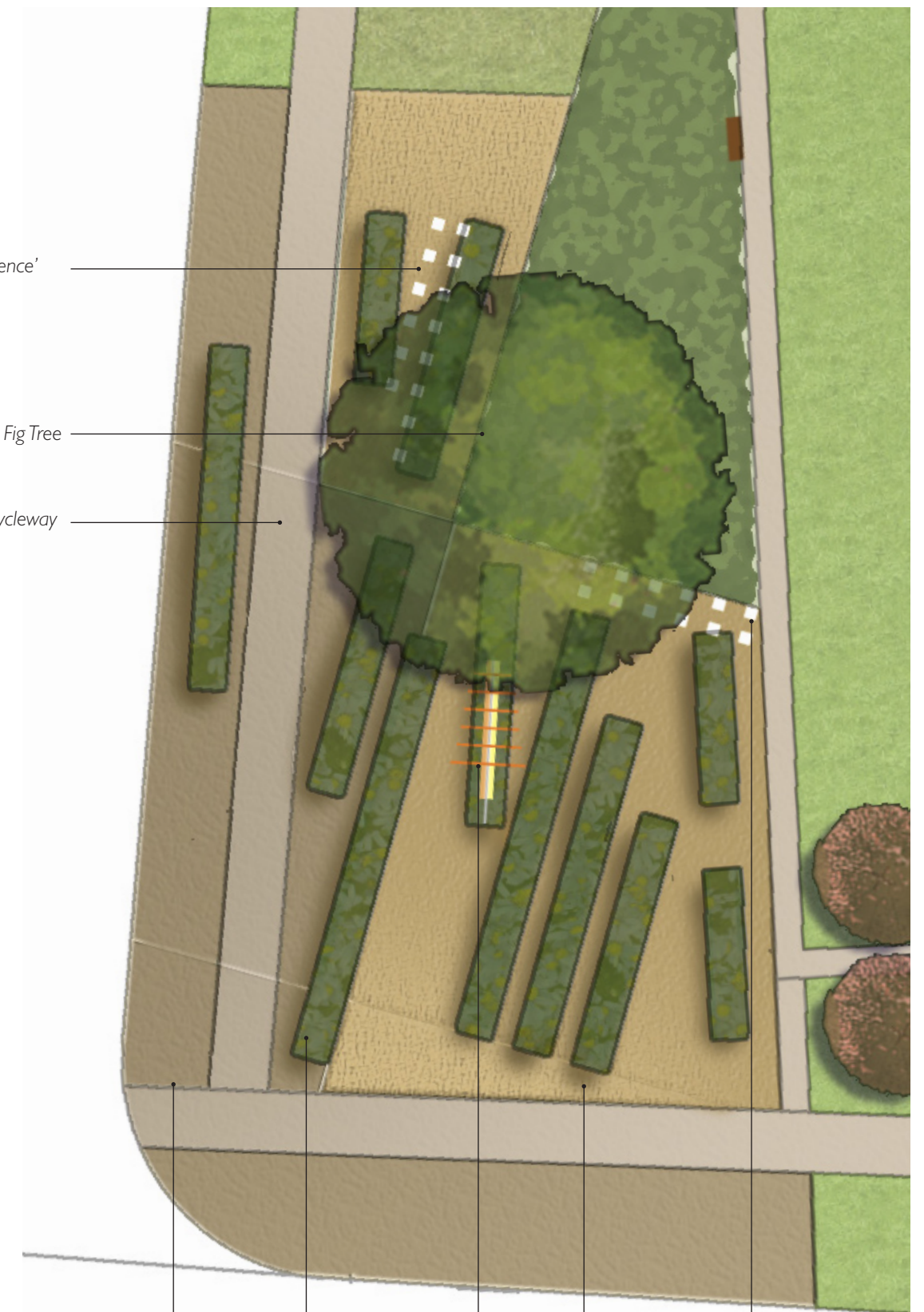

Concrete paved plaza space
0.5m high ornamental planting beds
Feature entry signage see details
Ornamental bound gravel to facilitate pedestrian permeability
Feature entry walk 'Farm Fence' timber posts see details
Plan 1:250 @ A3



STATUS		DATE
DEVELOPMENT APPLICATION		07/10/09
ISSUE	NOTES / STATUS	INITIAL
C	DA: MINOR AMENDMENTS	TDC
B	DA	TDC
A	DRAFT	TDC



NSW GOVERNMENT
Department of Planning



PROJECT BUNGARRIBEE ESTATE PROJECT STAGE 1A & 1B DEVELOPMENT APPLICATION			
CLIENT LANDCOM	PROJECT NUMBER NS1061	DRAWN TDC	DATE OCTOBER 09
DRAWING TITLE ENTRY PARK & DESIGN ELEMENTS	DRAWING NUMBER LA3.18	SCALE VARIES @ A3	ISSUE C

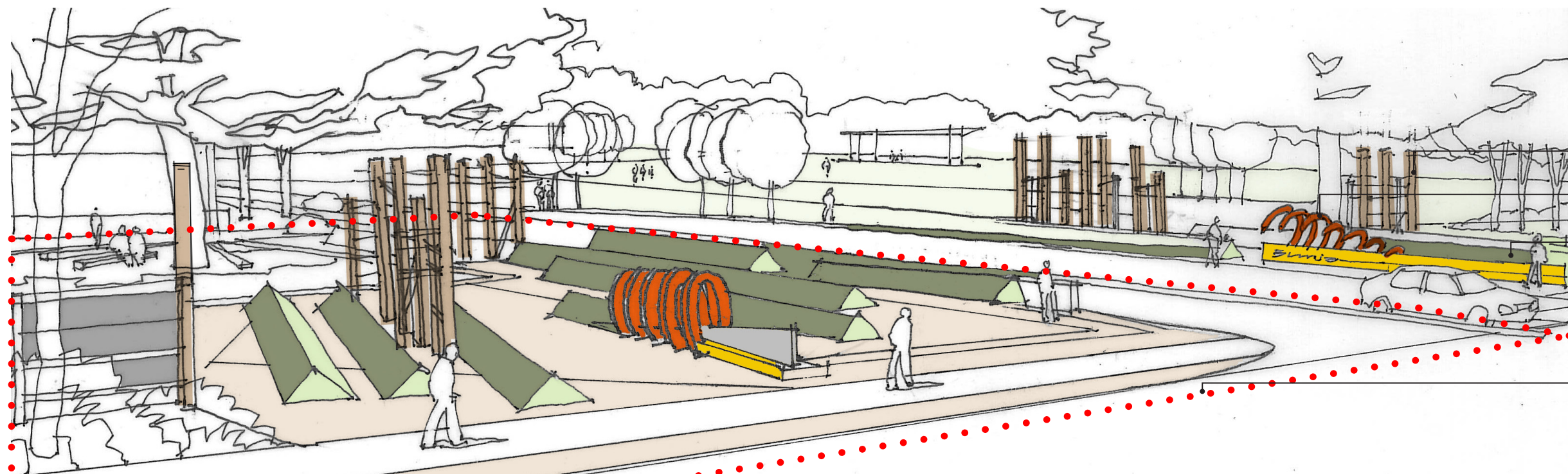

- Feature entry walk 'Farm Fence' (refer LA3.17)
- Feature entry signage 'Tines' sculpture (refer LA3.17)
- Groundcover planted 'windrows' representing field crops

South side of Entry Park subject of separate DA

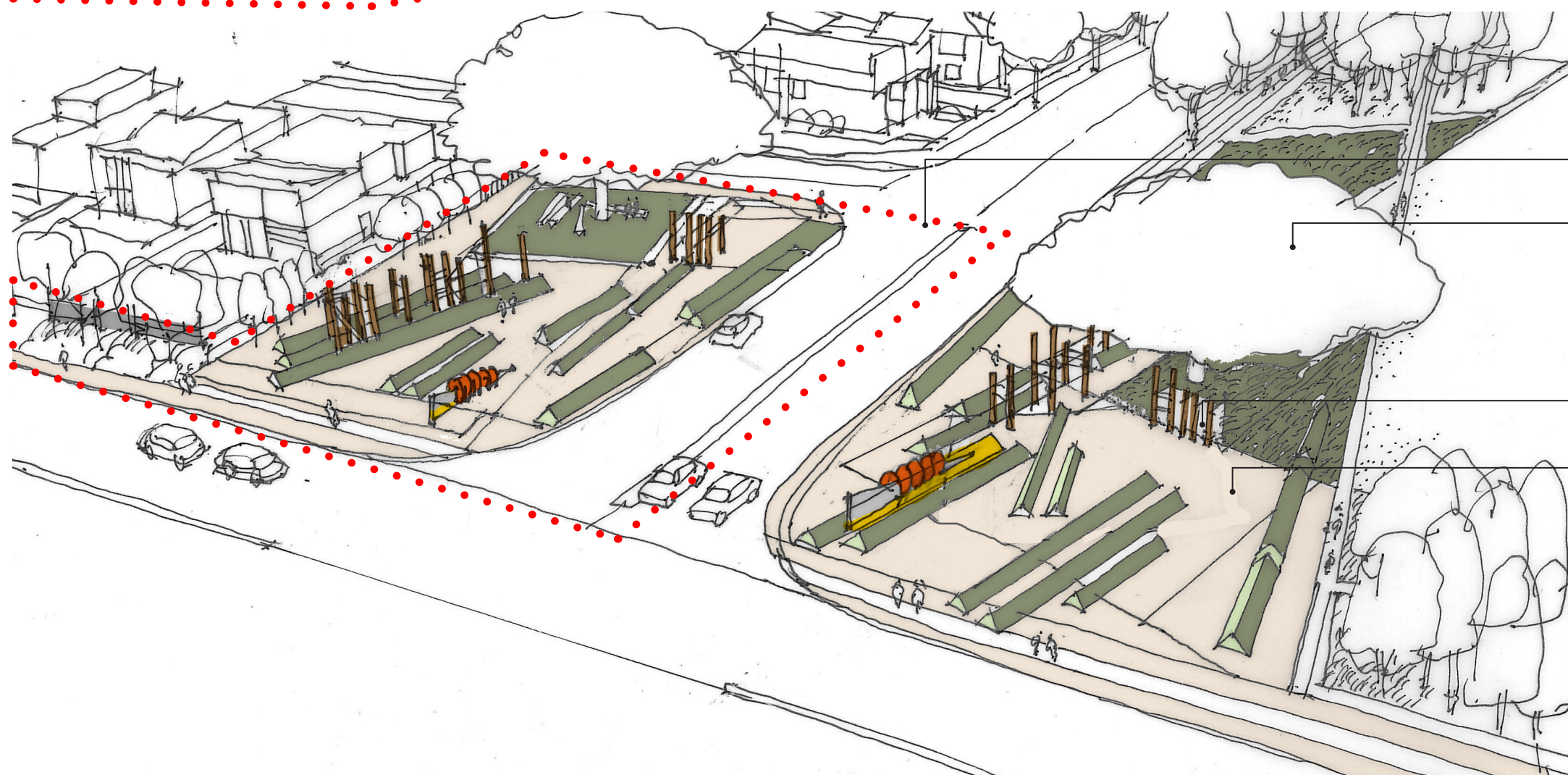

South side of Entry Park subject of separate DA

Feature Fig tree

Feature entry walk 'Farm Fence' (refer LA3.17)

Crushed sandstone court

STATUS		DATE
DEVELOPMENT APPLICATION		07/10/09
ISSUE	NOTES / STATUS	INITIAL
C	DA: MINOR AMENDMENTS	TDC
B	DA	TDC
A	DRAFT	TDC



NSW GOVERNMENT
Department of Planning



CLOUSTON associates
6A WETHERILL STREET - LEICHHARDT - PO BOX 64 - NSW 2060
TELEPHONE (02) 9550 1388 - FACSIMILE (02) 9550 9529
EMAIL: info@clouston.com.au - A/N 955 049 816
LANDSCAPE ARCHITECTS - URBAN DESIGNERS - LANDSCAPE PLANNERS



PROJECT
BUNGARRIBEE ESTATE PROJECT
STAGE 1A & 1B DEVELOPMENT APPLICATION

CLIENT
LANDCOM

DRAWING TITLE
ENTRY PARK - PERSPECTIVES

PROJECT NUMBER
NS1061

DRAWING NUMBER
LA3.19

DRAWN
TDC

SCALE
N/A

DATE
OCTOBER 09

ISSUE
C

Precedent Images



Example of raised planting beds at Doonside Entry area



Example showing integration of raised beds with signage



Indicative planting patterns and materials suitable for Doonside road entry



Original & Recycled Timbers



Fig Tree & Rural Fencing



Bluestone Drainage Channel

STATUS		DATE
DEVELOPMENT APPLICATION		07/10/09
ISSUE	NOTES / STATUS	INITIAL
C	DA: MINOR AMENDMENTS	TDC 07/10/09
B	DA	TDC 01/10/09
A	DRAFT	TDC 28/09/09



NSW GOVERNMENT
Department of Planning



PROJECT		BUNGARRIBEE ESTATE PROJECT STAGE 1A & 1B DEVELOPMENT APPLICATION	
CLIENT	LANDCOM	PROJECT NUMBER	NS1061
DRAWING TITLE	ENTRY PARK - PRECEDENT IMAGES	DRAWING NUMBER	LA3.20
		SCALE	N/A
		DRAWN	TDC
		DATE	OCTOBER 09
		ISSUE	C



Feature play net (Berliner Seilfabrik)



Kompan Swing



Kompan Galaxy Spica



Kompan Galaxy Supernova



Kompan Galaxy Flexus



Kompan Dino Tyre Swing

STATUS		DATE
DEVELOPMENT APPLICATION		07/10/09
ISSUE	NOTES / STATUS	INITIAL
C	DA: MINOR AMENDMENTS	TDC 07/10/09
B	DA	TDC 01/10/09
A	DRAFT	TDC 28/09/09



NSW GOVERNMENT
Department of Planning



PROJECT		BUNGARRIBEE ESTATE PROJECT STAGE 1A & 1B DEVELOPMENT APPLICATION	
CLIENT	LANDCOM	PROJECT NUMBER	NS1061
DRAWING TITLE	PLAY EQUIPMENT PALETTE	DRAWING NUMBER	LA3.21
		SCALE	1:1000 @ A1
		DRAWN	TDC
		DATE	OCTOBER 09
		ISSUE	C



COMMUNITY CENTRE & GARDENS
(TO FUTURE DA)

LEGEND

[- - -] Irrigated lawn (pop up
sprinkler irrigation)

STATUS		DATE
DEVELOPMENT APPLICATION		07/10/09
ISSUE	NOTES / STATUS	INITIAL DATE
C	DA: MINOR AMENDMENTS	TDC 07/10/09
B	DA	TDC 01/10/09
A	DRAFT	TDC 28/09/09



NSW GOVERNMENT
Department of Planning



PROJECT	
BUNGARRIBEE ESTATE PROJECT STAGE 1A & 1B DEVELOPMENT APPLICATION	
CLIENT	LANDCOM
DRAWING TITLE	IRRIGATION PLAN

PROJECT NUMBER	NS1061	DRAWN	TDC	DATE	OCTOBER 09
DRAWING NUMBER	LA3.22	SCALE	1:1500@A3	ISSUE	C