

DRAWING STATUS					
REV	DATE	BY	APP.	DETAILS	
				DESIGN BY	LJD 17/11/06
				DRAWN BY	CJG 17/11/09
				DRAFTING CHECK	
				DESIGN CHECK	
				FINAL APPROVAL	
PRELIMINARY					

	SCALE: (on A1 Original)
	1:200
	HEIGHT DATUM AHD

278 KEIRA STREET, WOLLONGONG, NSW 2500
Ph: (02) 4228 4133 Facsimile: (02) 4228 6811 ACN 003 936 981
This drawing is subject to COPYRIGHT. It remains the property of Forbes Rigby Pty Ltd

PROJECT TITLE
ILLAWARRA INTERNATIONAL
HEALTH PRECINCT
for
LA VIE DEVELOPMENTS

DRAWING TITLE			
PROPOSED STAGE 3 ROUNDABOUT PLAN			
Project No.	Com No.	Drawing No.	REV
108121	3	3003	P0

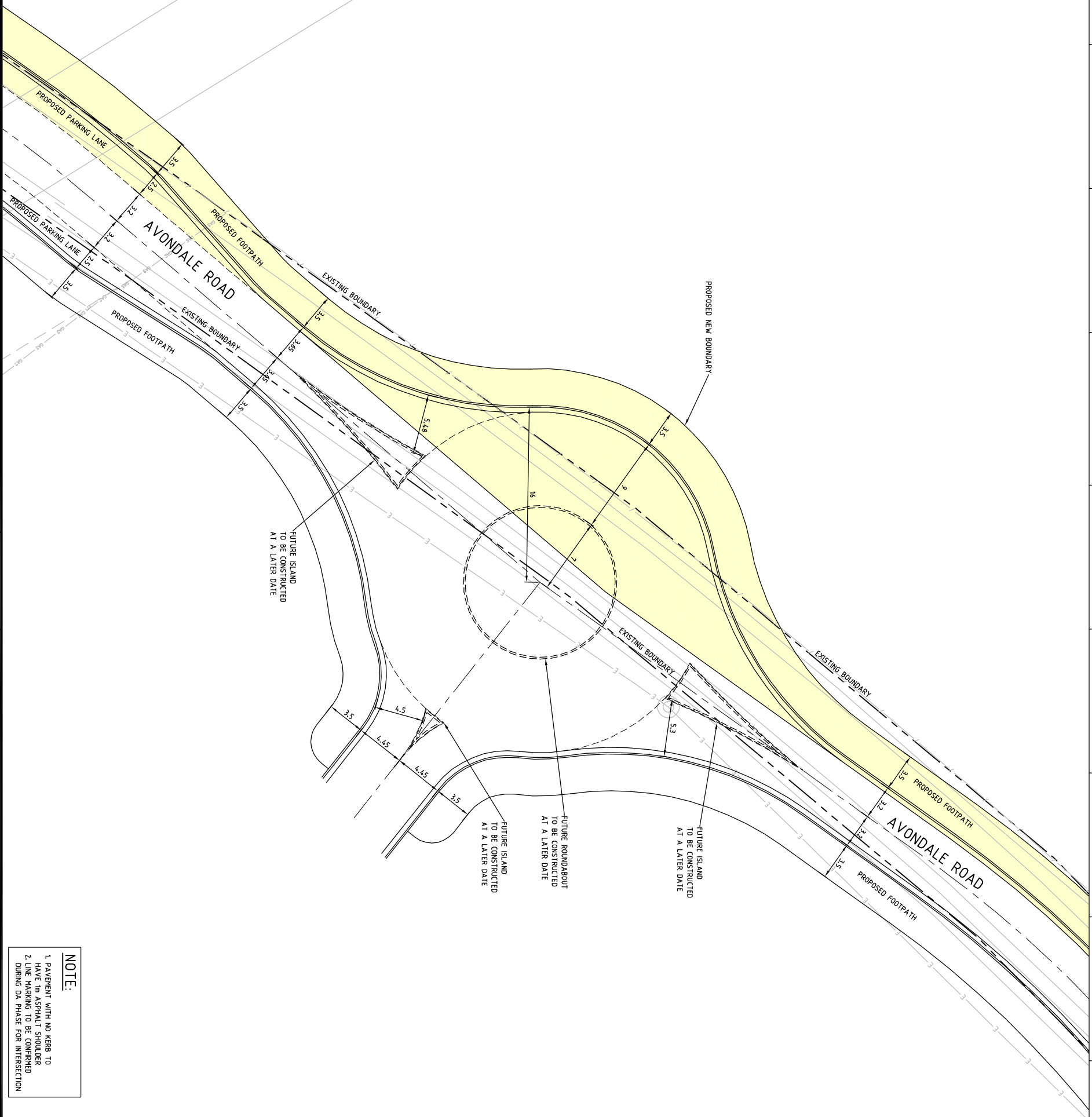

NOTE:

1. PAVEMENT WITH NO KERB TO HAVE 1m ASPHALT SHOULDER
2. LINE MARKING TO BE CONFIRMED DURING DA PHASE FOR INTERSECTION

LEGEND:

— — — — — EXISTING BOUNDARY LINE

— — — — — PROPOSED ROAD CENTRELINE

— — — — — PROPOSED ROAD TRAFFIC LANE

— — — — — FUTURE WORKS

0 10
SCALE 1:200

W
S
E