

L04

march 10

main courtyard cardinal freeman village care precinct

key

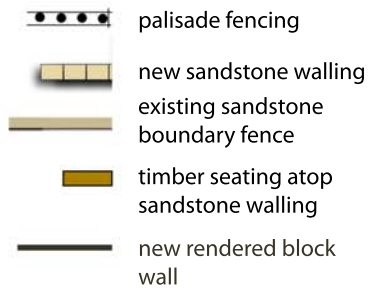
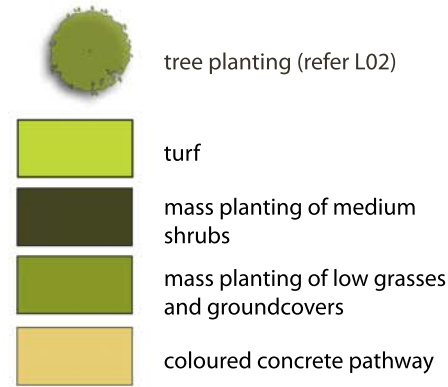

scattered planting of eucalypts with a meandering path wandering beneath (ref photo b).

water feature pond with spray jets aligned with palisade fencing providing views to the street

sculptural element to building corner to provide pleasant outlook from living area

palisade fencing provides break in wall allowing views to active street, copped planting of spotted gums



a. example of potted wall
b. existing path on site as proposed to northern walkway

ramped access to garden with sensory planting provides experiential walkway

terraced level reduces drop between courtyard and staff courtyard

turf space with small deciduous trees provides pleasant area for residents to gather

steel and timber pergola with climber provides "green roof" to courtyard with outdoor seating close to facilities with views to the street

mass planting of sensory plants to provide experiential walkway

1800mm high rendered block-work walls to provide separation between the dementia courtyard and the main courtyard. walls are to be mounted with colourful planted pots (refer photo a)



site details:
137 victoria street, ashfield
client:
aevum
date:
march 10
job number:
8190.5
scale:
1/100
rev. number:
g

0 2.5m 10m 20m 30m @ A1

terras
landscape architects

L05

march 10

dementia courtyard cardinal freeman village care precinct

key



structural planting
(refer to L02)

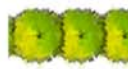

hedge planting



sensory planting



shade tolerant shrubs

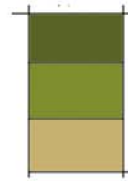

medium height shrubs and plants
mass planting of low groundcovers and grasses
exposed aggregate paving



new sandstone wall



palisade fencing



existing sandstone wall



new retaining wall refer to architectural details



new rendered concrete block wall

g

gate

note: plants chosen for their beauty and sensory value to appeal to multiple senses and to imitate a home garden with a large variety (non toxic).

site details:
137 victoria street, ashfield
client:
aevum
date:
march 10
job number:
8190.5
scale:
1/100
rev. number:
g

QUIET ZONE
intimate gardens, sensory plants
OPEN GROUP AREA
individual and group seating
ACTIVE ZONE
her gardening, sweeping, tool shed

feature gate with letter box
wall face to be a bright artwork of mosaic tiles
feature tree with sensory planting beneath
500mm high sandstone walls with timber seat above
mass planting to soften courtyard and provide privacy to rooms
steel and timber pergola with hanging baskets provides outdoor roof to courtyard. baskets can be lowered for residents to garden
existing sandstone sections of wall removed and set back from main line providing interest and relief along queen street
raised water feature within easy reach provides sensory enjoyment (refer to photo e)
spotted gums enhance streetscape in wall break and reduce scale of building
raised sandstone planter allows residents to stand and garden (refer photo b)
shallow planting tray suspended on wall allows for easy leg room for wheel chair access to allow less able residents to garden (refer photo d)
tool/potting shed (refer photo a)
gate provides maintenance access

queen street

B
L08

0 2.5m 10m 20m 30m @ A1



terras
landscape architects











L06

march 10

southern courtyard cardinal freeman village care precinct



key

-  structural planting (refer to L02)
-  hedge screen planting
-  medium height lush shade plantings
-  corten panel
-  mass planting of low grasses
-  coloured concrete type a with grit finish
-  coloured concrete type b with grit finish
-  exposed aggregate concrete
-  1500mm high sandstone wall
-  lush dense mass planting of medium height provides pleasant outlook and screens rooms from courtyard
-  hedge to terraced level provides more formal green wall. retaining wall part of architectural/earthworks

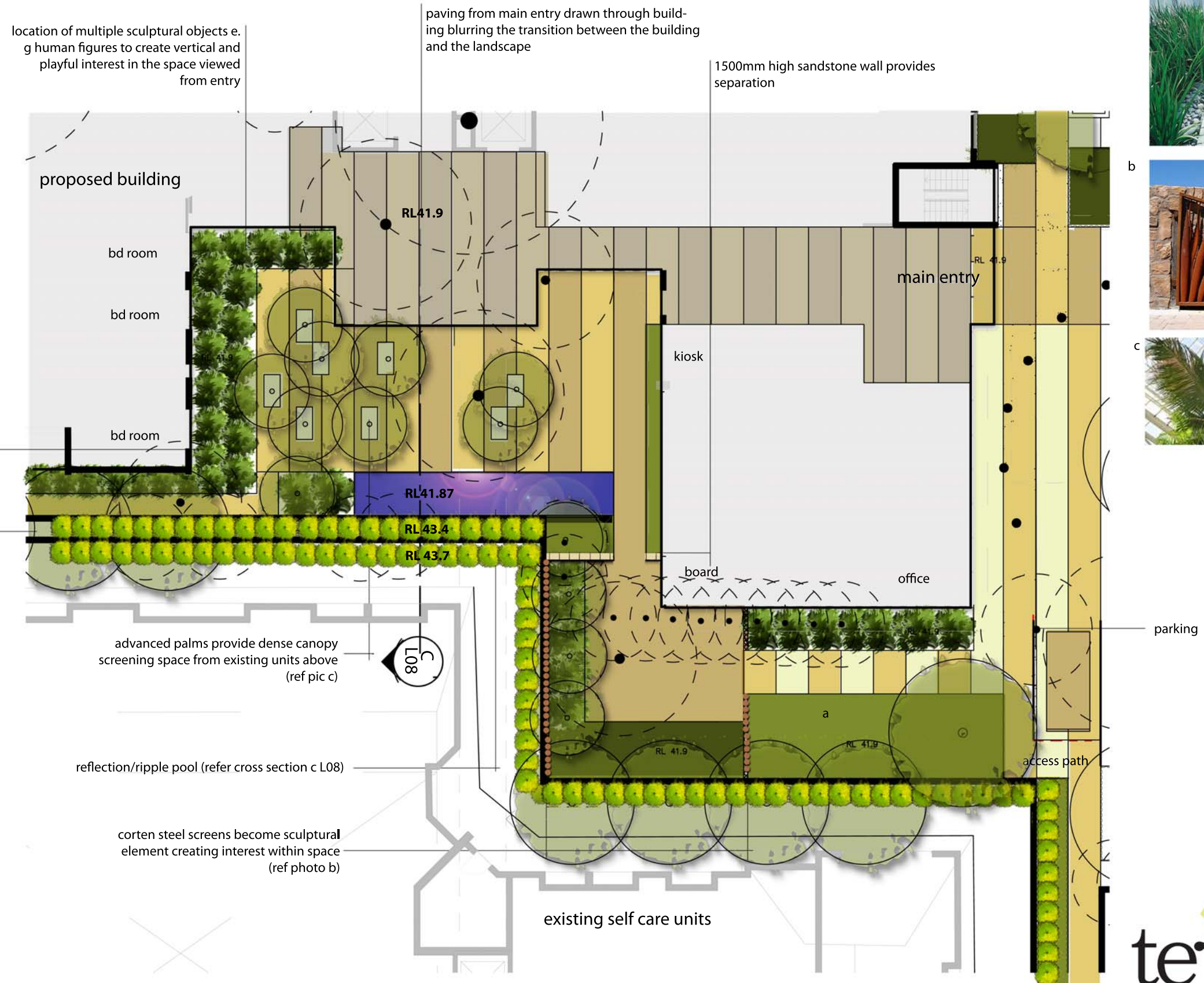

site details:
137 victoria street, ashfield
client:
aevum
date:
march 10
job number:
8190.5
scale:
1/100
rev. number:
g

terras
landscape architects

0 2.5m 10m 20m 30m @ A1

L07

march 10

master plan cardinal freeman village care precinct

cissold street



L08

march 10

sections a & b

cardinal freeman village care precinct

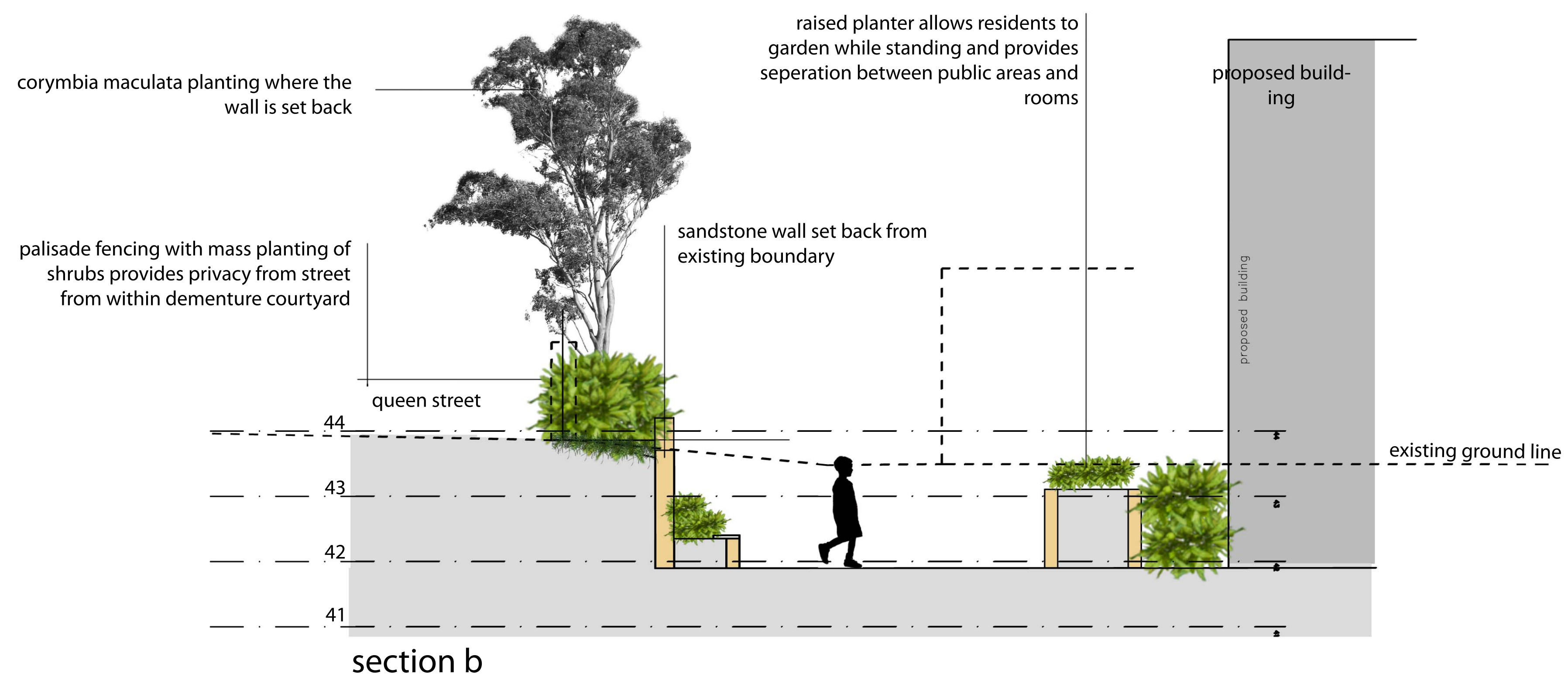
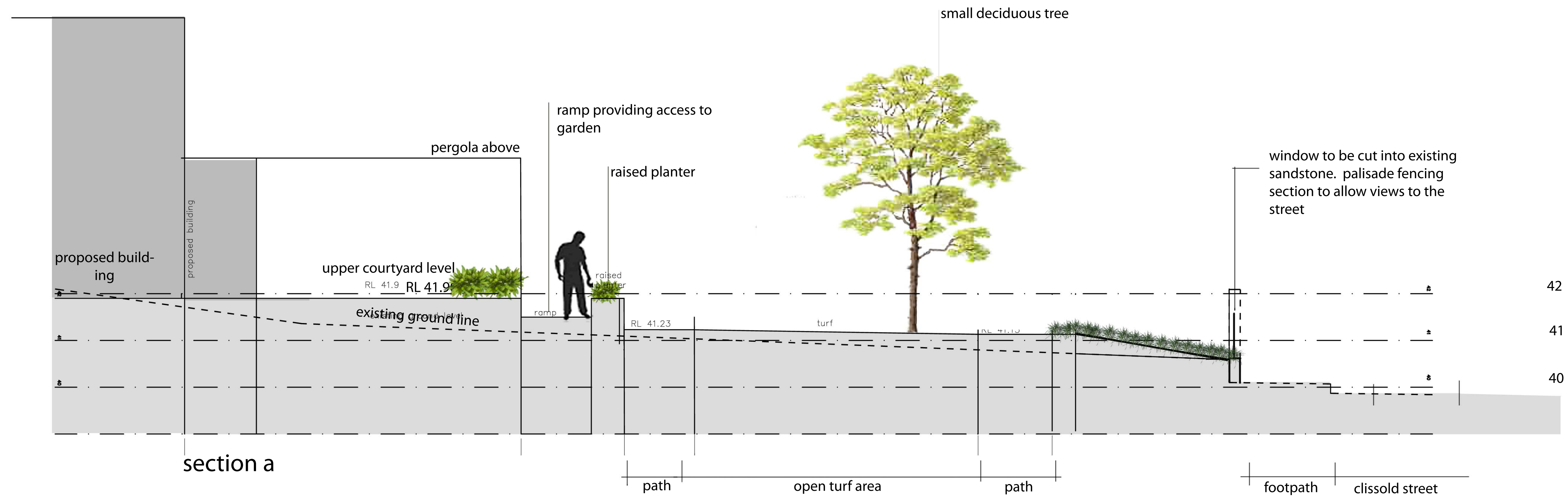
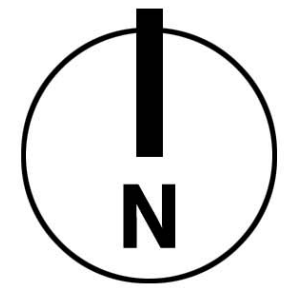

site details:
137 victoria street, ashfield
client:
aevum
date:
march 10
job number:
8190.5
scale:
1/50
rev. number:
g

L09

march 10

section c & plant sched.
cardinal freeman village care precinct

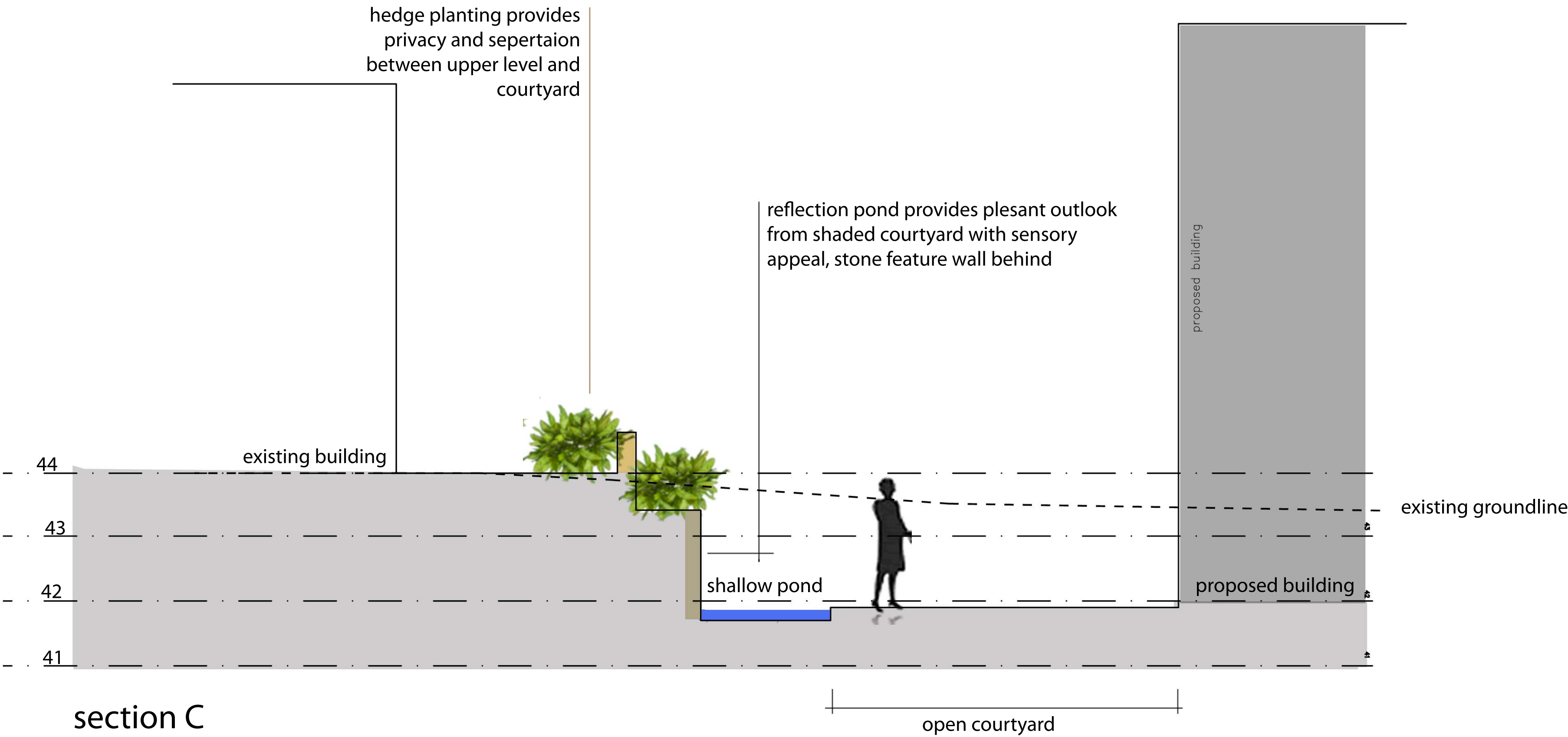

PLANT SCHEDULE

ABV	BOTANICAL NAME	COMMON NAME
FEATURE TREES AND PALMS		
Cm	<i>Corymbia maculata</i>	Spotted Gum
Hf	<i>Howea forsteriana</i>	Kentia palm
Wf	<i>Waterhousia floribunda</i>	Weeping lilly pilli
DECIDUOUS TREES		
Ap	<i>Acer palmatum</i>	Japanese Maple
Jm	<i>Jacaranda mimosifolia</i>	Jacaranda
Ms	<i>Magnolia soulangeana</i>	Magnolia
Pc	<i>Prunus cerasifera</i> "elfins"	Flowering plum
SHRUBS		
Ar	<i>Arthropodium cirratum</i>	Renga Renga Lilly
As	<i>Acmena smithii</i> "hedgemaster"	Lilly Pilly
Cv	<i>Callistemon viminalis</i>	Bottlebrush
Do	<i>Daphne odorata</i>	Daphne
Fw	<i>Fusha</i> "White Pixie"	
Gm	<i>Grevillea</i> "Misty Pink"	Grevillea
Hq	<i>Hydrangea quercifolia</i>	Hydrangea
Wj	<i>Westringea</i> "Jervis Bay"	Westringea
LOW GRASSES AND GROUNDCOVERS		
Ca	<i>Correa alba</i>	White correa
Cm	<i>Clivea miniata</i>	Kaffir lilly
Db	<i>Dianella</i> "Breeze"	
Ho	<i>Heleborus orientalis</i>	Winter rose
Vm	<i>Vinca major variegata</i>	Blue periwinkle
SENSORY PLANTING		
<i>Peas, tomatoes, mint, parsley, basil</i>		
Mf	<i>Michelia figo</i>	Port wine magnolia
Do	<i>Daphne odorata</i>	Daphne
Of	<i>Osmanthus fragrans</i>	
Ga	<i>Gardinea augusta</i> "Florida"	Gardinea
Th	<i>Trachelospermum jasminoides</i>	Jasmine
Ro	<i>Rosmarinus officinalis</i>	Rosemary
Mc	<i>Matricaria chamomilla</i>	Cammonmile
SHADE TOLLERANT PLANTING		
Am	<i>Acanthus mollis</i>	Oyster plant
Aa	<i>Asplenium australasicum</i>	Birds Nest Fern
Cm	<i>Clivea miniata</i>	Clivea
DI	<i>Dianella</i> "Little jess"	
Ho	<i>Heleborus orientalis</i>	Winter rose
Nd	<i>Nandina domestica</i>	Heavenly Bamboo
Px	<i>Philodendron xanadu</i>	Philodendron
Ss	<i>Stromanthe sanguinea</i>	Stronmanthe
Vh	<i>Viola hederacea</i>	Native violet
CLIMBER		
Wf	<i>Wisteria floribunda</i>	Japanese Wisteria

site details:
137 victoria street, ashfield
client:
aevum
date:
march 10
job number:
8190.5
scale:
1/50
rev. number:
e