



TRAFFIC ANALYSIS DIAGRAM, EXISITNG

- LEGEND**
- - - Major roads
 - - - Shared lane
 - - - Major pedestrian route
 - - - Bus route - Existing
 - Vehicular entry point
 - - - Minor roads
 - - - Cycle lane
 - - - Minor pedestrian route
 - - - Bus route - Proposed
 - Pedestrian entry point
 - ***** Blocked Road
 - Active Frontage
 - Future Signalled Intersection

0 25m 50m

NOMINATED ARCHITECT Henlia No 3 Pty Ltd SCALE 1:1000 @ A1 1:500 @ A3 PRINTED 03.05.10	F 3/5/10 kjd Roof plan updated E 17/11/09 kjd Concept Plan submission D 07/07/09 Stage 1 DA Issue C - - B - - A 08/12/08 KJD Issued for Information No. Date Appr Revision Notes
--	--

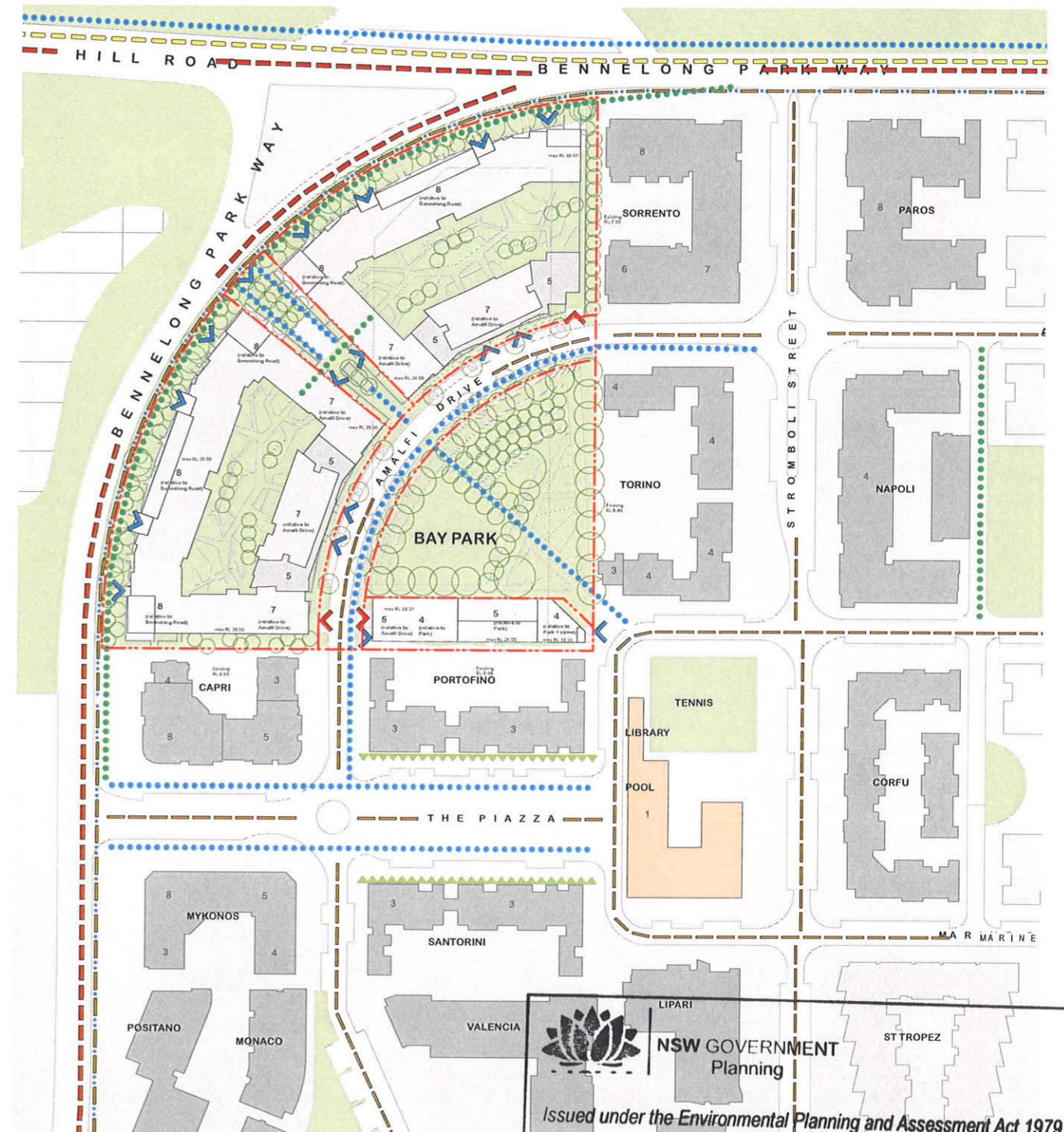

TRAFFIC ANALYSIS DIAGRAM, FUTURE

NSW GOVERNMENT Planning

Issued under the Environmental Planning and Assessment Act 1979

Approved Application No. MPO9-0160

granted on the 22/06/2010

Signed KS

Sheet No. 5 of 19

Job No. 08053	Rev F
Drawing No. DA11	Rev F

Bay Park
 23 Bennelong Parkway Wentworth Point NSW 2127
TURNER + ASSOCIATES
 L1 410 CROWN STREET SURRY HILLS NSW 2010 T 02 8668 0000 F 02 8668 0088

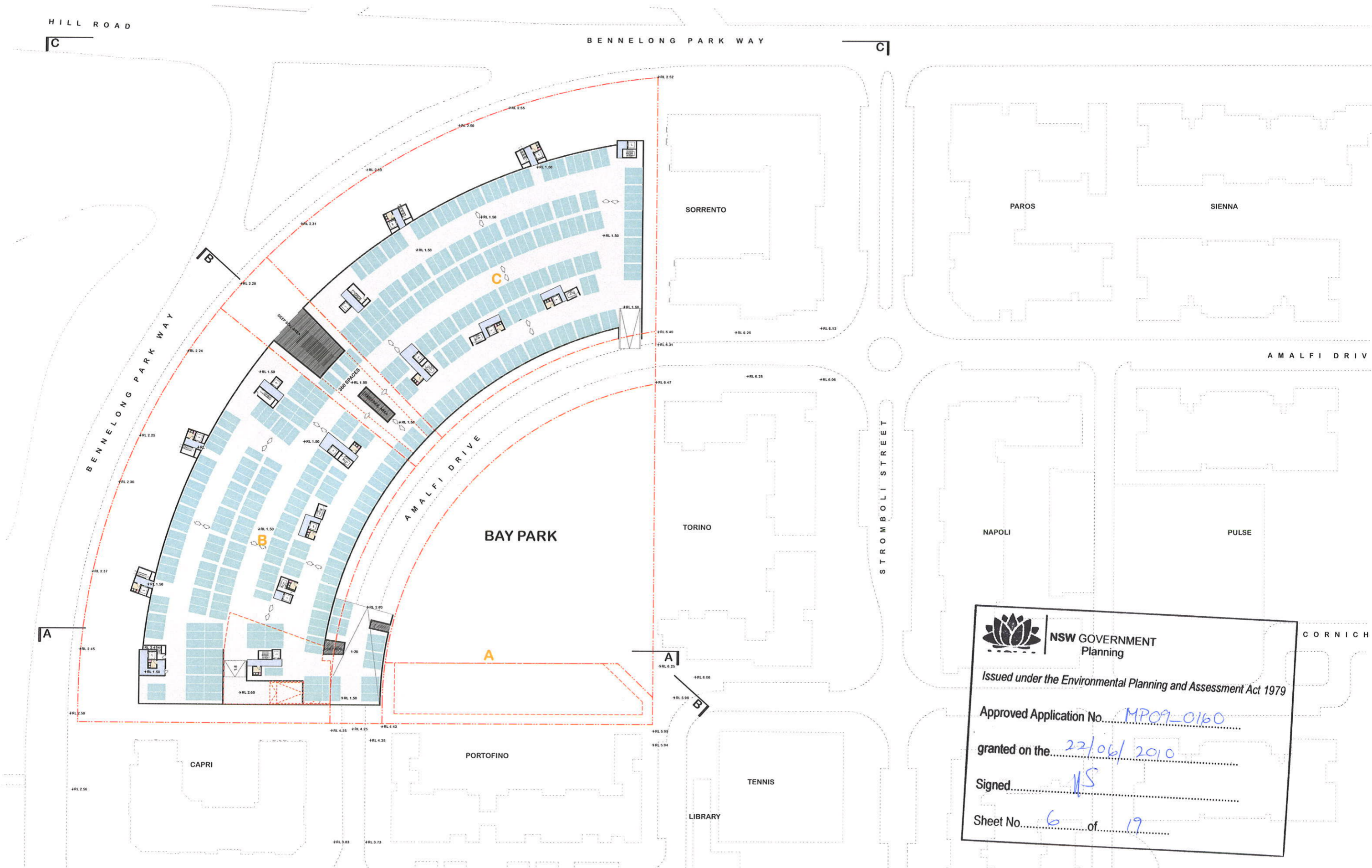



NSW GOVERNMENT
 Planning
 Issued under the Environmental Planning and Assessment Act 1979
 Approved Application No. MP09-0160
 granted on the 22/06/2010
 Signed MS
 Sheet No. 6 of 19

<small>NOVATED ARCHITECT</small> <small>David Quality Endorsed Company ISO 9001:2008 License Number 4198</small> <small>Drawn by: JLG</small> <small>Scale: 1:500 @ A1 1:1000 @ A3</small>	<small>Henlia No 3 Pty Ltd</small> <small>PRINTED 17/11/09</small>
---	---

<small>E 17/11/09 kjd Concept Plan submission</small> <small>D 07/07/09 Stage 1 DA Issue</small> <small>No. Date Appr Revision Notes</small>
--

<small>Job No. 08053</small> <small>Basement Plan</small>
--

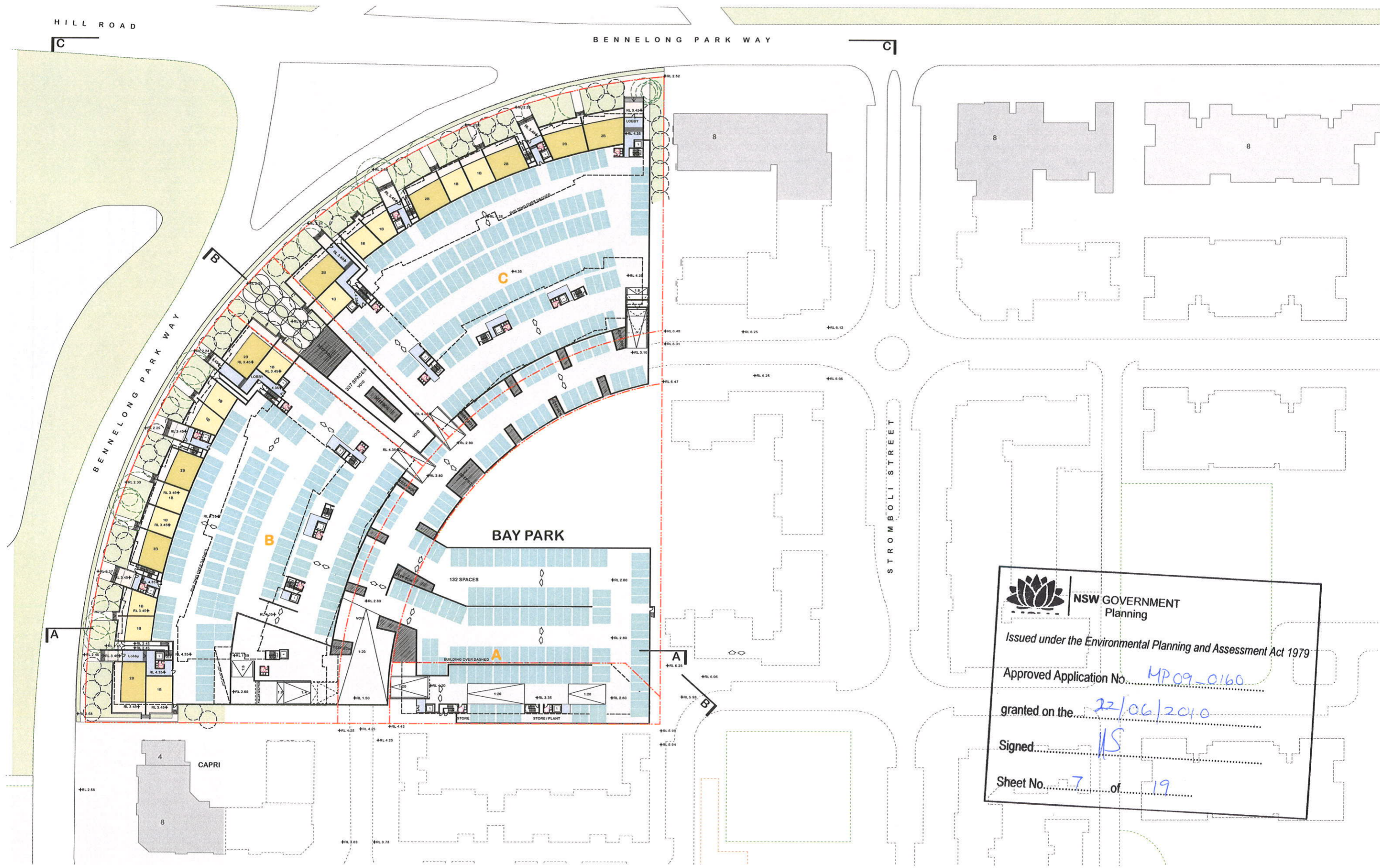
<small>23 Bennelong Parkway Wentworth Point NSW 2127</small> <small>Rev E</small> <small>TURNER+ASSOCIATES</small> <small>L1 410 CROWN STREET SURRY HILLS NSW 2010 T 02 8668 0000 F 02 8668 0088</small>	<small>Bay Park</small>
---	-------------------------



NSW GOVERNMENT
 Planning
 Issued under the Environmental Planning and Assessment Act 1979
 Approved Application No. MP09-0160
 granted on the 22/06/2010
 Signed JS
 Sheet No. 7 of 19

NOMINATED ARCHITECT Q30 Quality Endorsed Company ID# 901 2000 Licence Number 4118 Nishita Turner 6895 Drawn by JLG Scale: 1:250 @ A1 1:500 @ A3	PRINTED 17.11.09 Henlia No 3 Pty Ltd <small>This drawing is copyright and shall remain the property of Turner+Associates Architects. No reproduction without permission. Unless indicated otherwise this drawing is NOT FOR CONSTRUCTION. Do not scale from drawing. All dimensions shall take precedence.</small>
---	--

E 17/11/09 kjd Concept Plan submission D 07/07/09 Stage 1 DA Issue No. Date Appr Revision Notes

Job No. 08053
 Drawing No. DA 22
 Bay Park
 23 Bennelong Parkway Wentworth Point NSW 2127
TURNER+ASSOCIATES
 11 410 CROWN STREET SURRY HILLS NSW 2010 T 02 8668 0000 F 02 8668 0088

Job No. 08053 Drawing No. DA 22 Rev E	Bay Park 23 Bennelong Parkway Wentworth Point NSW 2127 TURNER+ASSOCIATES 11 410 CROWN STREET SURRY HILLS NSW 2010 T 02 8668 0000 F 02 8668 0088
---	---

Bennelong Road Level Plan