NSW GOVERNMENT
 Planning

Issued under the Environmental Planning and Assessment Act 1979

Approved Application No. MP09_0160

granted on the 22/06/2010

Signed KS

Sheet No. 8 of 19

HONORATED ARCHITECT Drawn By: JLG SCALE 1:500 @ A1 1:1000@ A3	Henlia No 3 Pty Ltd PRINTED 17.11.09	17/11/09 kjd Concept Plan submission D 07/07/09 Stage 1 DA Issue
---	---	---

No. Date Appr Revision Notes

Amalfi Drive Level Plan

Job No. 08053 Drawing No. DA 23	Bay Park 23 Bennelong Parkway Wentworth Point NSW 2127 TURNER+ASSOCIATES L1 410 CROWN STREET SURRY HILLS NSW 2010 T 02 8668 0000 F 02 8668 0088
------------------------------------	---

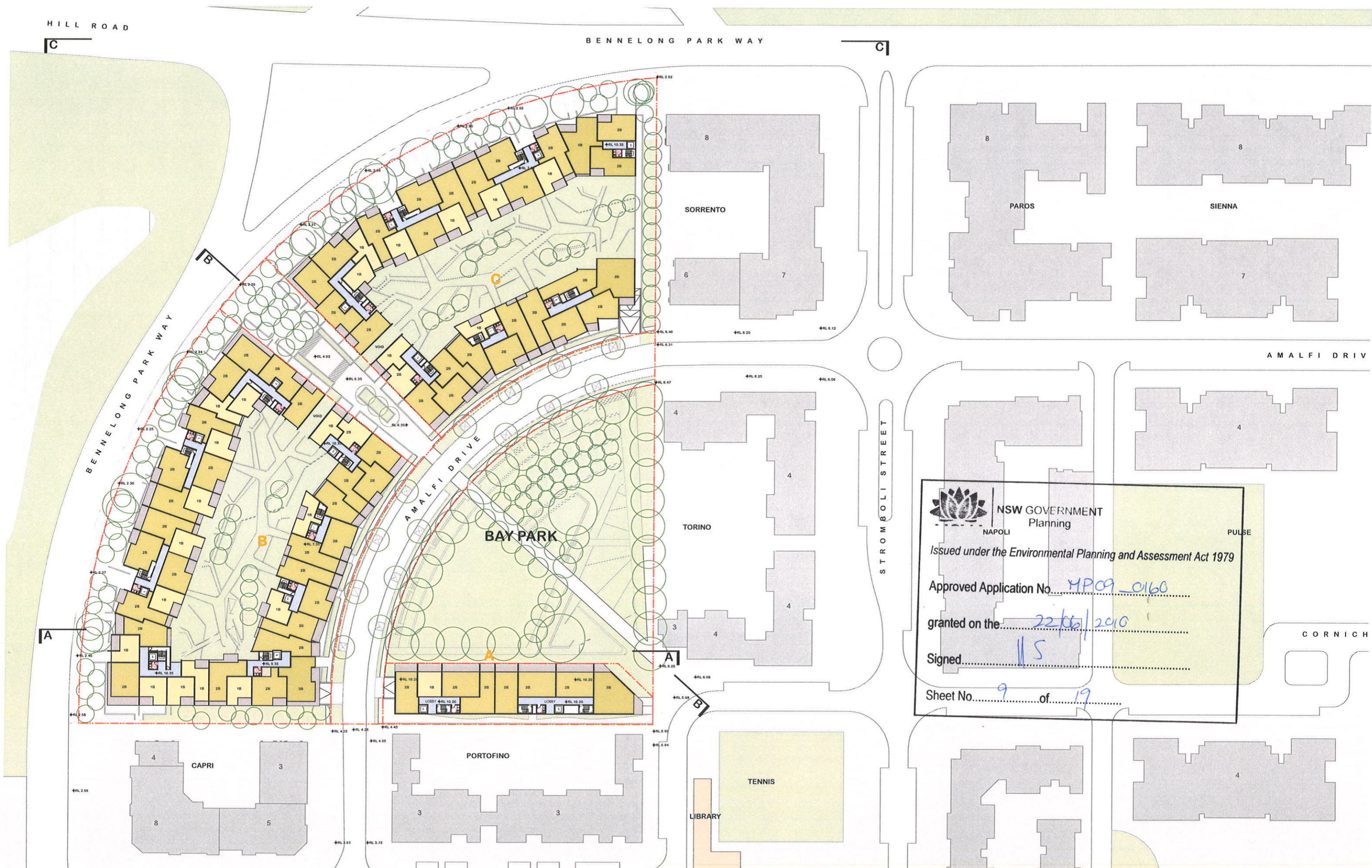

NSW GOVERNMENT
 Planning
 NAPOLI

Issued under the Environmental Planning and Assessment Act 1979
 Approved Application No. 4PC09_0160
 granted on the 22/06/2010
 Signed 115
 Sheet No. 9 of 19

NOMINATED ARCHITECT Drawn By: JLG SCALE 1:500 @ A1 1:10000 @ A3	Henlia No 3 Pty Ltd PRINTED 17/11/09 <small>This drawing is copyright and shall remain the property of Turner+Associates Architects. No reproduction without permission. Unless noted otherwise this drawing is NOT FOR CONSTRUCTION. Do not scale from drawings. If grid dimensions shall take precedence.</small>
---	---

E 17/11/09 kjd Concept Plan submission D 07/07/09 Stage 1 DA Issue No. Date Appr Revision Notes

Job No. 08053 Drawing No. DA 24 Level 1 Plan
--

Bay Park 23 Bennelong Parkway Wentworth Point NSW 2127 TURNER+ASSOCIATES <small>11410 CROWN STREET SURRY HILLS NSW 2010 T 02 8668 0000 F 02 8668 0088</small>	Rev E
---	-------