

**NSW GOVERNMENT**  
 Planning  
 NAPOLI PULSE  
 Issued under the Environmental Planning and Assessment Act 1979  
 Approved Application No. MP09\_0160  
 granted on the 22/06/2010  
 Signed V.S.  
 Sheet No. 10 of 19

<small>UNREGISTERED ARCHITECT</small> Drawn By: JLG SCALE 1:500 @ A1 1:1000@ A3		<small>REGISTERED ARCHITECT</small> Nicholas Turner 4695 DKPD Quality Endorsed Company ISO 9001:2008 Licence Number 4118 Cof. Fm. Name <b>Henlia No 3 Pty Ltd</b> PRINTED 13.11.09 <small>This drawing is copyright and shall remain the property of Turner+Associates Architects. No reproduction without permission. Unless noted otherwise this drawing is NOT FOR CONSTRUCTION. Do not scale from drawings. Ignore dimensions shall take precedence.</small>		E 17/11/09 kjd Concept Plan submission D 07/07/09 Stage 1 Da Issue No. Date Appr Revision Notes		Job No. 08053 Drawing No. DA25 Rev E		Bay Park 23 Bennelong Parkway Wentworth Point NSW 2127 <b>TURNER+ASSOCIATES</b> <small>11 410 CROWN STREET SURRY HILLS NSW 2010 T 02 8668 0000 F 02 8668 0088</small>	
---	--	--	--	---	--	--	--	--	--

Level 2+3 Plan

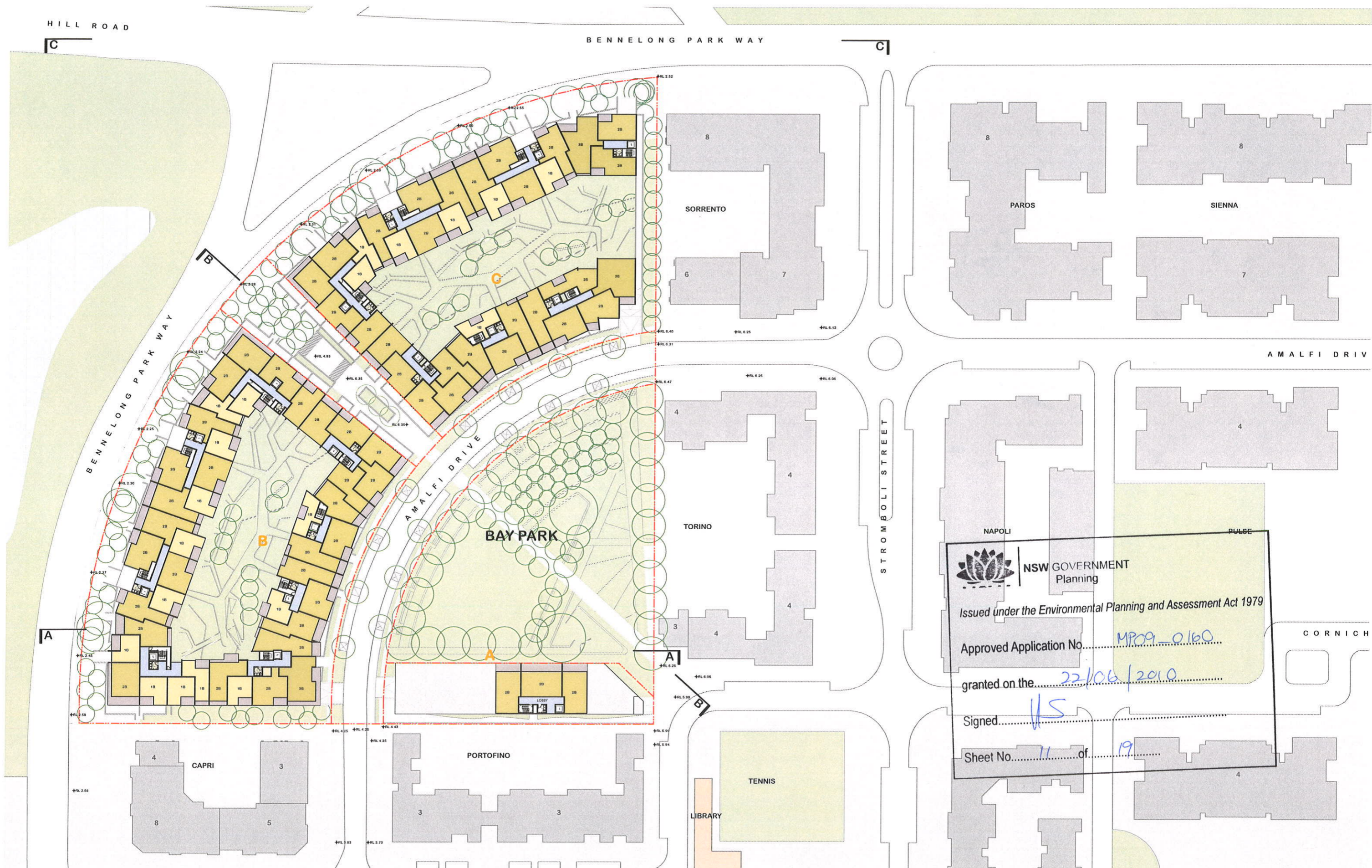

**NSW GOVERNMENT**  
 Planning  
 Issued under the Environmental Planning and Assessment Act 1979  
 Approved Application No. MPO9-0160  
 granted on the 22/06/2010  
 Signed JS  
 Sheet No. 11 of 19

<small>CONSULTANT ARCHITECT</small> <small>Drawn By:</small> JLG <small>SCALE</small> 1:500 @ A1 1:1000@ A3	<small>Henlia No 3 Pty Ltd</small> <small>PRINTED</small> 17.11.09 <small>This drawing is copyright and shall remain the property of Turner+Associates Architects. No reproduction without permission. Unless noted otherwise this drawing is NOT FOR CONSTRUCTION. Do not scale from drawings. Figure dimensions shall take precedence.</small>
---	--

<small>E</small> 17/11/09 kjd Concept Plan submission <small>D</small> 07/07/09 Stage 1 Da Issue <small>No.</small> <small>Date</small> <small>Appr</small> <small>Revision Notes</small>
---

<small>Job No.</small> 08053 <small>Drawing No.</small> DA 26 <small>Level 4 Plan</small>
---

<small>Bay Park</small> <small>23 Bennelong Parkway Homebush Bay NSW 2127</small> <small>Rev</small> E <small>TURNER+ASSOCIATES</small> <small>1 410 CROWN STREET SURRY HILLS NSW 2010 T 02 8668 0000 F 02 8668 0088</small>
--