

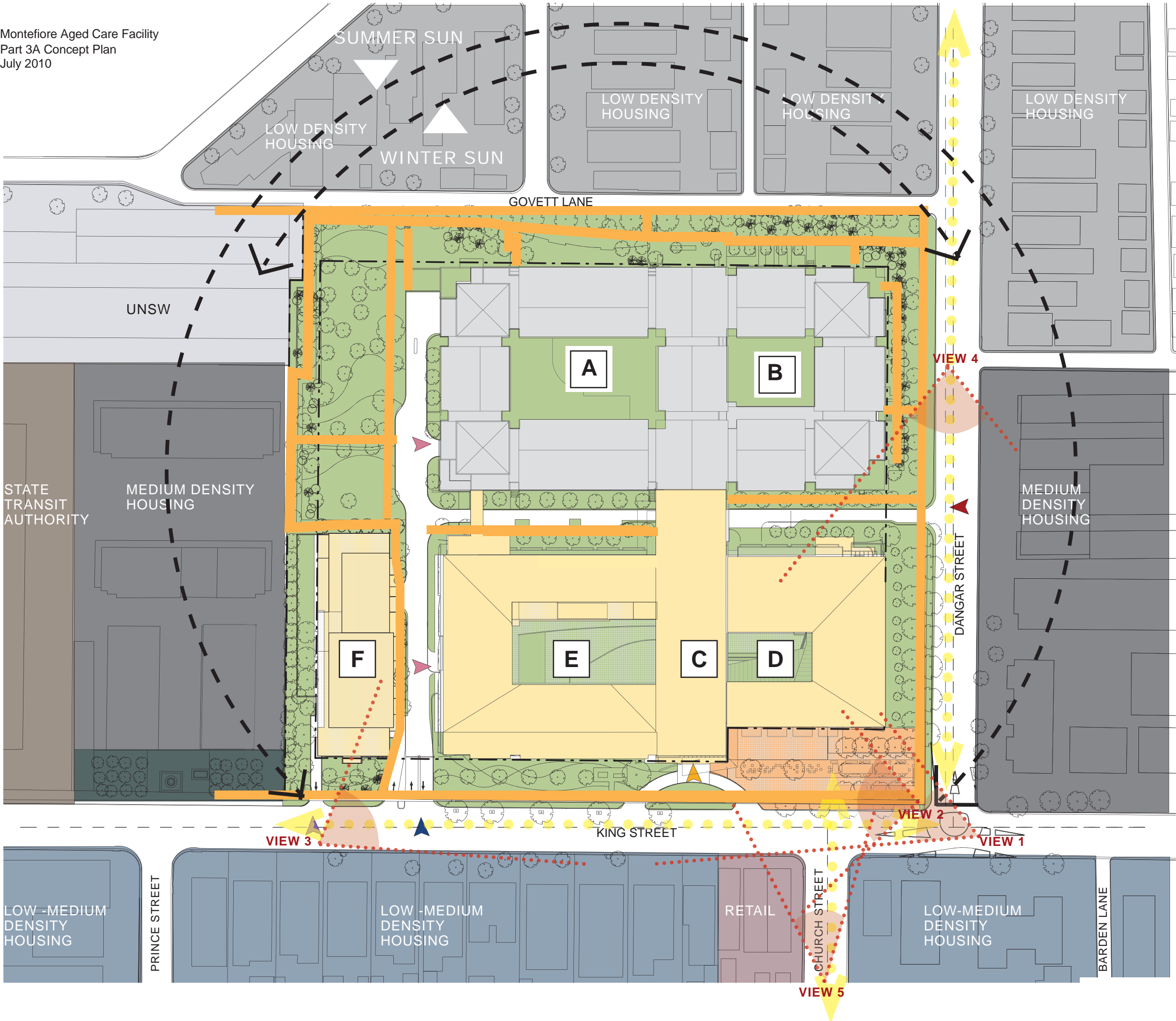

proposed

SECTION 3 PROPOSED





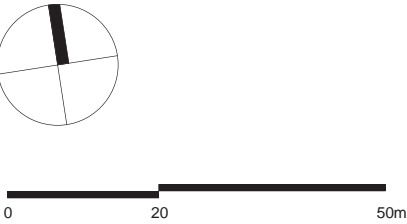

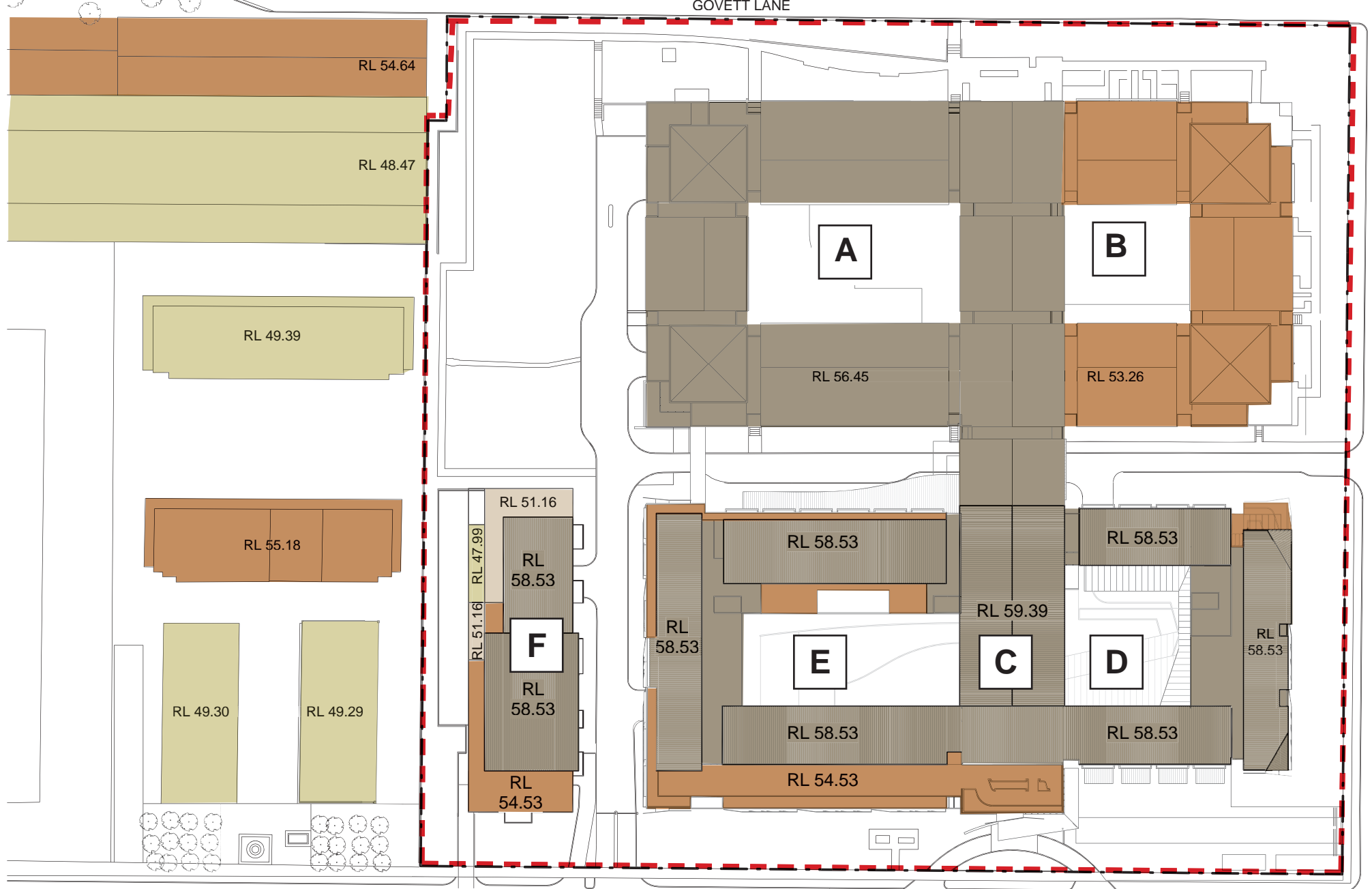

- Legend:**
- Existing Aged Care Facility
 - Proposed Aged Care Facility
 - Low Density Housing
 - Low-Medium Density Housing
 - Medium Density Housing
 - Private Open Space
 - Public Open Space
 - State Transit Authority
 - UNSW
 - Retail
 - Pedestrian Paths
 - Heritage Item
 - On-Street Cyclepath
 - Main Entrance
 - Service Entrance
 - Childcare Entrance
 - Loading dock / Car Park access (see also parking plan)
 - Day Care Entrance
 - Neighbourhood Roads
 - View Corridors
 - Buildings
 - VIEW 3
 - Selected existing and photomontage views.

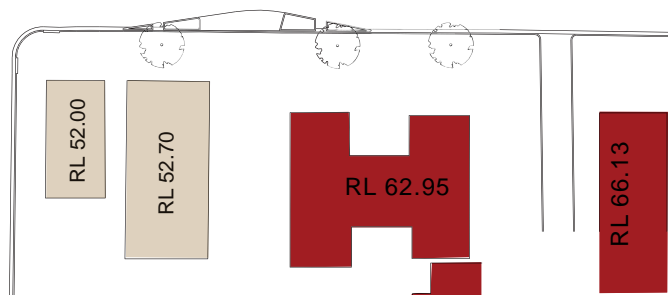



DANGAR STREET



-  RL 62-65
-  RL 59-62
-  RL 56-59
-  RL 53-56
-  RL 50-53
-  RL 47-50

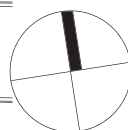
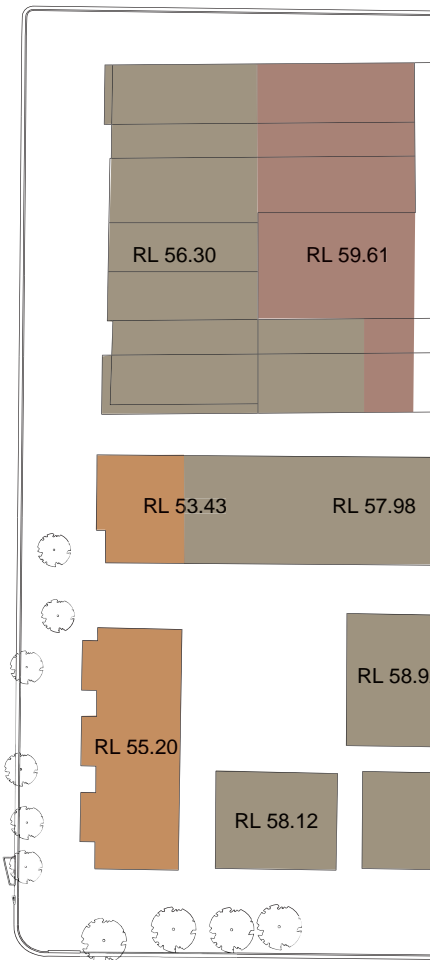

JACKSON TEECE
Nominated Architect Ian Brodie (4275)

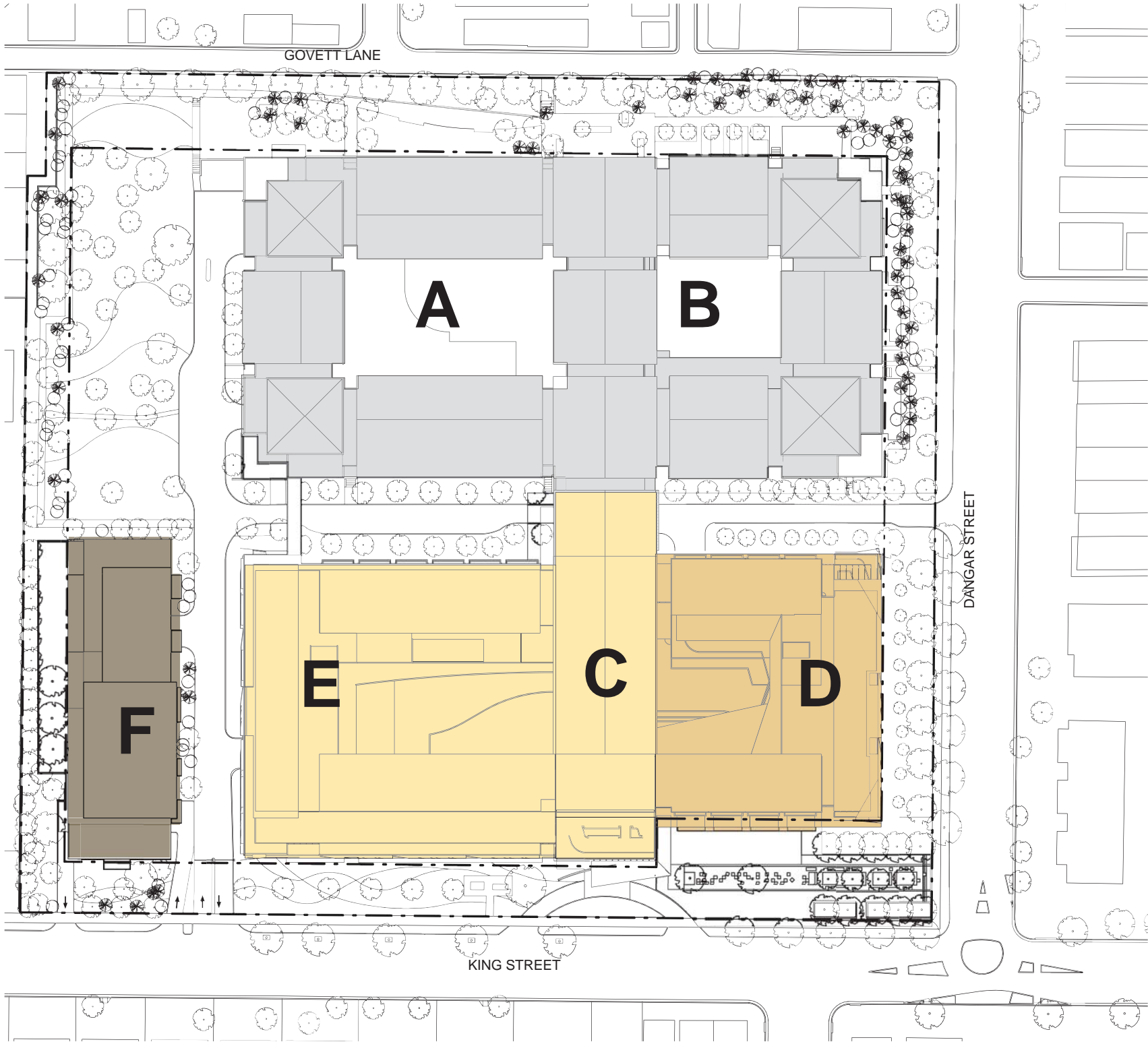

- Legend:**
- Stage 1
 - Stage 2
 - Stage 3
 - Existing Aged Care Facility

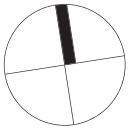

0 20 50m
Scale 1:1000 @ A3

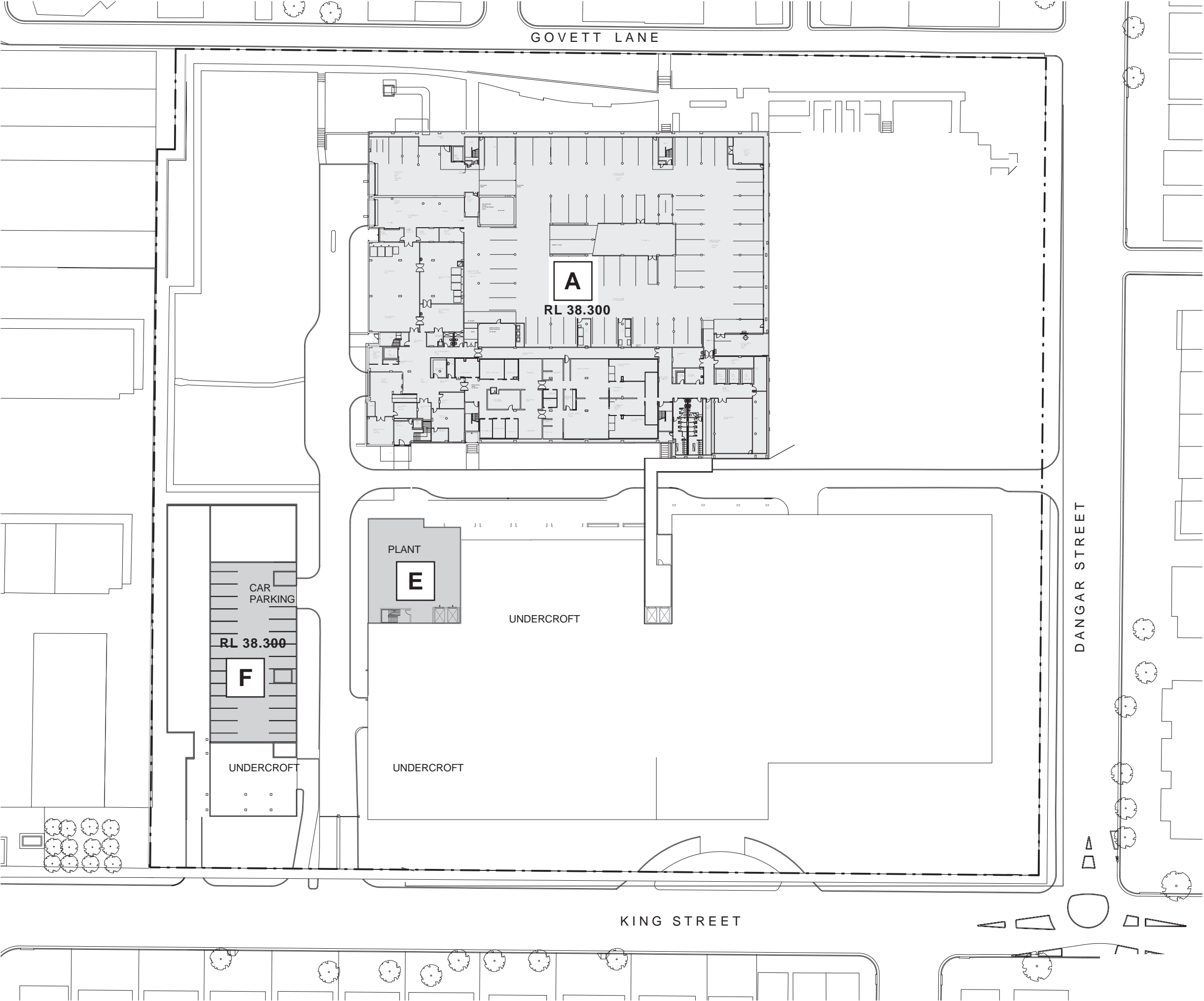

- Legend:**
- Residential Aged Care
 - Residential Health / Wellbeing
 - Adult Daycare / Childcare
 - Retail
 - Foyer / Administration
 - Self-Care Apartments
 - Existing Aged Care Facility
 - Carpark / Plantroom / Store
 - Public Open Space
 - Residential Aged Care Re-use of Existing Building
 - Residential Health / Wellbeing Re-use of Existing Building
 - Adult Daycare / Childcare Re-use of Existing Building



0 10 20 30 40m
Scale 1:750 @ A3