

EDMONDSON REGIONAL PARK
CONCEPT LANDSCAPE MASTER PLAN

appendix A: detailed plans

1. Zouch Road
2. Ingleburn Precinct
3. Ingleburn Precinct : buffers and filters
4. Maxwells Creek Precinct: buffers and filters
5. Maxwells Creek Precinct: buffers and filters
6. Campelltown Precinct

- I** CENTRE FOR OUT OF SCHOOL LEARNING SPACE 1 (Potential)
- II** CENTRE FOR OUT OF SCHOOL LEARNING 2 (potential)
Timber Platforms
Tree Planting
Walking Trails

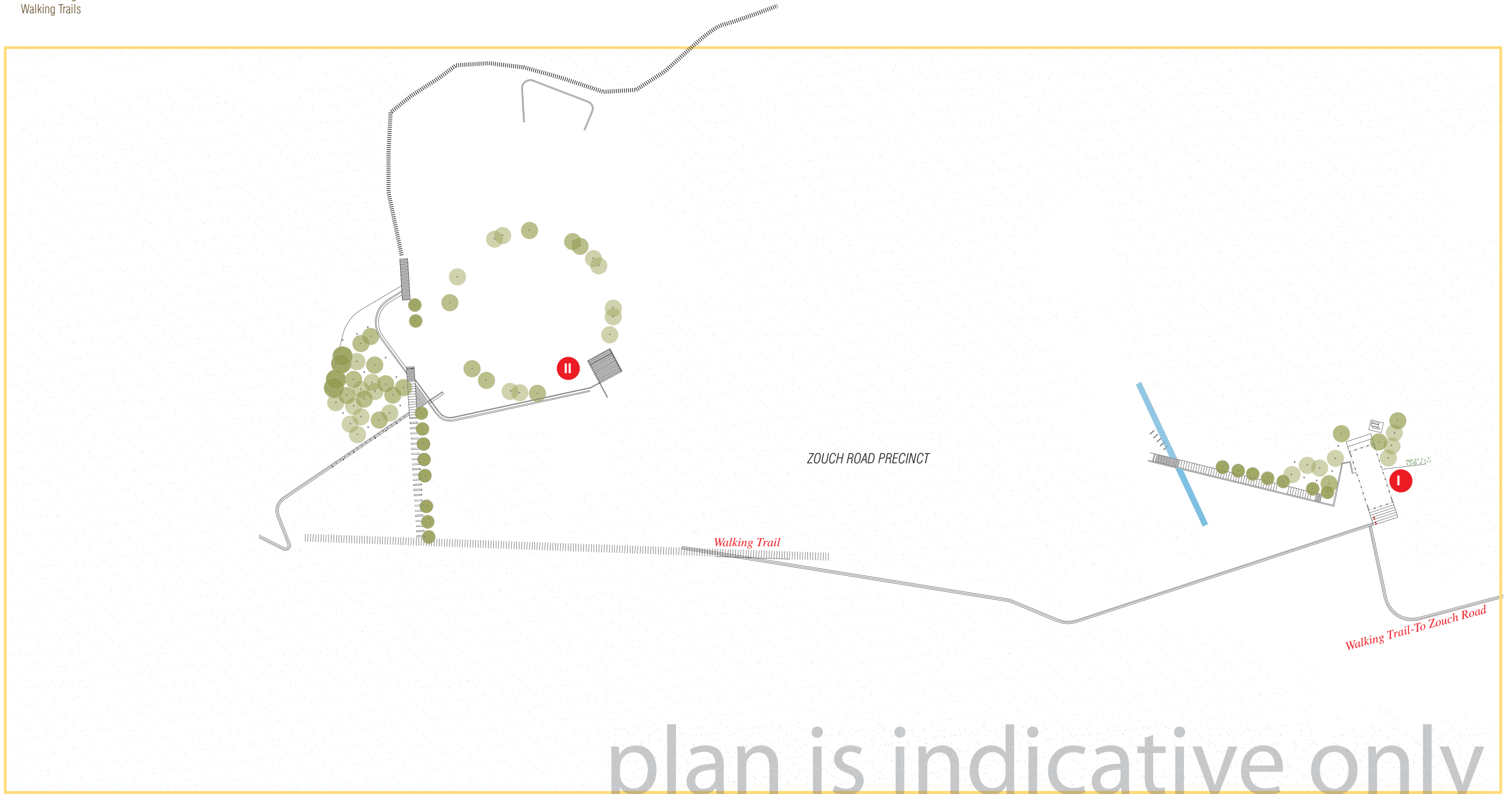

plan is indicative only

- I HILL MARKER
Wind Sculpture, Fire Tower
- II PLAYGROUND
- III PICNIC FACILITIES
Shade Structures
Picnic Tables
BBQ's

- IV PARK ROAD AND CARPARKING (100)
- V OVERFLOW CARPARKING (50)
Reinforced Turf
- VI PICNIC SPACES
- VII AMENITIES
- VIII ENTRY SIGNAGE

--- PRECINCT BOUNDARY

▭ CAP AND COVER AREA
(POTENTIAL RESTRICTIONS FOR BUILDINGS)

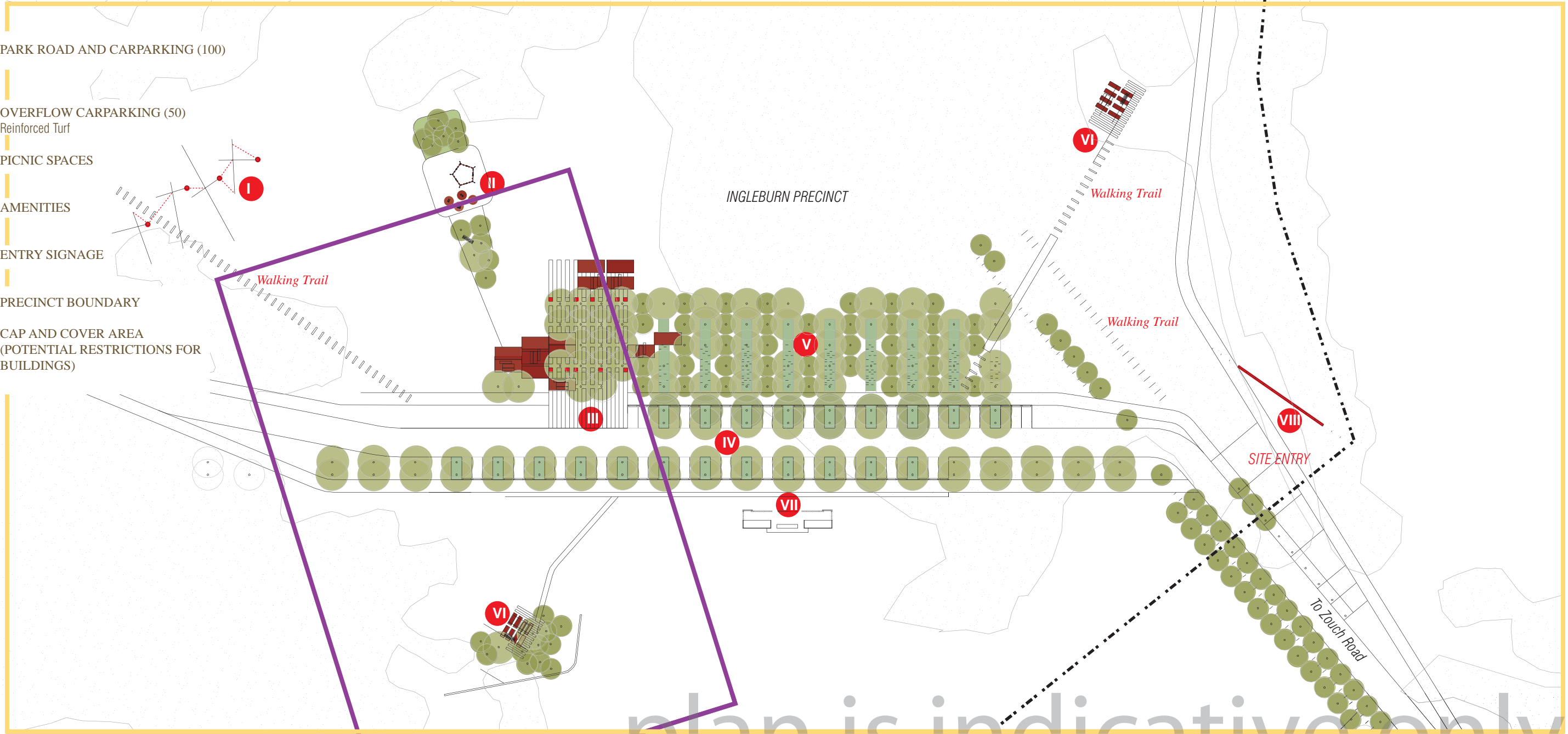

plan is indicative only



- I** COMMUNITY PURPOSE
Skate Park (Potential)
- II** PARK ENTRY
(Controlled Access)
Signage Elements
Green Trail Signage Elements
- III** NATIVE GARDENS
- IV** PICNIC FACILITIES
Shade Structure
Picnic Tables
BBQ's
Playground
- V** PERFORMANCE SPACE
- VI** CARPARK
(Controlled Access)
- VII** COMMUNITY HALL
Bushcare Office
DEC Office for park volunteers program
Backyard Buddies
Bio-Diversity for Kids
Sustainability Programs
Slide Shows
Interpretation Forecourt
- VIII** OUTDOOR LEARNING AREA:
Discovery for Kids Program
- PRECINCT BOUNDARY

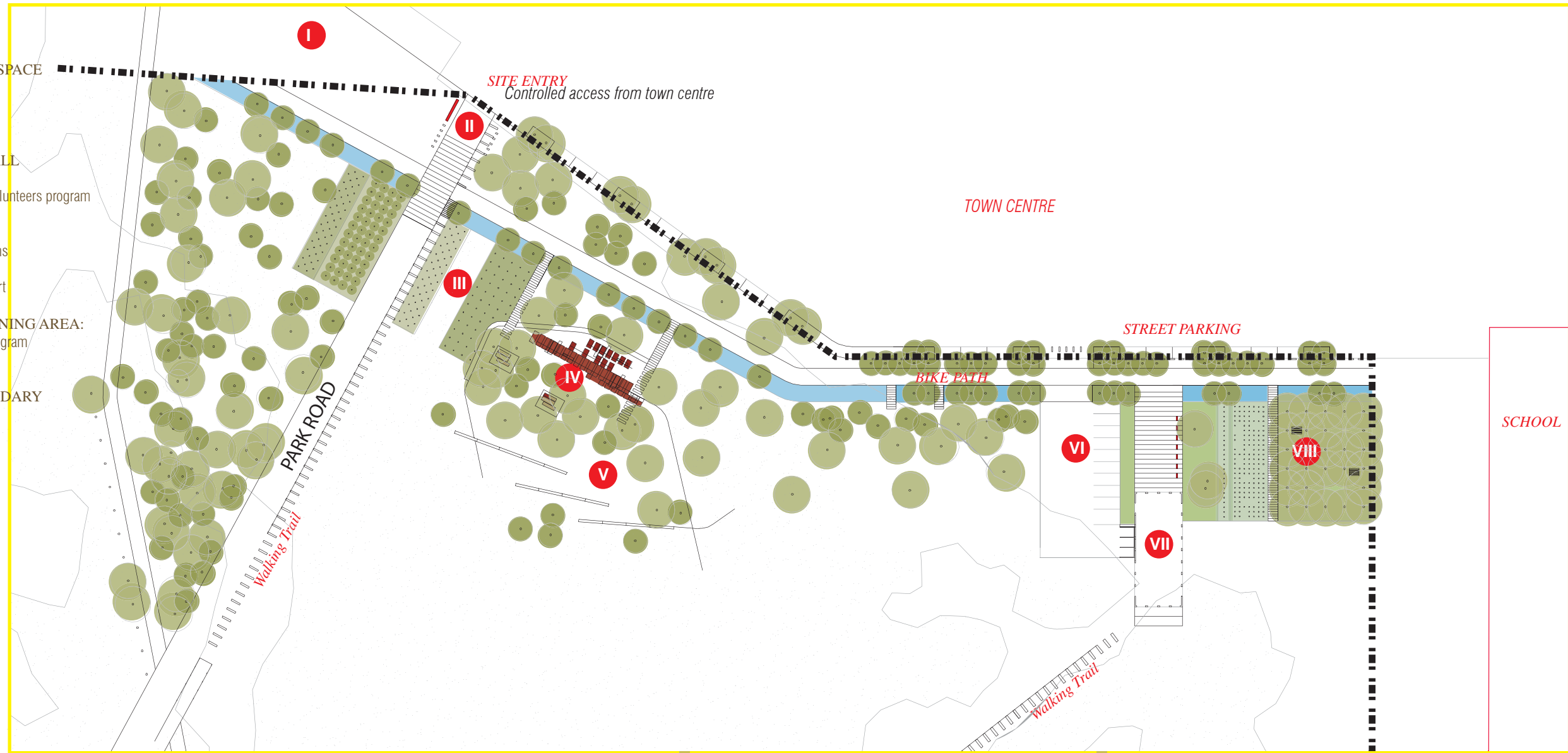

plan is indicative only



SCALE 1:1000 @ A3



- I** PICNIC FACILITIES
 - Shade Structure
 - Picnic Tables
 - BBQ's
 - Playground

- II** RAIN GARDENS

■■■■■ PRECINCT BOUNDARY

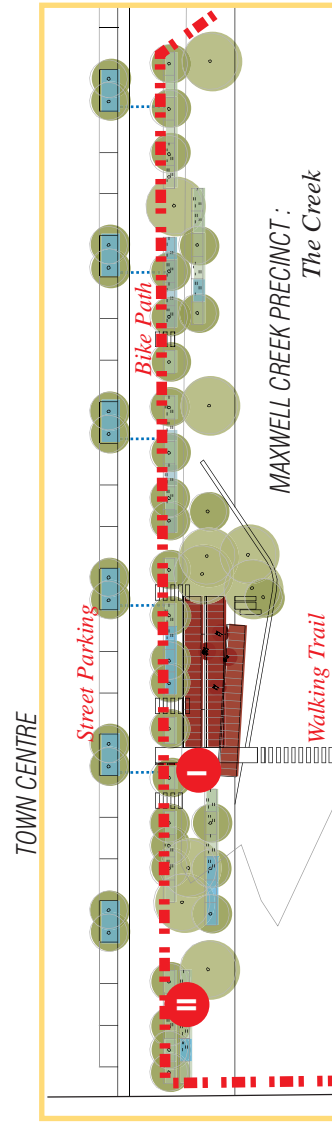

Asset Protection Zone

plan is indicative only

- I** DRIVE-IN PICNIC FACILITIES
Carparking
Picnic Tables
BBQ's
 - II** PARK ENTRY
Signage Elements
Green Trail Signage Elements
 - III** WATER TREATMENT POND (6a LAND)
Potential Community Amenity:
Reed Garden
Timber Boardwalk and Viewing Platforms
 - IV** PICNIC SPACE
Picnic Tables
- INDICATIVE PRECINCT BOUNDARY

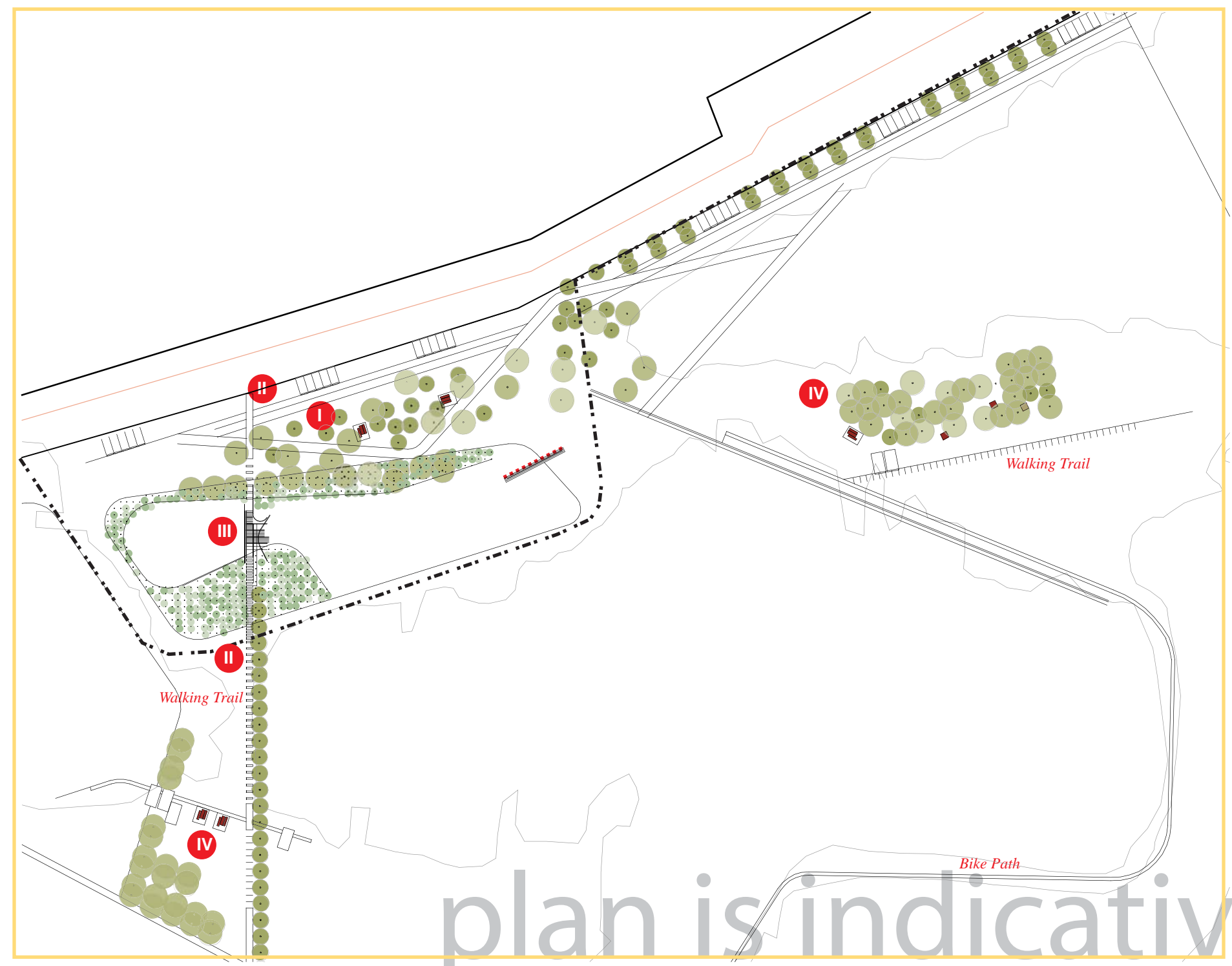

plan is indicative only

- I** PICNIC FACILITIES
 - Shade Structures
 - Picnic Tables
 - BBQ's
 - Tree Planting

- II** POTENTIAL FOR AMENITIES BUILDING

--- PRECINCT BOUNDARY

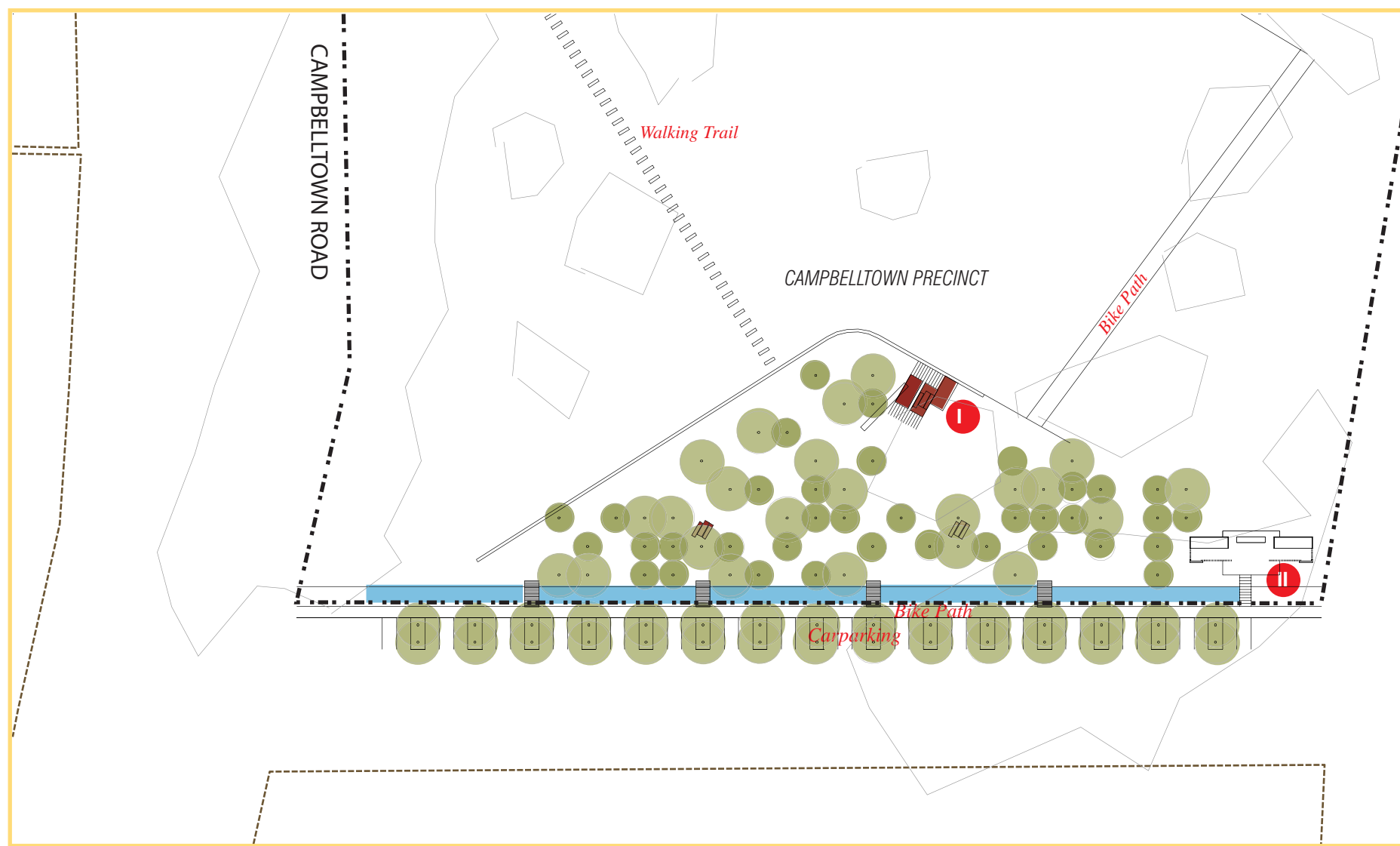

plan is indicative only

EDMONDSON REGIONAL PARK
CONCEPT LANDSCAPE MASTER PLAN

appendix B: relevant background studies

relevant background studies

Background Reports referred to in the development of this Concept Landscape Master Plan include the following:

- Edmondson Regional Park Draft Statement of Interim Management Intent (SIMI), Manidis Roberts February 2007
- Aboriginal Heritage Management Plan, AMBS, October 2003
- Centres and Retail Analysis, Patrick Partners, May 2003
- Edmondson Park Ecological Assessment, EcoLogical, August 2003
- Grassland Assessment Report, Wildthing, 2003
- Edmondson Park Infrastructure Planning, URS, October 2003
- Land Capability Assessment, Geotechnique, October 2003
- Non Indigenous Heritage Assessment, HLA October 2003
- Open Space and Recreation Plan, Cloustones, October 2003
- Community Planning Study: Social Infrastructure, Elton Consulting, October 2003
- Transport and Traffic Forecasting Study, Maunsell, October 2003
- Water Cycle Management: Stormwater, GHD, October 2003
- Campbelltown City Council Draft DCP, August 2005
- Edmondson Park Locality DCP Template, Liverpool City Council, August 2005
- Liverpool LEP 1997 and draft amendment No 83
- Liverpool Contributions Plan 2001
- LEP Zoning Boundaries Plan, March 2006
- Remediation Action Plan, Golder Associates, December 2005
- Ingleburn Defence Site, Heritage Analysis, Godden Mackay Logan, June 2001
- Ingleburn Lecture Hall, Draft Heritage Assessment and Use Options Study, September 2000
- Background Report, Civitas, August 2005
- Addendum to Background Report

EDMONDSON REGIONAL PARK

Statement of Interim Management Intent
draft financial model
February 2007

r



Prepared by

MANIDIS ROBERTS CONSULTANTS

Locked Bag 2740, Strawberry Hills 2012
Level 4, 23-33 Mary Street
Surry Hills NSW 2010 Australia

Tel (+612) 9281 5199
Fax (+612) 9281 9406

Email info@manidisroberts.com.au
Web www.manidisroberts.com.au

Quality Control

Our reference	05005
Version number	1.1
Date	22 February 2007



Table 1 Summary

	Year 1	Year 2	Year 3	Year 4	Year 5	Year 6	Year 7	Year 8 and thereafter
For example:	(\$'000s)	(\$'000s)	(\$'000s)	(\$'000s)	(\$'000s)	(\$'000s)	(\$'000s)	(\$'000s)
RECURRENT								
Expenditure (\$000)								
Direct recurrent expenditure on proposal	533	801	1163	1130	1138	1163	1156	1139
Plus flow on expenditure for other departments and authorities								
Less savings resulting from proposal								
Equals net expenditure on proposal	533	801	1163	1130	1138	1163	1156	1139
Less savings achieved as offset from other areas								
Equals net recurrent financial impact	533	801	1163	1130	1138	1163	1156	1139
REVENUE (\$000)	0	0	0	0	0	0	0	0
NET STAFFING (EFT)	3.0	3.5	5.5	4.5	4.5	4.5	4.5	4.5
ASSET ACQUISITIONS (\$000)								
Direct expenditure	454	2070	3847	2979	1840	759	391	178
Source of funds								
Asset sales								
Internal funds								

	Year 1	Year 2	Year 3	Year 4	Year 5	Year 6	Year 7	Year 8 and thereafter
Borrowings								
Other								
Flow on expenditure for other departments and authorities								

Table 2 Direct Recurrent Expenditure

Item	Year 1	Year 2	Year 3	Year 4	Year 5	Year 6	Year 7	Year 8 and thereafter
For example:	(\$'000s)	(\$'000s)	(\$'000s)	(\$'000s)	(\$'000s)	(\$'000s)	(\$'000s)	(\$'000s)
Salaries	191	217	332	267	250	250	250	250
Other employee expenses	38	38	38	38	6	6	6	6
Corporate overheads	57	64	92	76	63	63	63	63
Total employee related expenses	286	318	462	381	319	319	319	319
Other operating expenses	248	483	701	750	819	844	837	820
Total direct recurrent expenditure	533	801	1163	1130	1138	1163	1156	1139
Revenue	0	0	0	0	0	0	0	0

Table 3 Employee related expenses

Item	Year 1	Year 2	Year 3	Year 4	Year 5	Year 6	Year 7	Year 8 & thereafter
For example:	(\$'000s)	(\$'000s)	(\$'000s)	(\$'000s)	(\$'000s)	(\$'000s)	(\$'000s)	(\$'000s)
Salaries expense	191	217	332	267	267	267	267	267
Other employee expenses	37.5	37.5	37.5	37.5	37.5	37.5	37.5	37.5
Corporate overheads (25% of salaries and other employee expenses)	57.1	63.6	92.4	76.1	76.1	76.1	76.1	76.1

Table 4 Salaries expense

Classification	Grade	Status	Week ly hrs	Year 1		Year 2		Year 3		Year 4		Year 5		Year 6		Year 7		Year 8 and afterwards	
				\$'000	EFT	\$'000	EFT	\$'000	EFT	\$'000	EFT	\$'000	EFT	\$'000	EFT	\$'000	EFT	\$'000	EFT
For example:																			
Field Officer	1	Perma nent	38	50	1	50	1	50	1	50	1	50	1	50	1	50	1	50	1
Field Officer	1	Perma nent	38	0	0	0	0	50	1	50	1	50	1	50	1	50	1	50	1
Ranger	Gr1 Yr4	Perma nent	38	76	1	76	1	76	1	76	1	76	1	76	1	76	1	76	1
Planner / Field Officer	Gr1 Yr4	Perma nent	38	65	1	65	1	130	2	65	1	65	1	65	1	65	1	65	1
Admin		Part-time	17.5	0	0	26	0.5	26	0.5	26	0.5	26	0.5	26	0.5	26	0.5	26	0.5
Totals				191	3	217	3.5	332	5.5	267	4.5	267	4.5	267	4.5	267	4.5	267	4.5

Table 5 Other employees expenses

Classification	Grade	Status	Weekly hrs	Year 1	Year 2	Year 3	Year 4	Year 5	Year 6	Year 7	Year 8 and afterwards
For example:				(\$'000s)	(\$'000s)	(\$'000s)	(\$'000s)	(\$'000s)	(\$'000s)	(\$'000s)	(\$'000s)
Management (\$55/hr)											
Area/Regional Manager		Permanent	4	11.5	11.5	11.5	11.5	11.5	11.5	11.5	11.5
DEC Specialists (\$40/hr)											
Fire		Permanent	1	2	2	2	2	2	2	2	2
Biodiversity		Permanent	1	2	2	2	2	2	2	2	2
Strategic planning		Permanent	1	2	2	2	2	2	2	2	2
Neighbour relations		Permanent	1	2	2	2	2	2	2	2	2
Visitor services (\$30/hr)											
Visitor services officer		Temporary / casual	8	12.5	12.5	12.5	12.5	12.5	12.5	12.5	12.5
Support (\$15/hr)											
Clerical Officer	1	Permanent	7	5.5	5.5	5.5	5.5	5.5	5.5	5.5	5.5
Totals				37.5	37.5	37.5	37.5	37.5	37.5	37.5	37.5

Table 6 Other operating expenses

Item	Year 1	Year 2	Year 3	Year 4	Year 5	Year 6	Year 7	Year 8 and thereafter
For example:	(\$'000s)	(\$'000s)	(\$'000s)	(\$'000s)	(\$'000s)	(\$'000s)	(\$'000s)	(\$'000s)
Pest management	37	87	64	39	39	39	39	39
Fire management	40	26	29	27	27	39	39	39
Asset maintenance	23	125	311	445	514	527	520	503
Planning, reporting and monitoring	35	75	50	25	25	25	25	25
Land rehabilitation and restoration	0	20	50	30	30	30	30	30
Aboriginal cultural heritage management	2	7	12	7	7	7	7	7
Neighbour relations	8	10	11	7	7	7	7	7
Threatened species conservation	2	7	17	11	11	11	11	11
General operating expenses	101	126	157	159	159	159	159	159
Total	248	483	701	750	819	844	837	820

Table 7 Asset acquisitions (capital)

Project Details	Year 1	Year 2	Year 3	Year 4	Year 5	Year 6	Year 7	Year 8 and thereafter
For example:	(\$'000s)	(\$'000s)	(\$'000s)	(\$'000s)	(\$'000s)	(\$'000s)	(\$'000s)	(\$'000s)
Major Works (List of development works and plant and equipment with a total cost of greater than \$250,000)								
Entrances		50	350	100	50			
Fencing, bollards, vehicle barriers		20	150	50	50			
Landscaping	50	200	400	500	300	100	100	80
Irrigation	10	40	60	60	40	20	20	16
Toilets			200	100	100			
Sewer		250	200	100				
Service		50	50	50	20	10	10	8
Car parks	50	100	200	200	100	100	50	
Roads	50	200	500	200	200	200		
Tracks - cycle and pedestrian	80	150	150	200	100	50	20	
Construction of park management roads/fire trails, etc	50	50	80	100	50	20	20	16
Office building / depot	50	200	200	80	20			
Shelters		50	80	100	40	40		
Boundary definition – fences, etc		200	200	300	200			

Project Details	Year 1	Year 2	Year 3	Year 4	Year 5	Year 6	Year 7	Year 8 and thereafter
Visitor centre building	30	150	200	50	20	20		
Minor Works (List of development works and plant and equipment with a total cost of between \$5,000 and \$250,000)								
Works depot equipment		40	60	70	20	20	10	10
Picnic tables		10	20	50	40	20	10	10
Play equipment				100	100			
BBQ			100	100	100	50		
Truck			100					
Fire equipment	15	20	5		10		10	5
Signs	10	20	40	80	40	10	10	10
S/T	395	1800	3345	2590	1600	660	340	155
Contingency (15%)	59	270	502	389	240	99	51	23
Total	454	2070	3847	2979	1840	759	391	178
Cumulative asset value (5% depreciation p.a.)	454	2502	6223	8891	10286	10531	10395	10054

Table 8 Pest management

Item	Year 1	Year 2	Year 3	Year 4 and thereafter
For example:	(\$'000s)	(\$'000s)	(\$'000s)	(\$'000s)
Pest management planning	15	15		
Assessment of extent & type of pest species	10	0	2	2
Develop pest management strategies	10	50	50	25
Purchase minor equipment for pest control		20	10	10
Total	37	87	642	39

Table 9 Fire management

Item	Year 1	Year 2	Year 3	Year 4 and thereafter
For example:	(\$'000s)	(\$'000s)	(\$'000s)	(\$'000s)
Prepare fire management plan	10			
Hazard reduction	20	20	20	20
Maintenance of fire trails (\$25K/3 years)	5	5	5	5
Controlled burning (\$3K/3 years)			3	1
Purchase minor equipment for fire management	5	1	1	1
Total	40	26	29	27

Table 10 Asset maintenance

Item	Year 1	Year 2	Year 3	Year 4	Year 5	Year 6	Year 7	Year 8 and afterwards
For example:	(\$'000s)	(\$'000s)	(\$'000s)	(\$'000s)	(\$'000s)	(\$'000s)	(\$'000s)	(\$'000s)
Includes ongoing, routine expenses, for example:								
Road, trail and walking track repairs								
Boundary fence repairs								
Building repairs								
Bridge repairs								
Track closures								
Repairs to visitor infrastructure								
Repairs to signage								
Total	23	125	311	445	514	527	520	503

Table 11 Planning, reporting and monitoring

Item	Year 1	Year 2	Year 3	Year 4 and thereafter
For example:	(\$'000s)	(\$'000s)	(\$'000s)	(\$'000s)
Plans of management	10	40	20	5
Recreation and tourist strategies		20		
Monitoring and reporting on the conservation condition of visitor destinations	5	5	10	10
Development of public information strategies ie brochures and displays	20	10	20	10
Total	35	75	50	25

Table 12 Land restoration and rehabilitation

Item	Year 1	Year 2	Year 3	Year 4 and thereafter
For example:	(\$'000s)	(\$'000s)	(\$'000s)	(\$'000s)
Bush regeneration		20	30	15
Rehabilitation of tracks and trails			10	10
Control of soil erosion / sedimentation			10	5
Total		20	50	30

Table 13 Aboriginal cultural heritage management

Item	Year 1	Year 2	Year 3	Year 4 and thereafter
For example:	(\$'000s)	(\$'000s)	(\$'000s)	(\$'000s)
Community involvement	2	2	2	2
Management and conservation of on-park Aboriginal cultural heritage		5	10	5
Training service staff and members of the Aboriginal community				
Total	2	7	102	7

Table 14 Neighbour relations

Item	Year 1	Year 2	Year 3	Year 4 and thereafter
For example:	(\$'000s)	(\$'000s)	(\$'000s)	(\$'000s)
Identify neighbours	2	2		
Maintain and update GIS, neighbour maps and databases		1	1	1
Liaison with neighbours regarding cooperative land management strategies	1	2	5	1
Participation in community activities	5	5	5	5
Total	8	10	11	7

Table 15 Threatened species conservation

Item	Year 1	Year 2	Year 3	Year 4 and thereafter
For example:	(\$'000s)	(\$'000s)	(\$'000s)	(\$'000s)
Research and surveys		2	2	1
Implement recovery plans	2	5	10	5
Management of threatened species			5	5
Total	2	7	17	11

Table 16 General operating expenses

Item	Year 1	Year 2	Year 3	Year 4 and thereafter
For example:	(\$'000s)	(\$'000s)	(\$'000s)	(\$'000s)
Rent	50	50	50	50
Rates	10	10	10	10
Vehicle leasing costs	10	10	20	20
Vehicle running costs	5	10	10	10
Electricity / gas	2	2	3	5
Telephone	2	2	2	2
Purchase of minor office equipment	2	2	2	2
Security	20	40	60	60
Total	101	126	157	159

Table 17 Revenue

Item	Year 1	Year 2	Year 3	Year 4 and thereafter
For example:	(\$'000s)	(\$'000s)	(\$'000s)	(\$'000s)
Park entry fees	0	0	0	0
Total	0	0	0	0

Regional Park defines a reserved area of land in a natural or modified landscape that is suitable for public recreation and enjoyment in a sustainable manner. The NPW refer to a regional park near large population centres, these parks offer open space and recreational and cultural opportunities for urban residents. Their environments have often been largely altered since colonisation.

Park the land acquired for reservation under the *National Parks and Wildlife Act, 1974*.

Statement of Management Intent is a document, which sets out the planning context for proposed works within land reserved under the *National Parks and Wildlife Act, 1974* prior to the adoption of a Plan of management.

Plan of management means a plan of management as defined under Part 5 of the *National Parks and Wildlife Act, 1974*.

Advisory committee means an advisory committee constituted under the *National Parks and Wildlife Act, 1974*.

Regional advisory committee means an advisory committee constituted under section 24 (2) of the *National Parks and Wildlife Act, 1974*.

Development area means that part of the site area capable of having a building constructed on it exclusive of:

- Land where development is not permissible under the LEP.
- Land that is constrained by being flood and/or fire prone or subject to instability.

Place of Aboriginal heritage means:

- A place that has the physical remains of pre-European occupation by, or is of contemporary significance to the Aboriginal people. It can (but need not) include items and remnants of the occupation of the land by Aboriginal people such as burial places, engraving sites, rock art, midden deposits, scarred and sacred trees and sharpening grooves.
- A natural aboriginal sacred site or other sacred feature. It includes natural features such as creeks or mountains of long-standing cultural significance, as well as initiation, ceremonial or story places or areas of more contemporary cultural significance.

Public open space means land used, or intended for use, for recreational purposes by the public.

Council means either the Council of the City of Liverpool or the Council of the City of Campbelltown.

Cultural heritage encompasses past and present cultural associations of all people in Australia, including tradition knowledge and customs. It can be tangible (i.e. have physical manifestations such as art buildings etc.) or intangible (i.e. spiritual or social associations, songs, stories and cultural practices). Cultural significance includes values that are social, spiritual, aesthetic, historic and scientific. When natural resources acquire meaning for a particular group, they become cultural resources as well.

Pest species means a species occurring in an area outside its historically known natural range as a result of intentional or accidental dispersal by human activities.

APPENDIX B REFERENCES

Australian Museum Business Services (2003), *Edmondson Park Composite Site Master Plan: Aboriginal Heritage Management Plan*.

Campbelltown City Council (2004), *Draft Edmondson Park (Campbelltown) DCP*.

Campbelltown City Council (2005), Section 94 Contribution Plan.

Campbelltown City Council (2002), *Campbelltown (Urban Area) Local Environment Plan (Amendment No. 12)*.

Commonwealth Environmental Protection and Biodiversity Conservation Act, 1999.

Bushfire and Environmental Services Pty Ltd (2002), *Fire management plan Ingleburn Defence land*.

EcoLogical Australia (2003), *Edmondson Park Ecological Assessment: Summary Report*.

Golder Associates (2005), *Remediation Action Plan - Landcom Project No: 12619, Zouch Road, Edmondson Park, NSW*.

HLA Envirosiences (2003), *Non Aboriginal Heritage Assessment Edmondson Park*.

Liverpool City Council (2004), *Draft Edmondson Park (Liverpool) DCP No.53*.

Liverpool City Council (1997), *Liverpool Local Environment Plan (Amendment No. 83)*.

Liverpool City Council (2001) *Liverpool Contributions Plan*.

Department of Environment and Conservation (2005), *Recovering Bushland on the Cumberland Plain: Best Practice Guidelines for the Management and Restoration of Bushland*.

Department of Infrastructure, Planning and Natural Resources (2003), *Bringing the Bush back to Western Sydney*.

Department of Infrastructure, Planning and Natural Resources (2004), *Metropolitan Strategy and Planning Report for the Southwest Growth Centre: Structure Report*.

NSW Environmental Planning and Assessment Act, 1979.

NSW Heritage Act, 1977.

NSW Local Government Act, 1993.

NSW National Parks and Wildlife Act, 1974.

NSW Rural Fires Act, 1997.

NSW Rural Fire Service and planning NSW (2001), *Planning for Bushfire Protection: A Guide for Councils, Planners, Fire Authorities, Developers, and Home Owners*.

NSW State Environmental Planning Policy No. 19 – Bushland in Urban Areas (SEPP 19).

NSW State Environmental Planning Policy No. 44 – Koala Habitat Protection (SEPP 44).

NSW Threatened Species Conservation Act, 1995.

Wildthing (2003), *Grassland Assessment Report: Edmondson Park release area*.

SATISFYING THE OBJECTIVES FOR A 'REGIONAL PARK'

Table 13 Regional Park general objectives, and where they are addressed in this SIMI

Section 72AA of the <i>National Parks and Wildlife Act, 1974</i>	How this SIMI satisfies the objectives
(1) The following matters are to be taken into consideration in the preparation of a plan of management for land reserved under this Act:	
(a) The relevant management principles.	Refer Section 6.1 of this SIMI.
(b) The conservation of biodiversity, including the maintenance of habitat, ecosystems and populations of threatened species.	Identified in Part B and C of this SIMI.
(c) The protection and appreciation of objects, places and structures of cultural significance, and tracts of land.	Identified in Part B and C of this SIMI.
(d) The protection of landscape values and scenic features.	Identified in Part B and C of this SIMI.
(e) The protection of geological and geomorphological features.	Identified in Part B and C of this SIMI.
(f) The protection of wilderness values and the management of wilderness areas.	Not applicable.
(g) The maintenance of natural processes.	Identified in Part B and C of this SIMI.
(h) The rehabilitation of landscapes and the reinstatement of natural processes.	Identified in Part B and C of this SIMI.
(i) Fire management.	Identified in Part B and C of this SIMI.
(j) In the case of a plan of management for a national park, nature reserve or karst conservation reserve, the prohibition of the execution of any works adversely affecting the natural condition or special features of the park or reserve.	Not applicable.
(k) The potential for the reserved land to be used by Aboriginal people for cultural purposes.	Identified in Part B and C of this SIMI.
(l) The provision of opportunities for public understanding, enjoyment and appreciation of natural and cultural heritage values, including opportunities for sustainable visitor use.	Identified in Part B and C of this SIMI.
(m) The adaptive reuse of buildings, and structures.	Refer to Section 7 of this SIMI.

Section 72AA of the <i>National Parks and Wildlife Act, 1974</i>	How this SIMI satisfies the objectives
(n) The appropriate (including culturally appropriate). and ecologically sustainable use of the reserved land, including use by lessees, licensees and occupiers of the land.	Identified in Part B and C of this SIMI.
(o) The preservation of catchment values.	Identified in Part B and C of this SIMI.
(p) The encouragement of appropriate research into natural and cultural features and processes, including threatening processes.	Identified in Part B and C of this SIMI.
(q) The identification and mitigation of threatening processes.	Identified in Part B and C of this SIMI.
(r) The statutory natural resource management, land use management plans and land management practices of land surrounding or within a region of the reserved land.	Refer to Section 5 of this SIMI.
(s) The regional, national and international context of the reserved land, the maintenance of any national and international significance of the reserved land and compliance with relevant national and international agreements, including the protection of world heritage values and the management of world heritage properties.	Identified in Part B and C of this SIMI.
(t) Benefits to local communities.	Identified in Part B and C of this SIMI.
u) The social and economic context of the reserve so as to ensure, for example, that the provision of visitor facilities is appropriate to the surrounding area or that pest species management programs are coordinated across different tenures.	Identified in Part B and C of this SIMI.
(v) The protection and management of wild rivers.	Not applicable.
(w) The impact of the management and the use of land acquired under Part 11 on the reserved land's management.	Not applicable.
(2) A plan of management must include the means by which the responsible authority proposes to achieve the plan's objectives and performance measures.	Identified in Part B and C of this SIMI.
(3) The matters referred to in subsection (1) (b)–(s) are to be taken into account, where appropriate, in the preparation of a plan of management for a wildlife refuge, wildlife management area or conservation area.	Not applicable.
(4) A plan of management is to contain a written scheme of operations, which it is proposed to undertake in relation to the land that is the subject of the plan of management.	Identified in Part C of this SIMI.
(5) The written scheme of operations for a plan of management must:	Identified in Part C of this SIMI.

Section 72AA of the <i>National Parks and Wildlife Act, 1974</i>	How this SIMI satisfies the objectives
(a) If the plan is for land within a conservation area, relate to the carrying out of operations for the purpose and objects of the conservation agreement, and	Identified in Part C of this SIMI.
(b) If the plan is for land within a State forest, be consistent with the purpose and objects of this Act and the <i>Forestry Act, 1916</i> .	Not applicable.
(6) Without limiting subsection (1), a plan of management may do any one or more of the following:	
(a) In relation to land within a national park, historic site, regional park, state conservation area or karst conservation reserve: <ul style="list-style-type: none"> i. Identify any part of the land, and any building or structure on the land, and any modified natural area on the land, that may be the subject of a lease or licence as referred to in section 151B(5). ii. Specify the purposes for which such leases, and licences may be granted. 	Not applicable.
(b) In relation to land within a state conservation area, specify any activity proposed to be permitted in any part of the area and the nature of any development proposed to be carried out to encourage the use of that part for the activity so specified,	Not applicable.
(c) In relation to land reserved under Part 4A, provide for the use of the land for any community development purpose prescribed by the regulations.	Identified in Part B and C of this SIMI.
(7) A plan of management for a national park, historic site, nature reserve or karst conservation reserve may relate to land acquired or occupied, or proposed to be acquired or occupied, under Part 11.	Not applicable.