

Note:  
Areas are approximate only.

rev:	date:	amendment:
A	10.02.10	ISSUED FOR PART 3A SUBMISSION
B	01.09.10	ISSUED FOR PART RE-ZONING APPLICATION

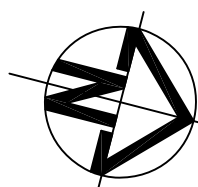

project:  
**FORMER HOXTON PARK AIRPORT  
REDEVELOPMENT**

Copyright of the design and other information shown here is owned by Mirvac Design Pty. Ltd. Reproduction or use of  
the design by any party for any purpose is expressly forbidden without the written permission of Mirvac Design Pty. Ltd.

architect:  
**Mirvac  
Design**  
architects  
planners  
interior designers

Level 26, 60 Margaret St.  
Sydney, NSW, 2000  
tel. 02 9080 8000  
fax. 02 9080 8181  
Mirvac Design Pty. Ltd.  
ABN 78 003 358 153



title:  
**FORMER HOXTON PARK AIRPORT  
REDEVELOPMENT  
EXISTING ZONING OVERLAY**

drawn: TM  
approved: TM  
job no: 7172

date: 17/11/09

scale @ A1: 1:4000

drawing no: **MP-1005**

rev: **B**

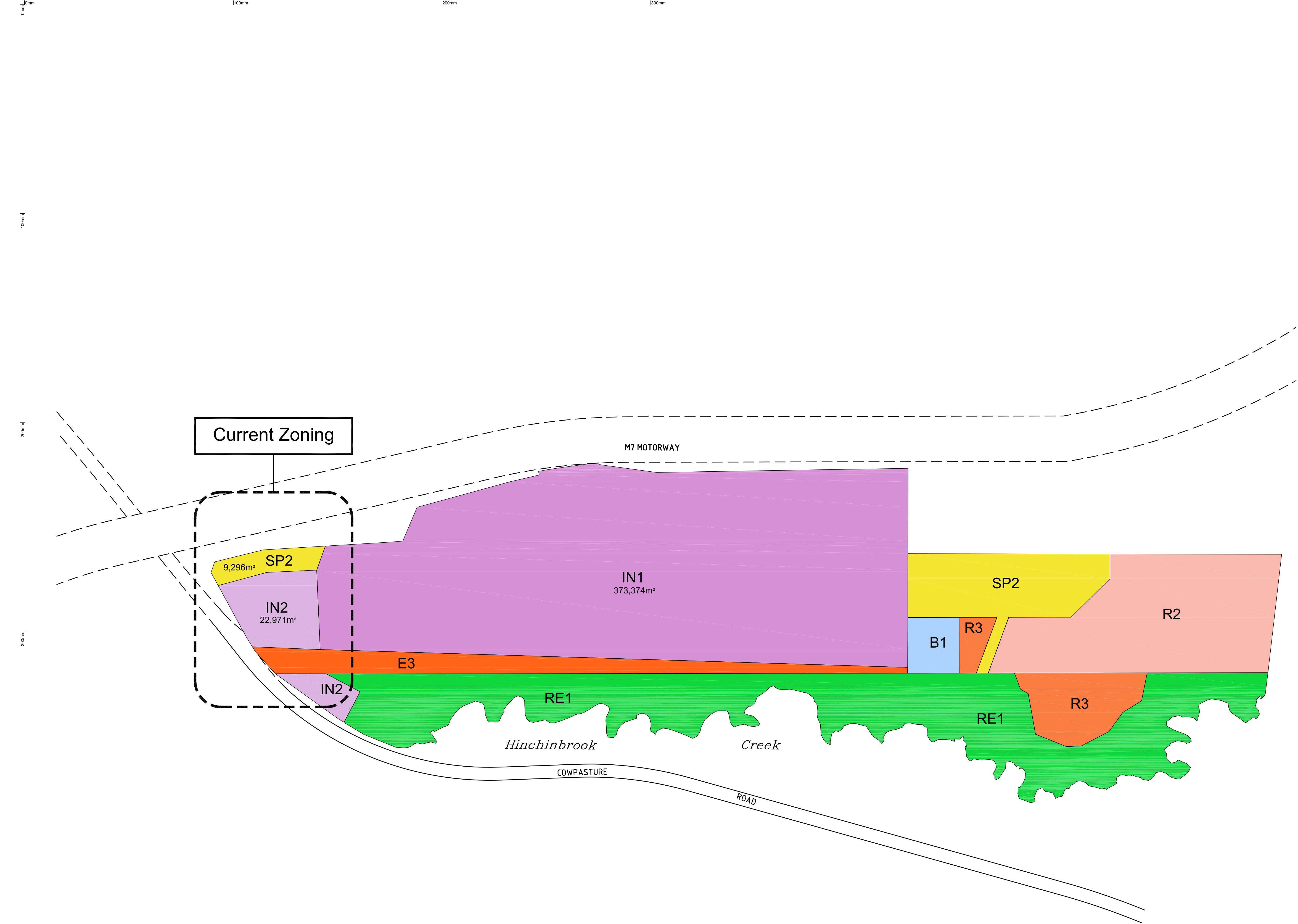

## Legend

- |     |                            |
|-----|----------------------------|
| B1  | Neighbourhood Centre       |
| E3  | Environmental Management   |
| IN1 | General Industrial         |
| IN2 | Light Industrial           |
| R2  | Low Density Residential    |
| R3  | Medium Density Residential |
| SP2 | Infrastructure (drainage)  |
| RE1 | Public Recreation          |

Note:  
Areas are approximate only.

rev:	date:	amendment:
A	10.02.10	ISSUED FOR PART 3A SUBMISSION
B	02.07.10	ISSUED FOR REZONING
C	24.08.10	ISSUED FOR REZONING

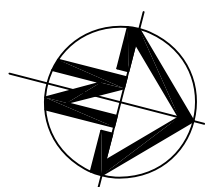

project:  
**FORMER HOXTON PARK AIRPORT  
REDEVELOPMENT**

Copyright of the design and other information shown here is owned by Mirvac Design Pty. Ltd. Reproduction or use of the design by any party for any purpose is expressly forbidden without the written permission of Mirvac Design Pty. Ltd.

architect:  
**Mirvac  
Design**  
architects  
planners  
interior designers

Level 26, 60 Margaret St.  
Sydney, NSW, 2000  
tel. 02 9080 8000  
fax. 02 9080 8181  
Mirvac Design Pty. Ltd.  
ABN 78 003 358 153



title:  
**FORMER HOXTON PARK AIRPORT  
REDEVELOPMENT  
PROPOSED ZONING**

drawn: TM  
approved: TM  
  
job no: 7172

date: 17/11/09

scale @ A1: 1:4000

lot no:

drawing no: **MP-1006**

rev:

**C**

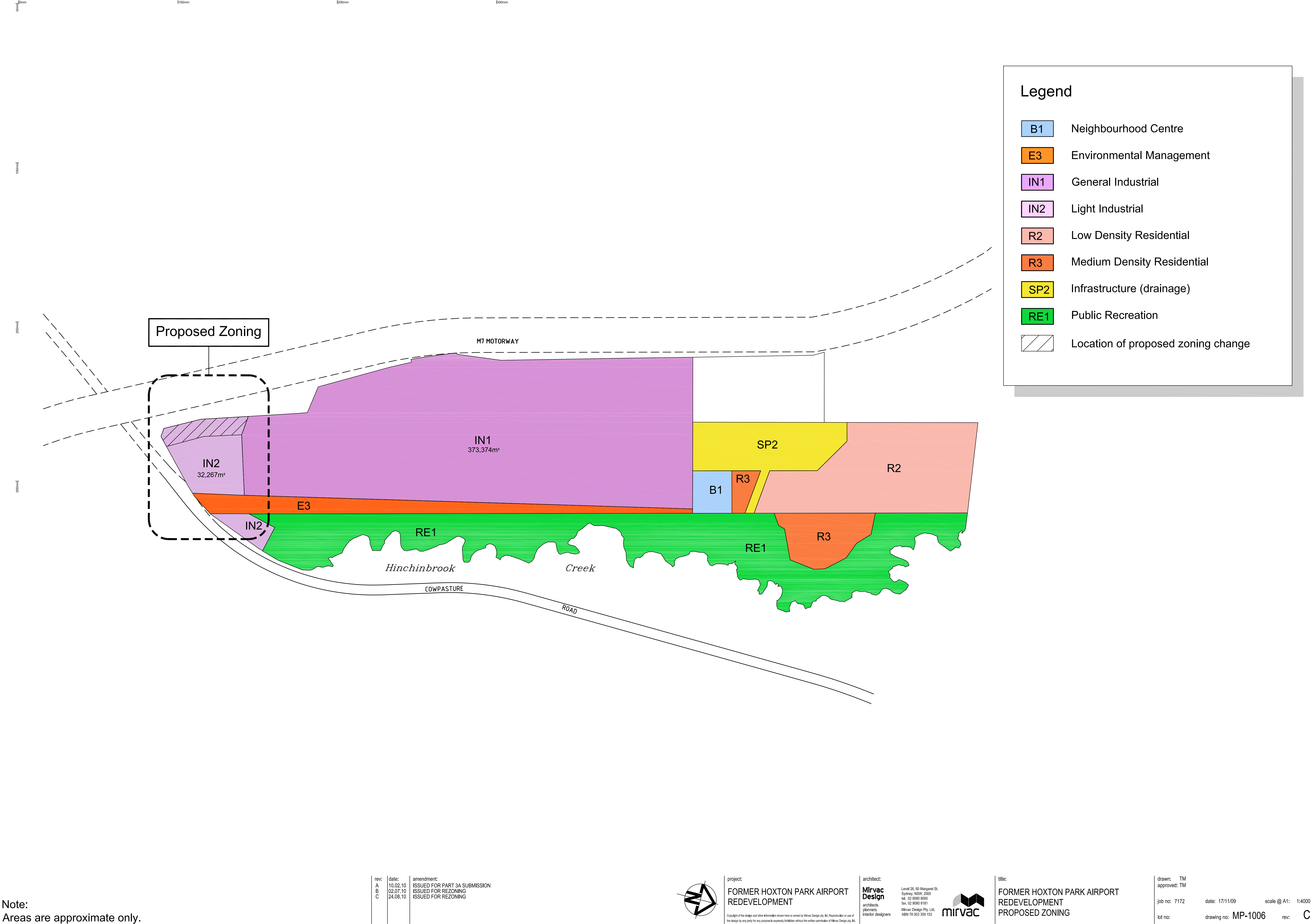

0mm

100mm

200mm

300mm

400mm

500mm

600mm

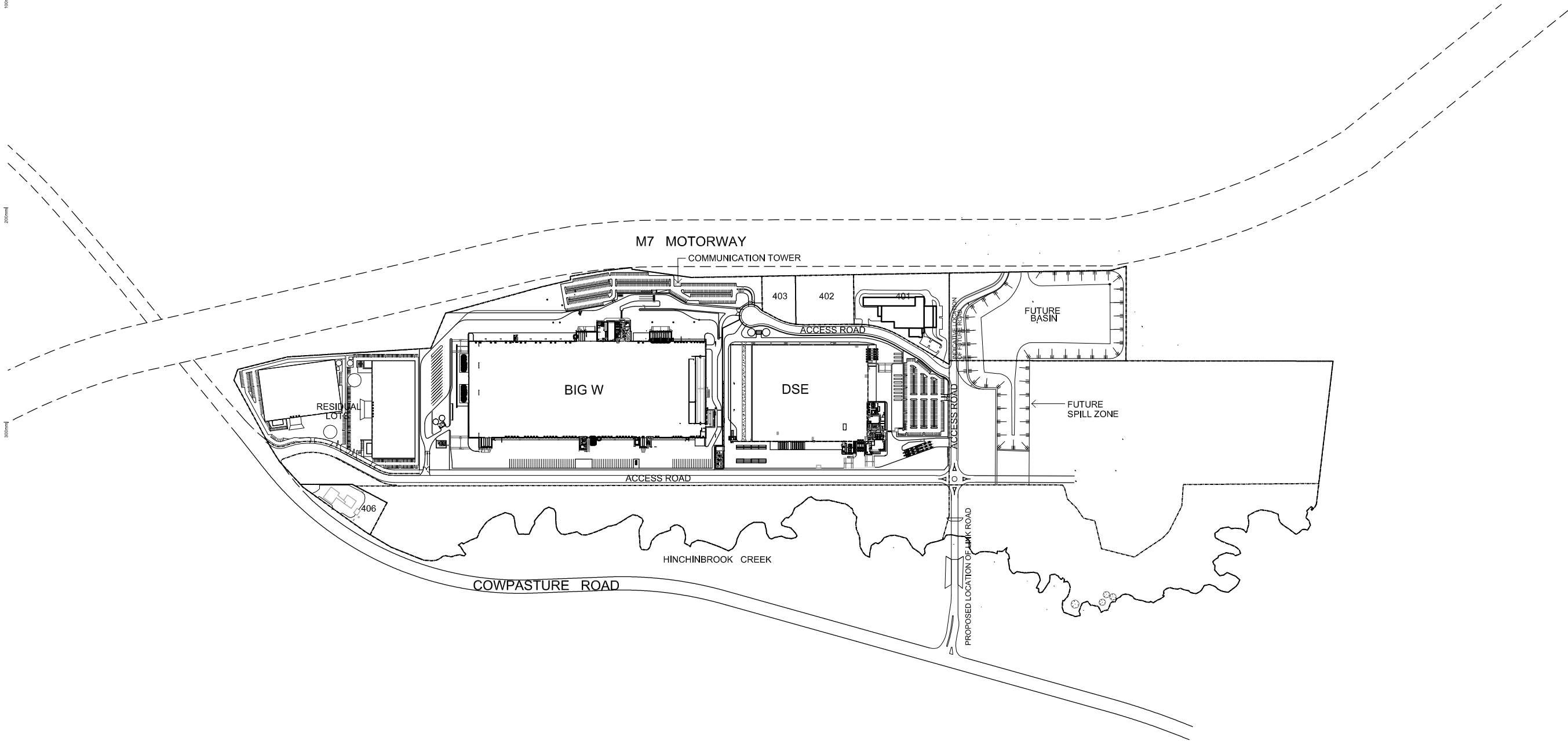

NOTE:  
BIG W & DSE BUILDING PLANS AS PROVIDED BY MNIA ARCHITECTS

rev:	date:	amendment
A	10.02.10	ISSUE FOR PART 3A SUBMISSION
B	15.06.10	LOTS AND PLAN REVISED
C	17.05.10	FUTURE ROAD NOTE CHANGED AS PROPOSED LOCATION OF LINK ROAD



project:  
**FORMER HOXTON PARK AIRPORT  
REDEVELOPMENT**

Copyright of the design and other information shown herein is owned by Mirvac Design Pty Ltd. Reproduction or use of this design by any party for any purpose is expressly forbidden without the written permission of Mirvac Design Pty Ltd.

architect:  
**Mirvac  
Design**  
architects  
planners  
interior designers

Level 20, 50 Margaret St.  
Sydney, NSW, 2000  
tel. 02 9030 8000  
fax. 02 9030 8181  
Mircvac Design Pty Ltd.  
ABN 78 003 359 153



title:  
**FORMER HOXTON PARK AIRPORT  
REDEVELOPMENT  
OVERALL SITE MASTERPLAN**

drawn: TM  
approved: TM  
job no: 7172  
lot no:

date: January 2010  
drawing no: **MP-1002**  
scale @ A1: 1:4000  
rev: **C**



0mm

100mm

200mm

300mm

100mm

200mm

300mm



<b>LOT 1</b>		
SITE AREA		29 633 m² approx
<b>GROSS FLOOR AREA</b>		
WAREHOUSE 1		14 065 m²
OFFICE		600 m²
AMENITIES		200 m²
<b>TOTAL</b>		<b>14 865 m²</b>

PAVEMENT HEAVY DUTY	5 995 m²
PAVEMENT LIGHT DUTY	4 985 m²

CARPARKING	124 SPACES
------------	------------

<b>LOT 2</b>		
SITE AREA		29 255m² approx.

<b>GROSS FLOOR AREA</b>		
WAREHOUSE 2		14 650 m²
OFFICE		600 m²
AMENITIES		200 m²
(FUTURE OFFICE)		(600 m²)
(FUTURE AMENITIES)		(200 m²)
<b>TOTAL</b>		<b>16 250 m²</b>

PAVEMENT HEAVY DUTY	6 840 m²
PAVEMENT LIGHT DUTY	4 485 m²

CARPARKING	113 SPACES
------------	------------

**NOTE:**  
Floor area's are indicative only.

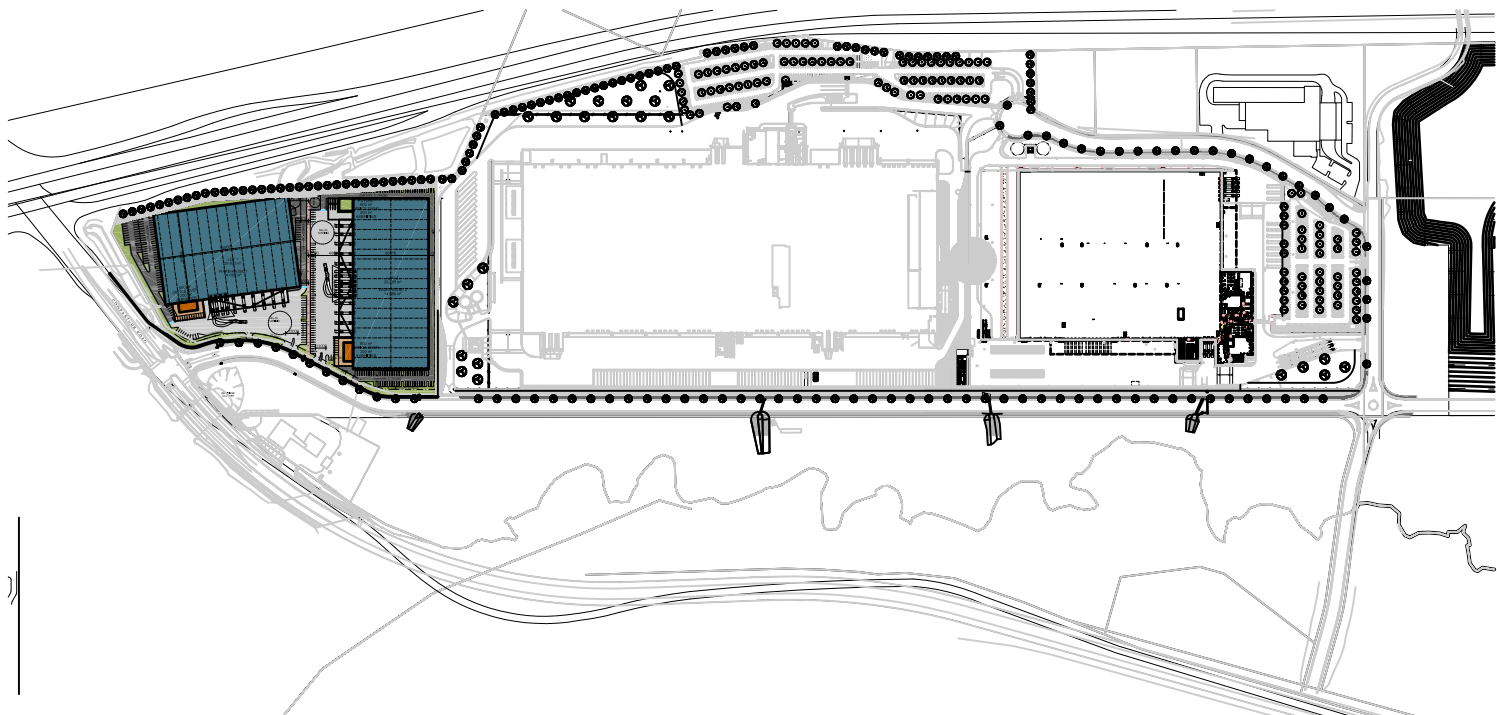

rev:	date:	amendment:
A	10.02.10	ISSUE FOR PART 3A SUBMISSION
B	24.08.10	LOTS & PLAN REVISED
C	22.08.10	GROSS FLOOR AREAS ADDED

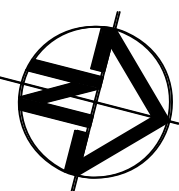

project:  
**FORMER HOXTON PARK AIRPORT  
REDEVELOPMENT**

Copyright of the design and other information shown here is reserved by Mirvac Design Pty. Ltd. Reproduction or use of the design by any party for any purpose is expressly forbidden without the written permission of Mirvac Design Pty. Ltd.

architect:  
**Mirvac Design**  
architects  
planners  
interior designers

Level 26, 60 Margaret St.  
Sydney, NSW, 2000  
tel. 02 9080 8000  
fax. 02 9080 8181  
Mirvac Design Pty. Ltd.  
ABN 78 003 358 153



title:  
**FORMER HOXTON PARK AIRPORT  
REDEVELOPMENT  
RESIDUAL LOTS PLANS**

drawn: approved:	job no: 7175	date: January 2010	scale @ A1: 1:750
lot no:	drawing no: MP-1009		

C