

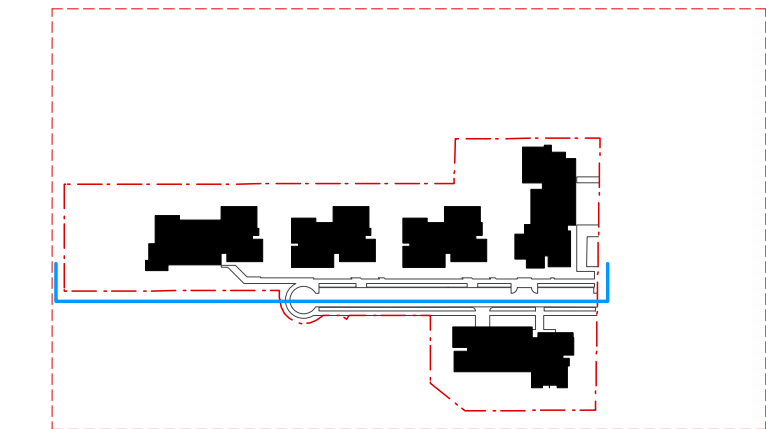

NOTE:
THE BUILDING FACADE AND LANDSCAPING ELEMENTS ARE INDICATIVE ONLY AND MATERIALS AND COLOURS HAVE NOT BEEN FINALISED TO DATE. THE DESIGN INTENT IS TO CREATE AN INDIVIDUAL CHARACTER FOR EACH BUILDING WHILST MAINTAINING CONNECTION TO A PRECINCT THEME.



NOTES
THIS DRAWING IS COPYRIGHT © AND SHALL REMAIN THE PROPERTY OF TURNER + ASSOCIATES ARCHITECTS. NO REPRODUCTION, WHOLE OR PARTIAL, OR ANY ALTERATION, OR ANY OTHER USE, IS PERMITTED WITHOUT THE WRITTEN PERMISSION OF TURNER + ASSOCIATES ARCHITECTS. THIS DRAWING IS NOT FOR CONSTRUCTION. DO NOT SCALE FROM DRAWING. FIGURED DIMENSIONS SHALL TAKE PRECEDENCE.

CLIENT
LIPMAN PROPERTIES PTY LTD
LEVEL 6, 66 BERRY STREET, NORTH SYDNEY
T 02 9955 7000 F 02 9955 3166



PROJECT TITLE
RESIDENTIAL DEVELOPMENT
128 HERRING ROAD, MACQUARIE PARK

DRAWING TITLE
Illustrative South Elevation
CONCEPT PLAN

G	17/01/20	1/20	General update
F	15/01/20	1/20	General update
E	15/01/20	1/20	General update
Rev	Date	Approved by	Revised/Notes
SCALE	1:250 @B1, 40% @ A3	JOB No.	09047
FOR INFORMATION		DWG No.	A 139
		REV	G
		AM	TS
TURNER + ASSOCIATES			
L1 410 Crown Street Surry Hills NSW 2010 Australia			
t +61 2 8668 0000 f +61 2 8668 0088			