

BELMORE GREEN & HOWELL PARK (OPEN SPACE 3 & 4)					
SYM	BOTANICAL NAME	COMMON NAME	HEIGHT	SPACING	POT SIZE
DECIDUOUS TREES					
	Fraxinus oxycarpa 'Raywood'	Claret Ash	15m	As Shown	200L
	Largerstoemia indica	Crepe Myrtle	12m	As Shown	100L
	Magnolia x soulangeana	Tulip Magnolia	7m	As Shown	100L
	Populus simonii	Chinese Poplar	20m	As Shown	800L
	Pyrus calleryana 'Chantideer'	Ornamental Pear	7m	As Shown	100L
	Pyrus calleryana 'Bradford'	Ornamental Pear	7m	As Shown	100L
	Quercus palustris	Pin Oak	20m	As Shown	400L
	Sapium serbiferum	Chinese Tallowood	12m	As Shown	100L
EVERGREEN TREES					
	Brachychiton populneus	Kurrajong	20m	As Shown	100L
	Cupaniopsis anacardioides	Tuckeroo	10m	As Shown	100L
	Hymenosporum flavum	Native Frangipani	10m	As Shown	75L
	Magnolia grandiflora	Bull Bay Magnolia	10m	As Shown	75L
	Syncarpia glomulifera	Turpentine	25m	As Shown	100L
	Tristaniopsis laurina 'Luscious'	Water Gum	12m	As Shown	75L
	Waterhousia floribunda	Weeping Lilly Pilly	15m	As Shown	100L
SHRUBS					
	Acmena smithii 'Hedgemaster'	Lilly Pilly	1m	500mm	25L
	Alternanthera dentata	Ruby Leaf Alternanthera	1.5m	300mm	200mm
	Buxus microphylla	Japanese Box	1.5m	300mm	200mm
	Callistemon citrinus 'Anzac'	Drawf Bottlebrush	1.0m	4m2	5L
	Callistemon viminalis 'Little John'	Drawf Bottlebrush	1.0m	4m2	5L
	Cordyline sp	Cordyline	3m	4m2	5L
	Dodenaee viscosa 'Purpurea'	Purple Hop Bush	2m	2m2	25L
	Grevillea 'Honey Gem'	Grevillea	3m	1m2	25L
	Gardenia augusta 'Florida'	Gardenia	1.5m	3m2	25L
	Lavandula dentata	French Lavenda	1m	300mm	5L
	Murraya paniculata	Orange Jessamine	3m	750mm	25L
	Philodendron 'Xanadu'	Philodendron	1.2m	500mm	25L
	Rosmarinus officinalis	Rosemary	1.5m	500mm	25L
	Syzygium sp.	Lilly Pilly	3m	1.0m	25L
	Viburnum odoratissimum	Sweet Viburnum	6m	500mm	25L
	Westringia 'Wynyabbie Gem'	Coastal Rosemary	1m	500mm	25L
GRASSES & GROUND COVERS					
	Beschorneria yuccoides	Mexican Lily	1.0m	3m2	200mm
	Dianella 'Breeze'	Paroo Lily	0.3m	7/m²	75mm Tube
	Dianella 'Little Rev'	Paroo Lily	0.3m	9/m²	75mm Tube
	Dianella 'Little Jess'	Paroo Lily	0.4m	7/m²	75mm Tube
	Dietes grandiflora	Wild Iris	0.6m	7/m²	75mm Tube
	'Hymenocallis littoralis'	Swamp Lilly	1.5m	4m2	5L
	Juniperus conferta	Shore Juniper	0.3m	4m2	200mm
	Liriope muscari 'Evergreen Giant'	Turf Lily	0.7m	5/m²	150mm
	Lomandra 'Tanika'	Mat Rush	0.7m	7/m²	75mm Tube
	Pennisetum alopecuroides 'Nafray'	Swamp Foxtail	0.7m	7/m²	75mm Tube
	Phormium tenax 'Baby Bronze'	New Zealand Flax	0.6m	5/m²	200mm
	Poa labillardieri 'Eskdale'	Tussock Grass	0.6m	9/m²	75mm Tube
	Trachelospermum jasminoides	Star Jasmine	0.6m	5/m²	150m
	Viola hederacea	Native Violet	0.2m	5/m²	100mm

## INDICATIVE WSUD PLANTING SCHEDULE:

WETLAND PARK (OPEN SPACE 5), RAIN GARDENS & SWALES					
SYM	BOTANICAL NAME	COMMON NAME	HEIGHT	SPACING	POT SIZE
DECIDUOUS TREES					
	Fraxinus pennsylvanica 'Cimarron'	Green Ash	15m	As Shown	100L
	Pyrus calleryana 'Chantideer'	Ornamental Pear	7m	As Shown	100L
ORCHARD TREES (Historic reference only)					
	Carya illinoensis	Pecan Tree	25m	As Shown	100L
	Macadamia tetraphylla	Macadamia	15m	As Shown	100L
	Prunus armeniaca 'Moorpark'	Apricot Tree	4m	As Shown	75L
TREES (Littoral Zones & Embankments)					
	Casuarina glauca	She Oak	15m	As Shown	45L
	Eucalyptus amplifolia	Cabbage Gum	20m	As Shown	75L
	Eucalyptus tereticornis	Forest Red Gum	20m	As Shown	75L
	Melaleuca decora	White Feather Honey Myrtle	7m	As Shown	75L
	Melaleuca quinquenervia	Broad Leaved Paperbark	15m	As Shown	75L
	Melaleuca styphelioides	Prickly-Leaved Paperbark	12m	As Shown	75L
SHRUBS (Littoral Zones & Embankments)					
	Acacia parramattensis #	Sydney Green Wattle	3-4m	As Shown	25L
	Bursaria spinosa	Blackthorn	3m	As Shown	5L
	Callistemon citrinus 'Anzac'	Drawf Bottlebrush	1.0m	4m2	5L
	Callistemon viminalis 'Little John'	Drawf Bottlebrush	1.0m	4m2	5L
	Dodenaee viscosa 'Purpurea'	Purple Hop Bush	2m	2m2	25L
	Grevillea 'Honey Gem'	Grevillea	3m	1m2	25L
	Grevillea 'Misty Pink'	Grevillea	3m	1m2	25L
	Grevillea 'Scarlet Sprite'	Grevillea	1m	3m2	25L
	Leptospermum 'Cardwell'	Tea Tree	2m	2m2	150mm
	Melaleuca thymifolia	Honey Myrtle	0.5m	5m2	150mm
GRASSES, SEDGES, RUSHES & GROUND COVERS (Littoral Zones & Embankments)					
	Carex appressa	Tall Sedge	0.6m	5/m²	125x50x50
	Dianella longifolia var longifolia	Smooth Flax Lily	0.5m	7/m²	125x50x50
	Hardenbergia violacaea	Native Violet	0.8m	3m2	75mm Tube
	Hibbertia scandens	Snake Vine	0.3m	4m2	75mm Tube
	Isolepsis nodosa	Club Rush	0.7m	5/m²	75mm Tube
	Juncus usitatus	Common Rush	0.7m	7/m²	75mm Tube
	Lomandra longifolia	Mat Rush	0.7m	7/m²	75mm Tube
	Lomandra longifolia 'Katrinus'	Mat Rush	0.7m	7/m²	75mm Tube
	Lomandra 'Tanika'	Mat Rush	0.7m	7/m²	75mm Tube
	Microlaena stipoides var stipoides	Weeping Grass	0.5m	7/m²	125x50x50
	Pennisetum alopecuroides 'Nafray'	Swamp Foxtail	0.7m	7/m²	75mm Tube
	Poa labillardieri 'Eskdale'	Tussock Grass	0.6m	9/m²	75mm Tube
MACROPHYTES * (Water Quality Basin)					
	Baumea articulata	Jointed Twig Rush	0.6m	5/m²	125x50x50
	Baumea rubiginosa	Soft Twig Rush	0.6m	5/m²	125x50x50
	Bolboschoenus fluviatilis	Stream Club Rush	1.5m	5/m²	125x50x50
	Carex appressa	Tall Sedge	0.6m	5/m²	125x50x50
	Eleocharis acuta	Common Spike Rush	0.6m	5/m²	125x50x50
	Isolepsis inundata	Swamp Club Rush	0.7m	5/m²	125x50x50
	Juncus usitatus	Common Rush	0.7m	7/m²	125x50x50
	Schoenoplectus validus	River Club Rush	1.0m	5/m²	125x50x50

# - Denotes that this stock is to be provinance stock sourced from the local area to maintain the genetic integrity of the threatened native vegetation communities.  
\* - Denotes that this stock is to be coordinated with detention basin engineers for suitability for water quality / filtration purposes.

## 10.1 INDICATIVE PLANTING SCHEDULE con’t

WATERS EDGE (OPEN SPACE 6)				
SYM	BOTANICAL NAME	COMMON NAME	HEIGHT	SPACING
DECIDUOUS TREES				
	Fraxinus oxycarpa 'Raywood'	Claret Ash	15m	As Shown
	Koelreuteria paniculata	Golden Rain Tree	6m	As Shown
	Largerstoemia indica	Crepe Myrtle	12m	As Shown
	Robinia pseudoacacia 'Frisia'	Flase Acacia	10m	As Shown
	Ulmus parvifolia	Chinese Elm	15m	As Shown
EVERGREEN TREES				
	Brachychiton populneus	Kurrajong	20m	As Shown
	Cupaniopsis anacardiodes	Tuckeroo	10m	As Shown
	Eucalyptus amplifolia	Cabbage Gum	20m	As Shown
	Eucalyptus moluccana	Grey Box	20m	As Shown
	Eucalyptus tereticornis	Forest Red Gum	20m	As Shown
	Hymenosporum flavum	Native Frangipani	10m	As Shown
	Syncarpia glomulifera	Turpentine	25m	As Shown
	Tristaniopsis laurina 'Luscious'	Water Gum	12m	As Shown
	Waterhousia floribunda	Weeping Lilly Pilly	15m	As Shown
SHRUBS				
	Acacia falcata	Sickle Wattle	2-3m	As Shown
	Acacia florabunda	Sally Wattle	3-4m	As Shown
	Acmena smithii 'Hedgemaster'	Lilly Pilly	1m	500mm
	Callistemon citrinus 'Anzac'	Drawf Bottlebrush	1.0m	4m2
	Callistemon viminalis 'Little John'	Drawf Bottlebrush	1.0m	4m2
	Callistemon 'Mauve Mist'	Bottlebrush	2.0m	3m2
	Dodenaee viscosa 'Purpurea'	Purple Hop Bush	2m	2m2
	Grevillea 'Misty Pink'	Grevillea	3m	1m2
	Grevillea 'Scarlet Sprite'	Grevillea	1m	3m2
	Kunzea ambigua	Tick Bush	3m	1m2
	Melaleuca thymifolia	Honey Myrtle	0.5m	5m2
	Syzygium sp.	Lilly Pilly	3m	1.0m
	Viburnum odoratissimum	Sweet Viburnum	6m	500mm
	Westringia 'Wynyabbie Gem'	Coastal Rosemary	1m	500mm
GRASSES & GROUND COVERS				
	Agapanthus sp.	Agapanthus	0.6m	5/m²
	Cerastium tomentosum'	Snow in Summer	0.3m	5/m²
	Dianella 'Breeze'	Paroo Lily	0.5m	7/m²
	Dianella 'King Alfred'	Paroo Lily	0.5m	7/m²
	Dianella 'Silver Streak'	Paroo Lily	0.6m	5/m²
	Dietes grandiflora	Wild Iris	0.6m	7/m²
	Hardenbergia 'Purple Spray'	Native Violet	0.8m	3m2
	Hibbertia scandens	Snake Vine	0.3m	4m2
	Liriope muscari 'Variegata'	Turf Lily	0.5m	5/m²
	Liriope muscari 'Evergreen Giant'	Turf Lily	0.7m	5/m²
	Lomandra longifolia 'Nyalla'	Mat Rush	0.7m	7/m²
	Lomandra longifolia 'Tanika'	Mat Rush	0.7m	7/m²
	Pennisetum alopecuroides 'Nafray'	Swamp Foxtail	0.7m	7/m²
	Phormium sp'	Flax	0.7m	5/m²
	Poa labillardieri 'Eskdale'	Tussock Grass	0.6m	9/m²
MACROPHYTES * (Detention Canal Edge)				
	Baumea juncea	JointedTwig Rush	1.2m	5/m²
	Bolboschoenus cardwellii	Sea Club Rush	1.0m	5/m²
	Carex appressa	Tussock Sedge	0.8m	5/m²
	Eleocharis acuta	Common Spike Rush	0.6m	5/m²
	Gahnia sieberena	Sawgrass Sedge	2.0m	5/m²
	Juncus kraussii	Sea Rush	0.7m	5/m²

# - Denotes that this stock is to be provinance stock sourced from the local are maintain the genetic integrity of the threatened native vegetation communities.



INDICATIVE OPEN SPACE  
PLANTING SCHEDULE:

McHENRYS PLACE (OPEN SPACE 7)					
SYM	BOTANICAL NAME	COMMON NAME	HEIGHT	SPACING	POT SIZE
DECIDUOUS TREES					
	Liriodendron tulipifera	Tulip Tree	15m	As Shown	400L
	Populus simonii	Chinese Poplar	20m	As Shown	400L
EVERGREEN TREES					
	Eucalyptus maculata	Spotted Gum	20m	As Shown	400L
	Eucalyptus microcorys	Tallowood	25m	As Shown	400L
SHRUBS					
	Acmena smithii 'Hedgemaster'	Lilly Pilly	1m	500mm	25L
	Alternanthera dentata	Ruby Leaf Alternanthera	1.5m	300mm	200mm
	Chaenomeles speciosa	Flowering Quince	1.5m	500mm	200mm
	Gardenia augusta 'Florida'	Gardenia	1.5m	3m2	25L
	Lavandula dentata	French Lavenda	1m	300mm	5L
	Rosmarinus officinalis	Rosemary	1.5m	500mm	25L
GRASSES & GROUND COVERS					
	Agapanthus sp.	Agapanthus	0.6m	5/m²	150mm
	Beschorneria yuccoides	Mexican Lily	1.0m	3m2	200mm
	Cerastium tomentosum'	Snow in Summer	0.3m	5/m²	150mm
	Dianella 'Breeze'	Paroo Lily	0.5m	7/m²	75mm Tube
	Dianella 'King Alfred'	Paroo Lily	0.5m	7/m²	75mm Tube
	Dianella 'Silver Streak'	Paroo Lily	0.6m	5/m²	150mm
	Dietes grandiflora	Wild Iris	0.6m	7/m²	75mm Tube
	Liriope muscari "Evergreen Giant"	Turf Lily	0.7m	5/m²	150mm
	Trachelospermum jasminoides	Star Jasmine	0.6m	5/m²	150m

STATION SQUARE (OPEN SPACE 8)					
SYM	BOTANICAL NAME	COMMON NAME	HEIGHT	SPACING	POT SIZE
DECIDUOUS TREES					
	Fraxinus oxycarpa 'Raywood'	Claret Ash	15m	As Shown	400L
	Liriodendron tulipifera	Tulip Tree	15m	As Shown	400L
	Pyrus calleryana 'Bradford'	Ornamental Pear	10m	As Shown	400L
SHRUBS					
	Acmena smithii 'Hedgemaster'	Lilly Pilly	1m	500mm	25L
	Alternanthera dentata	Ruby Leaf Alternanthera	1.5m	300mm	200mm
	Euphorbia characias 'wulfenii'	Spurge	1.5m	3m2	5L
	Gardenia augusta 'Florida'	Gardenia	1.5m	3m2	25L
	Lavandula dentata	French Lavenda	1m	300mm	5L
	Rosmarinus officinalis	Rosemary	1.5m	500mm	25L
GRASSES & GROUND COVERS					
	Agapanthus sp.	Agapanthus	0.6m	5/m²	150mm
	Cerastium tomentosum'	Snow in Summer	0.3m	5/m²	150mm
	Dianella 'Breeze'	Paroo Lily	0.5m	7/m²	75mm Tube
	Dianella 'King Alfred'	Paroo Lily	0.5m	7/m²	75mm Tube
	Dianella 'Silver Streak'	Paroo Lily	0.6m	5/m²	150mm
	Dietes grandiflora	Wild Iris	0.6m	7/m²	75mm Tube
	Gardenia jasminoides 'Radicans'	Creeping Gardenia	0.5m	4m2	150mm
	Liriope muscari "Evergreen Giant"	Turf Lily	0.7m	5/m²	150mm
	Trachelospermum jasminoides	Star Jasmine	0.6m	5/m²	150m





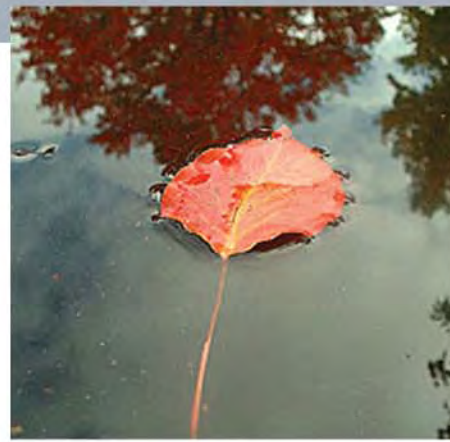

# **NORTH PENRITH VILLAGE - STAGE 1 PART 3A PROJECT APPLICATION LANDSCAPE CONCEPT REPORT**





# 1.0 STAGE 1 LANDSCAPE MASTER PLAN

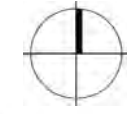

SCALE: 1/2000 @ A3  
0 25 50 75m







## LEGEND

### STREETSCAPE:

-  Main Entry & Boulevard
-  Boulevard and biofiltration median
-  Typical Main, Collector & Local Streets
-  Typical Minor Local Street
-  90 deg. On-street parking to village green

### OPEN SPACE:

-  Smiths Paddock / Village Green
-  Belmore Green
-  Coreen Ave. Entry
-  Community Facilities Building (called - Cricketers Pavilion)
-  Through Site Link / Cycle way

P.T.D.

THORNTON HALL





## 2.0 SMITHS PADDOCK

### General Character:

The Smiths Paddock location has significant references in terms of its historical contribution to the Penrith Districts affiliation with and the relentless pursuit of active recreation. Following these principles the oval will remain as part of the developments core active recreational facilities playing host to potentially social cricket and junior football codes. The green will also be available for use by the general public as a space for unstructured play. The northern and eastern perimeter of the oval will retain and enhance with supplementary plantings of the existing *Eucalyptus melliodora* which currently frames the existing oval location. The understory plantings located beneath the eucalypts will mainly consist of swathes of native grasses and exotic iris for flowering colour to enhance the appearance found within a woodland community while maintaining the overall character of the development. The southern portion of the oval contains a structured play spaces catering for children of various age groups along with a physical water play element such as a pop jet plaza. The play areas are to be designed with universal accessibility principles in mind. The western edge of the oval will contain a architecturally designed community facilities building with included private and public amenities. An activated and interactive foam jet water feature is proposed to visually link the movement of water to the north west to give the illusion of a connected water body linking to the waterfront park further to the west of the oval. Individual components of fitness equipment have been located in key areas around the inner pedestrian / cycle way path to install a dedicated fitness circuit around the oval adding significant value to the healthy lifestyle choices already found within this particular open space.

Some key points are listed below;

### Aspect and Views

- Strong visual associations with key destinations within the precinct through strong axial alignments.
- Take advantage of central location to enhance the opportunities for improved views and vistas to other key points both within and outside of the site

### Accessibility

- Strong connectivity along the central axis and perimeter path around the oval for pedestrian and cyclist's access to residential zones and parks.
- Continuity of and connectivity to local and recreational paths linking the entire site.

### Materials:

- Predominantly robust contemporary materials such as concrete combined with natural materials such as granite, bluestone, porphyry setts, local sandstone, timbers and gravels. In this way the more contemporary urban character of the park will be reflected through the choice of materials and also complement the more exotic character of the softscape palette.

### Plantings:

- Supplementary planting of native trees to the oval's existing perimeter community of eucalypt species in selected areas to enhance the visual appearance of the fragmented vegetation.

- Selected planting of deciduous trees to provide shade and visual amenity.
- Low shrub and ground cover planting using a mix of low maintenance plant species along with contemporary architectural species.

### WSUD Elements:

- Porous paving to be utilised within key areas of hardstand to reduce surface runoff while ornamental rain gardens will be used to temporarily store stormwater before entering the soil profile.

### Ecological:

- The Ecological assessment of this proposed open space area is identified as having no environmental significant communities but was likely to have been previously dominated by Cumberland Plain Woodland species.
- Planting of trees to enhance restoration of Eucalypt communities in selected areas to consolidate or promote linkages of fragmented native vegetation.

### Heritage/ Public Art/ Interpretation

- This park has high heritage significance from a cultural point of view and its strength lies in the opportunity for visual interpretation of the historic use of the site. The potential interpretative opportunities offered through the sites heritage components include a speedway, cricket oval, aerodrome and its significant historic buildings of Coombewood and Thornton Hall.
- Interpretive signs
- Interpretive Public Art of heritage elements

### Community/Recreational:

- Community Facilities building with private break out space
- Active/Passive open space
- Opportunities for markets
- Community gatherings and social events
- Pedestrian/cycle links to the rest of the site
- Children's all ages play ground/ All Inclusive Universal play area / Pop jet water play area
- Public seating / Fitness equipment stations and circuit





## 2.10 SMITHS PADDOCK LANDSCAPE CONCEPT

### LEGEND

- 1 Community Facilities building
- 2 All abilities play area
- 3 Interactive foam jet plaza
- 4 Central plaza/ Major public art installation
- 5 Raised vehicle crossing / pedestrian threshold
- 6 Ornamental rain gardens
- 7 5-12 Play area
- 8 BBQ & family areas
- 9 Children's Pop jet play area
- 10 Timber bridge / ornamental rain garden
- 11 Oval / Village green
- 12 Through site link / Cycle way
- 13 Central Median Bio-filtration Swale
- 14 90 degree on street parking
- 15 Public seating area / Fitness equipment station
-  Existing Eucalypts to be retained

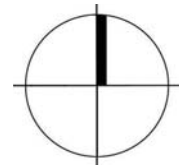

SCALE 1/1000 @ A3

0 10 20 30m





## 2.11 SMITHS PADDOCK (NORTH) LANDSCAPE DETAIL PLAN



### LEGEND

- 1 Oval / Village green
- 2 Timber bridge crossing
- 3 Ornamental rain garden
- 4 Internal Pedestrian link / Cycle way
- 5 External Pedestrian Footpath
- 6 Central Median Bio-filtration Swale
- 7 Public seating area / Fitness equipment station
- 8 Mass planting under Eucalypt trees
- 9 Cricket Bat Gate Art Installation

- Existing Eucalypts to be retained
- Supplementary plantings of existing Eucalypts
- Deciduous Street Trees in turf verge

### MATERIALS

- CO - Concrete Paths
- XC - Lightly Exposed Concrete Paths
- PF - 1000mm High Picket Fence
- TD - H/W Timber Bridge Crossing
- SS - Sandstone block edging to rain garden

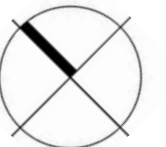

SCALE 1/500 @ A3

0 5 10 15m





## 2.12 SMITHS PADDOCK (SOUTH) LANDSCAPE DETAIL PLAN

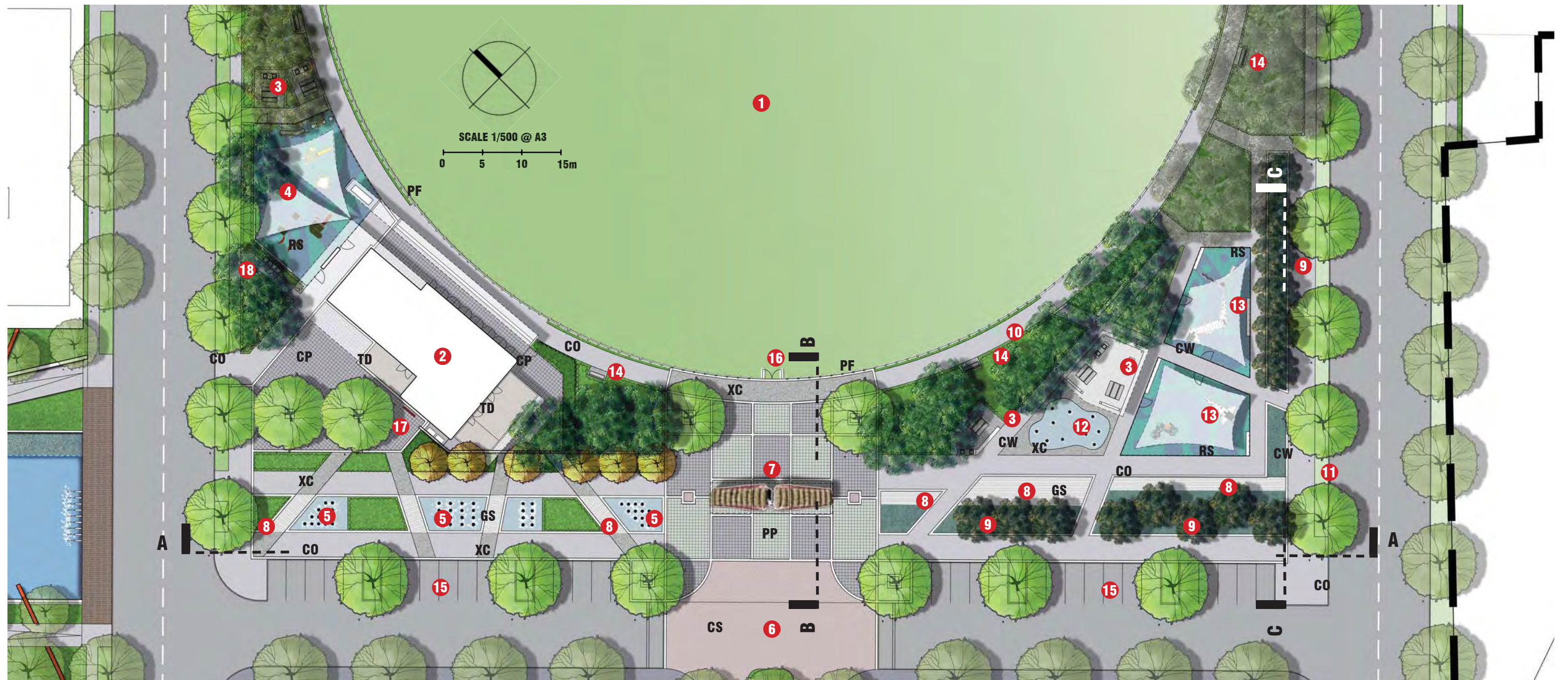

### LEGEND

- |  |  |   |
|--|--|---|
| 1 Oval / Village green                               | 6 Raised vehicle crossing / pedestrian threshold | 12 Children's Pop jet play area                     |
| 2 Community Facilities Building with break out space | 8 Galvanised steel faux bridge crossing          | 13 5-12 Play area / All inclusive                   |
| 3 BBQ / Family picnic areas                          | 9 Ornamental rain garden with melaleuca trees    | 14 Public seating areas / Fitness equipment station |
| 4 All abilities play area                            | 10 Internal Pedestrian link / Cycle way          | 15 90 Degree on street parking                      |
| 5 Interactive foam jet plaza                         | 11 External Pedestrian Footpath                  | 16 Cricket Bat Gate Art Installation                |
| 7 Central plaza/ Major public art installation       |  | 17 Community & Way Finding Signage                  |
|  |  | 18 Waste Bin Station under trees                    |

- Existing Eucalypts to be retained
- Supplementary plantings of existing Eucalypts
- Deciduous Street Trees in turf verge
- Evergreen Trees
- Mass planting & hedges

### MATERIALS

- |  |   |
|--|---|
| CO - Concrete Paths                        | PP - Natural Stone Plaza Paving           |
| XC - Lightly Exposed Concrete Paths        | PF - 1000mm High Timber Picket Fence      |
| CS - Concrete Pavers to Shared Zone        | GS - Galvanised Steel Grates.             |
| CP - Concrete Pavers to Building surrounds | RS - Reconstituted Rubber Soft fall       |
| CW - Off Form Concrete seating Walls       | TD - Timber Decking to building surrounds |





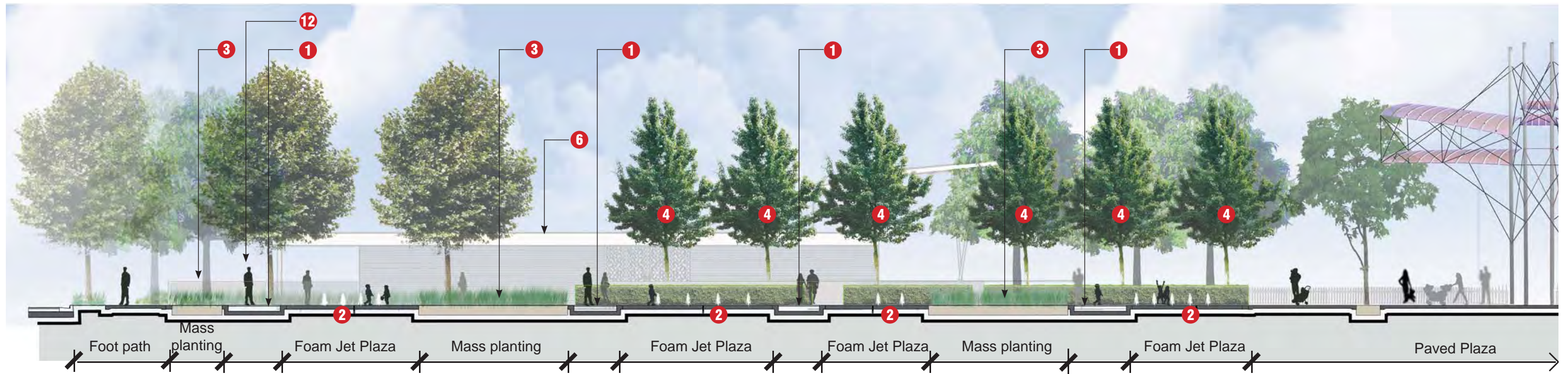

LONG SECTION AA

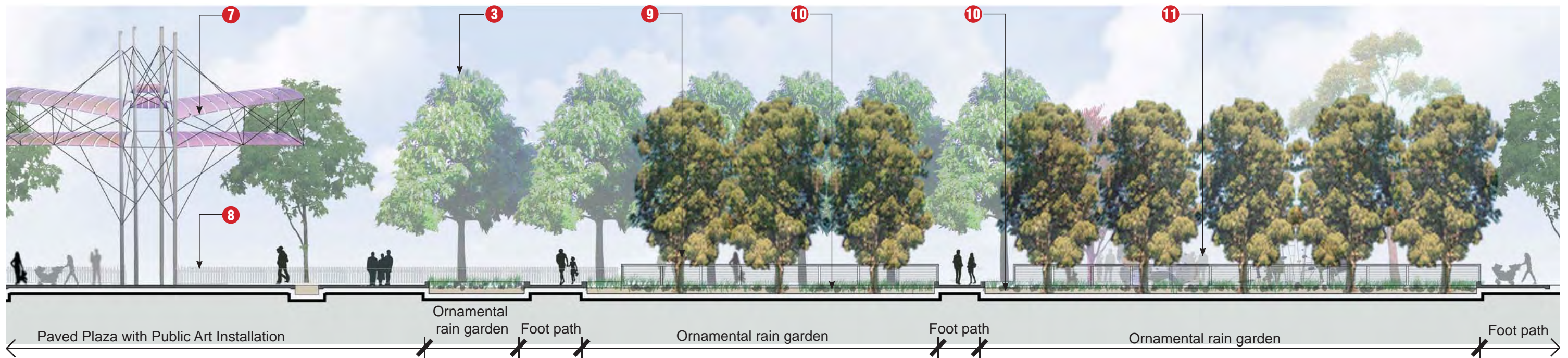

LONG SECTION AA con't

LEGEND

- |   |  |   |
|---|--|---|
| 1 Galvanised steel faux crossing bridge | 5 Evergreen shade tree planting behind                   | 9 Galvanised steel platform with railing                                  |
| 2 Interactive Foam Jet Plaza            | 6 Community Facilities Building behind                   | 10 Ornamental rain garden with Melaleuca tree planting                    |
| 3 Mass Planting between wet areas       | 7 Public Art Installation (Aviation Theme)               | 11 5 - 12 Children's Play area / inclusive play & Family BBQ area behind. |
| 4 Deciduous trees in hedge planting     | 8 White Picket Fence Cricket Bat Art Installation behind | 12 All abilities play area behind wall                                    |





## 2.21 SMITHS Paddock Sections

SCALE 1:200 @ A3

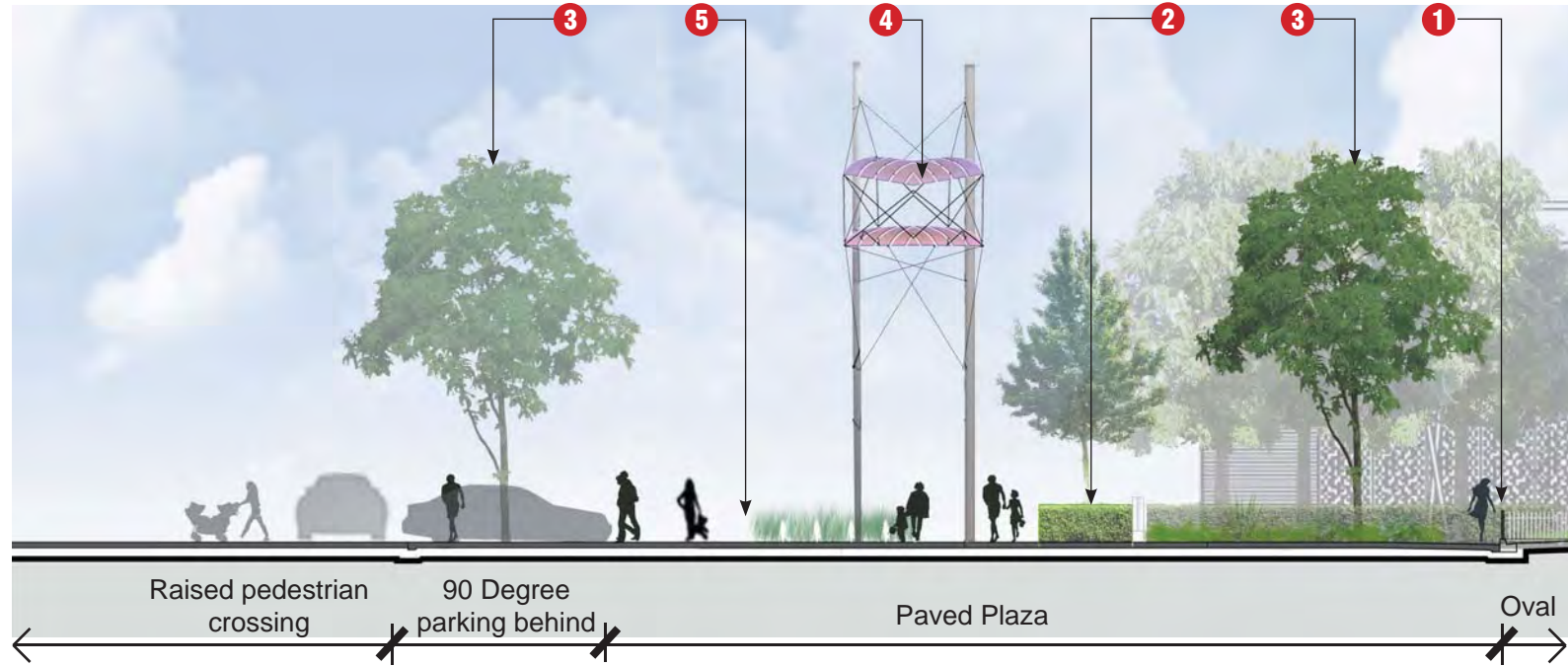

SECTION BB

### LEGEND

#### SECTION BB

- 1 Oval white picket fence
- 2 Deciduous trees & Hedge planting
- 3 Ulmus parvifolia ( Chinese elms)
- 4 Major Public Art Work
- 5 Interactive Foam jet play area with planting behind

#### SECTION CC

- 1 Ornamental rain garden with Melaleuca tree planting
- 2 Galvanised steel platform with railing
- 3 Concrete Seat wall
- 4 5 - 12 Children's Play area / inclusive play & Family BBQ area.
- 5 Evergreen shade tree planting
- 6 Feature deciduous tree on sculptural turf mound
- 7 Existing trees Eucalyptus melliodora
- 8 Mass planting - Native grasses

#### SECTION DD

- 1 Ornamental rain garden with rushes & sedge planting
- 2 Hardwood timber pedestrian bridge
- 3 Existing trees Eucalyptus melliodora
- 4 Supplementary planting of Eucalyptus melliodora
- 5 Mass planting - Native grasses

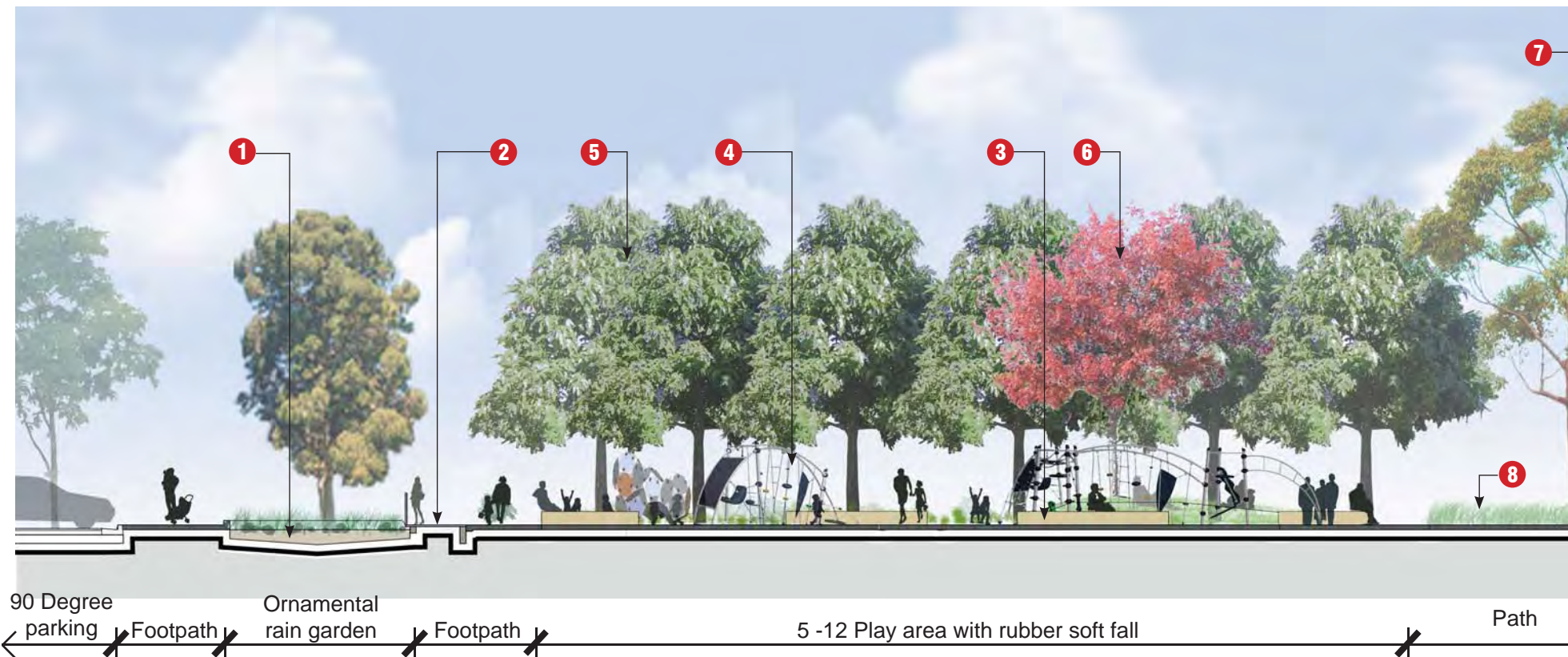

SECTION CC

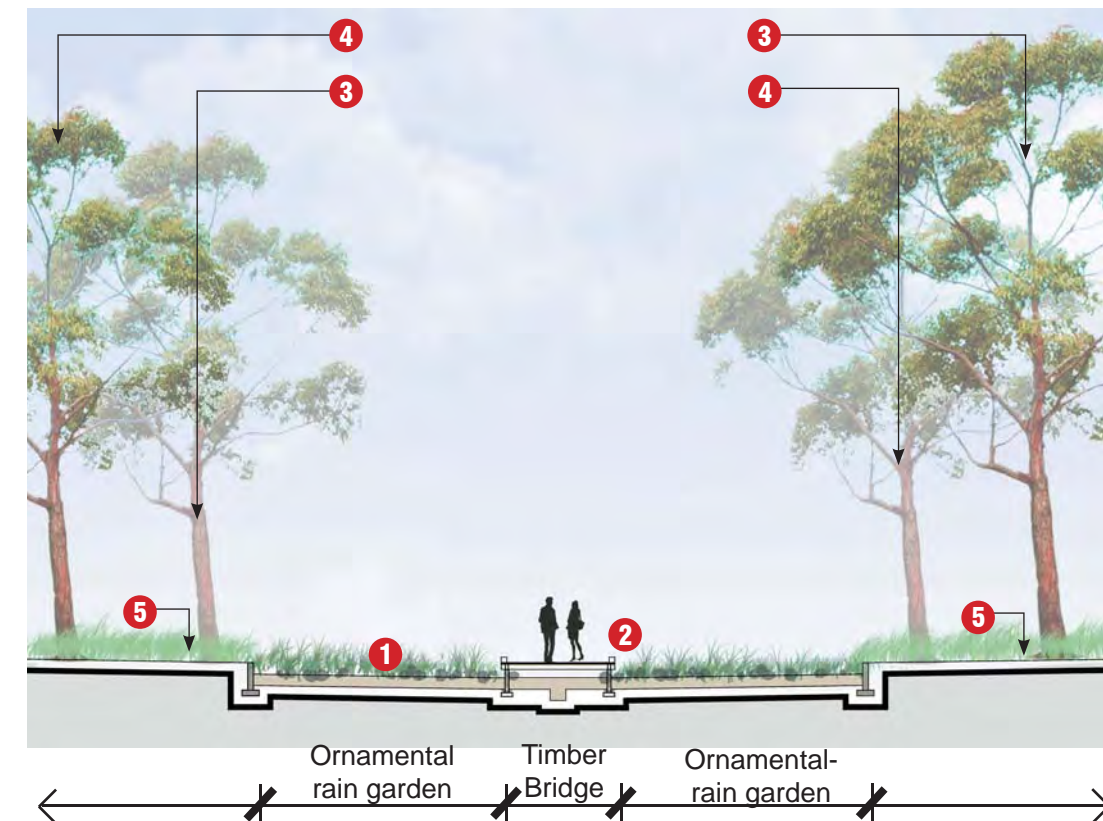

SECTION DD





## 3.0 BELMORE GREEN

### General Character:

This park is located along a north east axis from Smiths Paddock. The design intention of this park is to provide a landscape connection with the key design elements of Smiths Paddock.

The parks character will be in keeping with the surrounding streetscapes and incorporate both large deciduous and evergreen trees. Large swaths of turf provide an open park experience with ample usable space for both active play and quite strolling. Structured plantings to the west of the park will enhance the visual amenity of the park as well as provide screening to the residence situated on the western boundary,

The intent of this open space is to create an neighbourhood park that provides users with both passive and unstructured low level active recreation, The spatial qualities of this park also ensures that there is ample opportunity for quiet contemplation. Accessibility to three sides of the park and integration of the developments main cycle way route enhances the functionality of this long linear park. A raised sunning lawn area reflects the connection to the Smiths Paddock oval and will create interest for both young and old as well as improving visual safety as parents can watch over the kids whilst sitting on the mound or from the nearby proprietary bench seats.

Key parkland tree plantings along with both passive and active spatial arrangements will provide interest and sustainable amenity for the local community and external park users.

Some key points are listed below;

### Aspect and Views

- Use of large expanses of turf and wide paths to maintain and enhance view corridors from and within the site and increases passive surveillance.

### Accessibility

- Accessible paths linking the park to the streets and the surrounding apartments
- Pedestrian and cycle way access through the park with connections to council pedestrian path way networks.

### Materials:

- Predominantly robust contemporary materials such as concrete walls with cor-ten or red ceramic tile cladding, cast in-situ concrete pavements combined with the embellishments of natural materials such as granite / porphyry paving. In this way the character of the park will be reflected through the choice of materials without dissolving it from the overall design materials utilised through out the remainder of the development.

### Plantings:

- Deciduous and evergreen canopy trees to provide filtered light, shade and visual amenity.
- Understory planting using low maintenance plant species.
- Opportunity for pockets of exotic planting to reflect the village character of the development and the local community.

### WSUD Elements:

- Passive open space to reduce stormwater runoff

### Ecological:

- The Ecological assessment of this proposed open space area is identified as being dominated by Cumberland Plain Woodland.
- Planting of trees to enhance biodiversity.

### Heritage/ Public Art/ Interpretation

- This park has limited heritage significance from a cultural point of view but its strength lies in the opportunity for visual connection and interpretation of the sites significant heritage elements such as a former speedway, cricket oval, aerodrome and its significant personalities.

### Community/Recreational:

- Active/Passive open space areas
- Pedestrian/cycle links to the rest of the site
- Possibility for on street car parking
- Opportunities for BBQ areas and picnic facilities
- Development of large lawn areas to increase usability of active / passive spaces.





### 3.1 BELMORE GREEN LANDSCAPE DETAIL PLAN



#### LEGEND

- 1 Shared pedestrian / cycle way
- 2 Residential access pathway
- 3 Open turf space / kick around
- 4 Open turf space
- 5 Raised mound / sunning lawn / feature tree
- 6 Red tiled retaining wall
- 7 Feature paving / radial banding
- 8 Mass planting / formal hedge
- 9 Formal tree planting
- 10 Dense buffer planting
- 11 Concrete footpath

- Feature Park trees (*Quercus palustris*)
- Screening Tree (*Fraxinus oxycarpus* 'Raywood')
- Formal Planting (*Pyrus calleryana* 'Chanticleer')

#### MATERIALS

- CO - Concrete Paths
- XC - Lightly Exposed Concrete Paths
- PP - Natural Stone Paving / banding
- RC - Red ceramic tiles





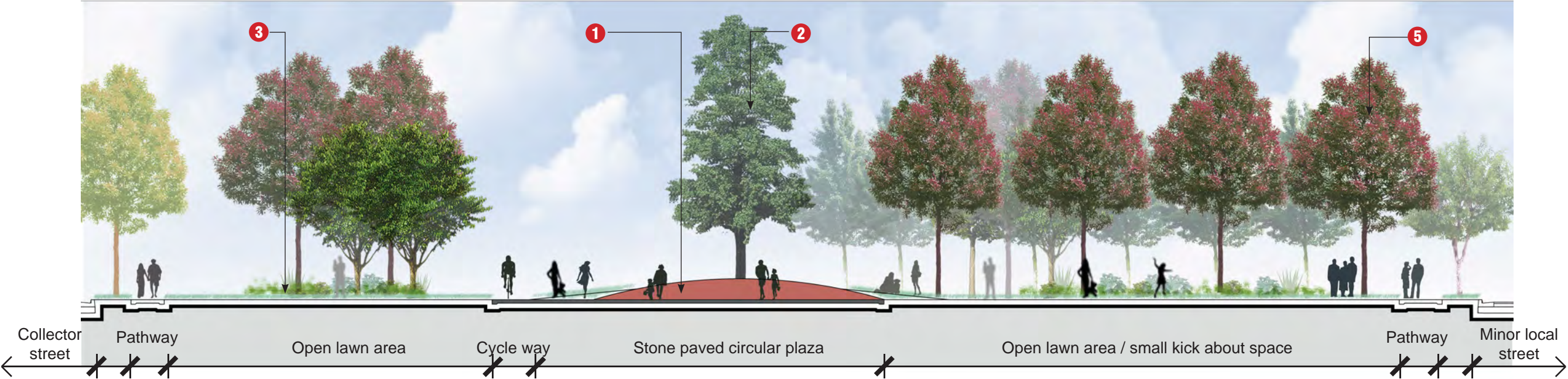

SECTION AA

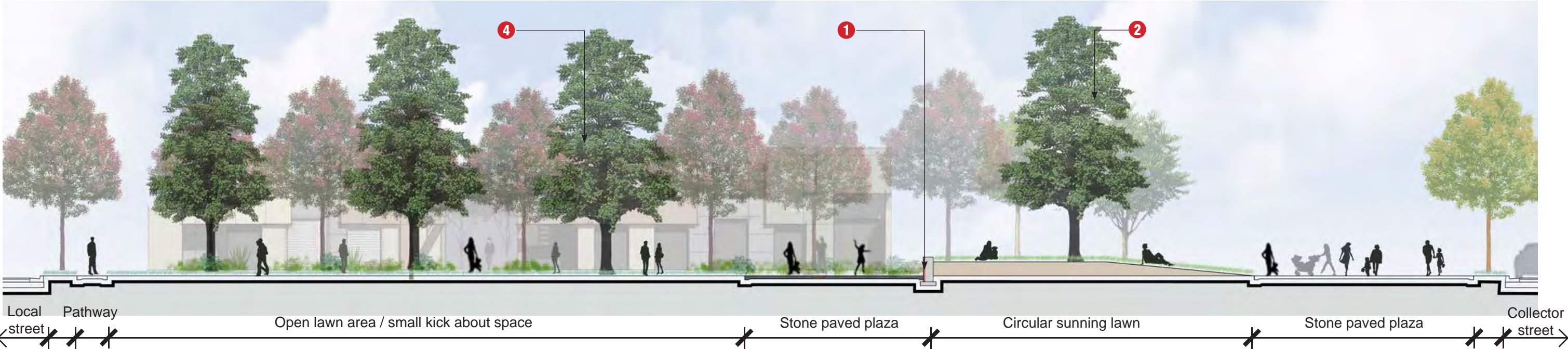

SECTION BB

LEGEND

- 1 Red tiled retaining wall
- 2 Large feature tree
- 3 Mass planting / buffer planting
- 4 Large Park feature trees
- 5 Park trees

SCALE 1:200 @ A3





## 4.0 COREEN AVENUE ENTRY

### General Character:

The developments main entry and key boulevard is located along Coreen Avenue and lies almost due north of the Smiths Paddock. From a functional point of view the entry has been designed to allow for the ingress and egress of Australian Defence Force vehicles and connecting public bus services within the site. From an aesthetic and marketing view point the landscape design was developed to ensure that the development is warm, welcoming and projects a distinct lack of visual exclusivity that may otherwise deter access to the greater community. Landcom's strategy in this instance is to provide a subtle and incorporated entrance statements that is not intended alienate or give the impression of exclusion. Set amongst the rich tapestry of low formal planting sits subtle low signage wall that relates directly to the site branding and heritage content of the site.

The entry boulevard will be defined by three rows of large street tree planting contained within the verges and central median strip. This subtle approach is designed to signal the entry point to the development rather than the over use of ostentation signage that is more in tune to promoting a brand rather than a place.

This design is meant to be a more appropriate response that meets the needs of the development and client.

### Aspect and Views

- Use of structured plantings of landmark trees to maintain and enhance view corridors from Coreen Avenue and from within the site.
- Low planting to the entry provide for both internal and external vehicle site lines and resulting safe traffic conditions.

### Accessibility

- Accessible paths linking the entry road to the remainder of the development site
- Pedestrian and cycle way access along the boulevard provides connections to council pedestrian pathway networks.

### Materials:

- Predominantly robust contemporary materials such as concrete block work walls clad with natural stone or red ceramic tiles, cast in-situ concrete pavements combined with the embellishments of natural materials such as porphyry stone setts within the mountable sections of the central median. In this way the character of the park will be reflected through the choice of materials without dissolving it from the overall design materials utilised through out the remainder of the development.

### Plantings:

- Landmark canopy trees to provide shade, dappled light and visual amenity.
- Understory planting using low maintenance plant species.

### WSUD Elements:

- Bio-filtration swale to the central median strip to improve water quality at the source prior to further treatment and storage.

### Ecological:

- The Ecological assessment of this proposed open space area is identified as being dominated Cumberland Plain Woodland.

### Community/Recreational:

- Visual point of difference from existing industrial streetscape / Entry Statement
- Pedestrian/cycle links to the rest of the site





## 4.1 - COREEN AVENUE ENTRY LANDSCAPE CONCEPT PLAN

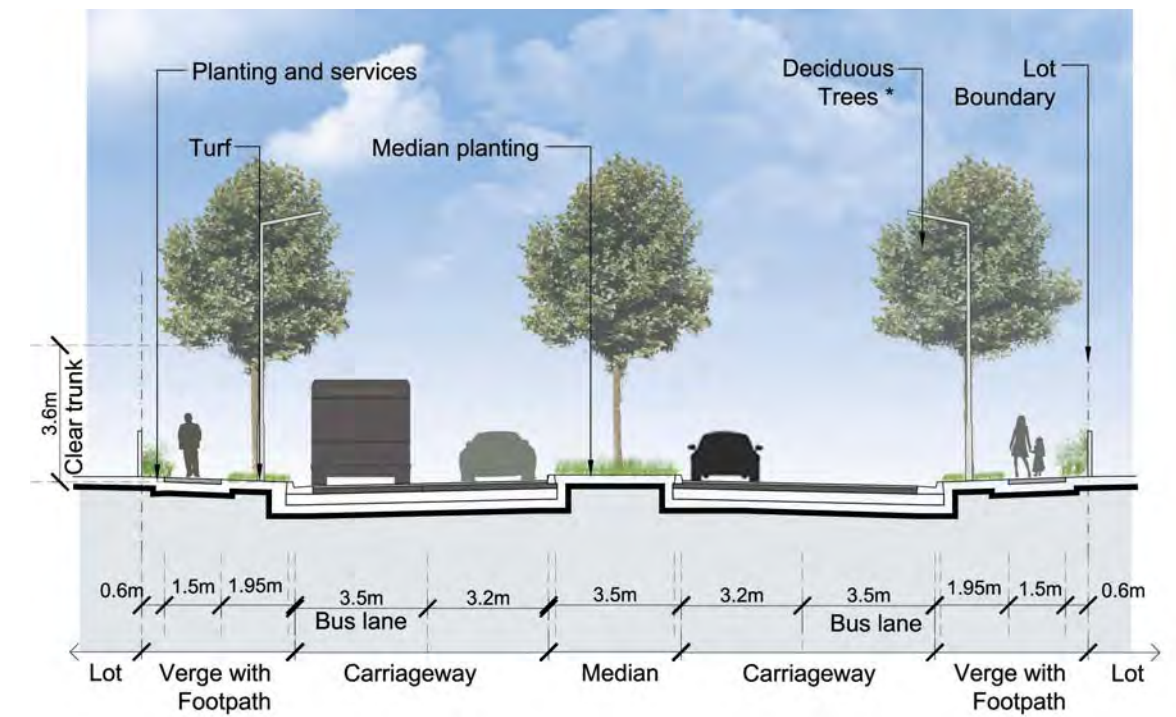
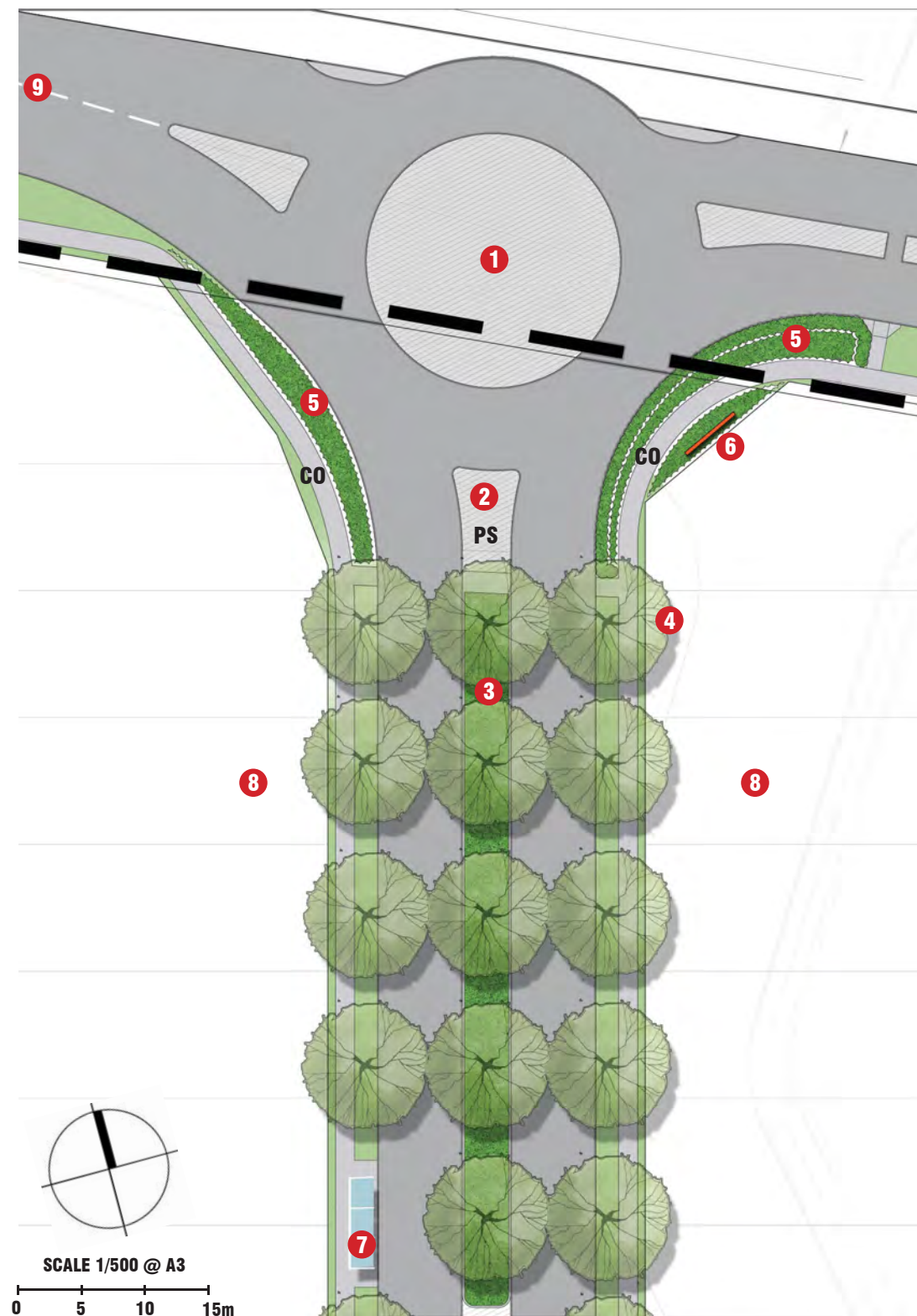

### MAIN ENTRY ROAD - BOULEVARD ENTRY (SECTION)

### LEGEND

- 1 Mountable Concrete Roundabout
- 2 Mountable Concrete / Stone Median
- 3 Raised & Planted Central Median
- 4 Triple Row of Street Trees to signify entry to Sydney Smith Drive
- 5 Low mass planting to signify entry point
- 6 Low Signage Wall in mass planting
- 7 Bus Stop
- 8 Residential Lots
- 9 Coreen Avenue
- Avenue trees (*Platanus x hybrida*)

### MATERIALS

- CO - Concrete Paths
- PS - Porphyry Stone setts





# 5.0 - TYPICAL STREETScape KEY PLAN



KEY PLAN - STREETScape TYPOLOGIES





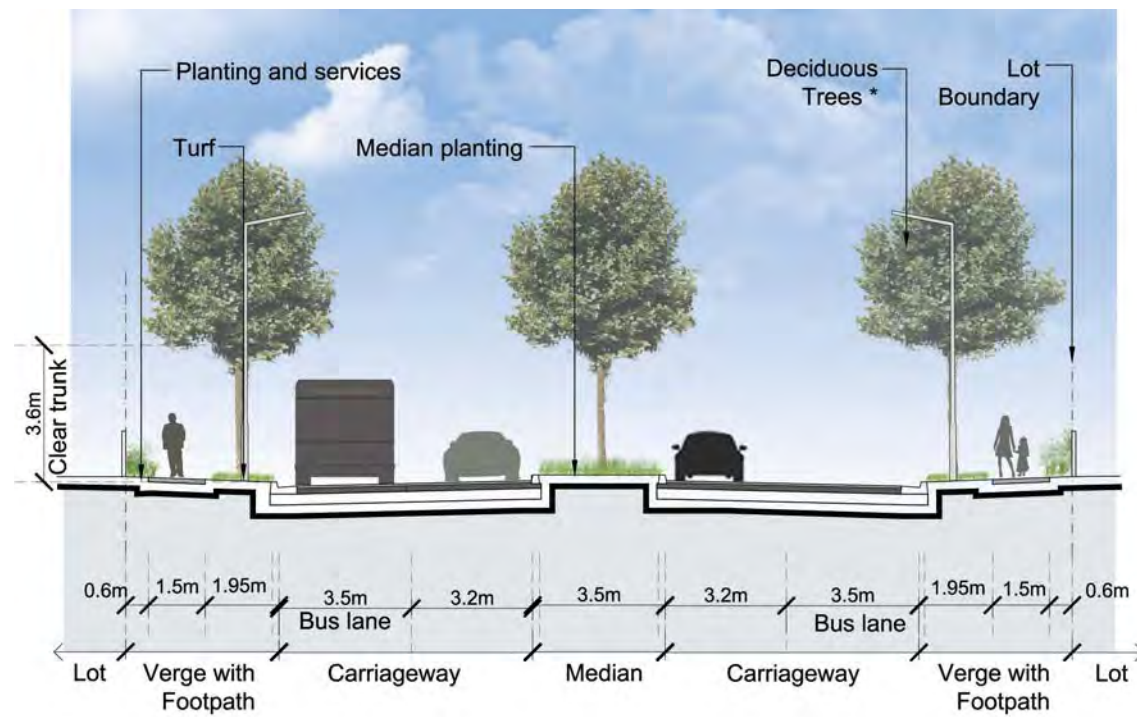

**MAIN ENTRY ROAD - BOULEVARD ENTRY (SECTION 1)**

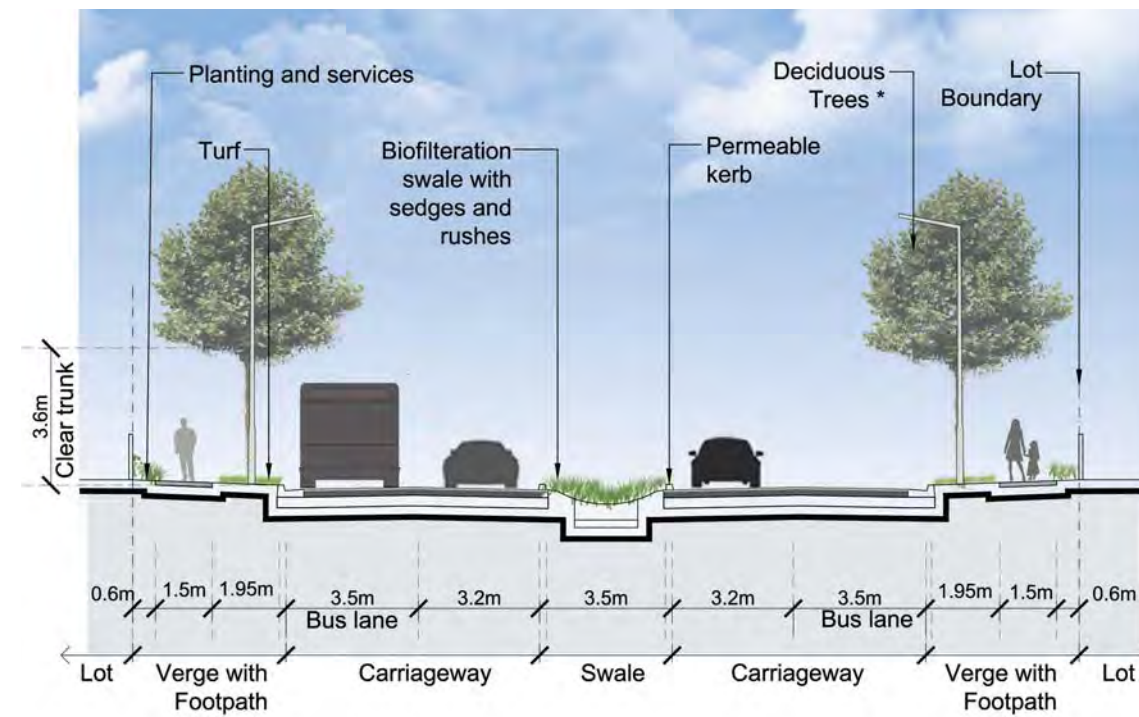

**MAIN ENTRY ROAD - BOULEVARD WSUD (SECTION 1a)**

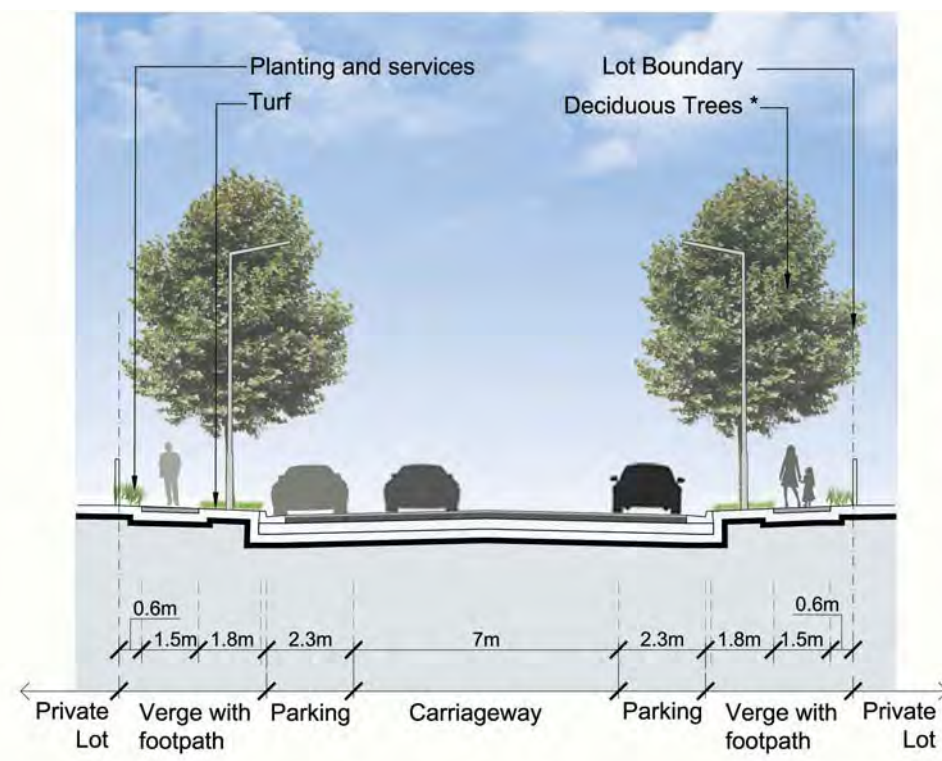

**COLLECTOR STREET (SECTION 2)**

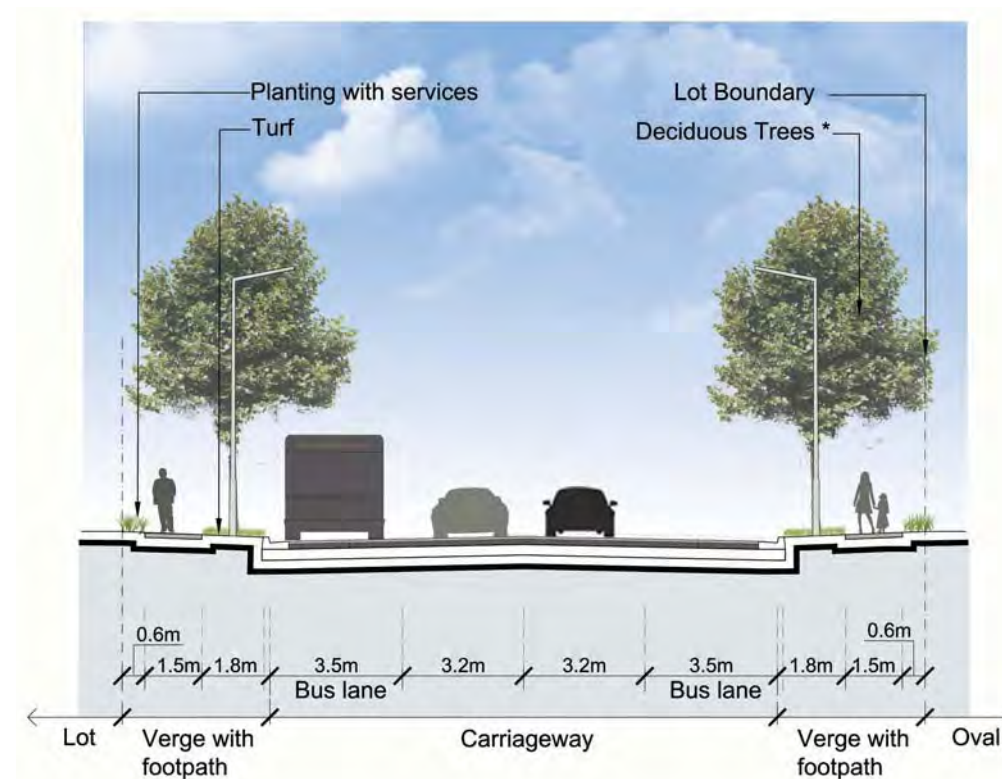

**COLLECTOR STREET - WITH BUS CORRIDOR (SECTION 3)**

Note \* Refer to streetscape planting plan

