

# 14-18 BOONDAH ROAD - Warriewood

## Stage 1 Development Application

# CONTENTS

LA000	Title Sheet
LA101	Landscape Masterplan - Landscape Vegetation Plan
LA102	Landscape Masterplan - Landscape Management Zones
LA103	Stage 1 - Detail Plan 01
LA104	Stage 1 - Detail Plan 02
LA201	Landscape Elevations
LA301	Landscape Details 01
LA302	Landscape Details 02

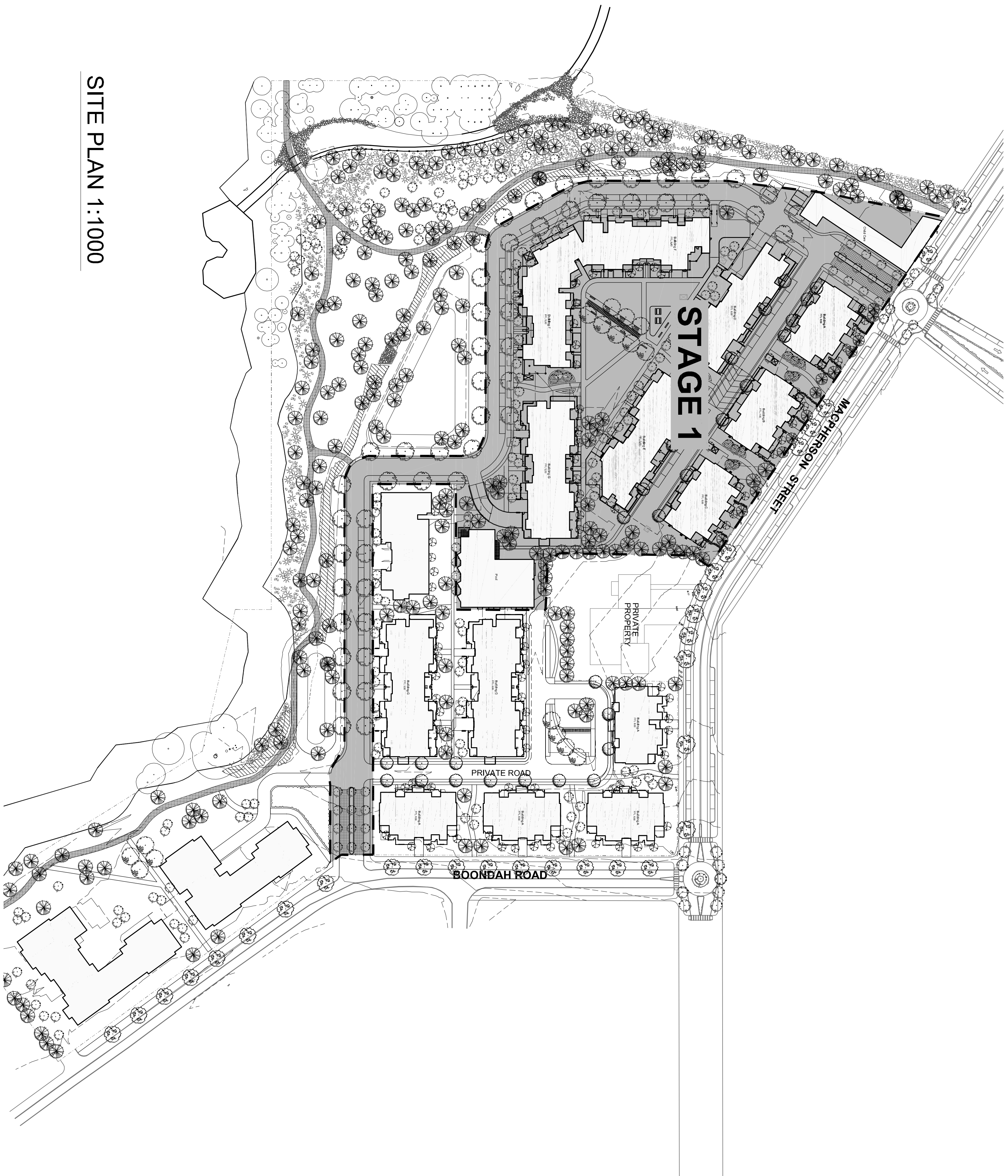

SITE PLAN 1:1000

Researcher	Research Description	DM	DD	Time	Place
1	Prevalence of	1978	1978	10	India
2	Prevalence of	1978	1978	10	India
3	Prevalence of	1978	1978	10	India
4	Prevalence of	1978	1978	10	India
5	Prevalence of	1978	1978	10	India
6	Prevalence of	1978	1978	10	India
7	Prevalence of	1978	1978	10	India
8	Prevalence of	1978	1978	10	India
9	Prevalence of	1978	1978	10	India
10	Prevalence of	1978	1978	10	India
11	Prevalence of	1978	1978	10	India
12	Prevalence of	1978	1978	10	India
13	Prevalence of	1978	1978	10	India
14	Prevalence of	1978	1978	10	India
15	Prevalence of	1978	1978	10	India
16	Prevalence of	1978	1978	10	India
17	Prevalence of	1978	1978	10	India
18	Prevalence of	1978	1978	10	India
19	Prevalence of	1978	1978	10	India
20	Prevalence of	1978	1978	10	India
21	Prevalence of	1978	1978	10	India
22	Prevalence of	1978	1978	10	India
23	Prevalence of	1978	1978	10	India
24	Prevalence of	1978	1978	10	India
25	Prevalence of	1978	1978	10	India
26	Prevalence of	1978	1978	10	India
27	Prevalence of	1978	1978	10	India
28	Prevalence of	1978	1978	10	India
29	Prevalence of	1978	1978	10	India
30	Prevalence of	1978	1978	10	India
31	Prevalence of	1978	1978	10	India
32	Prevalence of	1978	1978	10	India
33	Prevalence of	1978	1978	10	India
34	Prevalence of	1978	1978	10	India
35	Prevalence of	1978	1978	10	India
36	Prevalence of	1978	1978	10	India
37	Prevalence of	1978	1978	10	India
38	Prevalence of	1978	1978	10	India
39	Prevalence of	1978	1978	10	India
40	Prevalence of	1978	1978	10	India
41	Prevalence of	1978	1978	10	India
42	Prevalence of	1978	1978	10	India
43	Prevalence of	1978	1978	10	India
44	Prevalence of	1978	1978	10	India
45	Prevalence of	1978	1978	10	India
46	Prevalence of	1978	1978	10	India
47	Prevalence of	1978	1978	10	India
48	Prevalence of	1978	1978	10	India
49	Prevalence of	1978	1978	10	India
50	Prevalence of	1978	1978	10	India
51	Prevalence of	1978	1978	10	India
52	Prevalence of	1978	1978	10	India
53	Prevalence of	1978	1978	10	India
54	Prevalence of	1978	1978	10	India
55	Prevalence of	1978	1978	10	India
56	Prevalence of	1978	1978	10	India
57	Prevalence of	1978	1978	10	India
58	Prevalence of	1978	1978	10	India
59	Prevalence of	1978	1978	10	India
60	Prevalence of	1978	1978	10	India
61	Prevalence of	1978	1978	10	India
62	Prevalence of	1978	1978	10	India
63	Prevalence of	1978	1978	10	India
64	Prevalence of	1978	1978	10	India
65	Prevalence of	1978	1978	10	India
66	Prevalence of	1978	1978	10	India
67	Prevalence of	1978	1978	10	India
68	Prevalence of	1978	1978	10	India
69	Prevalence of	1978	1978	10	India
70	Prevalence of	1978	1978	10	India
71	Prevalence of	1978	1978	10	India
72	Prevalence of	1978	1978	10	India
73	Prevalence of	1978	1978	10	India
74	Prevalence of	1978	1978	10	India
75	Prevalence of	1978	1978	10	India
76	Prevalence of	1978	1978	10	India
77	Prevalence of	1978	1978	10	India
78	Prevalence of	1978	1978	10	India
79	Prevalence of	1978	1978	10	India
80	Prevalence of	1978	1978	10	India
81	Prevalence of	1978	1978	10	India
82	Prevalence of	1978	1978	10	India
83	Prevalence of	1978	1978	10	India
84	Prevalence of	1978	1978	10	India
85	Prevalence of	1978	1978	10	India
86	Prevalence of	1978	1978	10	India
87	Prevalence of	1978	1978	10	India
88	Prevalence of	1978	1978	10	India
89	Prevalence of	1978	1978	10	India
90	Prevalence of	1978	1978	10	India
91	Prevalence of	1978	1978	10	India
92	Prevalence of	1978	1978	10	India
93	Prevalence of	1978	1978	10	India
94	Prevalence of	1978	1978	10	India
95	Prevalence of	1978	1978	10	India
96	Prevalence of	1978	1978	10	India
97	Prevalence of	1978	1978	10	India
98	Prevalence of	1978	1978	10	India
99	Prevalence of	1978	1978	10	India
100	Prevalence of	1978	1978	10	India

© 2010 Site Image Pty Ltd A.B.N. 19 078 651 087. All rights reserved. This document is copyright and shall not be reproduced or copied in any form or by any means (graphic, electronic, or mechanical including photocopying) without the written permission of Site Image Pty Ltd. Any borrow, expressed or implied, to use this document for any purpose what so ever is restricted to the terms of the written agreement between Site Image Pty Ltd and the instructing party.

others) before commencing the landscape installation. Any discrepancies are to be reported to the Project Manager or Landscape Architect prior to commencing work. Do not scale this drawing. Any required clarifications not shown shall be referred to the Landscape Architect for confirmation.

**S I T E I M A G E**



Landscape Architects

15 Gillebone Street  
East Melbourne VIC 3002  
Australia

Tel: (61 3) 9662 1947  
Fax: (61 3) 9662 2447  
Web: [www.salamag.com.au](http://www.salamag.com.au)  
Sala Image Pty Ltd  
ABN 19 076 561 007

PRELIMINARY

# Title Sheet

Scale: 1:1000 @ A0		
Date: 07.02.2010		
Driver: DM	Approved:	DC
Job Number: SM10041	Drawing Number: LA000	Issue: A