

**NOTES:**

LOTS 9,25,26,34-36,38-43,45-47 & 49 DP 115128  
NOT OWNED BY COAL AND ALLIED

 LOTS 710 & 711 DP 1113237  
14.73 Ha

 LOT 48 DP 115128  
0.05 Ha

 LOT 712 DP 1113237  
277.96 Ha (Excl. Roads)

 LOT 351 DP1108608  
40.2 Ha

 LOT 6 DP 1044574  
11.12 Ha

 PT 2 DP 877349  
160.8 Ha (Excl. Roads)

 LOT 3 DP 877349  
101.2 Ha

 LOT 1 DP 1007615  
146.7 Ha

**STOCKRINGTON**

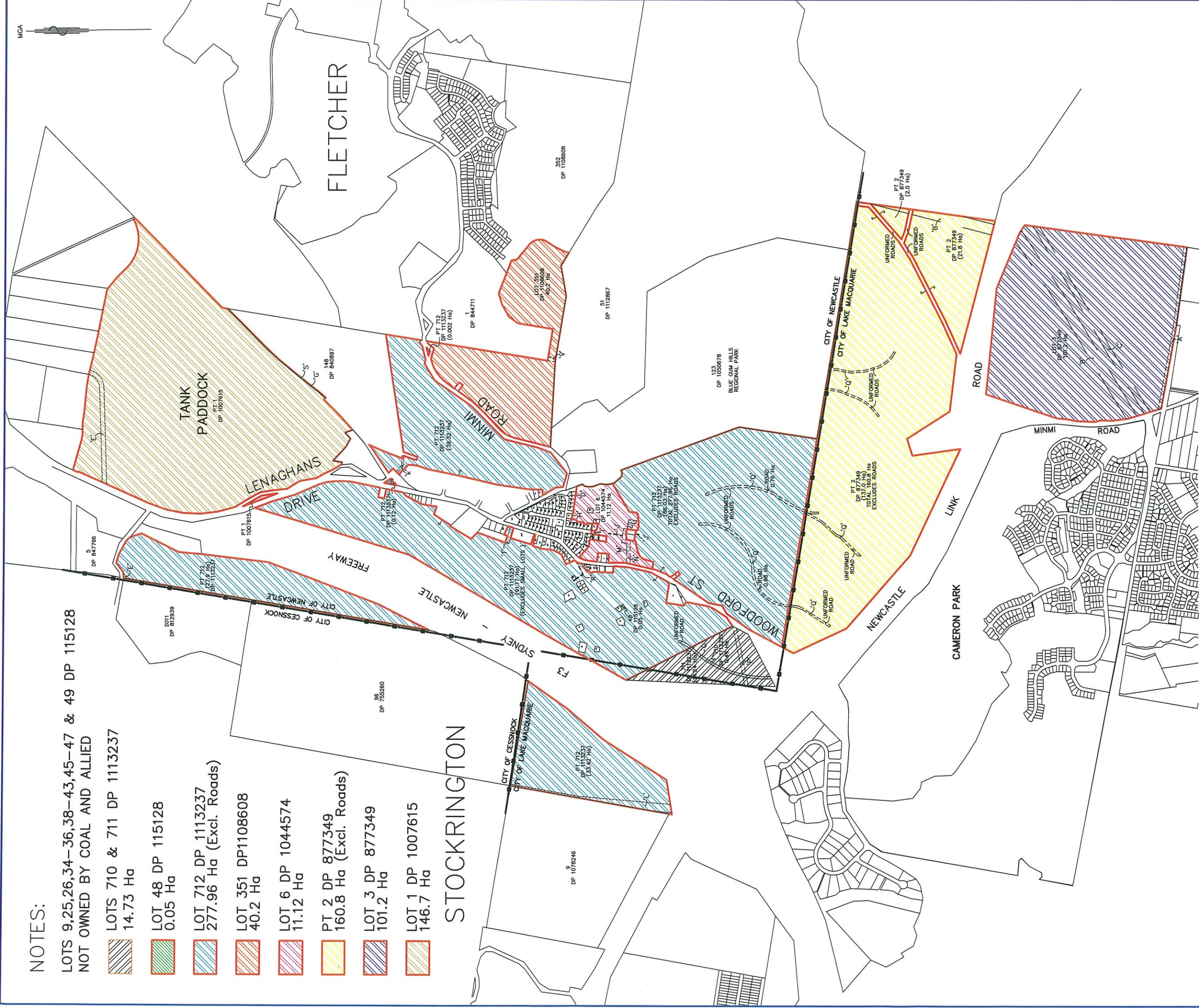

- 'A' PROPOSED EASEMENT FOR TRANSMISSION LINE AND ACCESS THERETO 15 WIDE (DP 646525)
- 'B' PROPOSED EASEMENT FOR TRANSMISSION LINE 60 WIDE (DP 645649)
- 'C' EASEMENT FOR TRANSMISSION LINE 30.48 WIDE VIDE SEE BOOK 2617 NO. 441 GAZETTE OF 3-5-1957 VOL.50 FOL.1377
- 'D' EASEMENT TO DRIAN WATER 2 WIDE (DP 840897)
- 'E' EASEMENT FOR PIPELINE 24.385 WIDE (DP499013 SH9)
- 'G' EASEMENT FOR PIPELINE 3.06 WIDE - CONV. NO.732 BK.1954 GAZ. OF 15-2-1980 FOL.703
- 'H' EASEMENT FOR ELECTRICITY SUBSTATION AND UNDERGROUND CABLES 2.5 WIDE (DP 840897)
- 'I' RIGHT OF WAY 15 AND 20.115 WIDE (DP 577710)
- 'J' EASEMENT FOR PIPELINE 3.06 WIDE VIDE CONV.NO.732 BK.1954
- 'K' RIGHT OF CARRIAGEWAY 10 WIDE (Y130400)
- 'L' EASEMENT FOR TRANSMISSION LINE 45.72 WIDE & VARIABLE GAZ. NO.30 OF 18-3-1966 FOL.1181 - 0268489

- 'M' RIGHT OF CARRIAGEWAY 20.115 WIDE & VARIABLE (DP 840897)
- 'N' RIGHT OF CARRIAGEWAY 20.115 WIDE VIDE CONV.NO.754 BK.2912
- 'P' EASEMENT FOR PIPELINE 10.06 WIDE - CONV. NO.732 BK.1954
- 'Q' RESERVED ROAD 10.06 WIDE (R8139-1603)
- 'R' Y.125177 - RIGHT OF CARRIAGEWAY & EASEMENT FOR WATERMAIN, SEWERMAIN & POWERLINE 4 & 3.67 WIDE (DP 785009)
- 'S' EASEMENT FOR PIPELINE 1.525 WIDE & VARIABLE - CONV.NO.803 BK.3185
- 'T' RIGHT OF CARRIAGEWAY - CONV. NO.555 BK.2095 (DP157344)
- 'Y' RIGHT OF CARRIAGEWAY AND EASEMENT 20.115 WIDE (TRANSFERS C136521 & B17280)

<p><b>REVISIONS</b></p> <table border="1"> <thead> <tr> <th>No.</th> <th>Revision</th> <th>Date</th> </tr> </thead> <tbody> <tr> <td> </td> <td> </td> <td> </td> </tr> </tbody> </table>		No.	Revision	Date				<p>Copyright Notice: This document remains the property of Monteath &amp; Powys Pty Ltd. CONDITIONS OF USE: THIS DOCUMENT MAY ONLY BE USED BY THE CLIENT FOR THE PURPOSE FOR WHICH IT WAS COMMISSIONED. ALL RIGHTS RESERVED. UNLESS OTHERWISE STATED, NO PART OF THIS DOCUMENT MAY BE REPRODUCED OR TRANSMITTED IN ANY FORM OR BY ANY MEANS, ELECTRONIC OR MECHANICAL, INCLUDING PHOTOCOPYING, RECORDING OR BY ANY INFORMATION STORAGE AND RETRIEVAL SYSTEM.</p>	
No.	Revision	Date							
<p>APPROVED PLAN SS 21109 B/C 41108</p>		<p>125 Dal Street Newcastle NSW 2300 PO Box 278 Newcastle NSW 2300 E: mtp@monteathpowys.com.au W: www.monteathpowys.com.au</p>							
<p>Surveyed Drawn SS Checked M&amp;P</p>		<p>Client Title CAD File: 07202at.dwg Ref No: 07/202 Date: 4 NOVEMBER 2008</p>							
<p>Scale: ①A1: 1:10 000 Original Size</p>		<p>COAL AND ALLIED MINIMI LAND HOLDINGS PLAN</p>							
<p>DO NOT SCALE A1</p>		<p>Sheet No. 1/1 Revision B</p>							