



planning consultants

ATTACHMENT 3

David Kettle

From: Nathan Murray [NMurray@transelect.com.au]
Sent: Tuesday, 24 November 2009 2:52 PM
To: Peter Freckelton
Cc: Mark Klein
Subject: Bayswood Estate - preliminary advice request for Stage 3 electricity Asset Relocation
Attachments: 25606_001_Draft Draft Option 1 (1).pdf

Peter,

Transelect have been engaged by Cardno Forbes Rigby Pty Ltd (on behalf of Stockland Development Pty Ltd) to investigate possible options for continuing the relocation of the 2 x 33kV and 4 x 11kV feeders along Naval College Rd. These preliminary works are associated with the next phase of Stockland's Bayswood development along the western precinct.

Essentially we wish to establish a dual 33/11kV feeder on each side of Naval College Rd.

- Feeders 7521 & HKB2 would be relocated to the southern side of Naval College Rd, and feeders 7519 & HKE2 would be constructed along the northern side of Naval College Rd.
- A nominal 28m wide easement would be proposed - 10m between feeders and 9m each side of feeder where installed on private land (where required).
- New poles would be offset a minimum 9m from lot boundaries, such that the associated easement does not encroach on private land.
- A 10m spacing would be maintained between the two 33/11kV feeders.

What we require from Integral Energy at this stage is advice as to the best way forward in terms of Integral providing a preliminary acceptance of our proposal. Stockland does not wish to submit the formal application for asset relocation at this stage, as the development of the western precinct is yet to be finalised, however Stockland does wish to obtain Integral's in principal agreement of the design approach in order to proceed with certainty the negotiations with the Department of Planning on layout amendments to the western precinct.

A rough sketch is attached for your reference. The pole spacings are indicative at this stage, but are sufficient to give you an idea.

Please advise.

Nathan Murray

Principal Design Engineer

Transelect – *INNOVATIVE POWER SOLUTIONS*

18 Investigator Drive (PO Box 657) Unanderra NSW 2526

P: 02 4272 2811 | **F:** 02 4272 1773 | **M:** 0417 682 118

E: nmurray@transelect.com.au | **W:** www.transelect.com.au

This email and any files transmitted with it are confidential and intended solely for the use of the individual or entity to whom they are addressed. If you have received this email in error please notify the system manager. Please note that any views or opinions presented in this email are solely those of the author and do not necessarily represent those of the company. Finally, the recipient should check this email and any attachments for the presence of viruses. The company accepts no liability for any damage caused by any virus transmitted by this email.

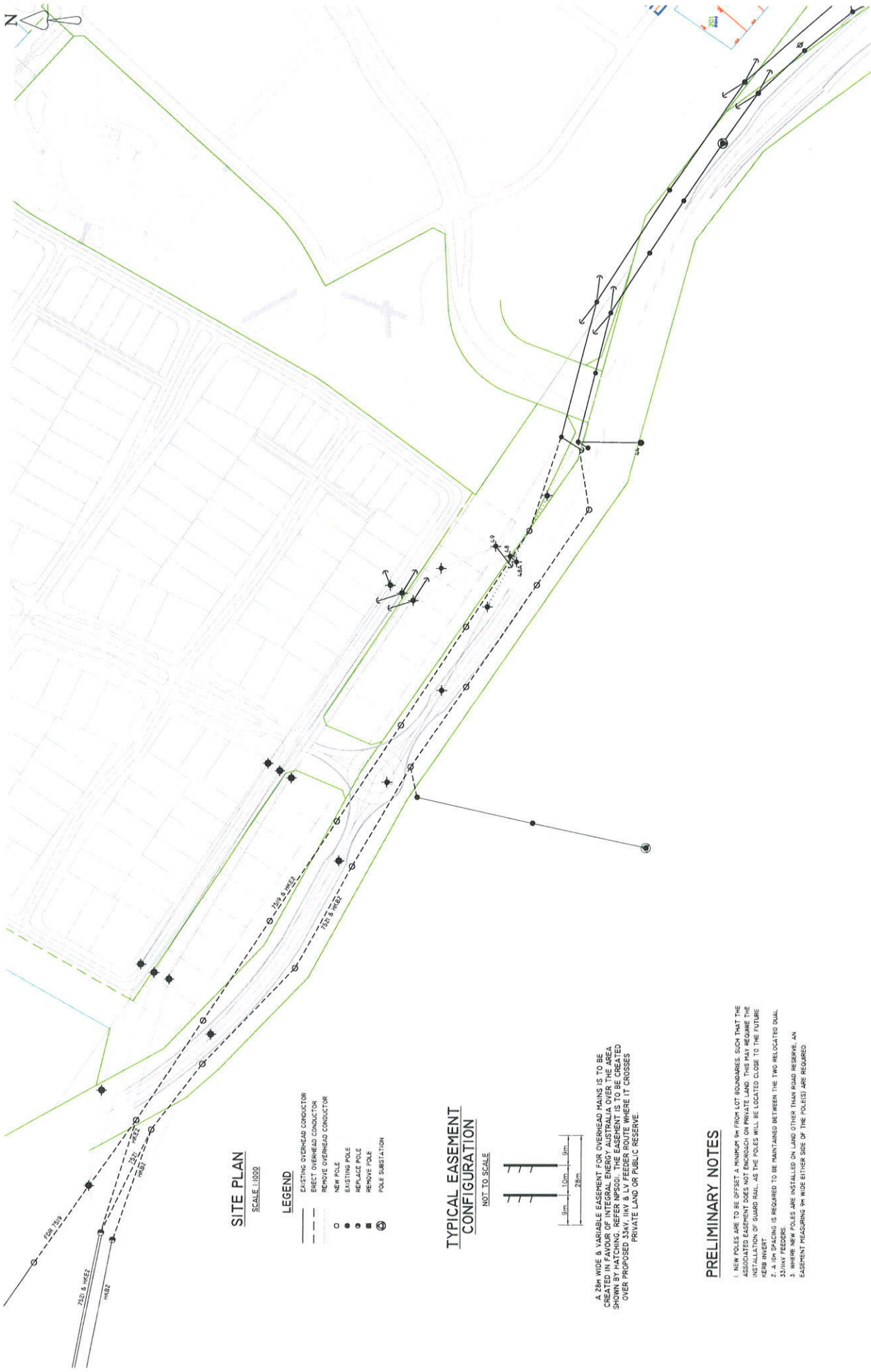

SITE PLAN
SCALE 1:1000

- LEGEND**
- EXISTING OVERHEAD CONDUCTOR
 - PROPOSED OVERHEAD CONDUCTOR
 - NEW POLE
 - EXISTING POLE
 - REPLACE POLE
 - ⊙ REMOVE POLE
 - ⊙ POLE SUBSTATION

TYPICAL EASEMENT CONFIGURATION
NOT TO SCALE

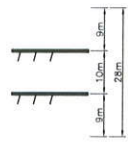

A 28M WIDE & VARIABLE EASEMENT FOR OVERHEAD MAINS IS TO BE CREATED IN FAVOUR OF INTEGRAL ENERGY AUSTRALIA OVER THE AREA SHOWN BY HATCHING. REFER NPS01. THE EASEMENT IS TO BE CREATED OVER PROPOSED 33KV HV & LV FEEDER ROUTE WHERE IT CROSSES PRIVATE LAND OR PUBLIC RESERVE.

PRELIMINARY NOTES

1. NEW POLES ARE TO BE OFFSET A MINIMUM 9M FROM LOT BOUNDARIES, SUCH THAT THE INDICATED EASEMENT DOES NOT ENOUGH ON PRIVATE LAND. THIS MAY REQUIRE THE USE OF GUARD RAIL, AS THE POLES WILL BE LOCATED CLOSE TO THE FUTURE KEEP INERT.
2. A 0M SPACING IS REQUIRED TO BE MAINTAINED BETWEEN THE TWO RELOCATED DUAL 33/11KV FEEDERS.
3. WHERE NEW POLES ARE INSTALLED ON LAND OTHER THAN ROAD RESERVE, AN EASEMENT MEASURING 9M WIDE EITHER SIDE OF THE POLE(S) ARE REQUIRED.

AMENDMENTS	A	ORIGINAL ISSUE
<h1>DRAFT OPTION 1</h1>		
THIS DRAWING AND DESIGN IS THE PROPERTY OF TRANSSELECT AUSTRALIA PTY LTD. ANY UNAUTHORIZED REPRODUCTION OR DISSEMINATION OF THIS DRAWING TO ANY THIRD PARTY WITHOUT THE WRITTEN AUTHORITY FROM TRANSSELECT AUSTRALIA PTY LTD. IS PROHIBITED.		
PROJECT NO.	25606	A01
FILE NO.	25606-01-01	
USE MAP NO.		
HY SWITCHING	X	
D/F MAINS	X	
LV MAINS	X	
SUBSTATIONS	X	
DO NOT SCALE		
DIMENSIONS IN METRES		
MAP AS REF AX		
LG AREA		
WOLLONGONG		
REGION		
SOUTHERN		
HY OF ROAD		
ORIGINAL SCALE	1:1000	
DESIGN	N.H.	
DRAWN	N.H.	
CIP	N.H.	
DATE	04/11/09	
BAYSWOOD ESTATE VINCENTIA STAGE 3 ASSET RELOCATION 33KV FDR 7521 & 7519		
INTERNAL DRAWING ???????		
A1		
SHEET NO. 1 OF 1 SHEETS		