



Network Protection



In reply to your enquiry, there are gas mains at the location of your intended work as per the attached map. For an explanation of the map, please see the key below. The following excavation guidelines apply:

Excavation Guidelines:

If you are going to excavate/bore within 0.4m of the gas main location as indicated on the map you must excavate carefully by hand. If you can't locate the gas main, contact the local depot.

Sydney South (02) 9397 9289
Wollongong (02) 9397 9289

MAXIMUM ALLOWABLE OPERATING PRESSURE		KEY	
—T—	TRUNK MAIN 7000 kPa		VALVE
—P—	PRIMARY MAIN 3500 kPa		SYSTEM PRESSURE REGULATOR
—S—	SECONDARY MAIN 1050 kPa		SIPHON
----	300 kPa	6NB	6 INCH CAST IRON MAIN
----	210 kPa	150MM	150MM STEEL MAIN
----	7 kPa	110MM PE/NY	110MM POLYETHYLENE / NYLON MAIN
-400-	400 kPa	⑥ NB 50MM NY	50MM NYLON INSERTED INTO
-100-	100 kPa		6 INCH CAST IRON MAIN
-30-	30 kPa	1.2MBL	DISTANCE IN METRES OF MAIN FROM BUILDING LINE (TOLERANCE OF 0.4M)
----	2 kPa		HOUSE NUMBERS
---> PROPOSED MAINS			NETWORK BOUNDARY
			NETWORK NODES

Warning: This company's plans show the position of its underground gas mains and installations in public gazetted roads only, individual customers services are not included on these plans. These plans have been prepared solely for the Companies own use and may show the position of such underground mains and installations relative to fences, buildings etc., as at the time the mains etc were installed and not necessarily corrected to take account of any subsequent change in particular. Agility will accept no liability for inaccuracies in the information or lack of information on such plans for any cause whatsoever arising. Persons excavating or carrying out other earthworks will be held responsible for any damage caused to the Companies underground mains and equipment.

In case of Emergency Phone 131 909 (24 hours)

Dianita
9397 9407
1300 725 905



Network Protection

In reply to your enquiry, there is **High Pressure Gas Mains** at the location of your intended work as per the attached map. For an explanation of the map, please see the key below. The following excavations guidelines apply:

Excavation Guidelines:

You must contact a Pipeline Patrol Officer **before** commencing any work in this area. If you have not already been contacted, you can arrange a survey, which is free, by contacting the High Pressure Response Coordinator on **1300 665 380**. *(Please note that two working days notice is required to arrange a survey).*

MAXIMUM ALLOWABLE OPERATING PRESSURE			KEY	
—T—	TRUNK MAIN	7000 kPa		VALVE
—P—	PRIMARY MAIN	3500 kPa		SYSTEM PRESSURE REGULATOR
—S—	SECONDARY MAIN	1050 kPa		SIPHON
----		300 kPa	6NB	6 INCH CAST IRON MAIN
----		210 kPa	150MM	150MM STEEL MAIN
----		7 kPa	110MM PE/NY	110MM POLYETHYLENE / NYLON MAIN
-400-		400 kPa	⑥ NB 50MM NY	50MM NYLON INSERTED INTO
-100-		100 kPa		6 INCH CAST IRON MAIN
-30-		30 kPa	1.2MBL	DISTANCE IN METRES OF MAIN FROM
----		2 kPa		BUILDING LINE (TOLERANCE OF 0.4M)
- - - ->	PROPOSED MAINS			HOUSE NUMBERS
				NETWORK BOUNDARY
				NETWORK NODES

Warning: This company's plans show the position of its underground gas mains and installations in public gazetted roads only, **individual customers services are not included** on these plans. These plans have been prepared solely for the Companies own use and may show the position of such underground mains and installations relative to fences, buildings etc., as at the time the mains etc were installed and not necessarily corrected to take account of any subsequent change in particular. Agility will accept no liability for inaccuracies in the information or lack of information on such plans for any cause whatsoever arising. Persons excavating or carrying out other earthworks will be held responsible for any damage caused to the Companies underground mains and equipment.

In case of Emergency Phone 131 909 (24 hours)

Dianita
9397 9407
1300 725 905

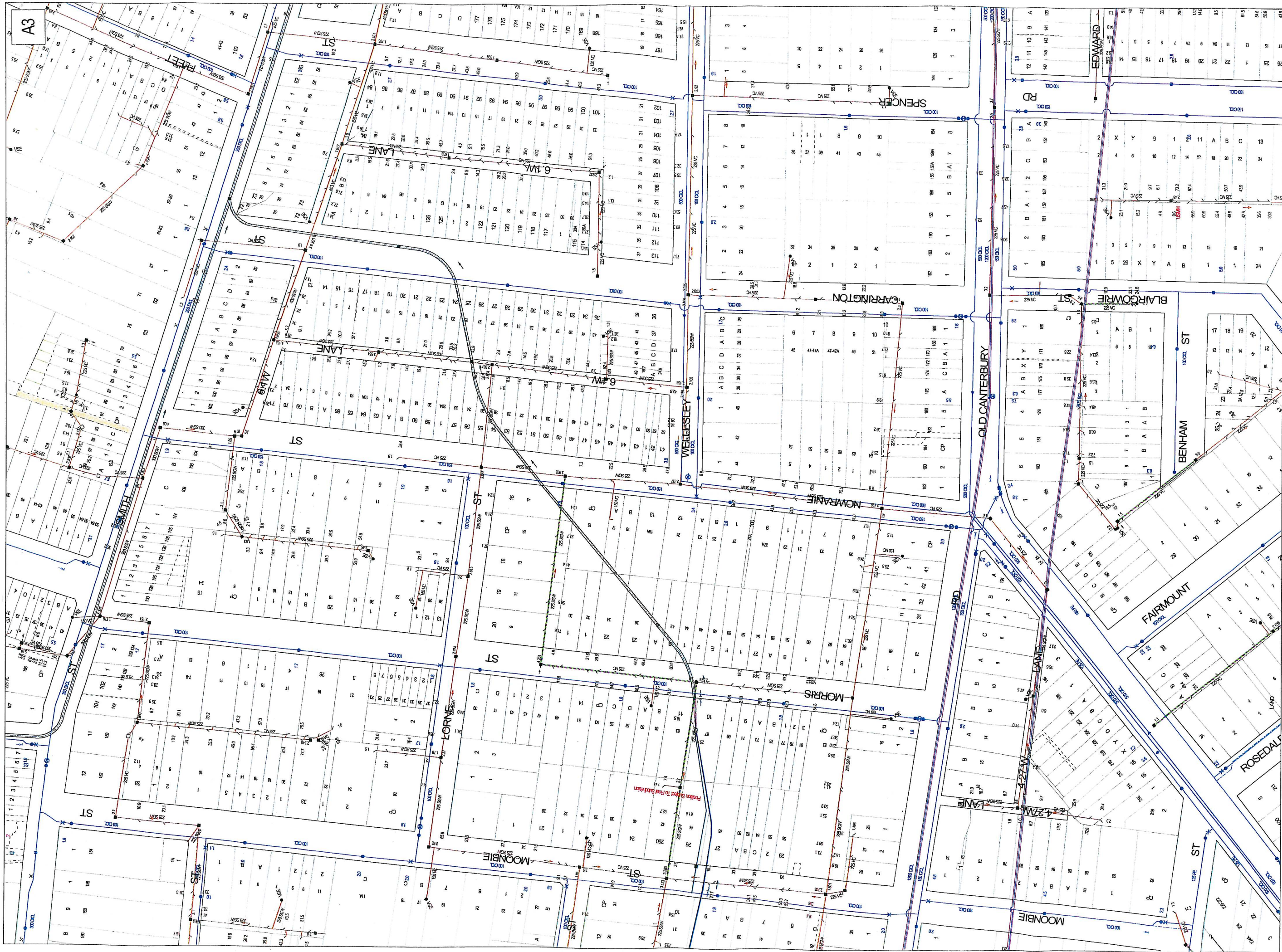

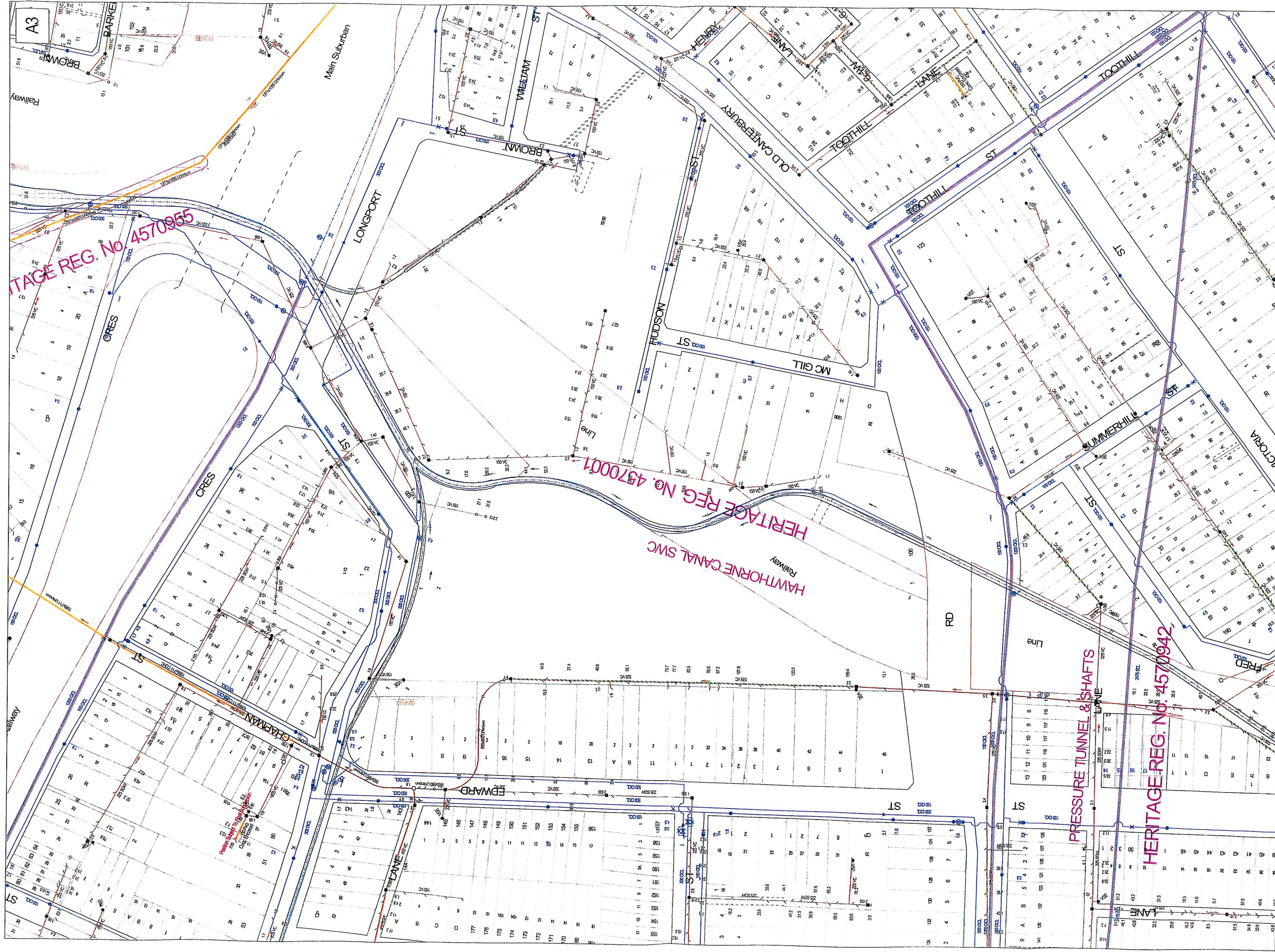

DBYD Address:
Edward St And Smith St
Summer Hill NSW 2130

DBYD Job No: 43495

DBYD Sequence No: 13050242

Copyright Reserved Sydney Water 2008

No warranty is given that the information shown is complete or accurate.

SYDNEY WATER CORPORATION

Scale: 1:1500

Date of Production: 09/01/2008

Plan 2 of 3



A3

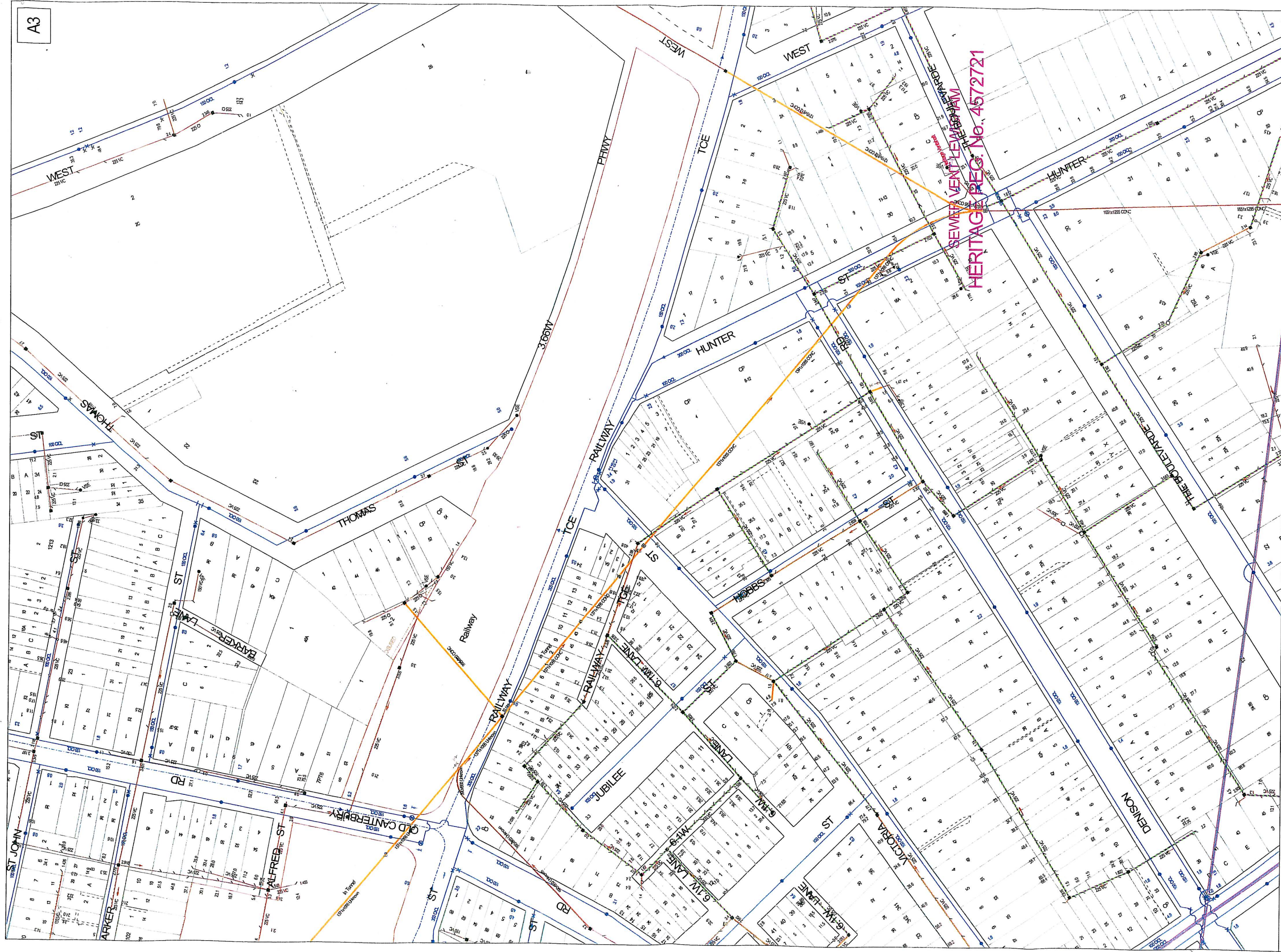

DBYD Address:
Edward St And Smith St
Summer Hill NSW 2130

DBYD Job No: 43495
DBYD Sequence No: 13050242

Copyright Reserved Sydney Water 2008
No warranty is given that the information shown is complete or accurate.
SYDNEY WATER CORPORATION

Scale: 1:1500

Date of Production: 09/01/2008

Plan 3 of 3

