

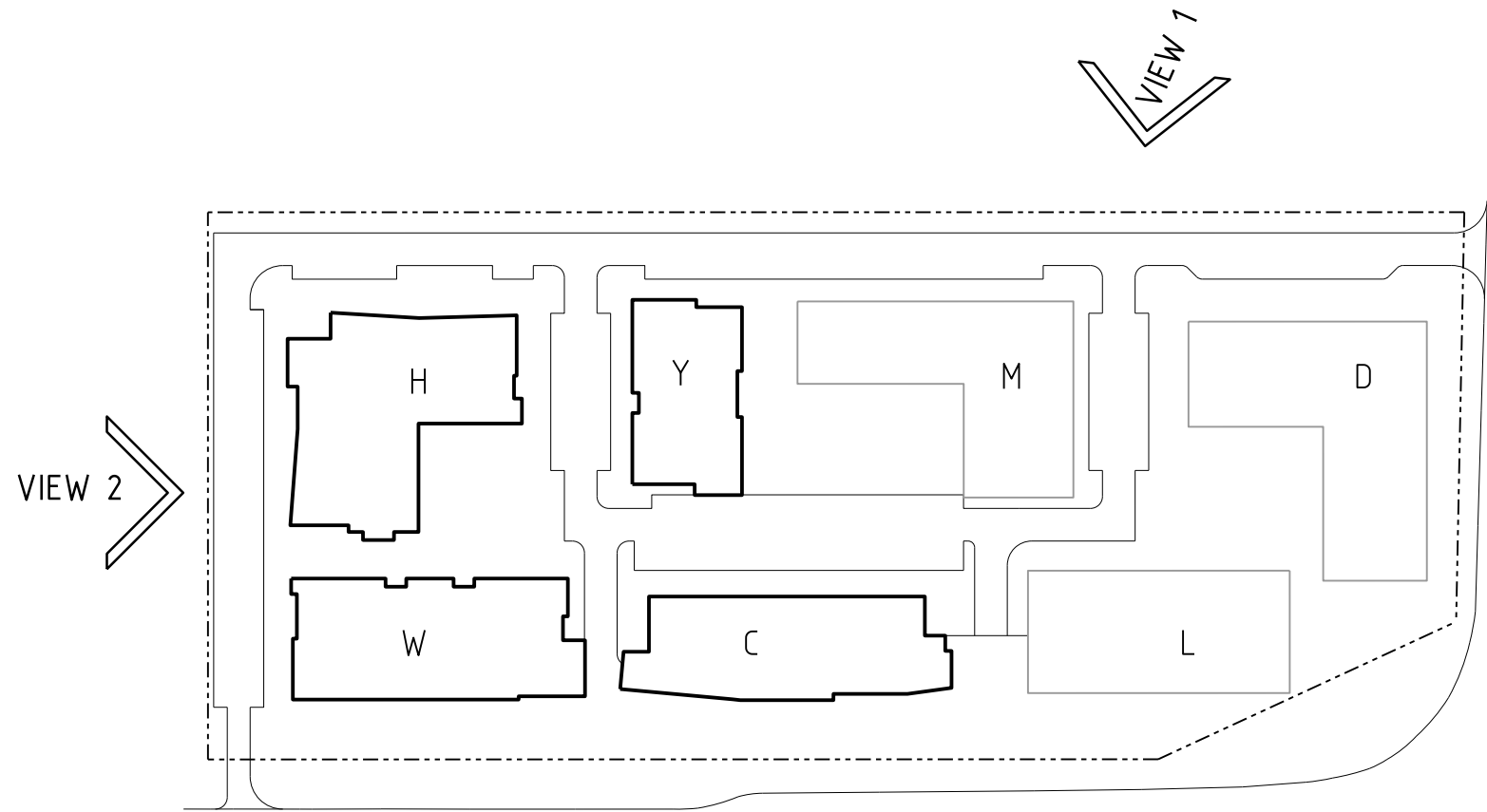

2 VIEW FROM NORTH WEST
NTS



1 VIEW FROM NORTH EAST
NTS



Revisions
No Date Description Ver App'd
A 21.01.11 PART 3A SUBMISSION

THE NUMBER 4 HAS BEEN DELETED
FROM THE FLOOR NOMENCLATURE

Do not scale drawings. Use figured dimensions only. Check & verify levels and dimensions on site prior to the commencement of any work, the preparation of shop drawings or the fabrication of components.

This drawing is the copyright of Allen Jack + Cottler Architects and is protected under the Copyright Act 1968. Do not alter, reproduce or transmit in any form, or by any means without the express permission of Allen Jack + Cottler Architects.

Nominated Architects: Michael Heenan 5264, Peter Ireland 6661, Reginald Smith 3312, Peter Stronach 3372

Site Location Plan

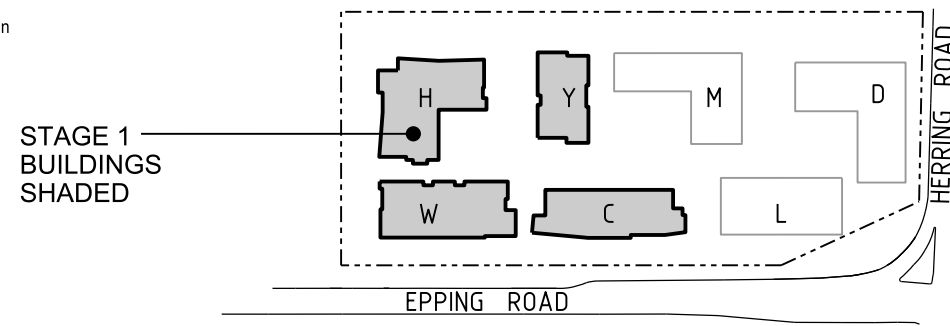

Client

STAMFORD
LAND CORPORATION LTD

Architect

AJ+C
ALLEN JACK + COTTLER
79 Myrtle Street Chippendale NSW 2008 AUSTRALIA
ph +61 2 9311 8222 fx +61 2 9311 8200 ABN 53 003 782 250

Project
MACQUARIE VILLAGE
110-114 HERRING ROAD
MACQUARIE PARK

Proj No. 10_030

Drawing Title
VIEWS SHEET 1

Drawing Status
NOT FOR CONSTRUCTION

Scale
NTS

Drawing No
DA3630

Issue
A